

Features

- In accordance with ISO21287 standard
- With male and female thread on piston rod
- Working temperature $-10\text{ }^{\circ}\text{C} \div +80\text{ }^{\circ}\text{C}$
- Working Pressure Range 1-10 bar

RS PRO Pneumatic Piston Rod Cylinder

RS PRO 0360733



RS PRO is the own brand of RS. The RS PRO Seal of Approval is your assurance of professional quality, a guarantee that every part is rigorously tested, inspected, and audited against demanding standards. Making RS PRO the Smart Choice for our customers.

Product Description

- * Compact and efficient solutions for industrial applications
- * These cylinders are ideal for those seeking reliable and high-performance solutions in environments with limited space.
- * Designed in accordance with the strict **ISO 21287** standard, they ensure uniformity and easy integration into systems.
- * Featuring an aluminium profile tube with sensor slots on three sides.

General Specifications

Manufacturer Series	RS PRO NSKI
Action	Double Acting

Mechanical Specifications

Stroke	See table below for more details
Bore	See table below for more details
Length	See table below for more details
Piston Rod Thread Gender	See table below for more details
Maximum Operating Pressure	10 bar
Working Pressure Range	1-10 bar
Working Temperature	-10 °C ÷ +80 °C
Absolute Maximum Pressure	12 bar
Cushioning Type	Elastomer
Pneumatic Connection	See table below for more details
Diameter	See table below for more details
Port Connection	See table below for more details
Width	See table below for more details
Height	See table below for more details
Dimensions	See table below for more details

Approvals

Declarations	MFR Declaration of Conformity
Standards Met	ISO21287

Products within this series

Stock No.	Bore (mm)	Stroke (mm)	Length (mm)	Height (mm)	Width (mm)	Diameter (mm)	Pneumatic Connect. (Port Connection)	Piston Rod Thread Gender
0360733	25	25	86	41	41	25	M5	Male
0360734	32	10	61	49	49	32	1/8"	Female
0360735	40	50	121	57	57	40	1/8"	Male
0360736	50	40	115	67	67	50	1/8"	Male

Drawings / Dimensions / Internal Structure / Materials

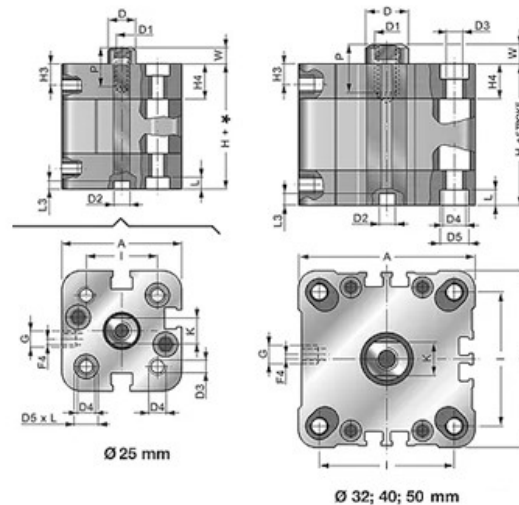

Stock No.	Bore	A	ØD	ØD2	ØD3	ØD4	ØD5	G	H3	H4	I	K	L	L3	ØD1	P	W	F4	H
0360733	25	41	10	6	4.2	M5	7.5	M5	7.5	13.5	26	8	4.2	2.5	M5	10	5.5	3	39,5 x (±0.5)
0360734	32	49.2	12	6	5.2	M6	9	G1/8	7.5	15	32	10	4.5	2	M6	12	6	0	44,5 x (±0.5)
0360735	40	57.2	12	6	5.2	M6	9	G1/8	7.5	15	42	10	4.2	2	M6	12	6.5	0	45,5 x (±0.5)
0360736	50	67	16	8	6.7	M8	10.5	G1/8	7.5	14.6	50	13	4.7	2.5	M8	12	7.5	0	45,5 x (±0.5)

Version with male thread NSKI..M

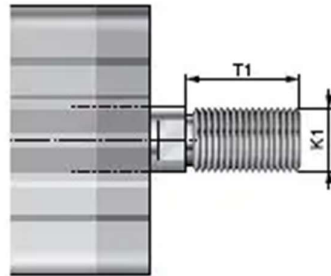

Standard ISO 21287			
Stock No.	Bore	K	T1
0360733	25	M8	16
0360735	40	M10x1.25	19
0360736	50	M12x1.25	22