

BLIND PLATE FOR BANK HOUSING - Keying tab



1113848

<https://www.phoenixcontact.com/in/products/1113848>

Please be informed that the data shown in this PDF document is generated from our online catalog. Please find the complete data in the user documentation. Our general terms of use for downloads are valid.

Dummy plate for unused slots on instrument housings



Commercial data

Item number	1113848
Packing unit	1 pc
Minimum order quantity	1 pc
Sales key	*****
Product key	DTMCAA
GTIN	4063151037246
Weight per piece (including packing)	9.16 g
Weight per piece (excluding packing)	9.2 g
Customs tariff number	85389099
Country of origin	DE

BLIND PLATE FOR BANK HOUSING - Keying tab



1113848

<https://www.phoenixcontact.com/in/products/1113848>

Technical data

Notes

Note on application	
Note on application	Only for industrial use

Product properties

Product type	Cover
--------------	-------

Material specifications

Color	black
-------	-------

BLIND PLATE FOR BANK HOUSING - Keying tab



1113848

<https://www.phoenixcontact.com/in/products/1113848>

Drawings

Dimensional drawing

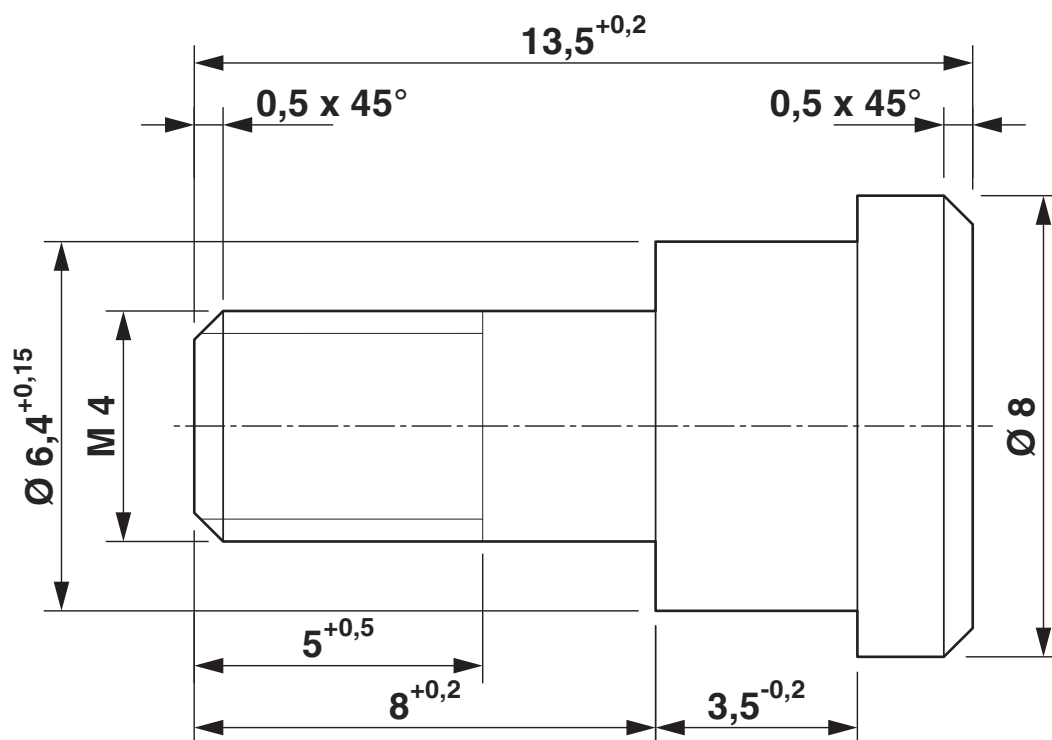

BLIND PLATE FOR BANK HOUSING - Keying tab



1113848

<https://www.phoenixcontact.com/in/products/1113848>

Classifications

ECLASS

ECLASS-11.0	27371692
ECLASS-12.0	27371692
ECLASS-13.0	27371692

ETIM

ETIM 9.0	EC002586
----------	----------

UNSPSC

UNSPSC 21.0	39122300
-------------	----------

BLIND PLATE FOR BANK HOUSING - Keying tab



1113848

<https://www.phoenixcontact.com/in/products/1113848>

Environmental product compliance

China RoHS	
Environment friendly use period (EFUP)	EFUP-25
	An article-related China RoHS declaration table can be found in the download area for the respective article under "Manufacturer declaration". For all articles with EFUP-E, no China RoHS declaration table issued and required.
EU REACH SVHC	
REACH candidate substance (CAS No.)	No substance above 0.1 wt%

Phoenix Contact 2025 © - all rights reserved
<https://www.phoenixcontact.com>

PHOENIX CONTACT (I) Pvt. Ltd.
A-58/2, Okhla Industrial Area, Phase - II, New Delhi-110 020

+91.1275.71420
info@phoenixcontact.co.in