

THIS DRAWING IS UNPUBLISHED. RELEASED FOR PUBLICATION
 © COPYRIGHT - TE CONNECTIVITY ALL RIGHTS RESERVED.

| LOC | | DIST | | REVISIONS | | | |
|-----|-----|---------------------------------|-----------|-----------|------|--|--|
| P | LTR | DESCRIPTION | DATE | DWN | APVD | | |
| W | | ECR-10-020218 | 28DEC2010 | PS | PKS | | |
| WI | | 3-338088-3 (HALOGEN FREE) ADDED | 24AUG2011 | PS | RRP | | |

NOTES:

- 1 TOLERANCES UNLESS OTHERWISE SPECIFIED: ±0.15.
- 2 CONTACT PLATING:
OVERALL: Ni 1.27µm MIN. ALL OVER THE CONTACTS
SOLDER ZONE: Sn 3.5-5.0µm ON THE SOLDER ZONE OF THE CONTACT
MATING ZONE: PLATING CONFIRMS TO PRODUCT REQUIREMENTS AS PER SPECIFICATION 108-19117
- 3 CONTACT AND BRACKET MATERIAL:
CONTACTS: PHOSPHOR BRONZE
SOLDER BRACKET: TINPLATED BRASS WITH NICKEL UNDERLAYER.
- 4 THIS JACK CAN ALSO BE APPLIED HANGING THROUGH A HOLE, IN A PRINTED CIRCUIT BOARD. SEE LEFT PCB LAYOUT.
- 5 SURFACE CAN BE USED FOR PICKING THE MODULAR JACK WITH, TYPE 11 SMD MACHINE.
- 6 MEASURED AT HEEL OF CONTACTS, COPLANARITY AT TIPS MAX. 0.18mm.
- 7 TAPE AND REEL PACKAGING ACCORDING TO EIA 481-3 SPECIFICATIONS.
- 8 INCLUDES KAPTON TAPE (10mm x 14mm) ON TOP SURFACE FOR PICK AND PLACE UNIT
- 9 OBSOLETE
- 10 HOUSING MATERIAL:
HOUSING: 30% G.F. P.A 9T, COLOR BLACK, UL 94V-0.
- 11 HOUSING MATERIAL:
HOUSING: 30% G.F. LCP (HALOGEN FREE), COLOR BLACK, UL 94V-0.

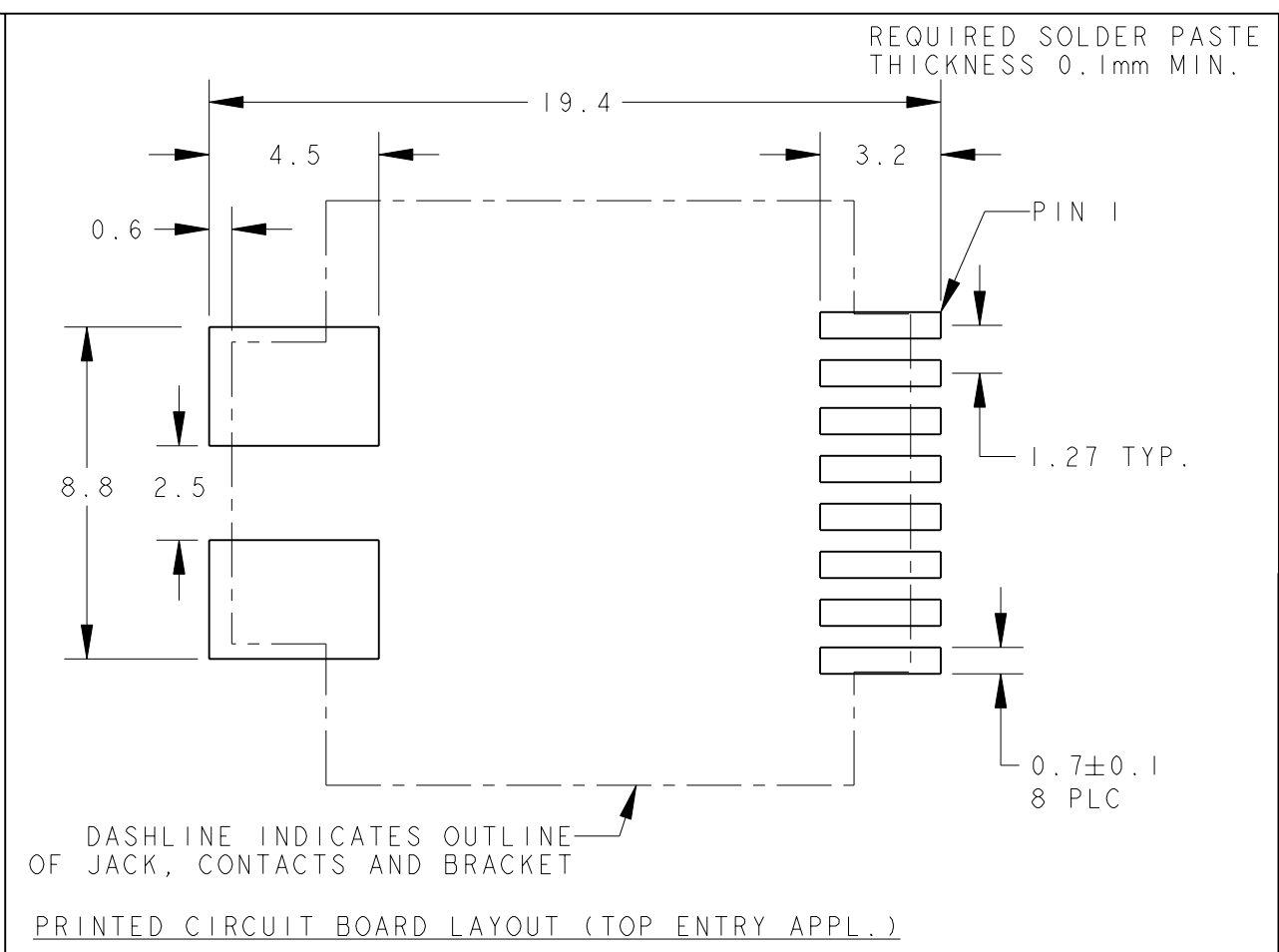
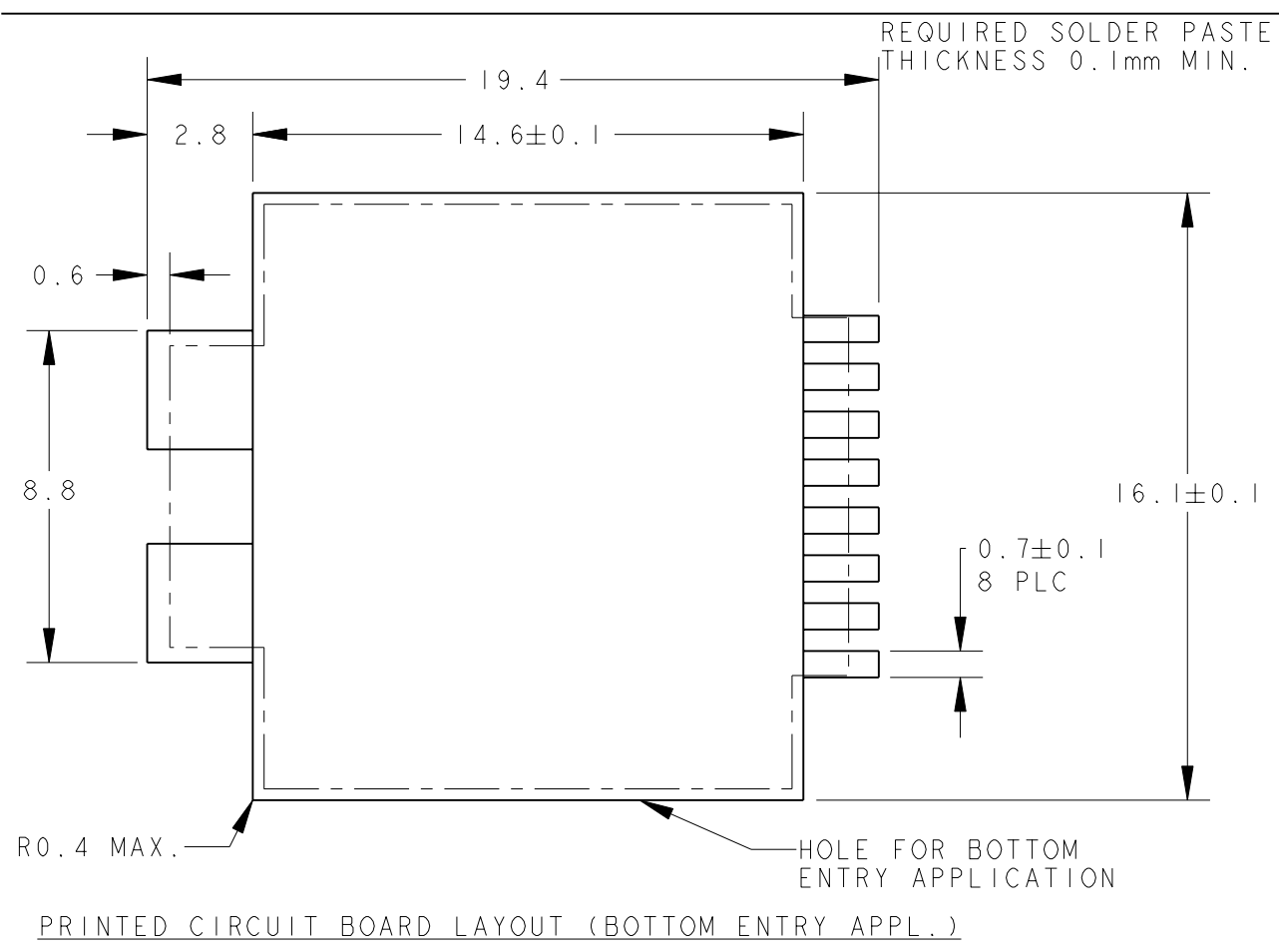
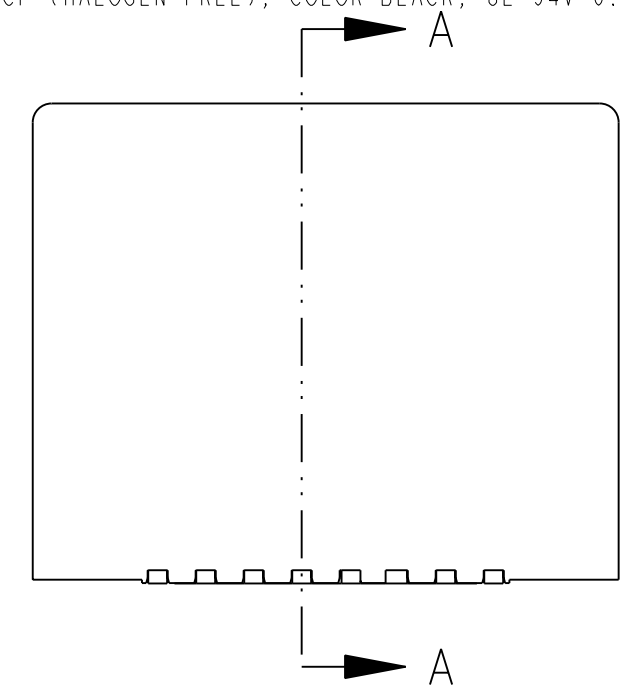
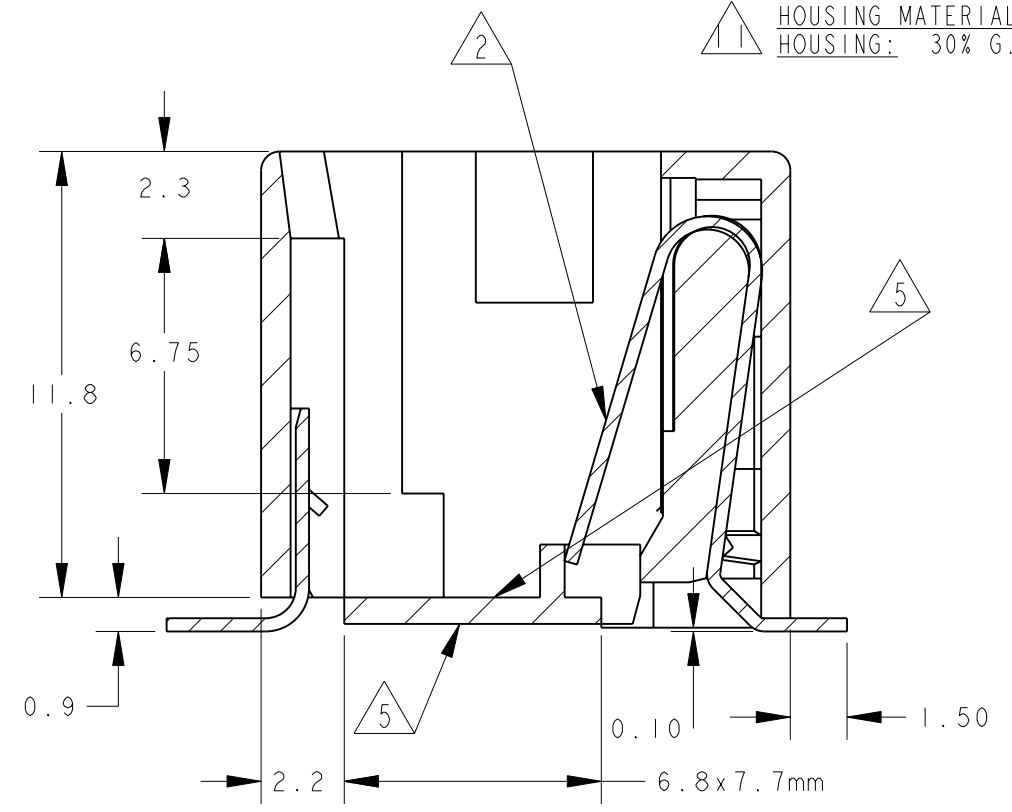
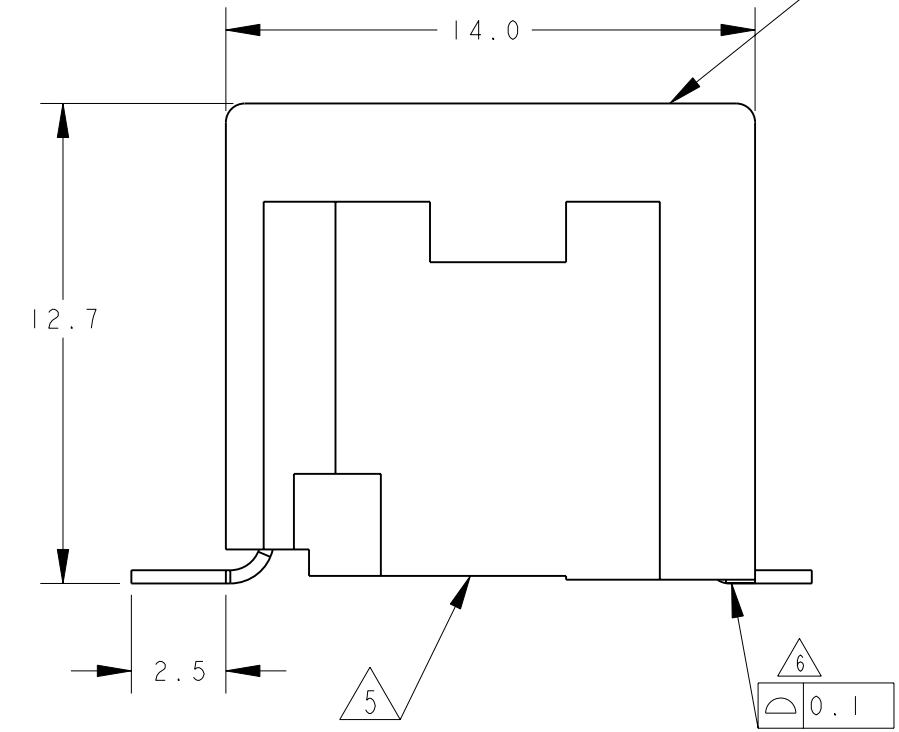
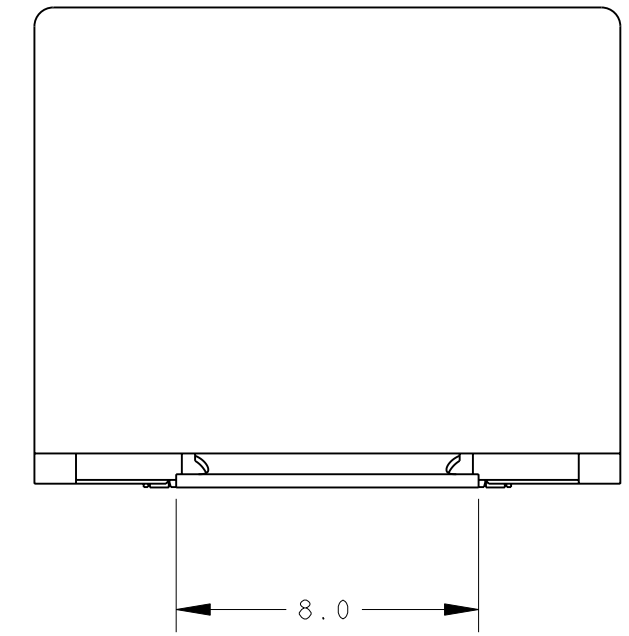
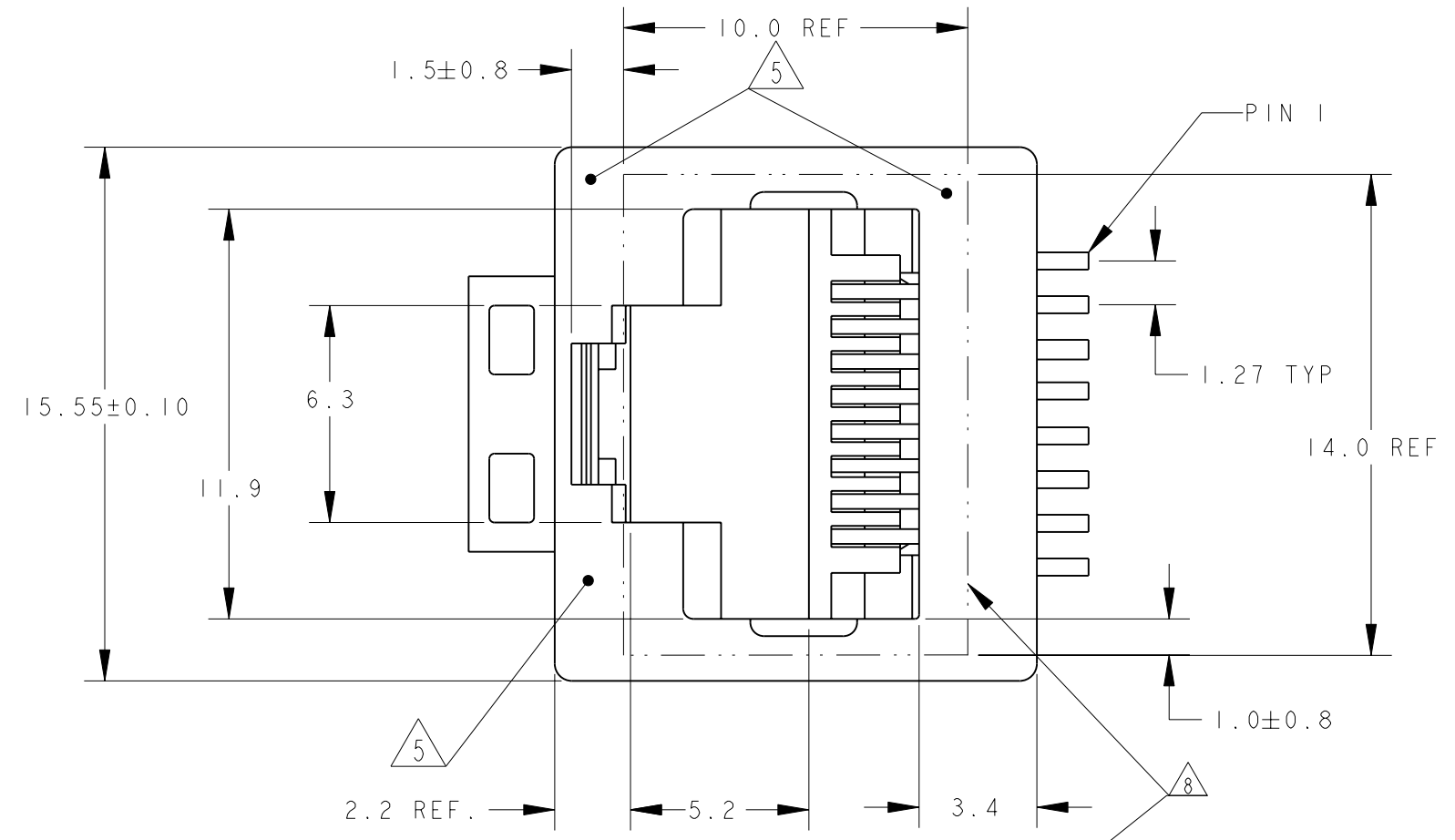
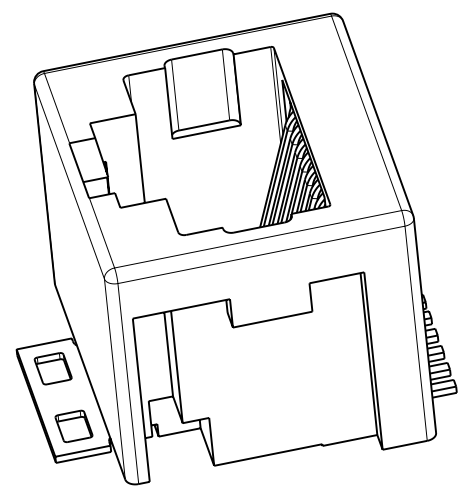

| REMARKS | PACKAGING | PART NUMBER |
|-------------------|--|-------------|
| 8 POSN./8 CONTACT | 250 PCS ON Ø360mm OD REEL TOP ENTRY ORIENTATION PER DETAIL B1 | 3-338088-3 |
| 8 POS./8 CONTACT | 250PCS ON Ø360mm OD REEL TOP ENTRY ORIENTATION PER DETAIL B1 WITH KAPTON TAPE FOR PICK AND PLACING | 1-338088-6 |
| 8 POSN./8 CONTACT | 250 PCS ON Ø360mm OD REEL BOTTOM ENTRY ORIENTATION PER DETAIL B2 | 1-338088-5 |
| 8 POSN./8 CONTACT | 500 PCS ON Ø560mm OD REEL TOP ENTRY ORIENTATION PER DETAIL B1 | 2-338088-3 |
| 8 POSN./8 CONTACT | 250 PCS ON Ø360mm OD REEL TOP ENTRY ORIENTATION PER DETAIL B1 | 1-338088-3 |

THIS DRAWING IS A CONTROLLED DOCUMENT.

DIMENSIONS: mm

TOLERANCES UNLESS OTHERWISE SPECIFIED:

| | |
|--------|---|
| 0 PLC | ± |
| 1 PLC | ± |
| 2 PLC | ± |
| 3 PLC | ± |
| 4 PLC | ± |
| ANGLES | ± |
| FINISH | ± |

MATERIAL: SEE NOTE 3-

APVD: R. SMEETS

PRODUCT SPEC: 108-19117

APPLICATION SPEC: 114-19041

WEIGHT: 2.1 gr

SCALE: 5:1

SHEET 1 OF 2

REV: W1

TE Connectivity

INVERTIBLE MODULAR JACK, 8 POSITION SURFACE MOUNT APPLICATION

SIZE: A2 CAGE CODE: 0779 DRAWING NO: 338088

THIS DRAWING IS UNPUBLISHED. RELEASED FOR PUBLICATION
 © COPYRIGHT - TE CONNECTIVITY ALL RIGHTS RESERVED.

| LOC | DIST | REVISIONS | | | |
|-----|------|-------------|------|-----|------|
| P | LTR | DESCRIPTION | DATE | DWN | APVD |
| IR | - | SEE SHEET 1 | - | - | - |

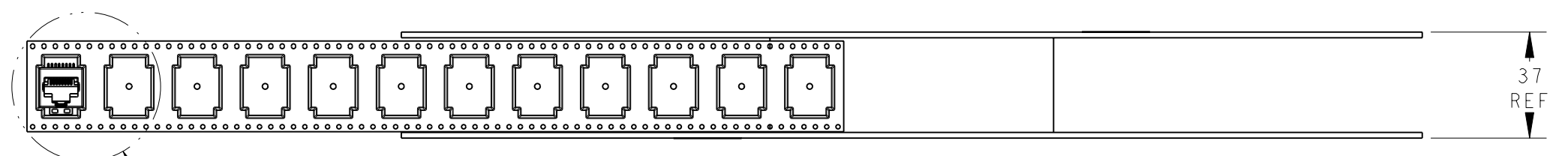
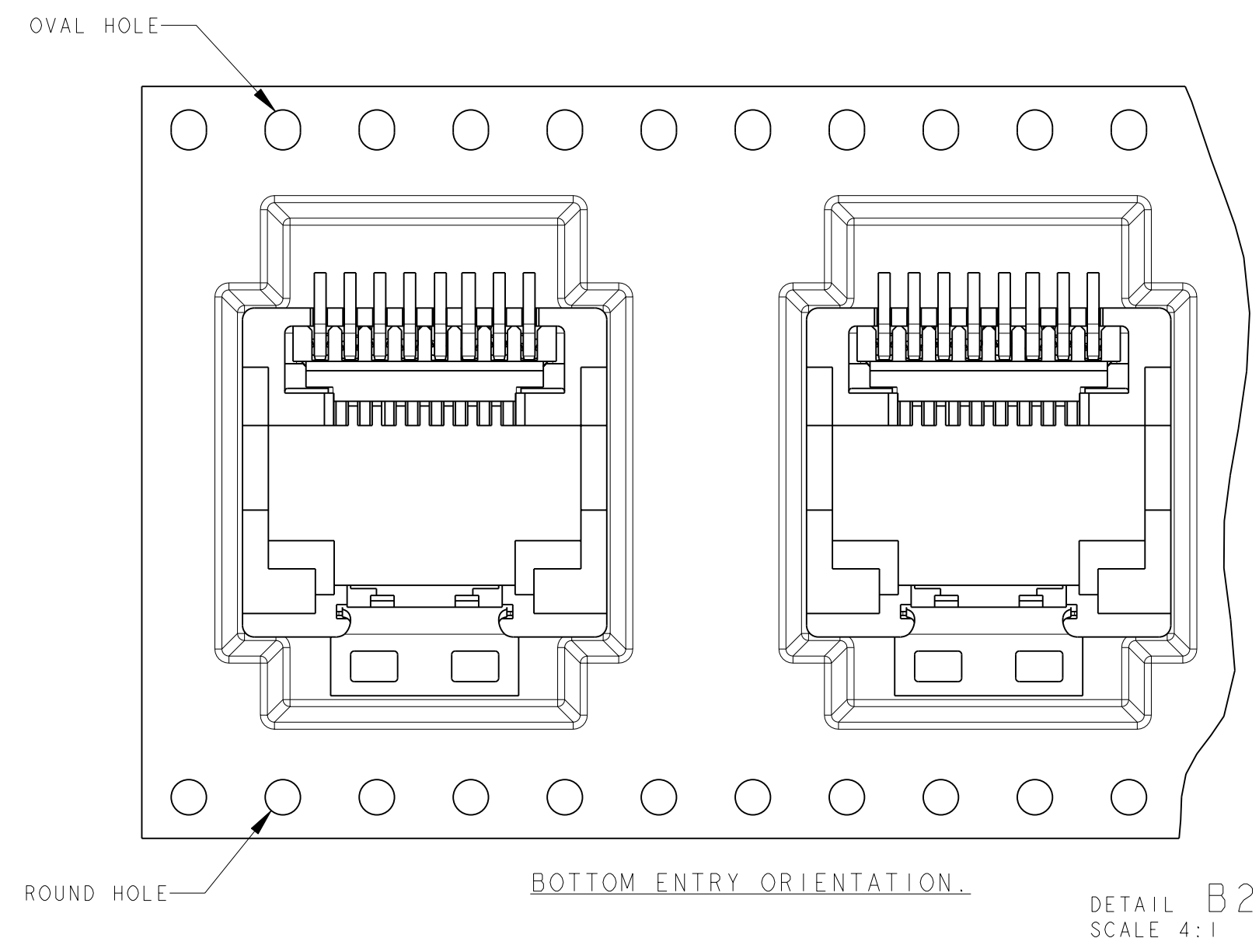
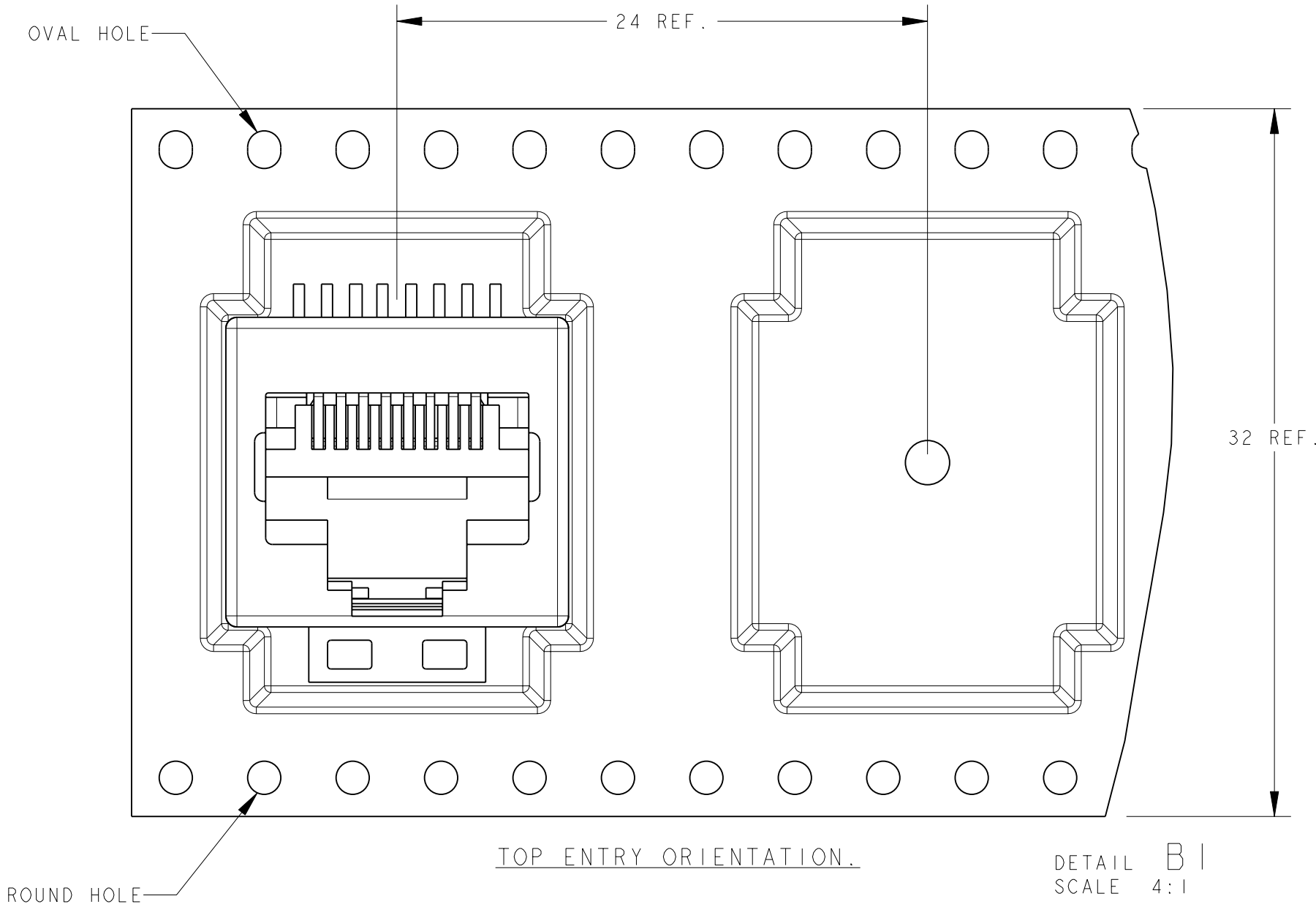

SEE DETAIL B1 & B2

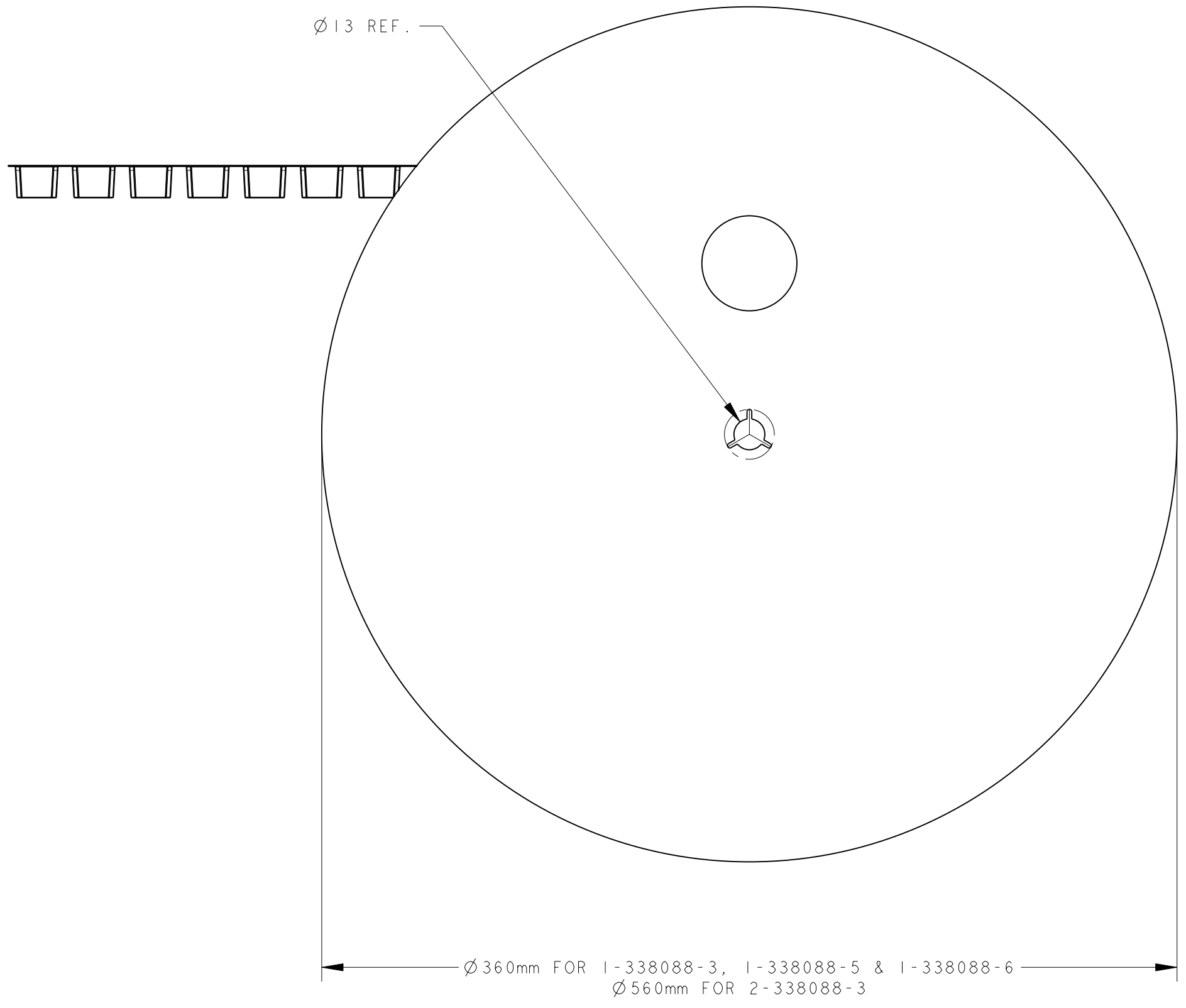

| | | | | |
|--|--|-------------------------------|---|-----------------|
| THIS DRAWING IS A CONTROLLED DOCUMENT. | | DWN E.v.ELJK 30-Sep-96 | TE Connectivity | |
| DIMENSIONS: mm | | CHK E.STELLINGA Dec-96 | | |
| TOLERANCES UNLESS OTHERWISE SPECIFIED: | | APVD R.SMEETS | NAME INVERTIBLE MODULAR JACK, 8 POSITION SURFACE MOUNT APPLICATION | |
| 0 PLC ± | | PRODUCT SPEC 108-19117 | SIZE | CAGE CODE |
| 1 PLC ± | | APPLICATION SPEC 114-19041 | DRAWING NO A20779C-338088 | RESTRICTED TO |
| 2 PLC ± | | WEIGHT 2.1 gr | SCALE 5:1 | SHEET 2 OF 2 |
| 3 PLC ± | | CUSTOMER DRAWING | REV. W1 | |
| 4 PLC ± | | | | |
| ANGLES ± | | | | |
| FINISH | | | | |