

**Compact connectors**  
**Sockets/plugs for snap-in assembly 250 V, 16 A**

# ST 18/3

The snap-in design can be snapped into place for the rapid installation of socket/plug components in housing. It guarantees a clean termination in the section of housing<sup>1)</sup>.

The terminal connection can be both a screwless and a screw connection.

By using an interlocking slide, it is possible to lock the cable assembly and crimp designs of ST 18.

**Snap-in: screwless**

2 connections per pole  
 Finely stranded cable 0.5–1.5 mm<sup>2</sup> with connector sleeve  
 Rigid cable 0.5–2.5 mm<sup>2</sup>

Insulation strip length: 0.5–1.5 mm<sup>2</sup>: 8 mm  
 2.5 mm<sup>2</sup>: 9 mm

**Snap-in: screwable**

1 connection per pole  
 Single-core and finely stranded cable 0.5–2.5 mm<sup>2</sup>

Insulation strip length: 0.5–1.5 mm<sup>2</sup>: 8 mm  
 2.5 mm<sup>2</sup>: 9 mm

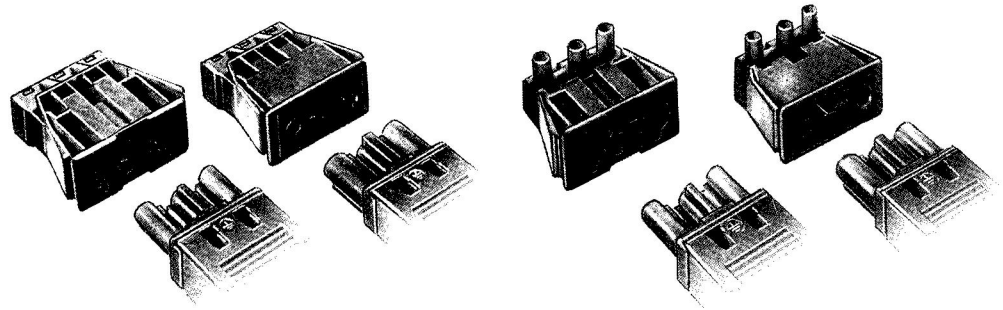

**Plug component**  
 for snap-in assembly

black **93.032.9053.0** 100  
 white **93.032.9058.0** 100

**93.032.9358.1** 100  
**93.032.9358.0** 100

**Socket component**  
 for snap-in assembly

black **93.031.9053.0** 100  
 white **93.031.9058.0** 100

**93.031.9358.1** 100  
**93.031.9358.0** 100

**Interlocking slide** (order separately)  
 suitable for ST 18/3 with cable assembly.

black **05.584.0153.0** 100  
 white **05.584.0153.2** 100

**05.584.0153.0** 100  
**05.584.0153.2** 100

Interlocking slide  
 for socket and plug contacts

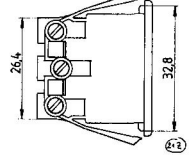
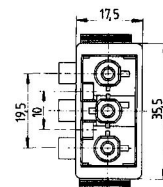
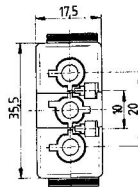
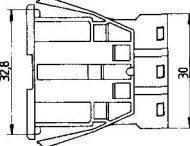
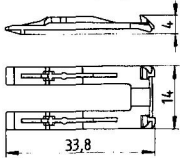

Section:

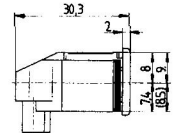
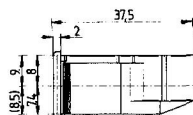
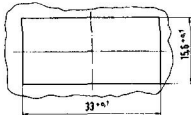

Material thickness 0.5 – 1.5 mm

<sup>1)</sup> Housing material, enamel and deburring can influence the fixing position in the housing. Detailed installation instructions are available on request.