

## Features

- Maximum operating pressure is 35 bar.
- Operating temperature range -20°C to +100°C.
- Material: Brass / Steel with Nickel Plated Finish
- Single Shut Off (One side is with valve)
- Flow 660 l/min
- British Profile DN5.5
- Compatible with:  
TST SWING COUPLING P  
PCL 60  
PARKER - RECTUS 19

## RS PRO Pneumatic Quick Connect Coupling

RS Stock No.: 0325493



RS PRO is the own brand of RS. The RS PRO Seal of Approval is your assurance of professional quality, a guarantee that every part is rigorously tested, inspected, and audited against demanding standards. Making RS PRO the Smart Choice for our customers.

## Product Description

### RS PRO Series 19 Quick Connect Couplings

Pneumatic quick-connect coupling connectors are found across industry in pneumatic systems as diverse as robotic assembly lines and other equipment.

- Maximum operating pressure is 35 bar.
- Operating temperature range -20°C to +100°C.
- Material: Brass / Steel with Nickel Plated Finish
- Single Shut Off (One side is with valve)
- Flow 660 l/min
- British Profile DN5.5
- Compatible with:  
TST SWING COUPLING P  
PCL 60  
PARKER - RECTUS 19

## Specifications

Manufacturer Series	019
Coupling Type	Quick Connect Coupling Plug
Connection Standard	DN 5.5 British Profile
Connection Standard Compatible With	TST SWING COUPLING P; PCL 60; PARKER-RECTUS 19
Minimum Operating Temperature	-20°C
Maximum Operating Temperature	+100°C
Maximum Operating Pressure	35bar
Flow	660 l/min
Flow Direction & Sealing	Through Type Coupling
Material	Steel
Finish	Nickel Plated
Connection Type	Threaded
Thread Size	1/8 in
Thread Standard	G
Thread Gender	Female
Coupling Gender	Male
Threaded Connection	G 1/8 Female
Seal material	N/A
Hose Barb Connection	N/A

## Specifications

**Plug Profile Serie 019**

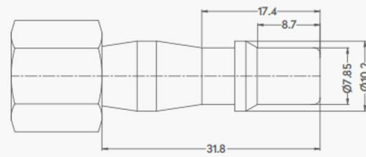

**Dimensions (mm)**

SW	L	ØD
14	45	-

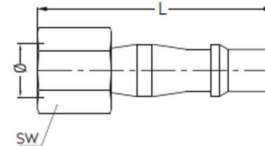

**Materials**

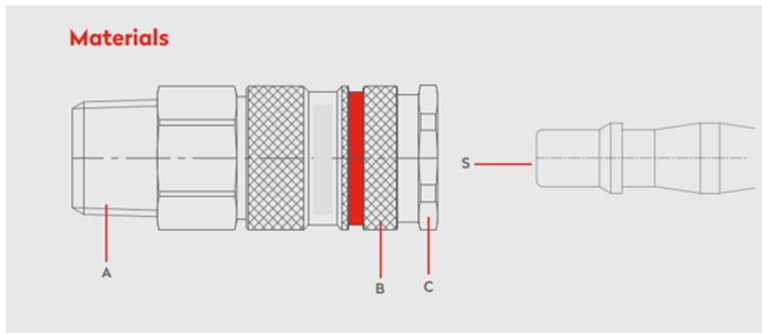

**Material Code**

A = Steel Nickel Plated  
B = Steel Nickel Plated  
C = Brass Nickel Plated  
S = Steel Nickel Plated

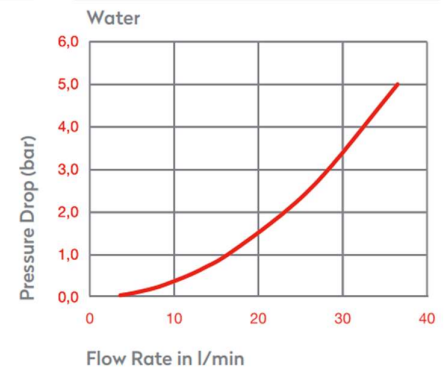
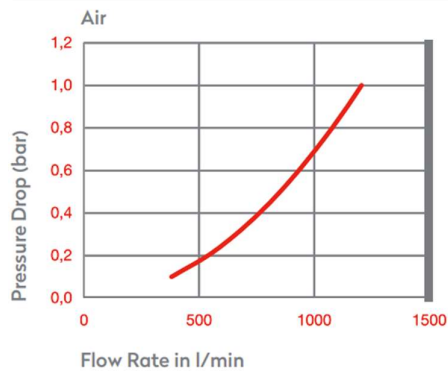

## Series 19 Quick Connect Couplings



0 - 35 bar  
(0-508 PSI)



-20° to +100°C (NBR)  
-4° to +212°F

**Shut Off  
Type**

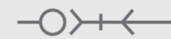

OM 300 - 00750  
OM 100 - 01000  
OM 250 - 00500

**FLOW**

660 lt/min

**DN**

**5.5 mm**