

Confidence in Kaba...

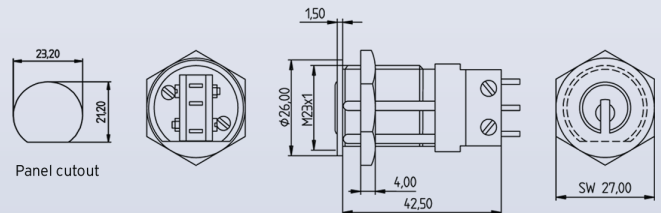
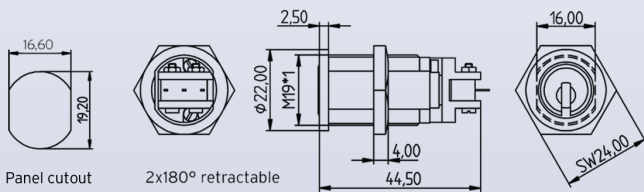
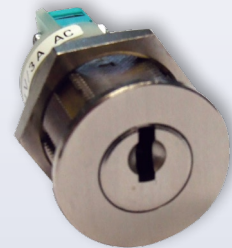

SZM series

Features & Benefits:

- Low Voltage keyswitch, up to 250 vac, 30 vdc
- Single Pole available as normally open and/or normally closed circuit
- Obtainable as:
 - 1 key entry 90° clockwise movement
 - 1 key entry 90° Spring Return
 - 2 key entry 180° movement
- Compact design
- High Security Key Registration
- Extensive Master Keying capability
- Strong Reversible Nickel Silver keys
- Standard Finish - Nickel Plated
Special Finish - Polished Brass
- Available in Kaba Quattro pluS cylinder series only

K64

Features & Benefits:

- Keyswitch available as 3A 250 vac or 5A 125 vac
- Several switching options available
- Single Pole available as normally open and/or normally closed circuit.
- Obtainable as:
 - 1 key entry 90° clockwise movement
 - key entry 90° Spring Return
 - 1 Key entry 360° lost motion
 - 2 Key entry 90° movement (Kaba 20 only)
- Compact design
- High Security Key Registration
- Extensive Master Keying capability
- Strong Reversible Nickel Silver keys
- Standard Finish - Nickel Plated
Special Finish - Polished Brass
- Available in both Kaba Quattro pluS and Kaba 20 cylinder series