

## Product Datasheet

# RS Diabolo Mounts



Their elasticity is much greater in all the directions parallel to the armatures than in the perpendicular direction. The rubber works based on compression or shear depending on the direction it is placed in at installation time. This direction is made according to the use and the objective.

It is therefore installed with nuts or screws depending on the model chosen, with one part attached to the fixed chassis and the other to the machine to be suspended.

The AMC Mecanocaucho® bobbins are particularly suitable for installation on small motor-pumps, motor-ventilators, driers, sieves, compactors, washing machines, electrical motors, on-board control panels, measuring apparatuses, control cabinets, microphones, fluorescent tubes, etc.

## Technical data

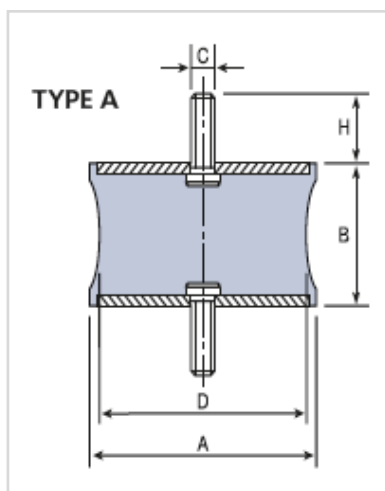

RS Ref:	AMC Ref:	A	B	C	D	H	COMPRESSION		SHEAR	
							LOAD max. daN	DEFLECT. mm	LOAD max. daN	DEFLECT. mm
8112495	129001	12	12	M-5	8	10	4	1,5	0,4	1,5
8112344	129002	20	19	M-6	13,5	16,5	12	2,5	3	5
8112542	129003	30	25	M-8	24	20	40	5	4	4,5
8112524	129004	40	28	M-10/M-8	19	25	30	5	2,5	4,5
8112552	129009	60	60	M-10	50	25	150	8	30	10