

## FEATURES

- Primary voltage rating of 115/230V ac
- Secondary voltage rating of 2x6, 2x9, 2x12, 2x15, 2x18V
- Power rating of 4 - 30VA
- Operating frequency of 50/60Hz
- Maximum temperature of 130°C
- Isolation of 3.75kV RMS
- Low height and compact design
- Protection class IP00

## RS PRO PCB Transformers – Low Profile Type A



RS Professionally Approved Products bring to you professional quality parts across all product categories. Our product range has been tested by engineers and provides a comparable quality to the leading brands without paying a premium price.

## Product Description

Potted PCB mounting low voltage mains trans-formers with a twin 115 VAC 50/60Hz primary winding. Designed according to the following specifications.

- Low height and compact design
- Independent secondary windings suitable for series/parallel connection to give output voltage and current options
- High efficiency and low temperature rise
- Two compartments' bobbins providing double insulation
- Low interwinding capacity
- Low radiated noise
- 100% electrical and flash tested
- Four holes fixing for all types.

## General Specifications

<b>Number of Outputs</b>	2
<b>Output Protection Type</b>	None. Suggested fusing according to current rating
<b>Applications</b>	Various electronics, electronic and electrical control systems, relays

## Mechanical Specifications

<b>Mounting Type</b>	PCB mount
<b>Length</b>	53 - 68mm
<b>Width</b>	44 - 57mm
<b>Depth</b>	23 - 31mm
<b>Weight</b>	150 - 450g

## Electrical Specifications

<b>Power Rating</b>	4 -30VA
<b>Primary Voltage Rating</b>	115/230V ac
<b>Secondary Voltage Rating</b>	2x6, 2x9, 2x12, 2x15, 2x18V
<b>Isolation</b>	3.75kV RMS
<b>Temperature Class</b>	B (130°C)

Input Data	
Rated Input Voltage	115/230V ac
Switch-On Time	100%
Minimum Operating Frequency	50Hz
Maximum Operating Frequency	60Hz

Output Data	
Rated Output Voltage	2x6, 2x9, 2x12, 2x15, 2x18V
Rated Power	4 - 30VA

## Protection Category

IP Rating	IP00
-----------	------

## Approvals

Declarations	MFR Declaration of Conformity
Compliance	RoHS, CE
Standards Met	IEC/BS/EN 61558-1 AS/NZS 61558.1 IEC/BS/EN 61558-2-6 AS/NZS 61558.2.6

## Order Details

RS Stock number	Power VA	Specification	Primary [V]	Secondary voltage [V]	Secondary current [mA]	No-load voltage +/-10%
1213835	4	Transformer Low Profile PCB 4VA 2x6V	2x115	2x6	333.3	2 x 9.4
1213836	4	Transformer Low Profile PCB 4VA 2x9V	2x115	2x9	222.2	2 x 14
1213839	6	Transformer Low Profile PCB 6VA 2x6V	2x115	2x6	500.0	2 x 8.1
1213840	6	Transformer Low Profile PCB 6VA 2x9V	2x115	2x9	333.3	2 x 12.1
1213841	6	Transformer Low Profile PCB 6VA	2x115	2x12	250.0	2 x 16.2
1213842	6	Transformer Low Profile PCB 6VA	2x115	2x15	200.0	2 x 20.2
1213849	10	Transformer Low Profile PCB 10VA	2x115	2x12	416.6	2 x 16.4
1213850	18	Transformer Low Profile PCB 18VA	2x115	2x12	750.0	2 x 14.7
1213851	18	Transformer Low Profile PCB 18VA	2x115	2x18	500.0	2 x 22.5
1213852	24	Transformer Low Profile PCB 24VA	2x115	2x12	1000.0	2 x 16.0
1213858	30	Transformer Low Profile PCB 30VA	2x115	2x9	1666.6	2 x 11.2
1213855	30	Transformer Low Profile PCB 30VA	2x115	2x12	1250.0	2 x 15.2
1213856	30	Transformer Low Profile PCB 30VA	2x115	2x15	1000.0	2 x 18.5
1213857	30	Transformer Low Profile PCB 30VA	2x115	2x18	833.3	2 x 20.2

## Mechanical Drawings

### 4 VA & 6 VA

Primary possible connections

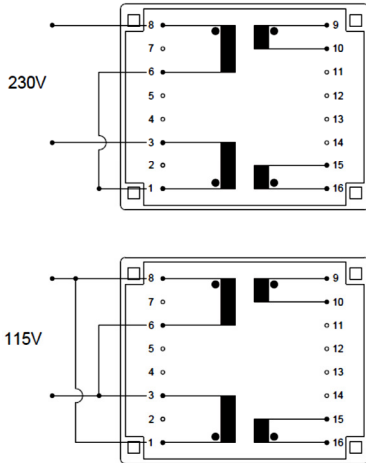

Secondary possible connections

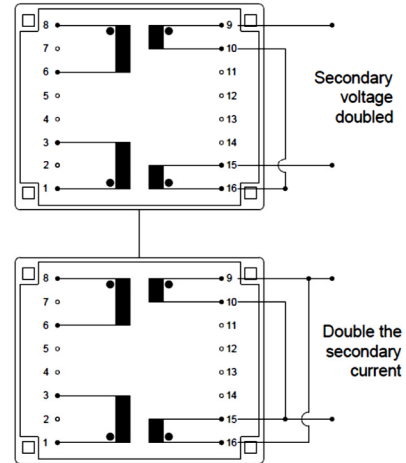

### 10 VA - 30 VA

Primary possible connections

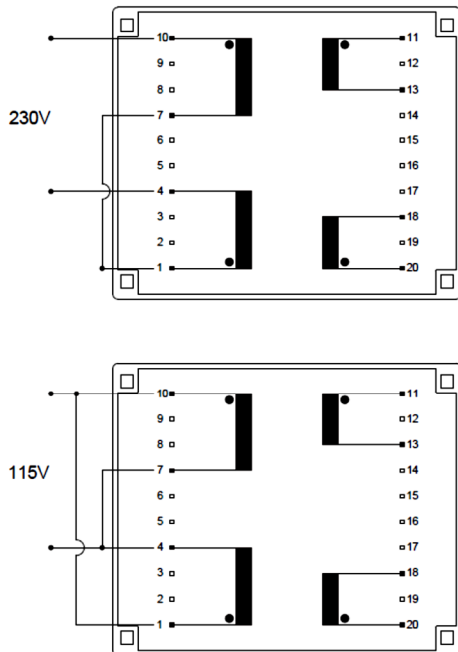

Secondary possible connections

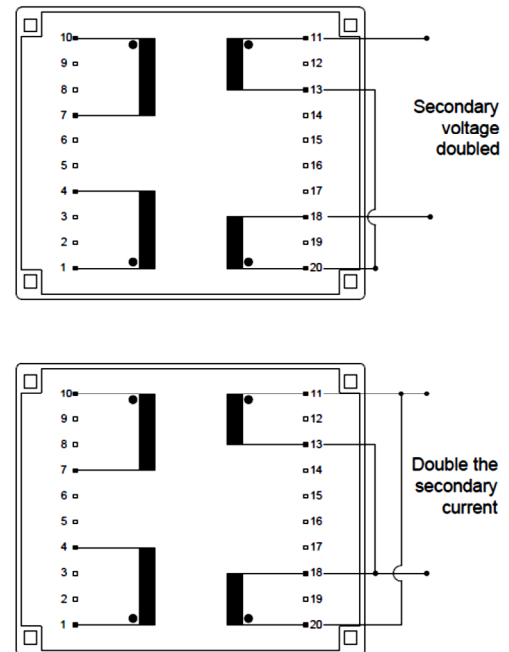

### 4VA 6 VA

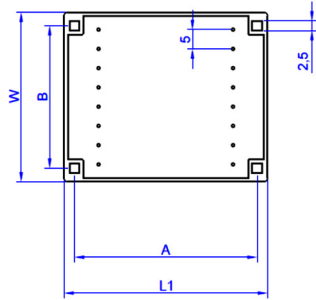
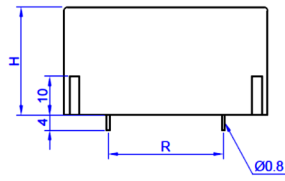

### 10 VA - 30VA

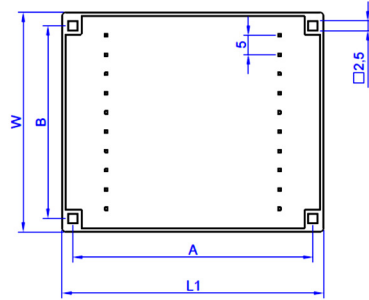
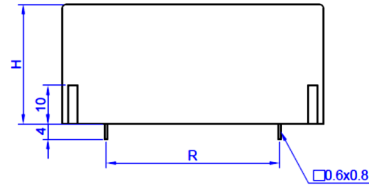

Power [VA]	Dimensions			Fixing holes		Pins		Weight [kg]
	L1 [mm]	W [mm]	H [mm]	A [mm]	B [mm]	R [mm]	No.	
4	53	44	23	47.5	37.5	35	2x8	0.15
6	53	44	23	47.5	37.5	35	2x8	0.185
10	68	57	25	62.5	50	45	2x10	0.260
18	68	57	27	62.5	50	45	2x10	0.385
24	68	57	31	62.5	50	45	2x10	0.45
30	68	57	35	62.5	50	45	2x10	0.53