

# POWERMONKEY EXPEDITION

## QUICK START GUIDE

### MULTI-POWER GENERATOR RUGGED WATER RESISTANT 5V & 12V CHARGER

10500mAh



- A** powermonkey expedition battery unit
- B** solarmonkey expedition solar panel
- C** Hand crank
- D** Blanking cap
- E** End cap with waterproof cable connector
- F** Female in-car socket
- G** Universal AC mains charger

## HOW TO CHARGE THE POWERMONKEY EXPEDITION



### HAND CRANK



Press on/off button to display level of charge in the battery unit

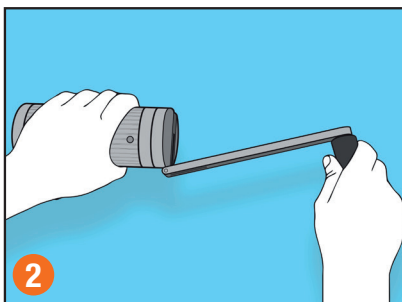

Lift crank arm and slot into groove on top cap. Holding the unit with one hand, begin turning crank in a forwards direction

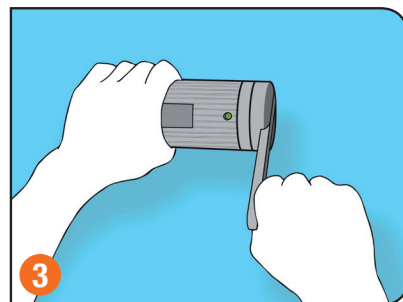

The green LED shows when hand crank is producing energy at optimum level. 10 mins provides 40 mins talk time on iPhone 5S



### SOLAR

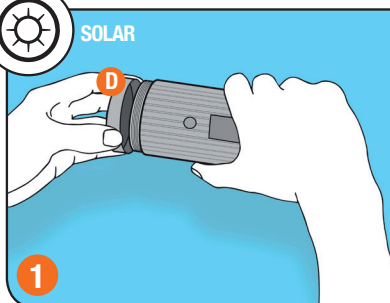

Unscrew end blanking cap and attach end cap with waterproof cable connector

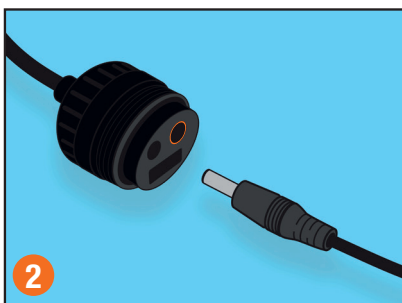

Connect solar panel to powermonkey expedition via the waterproof cable connector using the DC to DC cable

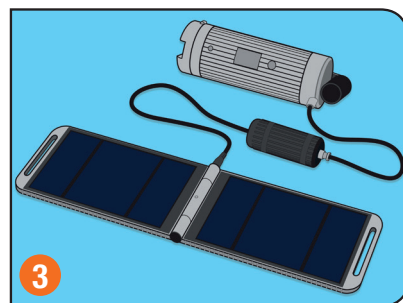

Fully charges expedition battery unit in 12-15 hours in optimum conditions



### AC MAINS

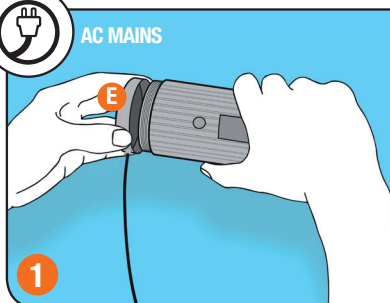

Unscrew end blanking cap and attach end cap with waterproof cable connector

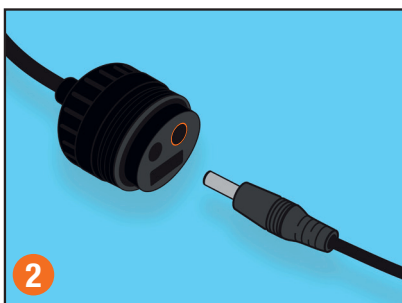

Select relevant AC plug head and connect the mains charger to the unit via the waterproof cable connector

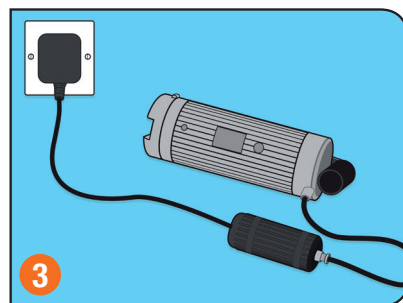

Fully charges expedition battery unit in 6-8 hours

# WATERPROOF CONNECTOR IP67

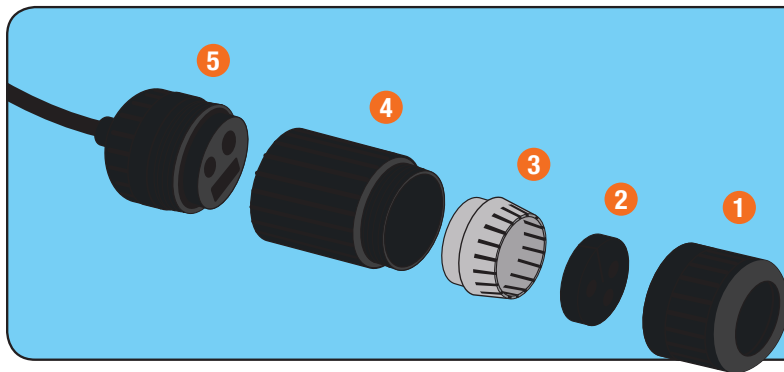

To assemble the IP67-rated waterproof connector first guide your cable through the outer ring (1), through the foam seal (2), into the plastic housing (3) and through the spacer housing (4) to connect to the appropriate input/output port (5). To complete the waterproof seal, screw the spacer housing (4) to the output socket (5), slide the foam seal (2) into the plastic housing (3) and both into the spacer housing (4) before screwing on the outer ring (1)

## YOU CAN CHARGE:

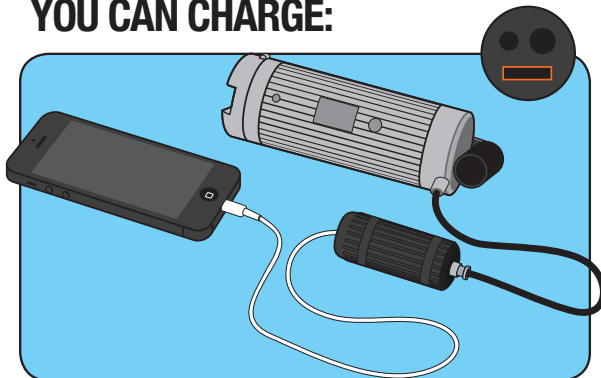

**Via 5V USB:** iPads, smartphones, sports watches, satellite phones, two-way radios, GPS and more

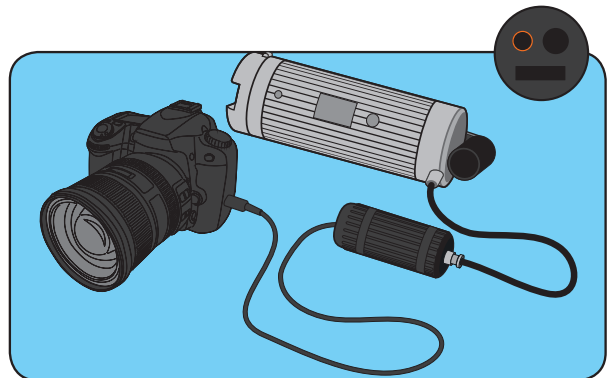

**Via 12V DC:** SLR cameras, heavy duty torches/head lamps and more. A female in-car charger is supplied for 12V devices that require an in-car charging connection

## LCD SCREEN

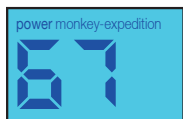

Tap on/off button to display level of charge remaining

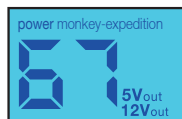

Hold on/off button down for 3 seconds to turn unit on

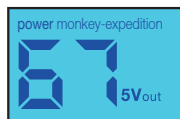

Once unit is on, tap on/off button to turn off 12V output if desired

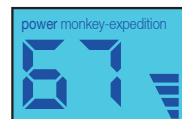

Bars show the amount of power being generated



Hold on/off button down to turn unit off when not in use



Designed and developed in the UK



Engineered and made in China

### POWERTRAVELLER LIMITED

Ceratech House, Omega Park,  
Wilsom Road, Alton, Hampshire  
GU34 2QE, UK  
t +44 (0) 1420 542980  
info@powertraveller.com  
www.powertraveller.com

Tips and other Powertraveller products can be purchased from  
[www.powertraveller.com](http://www.powertraveller.com)

For customer support, email us at support@powertraveller.com

Please note: the powermonkey expedition is patent pending (application made in 2014). All brands and trademarks belong to their respective owners.

iPad, iPhone and iPod are trademarks of Apple Inc., registered in the U.S. and other countries.

"Made for iPod," "Made for iPhone," and "Made for iPad" mean that an electronic accessory has been designed to connect specifically to iPod, iPhone, or iPad, respectively, and has been certified by the developer to meet Apple performance standards. Apple is not responsible for the operation of this device or its compliance with safety and regulatory standards. Please note that the use of this accessory with iPod, iPhone, or iPad may affect wireless performance.

#### POWERMONKEY EXPEDITION PARAMETERS:

- Input: 5V-25V
- Output: 5V 2A and 12V 800mA
- Battery Chemical: Lithium Polymer
- Energy: 10,500mAh Lithium Polymer
- MPPT technology applied to enhance charging efficiency when using the solar panels
- LCD display
- Dimensions: 164 x 62 x 62 mm
- Weight: 913g (with hand crank)
- Short-circuit protection, overload protection, low voltage protection, anti-discharge

#### SOLARMONKEY EXPEDITION PARAMETERS:

- Output: 1A 5V
- Red LED light
- Weight: 410g
- Dimensions: 200x110x18mm (folded)

Bedienungsanleitung bitte von unserer website runterladen

Allez sur notre site internet afin de consulter le mode d'emploi

Visitate il nostro website per scaricare le istruzioni

Visita nuestra web para descargar el manual de usuario

Bezoek onze website om deze gebruikershandleiding te downloaden

[powertraveller.com/expedition](http://powertraveller.com/expedition)



**powertraveller**  
without boundaries™