



**FAG**

## SES517-L

### Plummer block housing

Split plummer block housing for various bearing designs. The SNV series will be replaced by the new SES series in 2022.

## Technical information

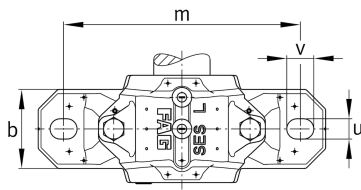

### Main Dimensions & Performance Data

D	150 mm	Outside diameter bearing
a	320 mm	Length base
h <sub>1</sub>	183 mm	Height
g	125 mm	Width housing body
K	61 mm	Width bearing seat
≈m	9.9 kg	Weight

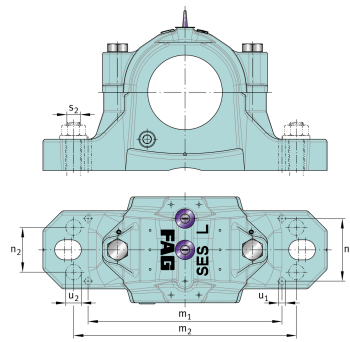
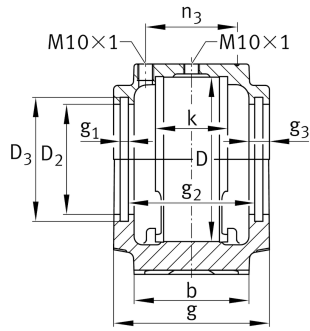
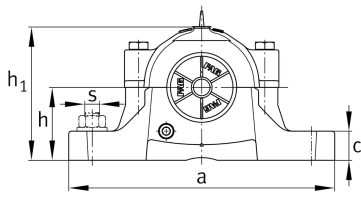

## Dimensions

b	90 mm	Width base
c	32 mm	Height base
h	95 mm	Base to shaft centerline height
m	260 mm	Distance fixing bore
s	19.05 mm	Screw size
s	M20	Size of fixing screws
u	22 mm	Width slot
v	28 mm	Length slot
D 2	97.5 mm	Diameter sealing
D 3	106 mm	Diameter sealing groove
D 5	103.7 mm	Outside diameter sealing labyrinth
g 1	5 mm	Width sealing groove
g 2	107 mm	Distance sealing
g 3	13 mm	Wall thickness
g 4	32 mm	Distance oil lubrication
m 1	220 mm	Distance holes aligned pins m1
n 3	80 mm	Distance lubrication
n 4	111 mm	Distance lubrication sealing
u 1	8 mm	Bore diameter u1
u 2	18 mm	Bore diameter u2