

Mizu-P25™ Miniature Waterproof Connectors 250 Volts Type

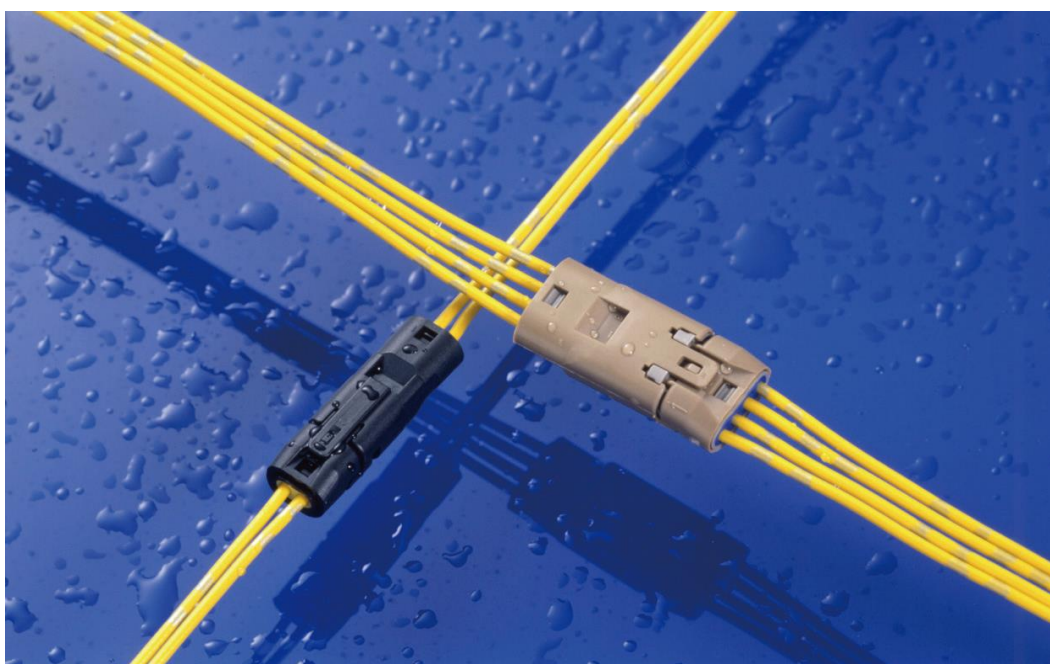

REV.	B2																		
SHEET	1-14																		
REVISE ON PC ONLY							TITLE: APPLICATION SPECIFICATION FOR 2.5 MINI WATERPROOF CONN.												
B2	REVISED 620884 2019/07/23 R.HORI																		
THIS DOCUMENT CONTAINS INFORMATION THAT IS PROPRIETARY TO MOLEX ELECTRONIC TECHNOLOGIES, LLC AND SHOULD NOT BE USED WITHOUT WRITTEN PERMISSION																			
REV.	DESCRIPTION																		
DESIGN CONTROL JTR					STATUS		WRITTEN BY: SINAOKA			CHECKED BY: SANDO			APPROVED BY: MAYAMAMOTO			DATE: 2011/12/01			
DOCUMENT NUMBER AS-52213-001							DOC. TYPE PS			DOC. PART 001			CUSTOMER GENERAL MARKET					SHEET 1 OF 14	
EN-127(2015-12)																			



APPLICATION SPECIFICATION

LANGUAGE

ENGLISH

REV.	REV. RECORD	DATE	EC NO.	WRTTN:	CH'K:
A	PROPOSED & RELEASED	2012/ 2/ 3	JTR2012-0053	SINAOKA	SANDO
A1	REVISED	2015/10/30	JTR2016-0041	YFUSHIMI	TAITO
B	REVISED	2016/ 5/13	JTR2016-0105	YFUSHIMI	TAITO
B1	REVISED	2016/ 8/ 5	107245	YFUSHIMI	TAITO
B2	REVISED	2019/07/23	620884	RHORI	HKOMATSU

REVISE ON PC ONLY

B2

SEE SHEET 1 OF 14

TITLE:

**APPLICATION SPECIFICATION
FOR 2.5 MINI WATERPROOF CONN.**THIS DOCUMENT CONTAINS INFORMATION THAT IS PROPRIETARY TO MOLEX ELECTRONIC
TECHNOLOGIES, LLC AND SHOULD NOT BE USED WITHOUT WRITTEN PERMISSION

REV.

DESCRIPTION

DOCUMENT NUMBER
AS-52213-001DOC. TYPE
PSDOC. PART
001CUSTOMER
GENERAL MARKETSHEET
2 OF 14

EN-127(2015-12)

SUMMARY**1.0 GENERAL PRESENTATION****1.1 PART NUMBERS****1.2 COMPONENTS****2.0 CONNECTOR ASSEMBLY PROCESS****2.1 TERMINALS CRIMPING****2.2 TERMINALS INSERTION****2.3 CAP LOCKING****2.4 MATING****2.5 UNMATING**

REVISE ON PC ONLY

B2

SEE SHEET 1 OF 14

TITLE:

**APPLICATION SPECIFICATION
FOR 2.5 MINI WATERPROOF CONN.**THIS DOCUMENT CONTAINS INFORMATION THAT IS PROPRIETARY TO MOLEX ELECTRONIC
TECHNOLOGIES, LLC AND SHOULD NOT BE USED WITHOUT WRITTEN PERMISSION

REV.

DESCRIPTION

DOCUMENT NUMBER

AS-52213-001

DOC. TYPE

PS

DOC. PART

001

CUSTOMER

GENERAL MARKET

SHEET

3 OF 14

1.0 GENERAL PRESENTATION

The plug and receptacle housings (hereinafter referred to as "housing assembly ") include a wire-end seal and are shipped in a pre-lock state, whereby the cap is not completely locked, but is held in a provisional state.

1.1 PART NUMBERS

DESCRIPTION	MOLEX P/N	COLOR
CONNECTOR		
Plug Housing Assembly 2way	52266-0211	Black
Plug Housing Assembly 3way	52266-0311	Black
Plug Housing Assembly 4way	52266-0411	Black
	52266-0417	Brown
Receptacle Housing Assembly 2way	52213-0211	Black
Receptacle Housing Assembly 3way	52213-0311	Black
Receptacle Housing Assembly 4way	52213-0411	Black
	52213-0417	Brown
TERMINAL		
Crimp Pin	50147-8*00	N / A
Crimp Receptacle	50148-8*00	N / A

REVISE ON PC ONLY

B2

SEE SHEET 1 OF 14

TITLE:

**APPLICATION SPECIFICATION
FOR 2.5 MINI WATERPROOF CONN.**

THIS DOCUMENT CONTAINS INFORMATION THAT IS PROPRIETARY TO MOLEX ELECTRONIC
TECHNOLOGIES, LLC AND SHOULD NOT BE USED WITHOUT WRITTEN PERMISSION

REV.

DESCRIPTION

DOCUMENT NUMBER
AS-52213-001

DOC. TYPE
PS

DOC. PART
001

CUSTOMER
GENERAL MARKET

SHEET
4 OF 14

1.2 COMPONENTS

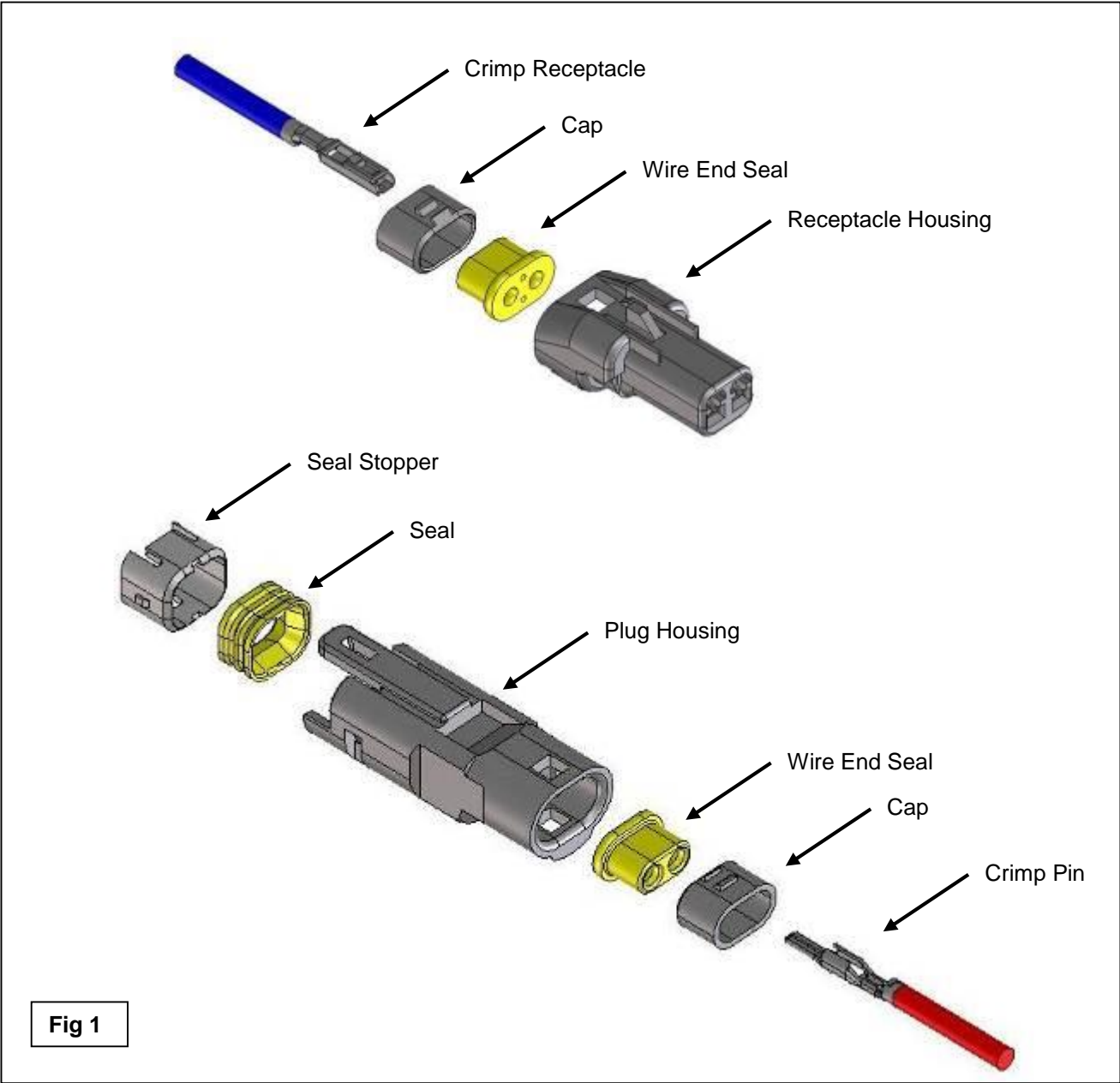

Fig 1

REVISE ON PC ONLY		TITLE: APPLICATION SPECIFICATION FOR 2.5 MINI WATERPROOF CONN.			
B2	SEE SHEET 1 OF 14				
REV.	DESCRIPTION	THIS DOCUMENT CONTAINS INFORMATION THAT IS PROPRIETARY TO MOLEX ELECTRONIC TECHNOLOGIES, LLC AND SHOULD NOT BE USED WITHOUT WRITTEN PERMISSION			
DOCUMENT NUMBER AS-52213-001		DOC. TYPE PS	DOC. PART 001	CUSTOMER GENERAL MARKET	SHEET 5 OF 14
EN-127(2015-12)					

2.0 CONNECTOR ASSEMBLY PROCESS

2.1 TERMINALS CRIMPING

Please refer to Molex Crimp Specifications [AS-50147-001].

2.2 TERMINALS INSERTION

WARNING:

BEFORE THE TERMINAL INSERTION, PLEASE MAKE SURE THAT THE CAPS LOCK IS IN PRE-LOCKED POSITION, THEREFORE THE YELLOW END WIRE SEAL IS VISIBLE.

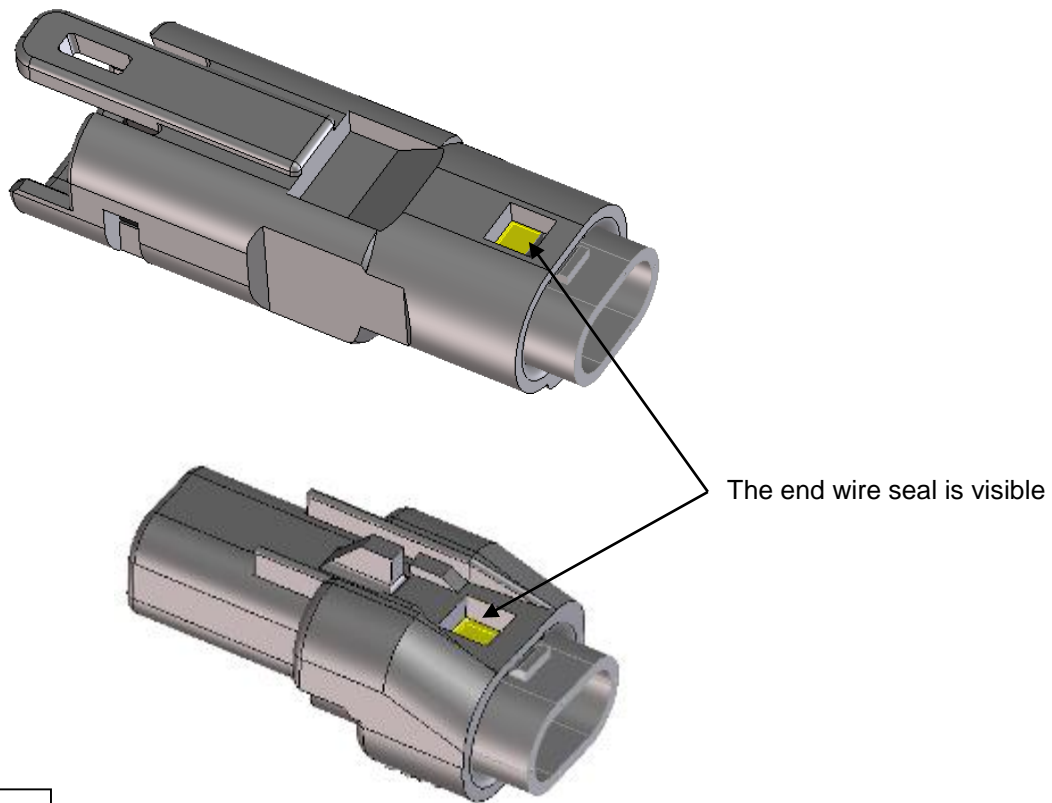
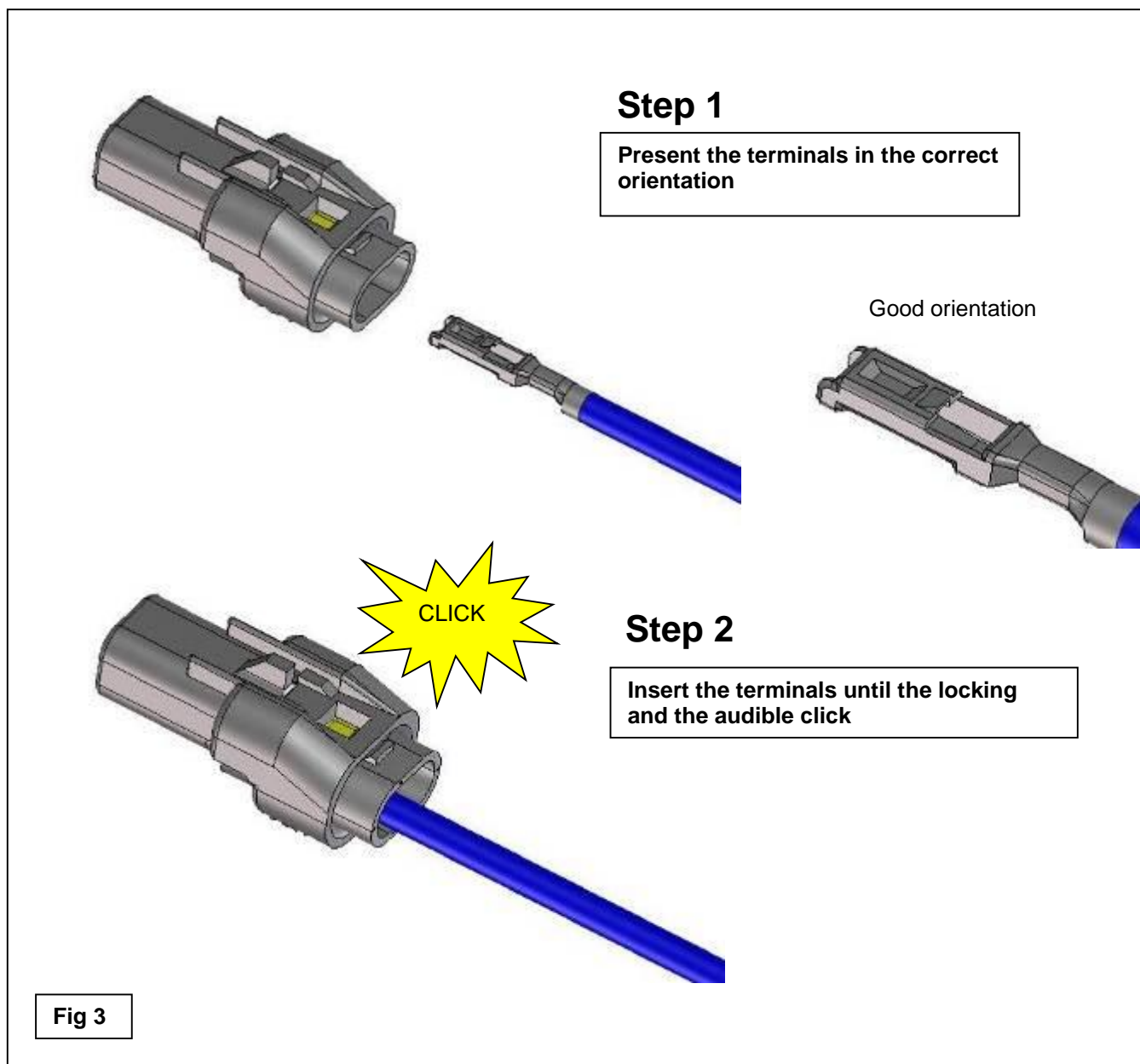

Fig 2

REVISE ON PC ONLY		TITLE: APPLICATION SPECIFICATION FOR 2.5 MINI WATERPROOF CONN.			
B2	SEE SHEET 1 OF 14				
REV.	DESCRIPTION	THIS DOCUMENT CONTAINS INFORMATION THAT IS PROPRIETARY TO MOLEX ELECTRONIC TECHNOLOGIES, LLC AND SHOULD NOT BE USED WITHOUT WRITTEN PERMISSION			
DOCUMENT NUMBER AS-52213-001		DOC. TYPE PS	DOC. PART 001	CUSTOMER GENERAL MARKET	SHEET 6 OF 14

With the housing assembly and terminal facing each other as below (Step1), proceed to insert terminal into the housing in the wire-end seal side until it locks into the housing assembly with a “click”. (Step2) If the terminal is in the reverse position, it will not lock. In this situation, reconfirm the proper position of the terminal and reinsert.



	REVISE ON PC ONLY		TITLE: APPLICATION SPECIFICATION FOR 2.5 MINI WATERPROOF CONN.			
	B2	SEE SHEET 1 OF 14				
	REV.	DESCRIPTION	THIS DOCUMENT CONTAINS INFORMATION THAT IS PROPRIETARY TO MOLEX ELECTRONIC TECHNOLOGIES, LLC AND SHOULD NOT BE USED WITHOUT WRITTEN PERMISSION			
DOCUMENT NUMBER AS-52213-001			DOC. TYPE PS	DOC. PART 001	CUSTOMER GENERAL MARKET	SHEET 7 OF 14
EN-127(2015-12)						

Step 1

Present the terminals in the correct orientation

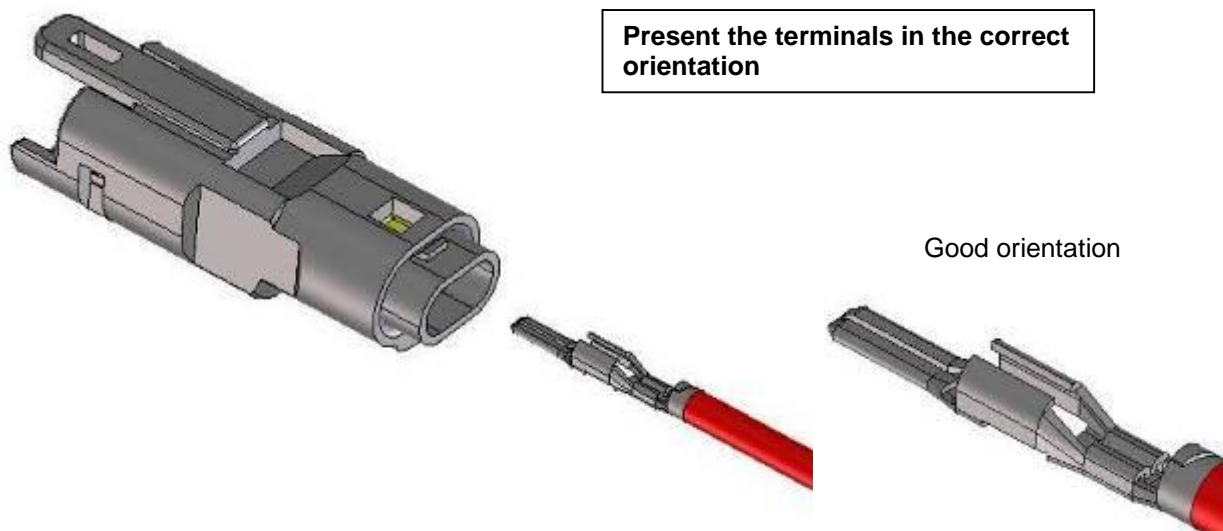
Step 2

Insert the terminals until the locking and the audible click

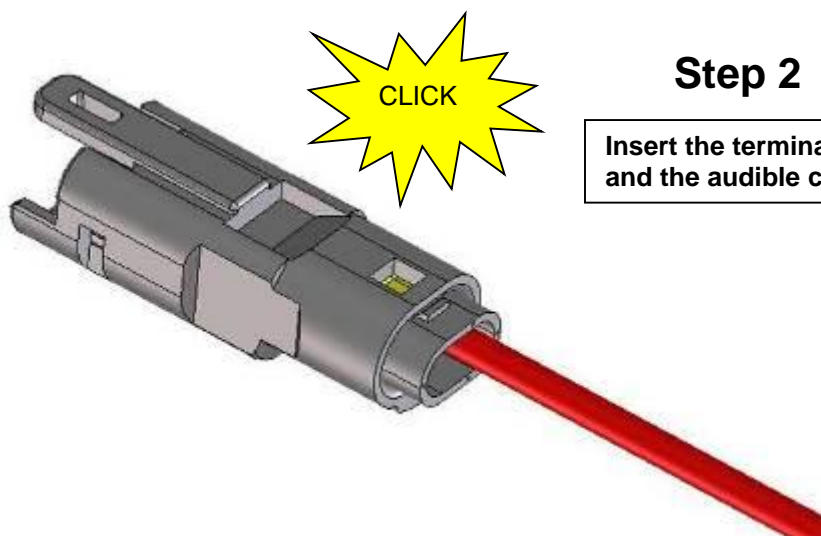
Fig 4

REVISE ON PC ONLY		TITLE: APPLICATION SPECIFICATION FOR 2.5 MINI WATERPROOF CONN.		
B2	SEE SHEET 1 OF 14			
REV.	DESCRIPTION	THIS DOCUMENT CONTAINS INFORMATION THAT IS PROPRIETARY TO MOLEX ELECTRONIC TECHNOLOGIES, LLC AND SHOULD NOT BE USED WITHOUT WRITTEN PERMISSION		
DOCUMENT NUMBER AS-52213-001		DOC. TYPE PS	DOC. PART 001	CUSTOMER GENERAL MARKET SHEET 8 OF 14

WARNING:

INSERT THE CRIMPED TERMINALS STRAIGHTLY INTO THE WIRE END SEAL OPENING. DO NOT TWIST OR SLANT THE CRIMPED TERMINALS WHEN INSERTING. WHEN THE TERMINAL SEEMS TO BE CAUGHT DURING INSERTION, DO NOT FORCE THE TERMINALS INTO THE HOUSING AND INSERT THE TERMINAL AGAIN. IF TERMINALS ARE FORCED IN, IT COULD CAUSE THE SEALING TO TEAR.

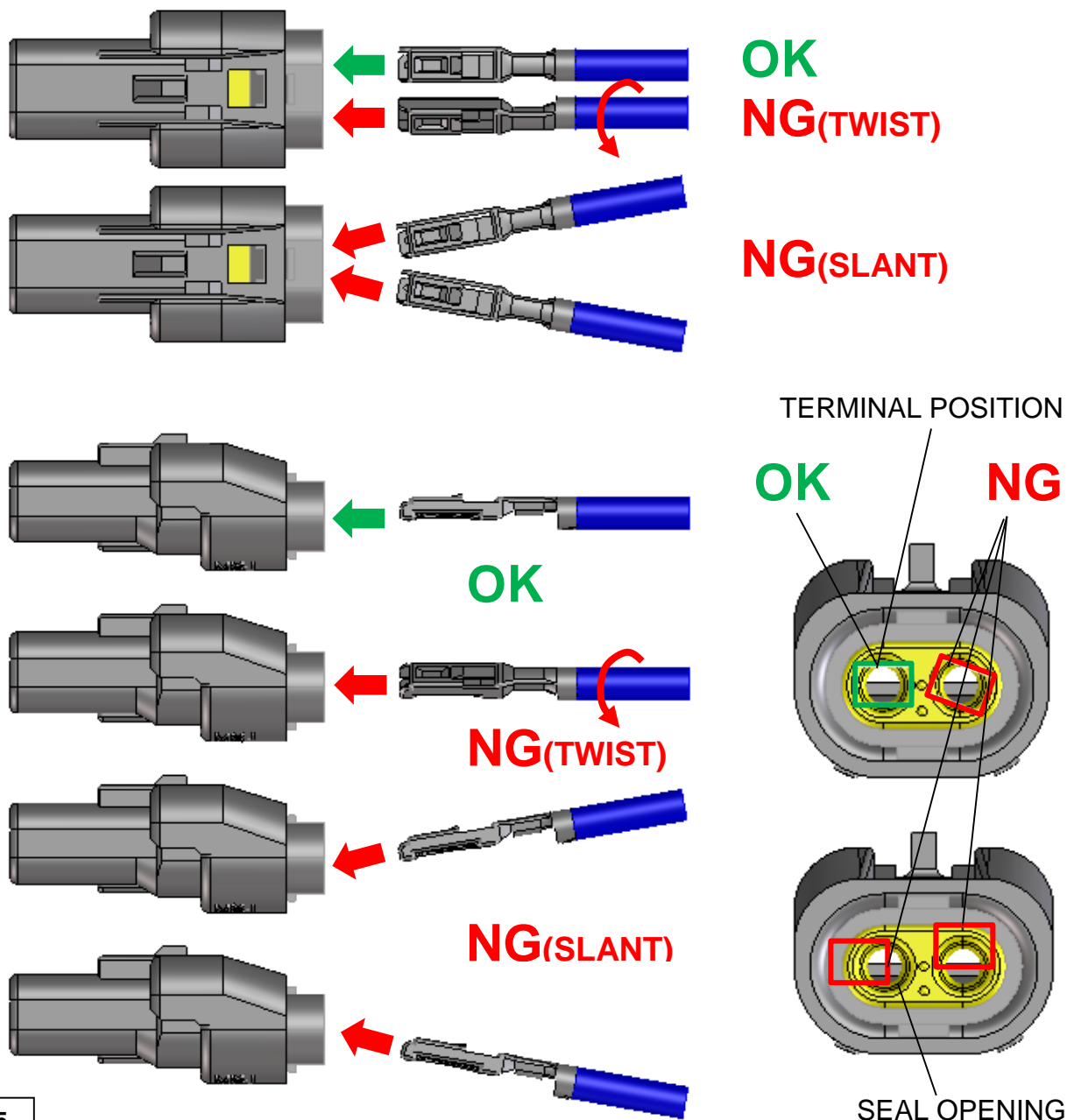

Fig 5

REVISE ON PC ONLY

B2

SEE SHEET 1 OF 14

REV.

DESCRIPTION

TITLE:

**APPLICATION SPECIFICATION
FOR 2.5 MINI WATERPROOF CONN.**

THIS DOCUMENT CONTAINS INFORMATION THAT IS PROPRIETARY TO MOLEX ELECTRONIC TECHNOLOGIES, LLC AND SHOULD NOT BE USED WITHOUT WRITTEN PERMISSION

DOCUMENT NUMBER
AS-52213-001

DOC. TYPE
PS

DOC. PART
001

CUSTOMER
GENERAL MARKET

SHEET
9 OF 14

2.3 CAP LOCKING

After confirming the proper position of the terminal, push the cap in the direction of the arrow. Using the splash-proof connector cap tool, the cap will lock securely and easily. See Housing Assembly/Cap Fitting Tool Cross Reference Table.

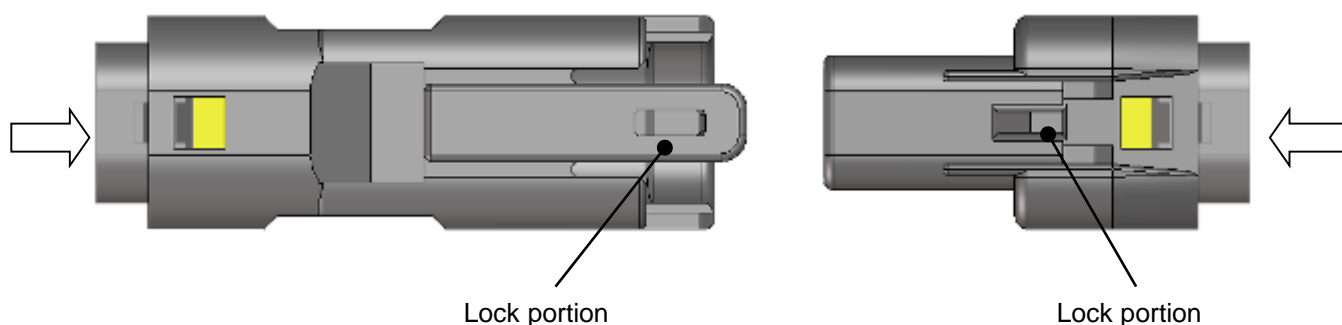
**Fig 6**

Housing Assembly/Cap Fitting Tool Cross Reference

Housing Assembly	Cap Fitting Tool	Note
52266-02**	---	---
52266-0***	57147-6000	(Wire Type) AVSS0.3
52266-0***	57170-6000	(Wire Type) AVS0.3
52213-02**	---	---
52213-0***	57148-6000	(Wire Type) AVSS0.3
52213-0***	57171-6000	(Wire Type) AVS0.3
52116-0***	57130-6000	---
52117-0***	57131-6000	---

REVISE ON PC ONLY

B2

SEE SHEET 1 OF 14

TITLE:

**APPLICATION SPECIFICATION
FOR 2.5 MINI WATERPROOF CONN.**

THIS DOCUMENT CONTAINS INFORMATION THAT IS PROPRIETARY TO MOLEX ELECTRONIC TECHNOLOGIES, LLC AND SHOULD NOT BE USED WITHOUT WRITTEN PERMISSION

REV.

DESCRIPTION

DOCUMENT NUMBER
AS-52213-001

DOC. TYPE
PS

DOC. PART
001

CUSTOMER
GENERAL MARKET

SHEET
10 OF 14

When the cap locks completely, the cap lock portion will show in the lock window (reverse side). If only one side is locked, water resistance may be compromised.

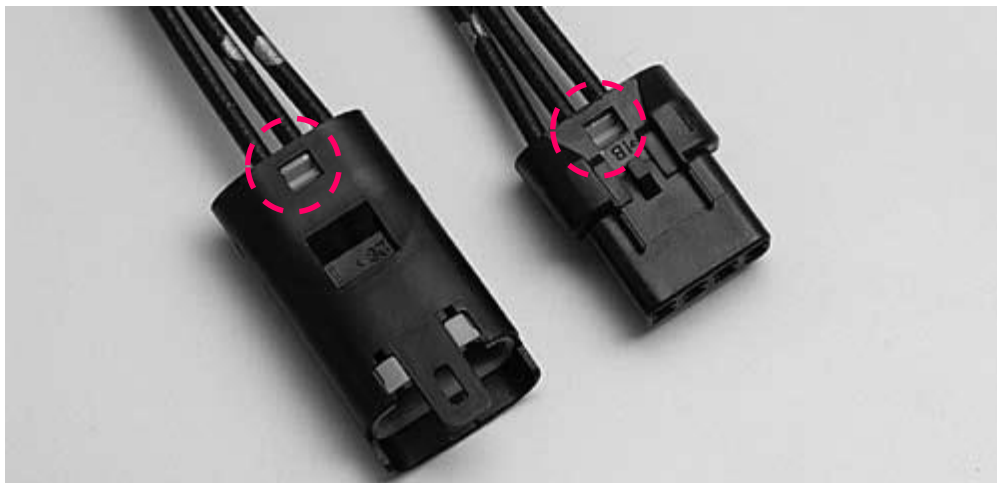
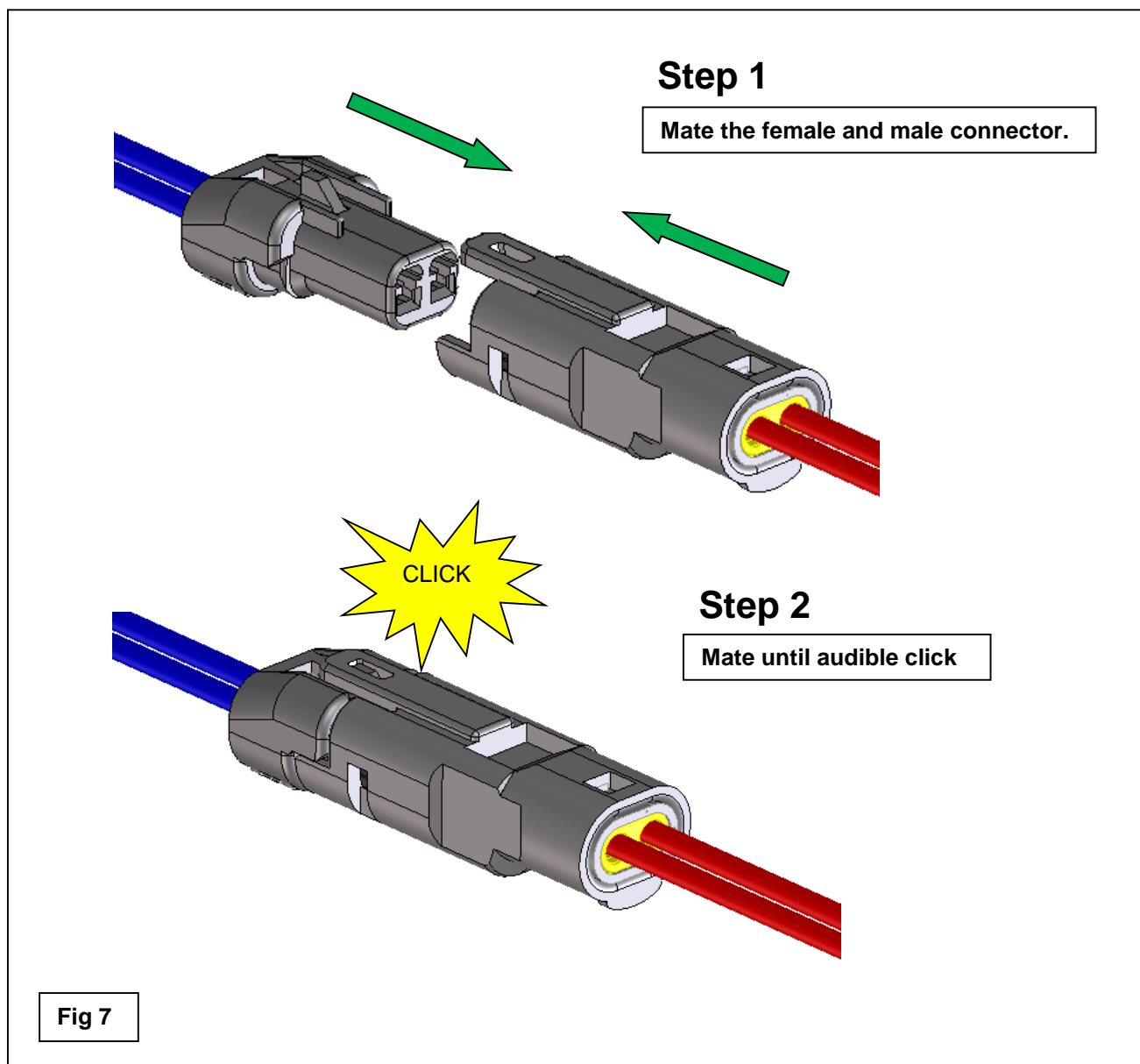

Photo 1

	REVISE ON PC ONLY		TITLE: APPLICATION SPECIFICATION FOR 2.5 MINI WATERPROOF CONN.			
	B2	SEE SHEET 1 OF 14				
	REV.	DESCRIPTION	THIS DOCUMENT CONTAINS INFORMATION THAT IS PROPRIETARY TO MOLEX ELECTRONIC TECHNOLOGIES, LLC AND SHOULD NOT BE USED WITHOUT WRITTEN PERMISSION			
DOCUMENT NUMBER AS-52213-001			DOC. TYPE PS	DOC. PART 001	CUSTOMER GENERAL MARKET	SHEET 11 OF 14
EN-127(2015-12)						

2.4 MATING

Join the lock portion of the plug and receptacle housings (Fig 7). Continue mating until a “click” is felt or heard.



REVISE ON PC ONLY		TITLE: APPLICATION SPECIFICATION FOR 2.5 MINI WATERPROOF CONN.		
B2	SEE SHEET 1 OF 14			
REV.	DESCRIPTION	THIS DOCUMENT CONTAINS INFORMATION THAT IS PROPRIETARY TO MOLEX ELECTRONIC TECHNOLOGIES, LLC AND SHOULD NOT BE USED WITHOUT WRITTEN PERMISSION		
DOCUMENT NUMBER AS-52213-001		DOC. TYPE PS	DOC. PART 001	CUSTOMER GENERAL MARKET SHEET 12 OF 14

2.5 UNMATING

Use a tool like a screwdriver (end portion 2 mm) or similar tool. Insert tip into the plug housing side-lock portion (Step 1), lift (Step 2), pull out the receptacle housing circuit and unmate (Step 3).

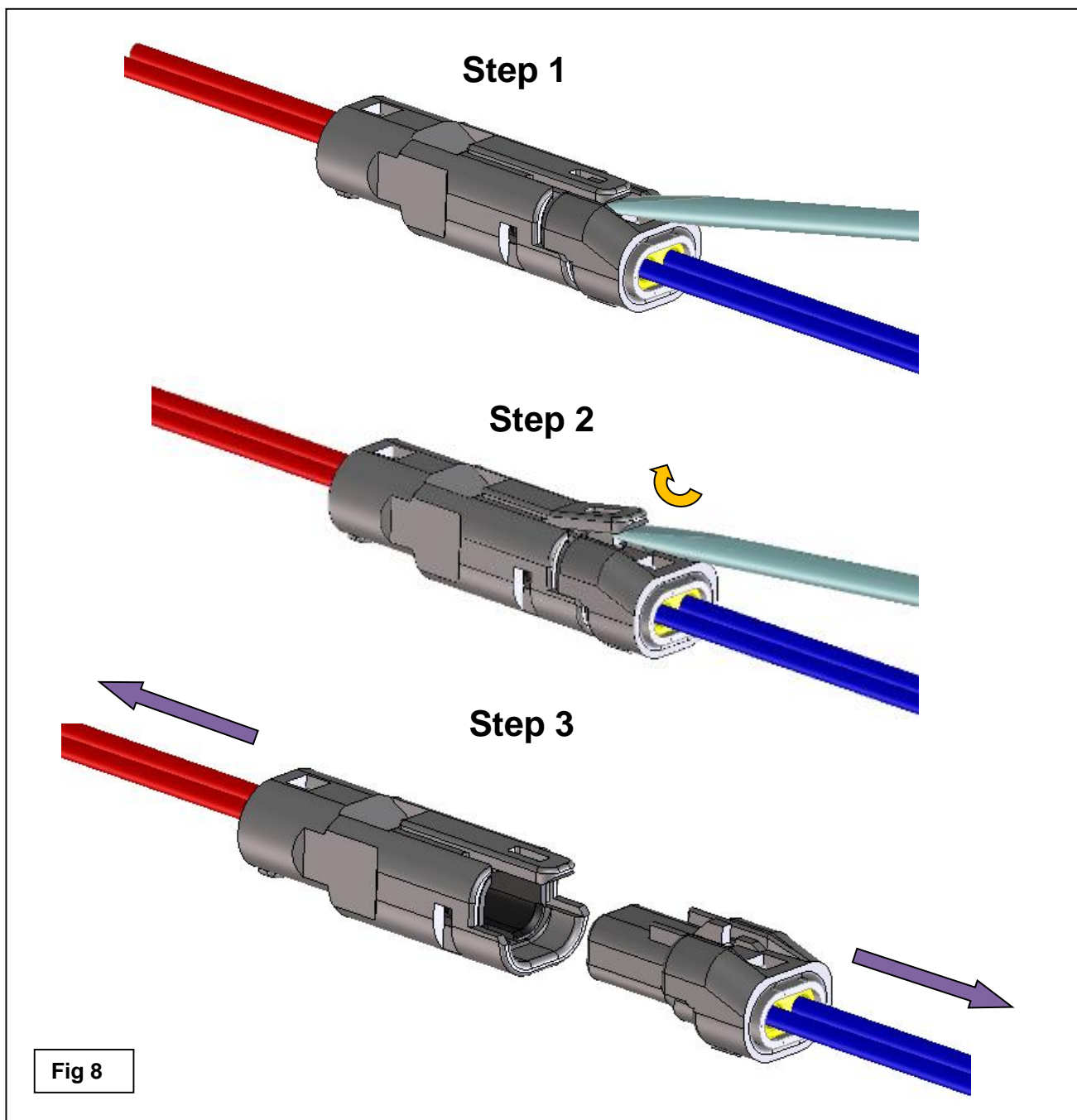

REVISE ON PC ONLY

B2

SEE SHEET 1 OF 14

REV.

DESCRIPTION

TITLE:

**APPLICATION SPECIFICATION
FOR 2.5 MINI WATERPROOF CONN.**

THIS DOCUMENT CONTAINS INFORMATION THAT IS PROPRIETARY TO MOLEX ELECTRONIC TECHNOLOGIES, LLC AND SHOULD NOT BE USED WITHOUT WRITTEN PERMISSION

DOCUMENT NUMBER
AS-52213-001

DOC. TYPE
PS

DOC. PART
001

CUSTOMER
GENERAL MARKET

SHEET
13 OF 14

Care is needed not to lift the lock portion more than necessary. "Do not lift more than twice the height of the lock portion" is a convenient yardstick to use (Fig 9). If lifted any more than this, it will not be able to return to its original position, resulting in either a reduced latch effect or break.

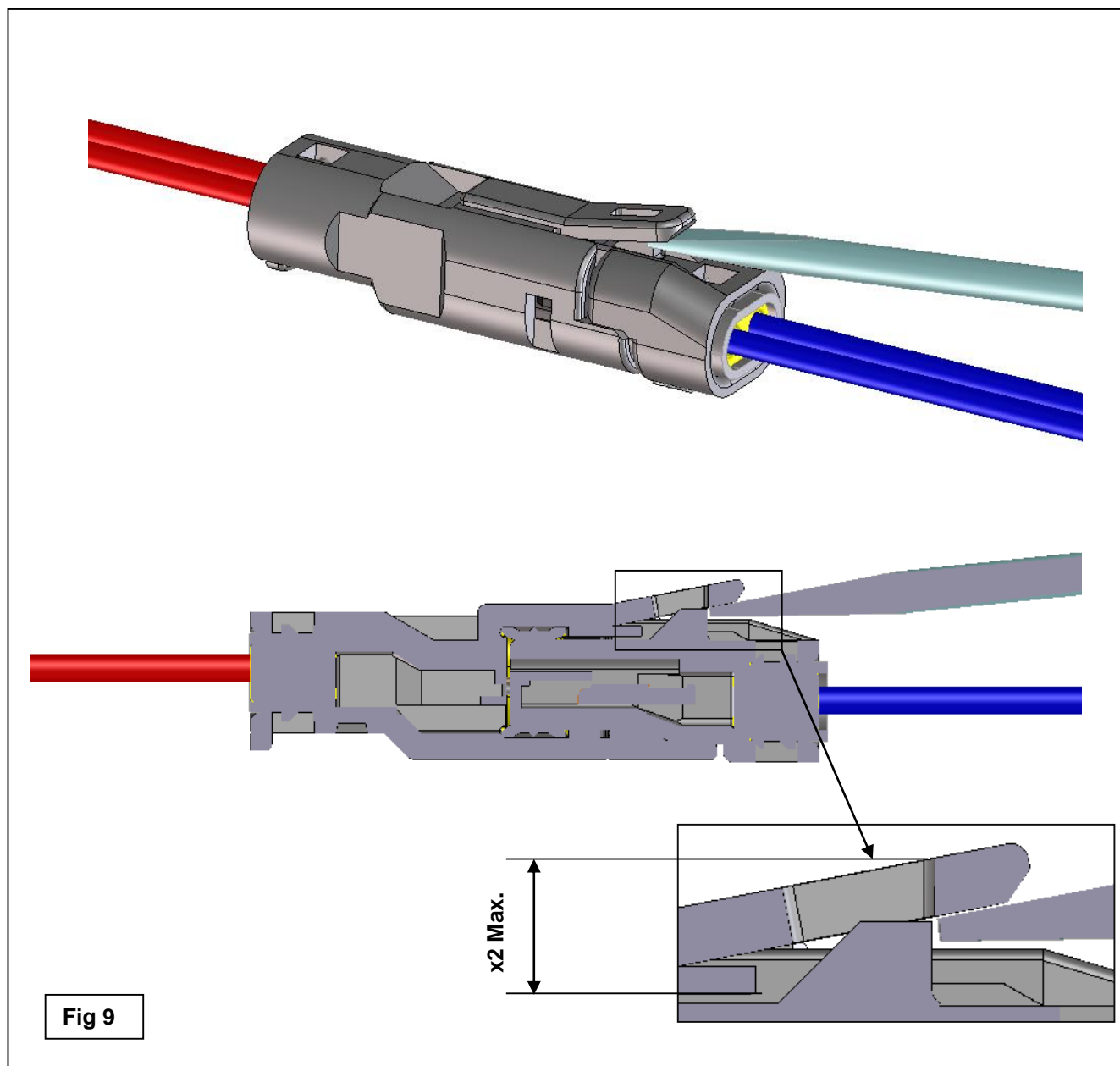
Fig 9

REVISE ON PC ONLY		TITLE: APPLICATION SPECIFICATION FOR 2.5 MINI WATERPROOF CONN.		
B2	SEE SHEET 1 OF 14			
REV.	DESCRIPTION	THIS DOCUMENT CONTAINS INFORMATION THAT IS PROPRIETARY TO MOLEX ELECTRONIC TECHNOLOGIES, LLC AND SHOULD NOT BE USED WITHOUT WRITTEN PERMISSION		
DOCUMENT NUMBER AS-52213-001		DOC. TYPE PS	DOC. PART 001	CUSTOMER GENERAL MARKET
				SHEET 14 OF 14