

KEY901

Key for Locks HRL, IRL, SRL, WRL, WIRL

LORLIN

LOCK SWITCH

SRL

SRL LOCK SWITCH

ELECTRICAL & MECHANICAL SPECIFICATION

| | | | |
|-------------------------------|--|-------------------------------|-----------------------------|
| Switch Rating: | 1A @24V ac/dc | Life: | >10,000 Cycles |
| Proof Voltage: | 750 Vac (Initial) | Lock Type: | S Disc |
| Insulation Resistance: | >999MΩ @ 500Vdc (Initial) | Operating Temperature: | -20°C to +65°C |
| Contact Resistance: | <20mΩ (Initial) | Lock Housing: | Zinc Alloy Bright Cr Plated |
| Contact Material: | Brass CZ108, Ag Plated | Moulding Material: | Polyamide 6.6 G.F. V0 Rated |
| Moulding Colour: | Single pole – Natural, Double pole - Black | | |

FEATURES

| | | |
|---------------------------|---|---|
| Front assembly | 2 keys per switch | Moulded bezel available for parallel lock headed version (SRLD2101 see below) |
| Single or Double pole | Up to 200 differ key combinations available | Made In UK |
| Rear panel depth <30mm | Keys are double entry (can be inserted into lock either way up) | |
| Max panel thickness 4.5mm | | |



SINGLE POLE LOCK SWITCH

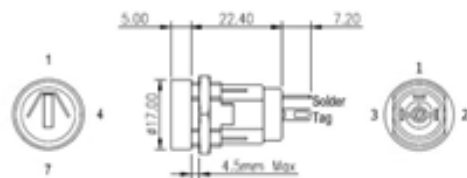

Key Withdrawal Positions

PARALLEL LOCK HEAD 90° INDEXING

| BASIC PART No. | TOTAL MOVEMENT | INDEXING | KEY WITHDRAWAL POSITIONS | SWITCH CONFIGURATION |
|----------------|----------------|----------|--------------------------|----------------------|
| SRL-5-A | 90° | 90° | 1,4 | |
| SRL-5-B | 90° | 90° | 1 ONLY | |
| SRL-5-C | 180° | 90° | 1,4,7 | |
| SRL-5-R | 180° | 90° | 1,4 | |
| SRL-5-S | 180° | 90° | 1 ONLY | |
| SRL-5-N | 180° | 90° | 1,4,7 | |

SINGLE POLE LOCK SWITCH

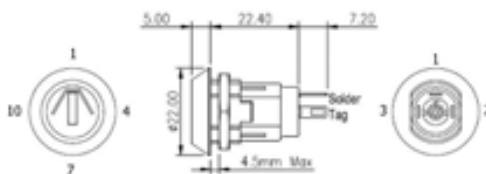

Key Withdrawal Positions

Types T,Q and X. For centre off link terminals 1 & 3

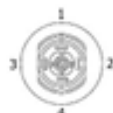

TAPERED LOCK HEAD 90° INDEXING

| BASIC PART No. | TOTAL MOVEMENT | INDEXING | KEY WITHDRAWAL POSITIONS | SWITCH CONFIGURATION |
|----------------|----------------|----------|--------------------------|----------------------|
| SRL-5-D | 90° 1-4 | 90° | 1,4 | |
| SRL-5-E | 90° 1-4 | 90° | 1 ONLY | |
| SRL-5-F | 180° 1-7 | 90° | 1,4,7 | |
| SRL-5-V | 180° 1-7 | 90° | 1,4 | |
| SRL-5-W | 180° 1-7 | 90° | 1 ONLY | |
| SRL-5-P | 180° 1-7 | 90° | 1,4,7 | |
| SRL-5-T | 180° 1-7 | 90° | 1,4,7 | |
| SRL-5-Q | 180° 1-7 | 90° | 4 ONLY | |
| SRL-5-X | 180° 10-4 | 90° | 1 ONLY | |

DOUBLE POLE LOCK SWITCH

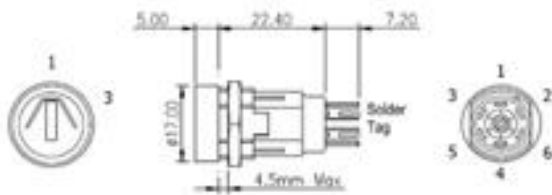

Key Withdrawal Positions

PARALLEL LOCK HEAD 60° INDEXING

| BASIC PART No. | TOTAL MOVEMENT | INDEXING | KEY WITHDRAWAL POSITIONS | SWITCH CONFIGURATION |
|----------------|----------------|----------|--------------------------|----------------------|
| SRL-5-J | 60° | 60° | 1,3 | |
| SRL-5-K | 60° | 60° | 1 ONLY | |

DOUBLE POLE LOCK SWITCH

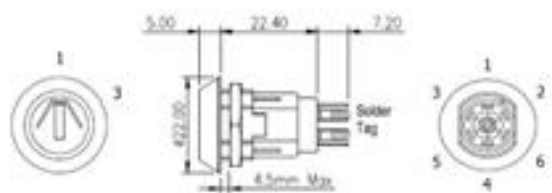

Key Withdrawal Positions

TAPERED LOCK HEAD 60° INDEXING

| BASIC PART No. | TOTAL MOVEMENT | INDEXING | KEY WITHDRAWAL POSITIONS | SWITCH CONFIGURATION |
|----------------|----------------|----------|--------------------------|----------------------|
| SRL-5-L | 60° | 60° | 1,3 | |
| SRL-5-M | 60° | 60° | 1 ONLY | |

OPTIONAL MOULDED BEZEL

FOR PARALLEL LOCK HEADED VERSIONS
PART NUMBER SRL02101

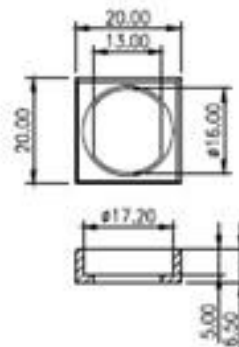

SRL ORDERING CODE

S R L - 5 - [] - [] - 2

| | | |
|-----------------------|---|---|
| STYLE A - X | KEYS: S = Same key number (901) D = Differs (200 differs available) | NUMBER OF KEYS (2 is standard) |
|-----------------------|---|---|

LOCK SWITCH

IRL IMPULSION LOCK SWITCH 2 & 3 POSITION

ELECTRICAL & MECHANICAL SPECIFICATION

| | | | |
|-------------------------------|---------------------------|-------------------------------|-----------------------------|
| Switch Rating: | 1A @24V ac/dv | Life: | >10,000 Cycles |
| Proof Voltage: | 750 Vac (Initial) | Lock Type: | 5 Disc |
| Insulation Resistance: | >999MΩ @ 500Vdc (Initial) | Operating Temperature: | -20°C to +65°C |
| Contact Resistance: | <20mΩ (Initial) | Lock Housing: | Zinc Alloy Bright Cr Plated |
| Contact Material: | Brass CZ108, Ag Plated | Moulding Material: | Polyamide 6.6 G.F. V0 Rated |

FEATURES

| | | |
|--------------------------|-------------------------|--|
| Spring return | Front assembly | 2 keys per switch, up to 200 differ key combinations available |
| Double Pole DPST | Moulded bezel available | Keys can be inserted either way up |
| Rear panel depth - <30mm | Made in UK | Master key versions to order |
| Single Pole SPDT | | |
| Rear panel depth - <35mm | | |



DOUBLE POLE LOCK SWITCH

Parallel lock head 60° indexing Spring Return 2 Pole 2 Position

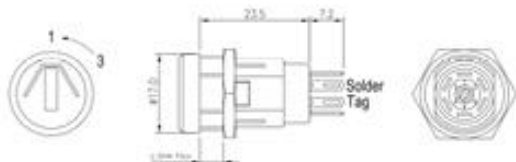

PARALLEL LOCK HEAD 60° INDEXING

| BASIC PART No. | TOTAL MOVEMENT | INDEXING | KEY WITHDRAWAL POSITIONS | SWITCH CONFIGURATION |
|----------------|----------------|----------|--------------------------|----------------------|
| IRL-5-K | 60° | 60° | 1 ONLY | |

DOUBLE POLE LOCK SWITCH

Tapered lock head 60° indexing Spring Return 2 Pole 2 Position

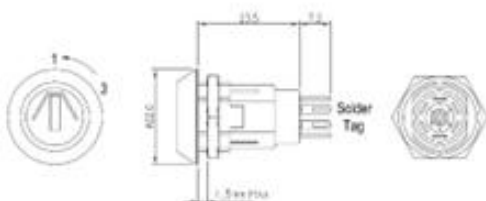

TAPERED LOCK HEAD 60° INDEXING

| BASIC PART No. | TOTAL MOVEMENT | INDEXING | KEY WITHDRAWAL POSITIONS | SWITCH CONFIGURATION |
|----------------|----------------|----------|--------------------------|----------------------|
| IRL-5-M | 60° | 60° | 1 ONLY | |

SINGLE POLE 3 POSITION

Available in three versions:-

Type L - Left spring return with latching to the right.

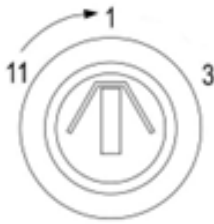

Type D - Double spring return.

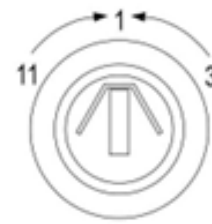

Type R - Right spring return with latching to the left.

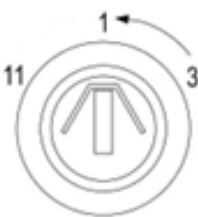

Type R Alternate mounting

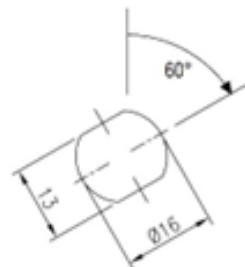

SINGLE POLE LOCK SWITCH

Tapered lock head 60° indexing Spring Return 1 Pole 3 Position

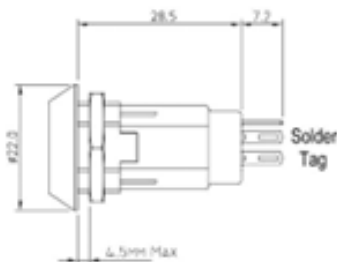

TAPERED LOCK HEAD 60° INDEXING

| BASIC PART No. | TOTAL MOVEMENT | INDEXING | KEY WITHDRAWAL POSITIONS | SWITCH CONFIGURATION |
|----------------|----------------|----------|--------------------------|----------------------|
| IRL-5-L | 120° | 60° | 1, 3 | |
| IRL-5-D | 120° | 60° | 1 ONLY | |
| IRL-5-R | 120° | 60° | 11, 1 | |

IRL - 5 - [] - [] - 2

STYLE
D - R

KEYS:
S = Same key number (901)
D = Differs (200 differs available)

NUMBER OF KEYS
(2 is standard)

LOCK SWITCH

HRL LOCK SWITCH

ELECTRICAL & MECHANICAL SPECIFICATION

| | | | |
|-------------------------------|---|-------------------------------|-----------------------------|
| Switch Rating: | 1A @24V ac/dc | Life: | >10,000 Cycles |
| Proof Voltage: | 750 Vac (Initial) | Lock Type: | 5 Disc |
| Insulation Resistance: | >999MΩ @ 500Vdc (Initial) | Operating Temperature: | -20°C to +65°C |
| Contact Resistance: | <20mΩ (Initial) | Lock Housing: | Zinc Alloy Bright Cr Plated |
| Contact Material: | Brass CZ108, Ag Plated | Moulding Material: | Polyamide 6.6 G.F. V0 Rated |
| Moulding Colour: | Single pole – Grey, Double pole - Green | | |

FEATURES

Reinforced module to lock connection for higher vibration or weight applications

| | | |
|---------------------------|---|---|
| Front assembly | 2 keys per switch | Moulded bezel available for parallel lock headed version (SRLD2101 see below) |
| Single or Double pole | Up to 200 differ key combinations available | Made In UK |
| Rear panel depth <30mm | Keys are double entry (can be inserted into lock either way up) | |
| Max panel thickness 4.5mm | | |



SINGLE POLE LOCK SWITCH

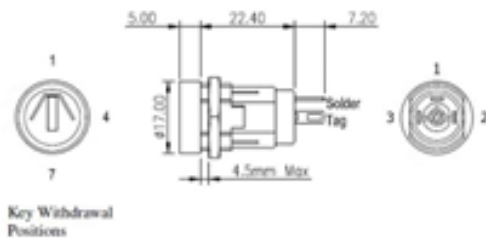

PARALLEL LOCK HEAD 90° INDEXING

| BASIC PART No. | TOTAL MOVEMENT | INDEXING | KEY WITHDRAWAL POSITIONS | SWITCH CONFIGURATION |
|----------------|----------------|----------|--------------------------|----------------------|
| HRL-5-A | 90° | 90° | 1,4 | |
| HRL-5-B | 90° | 90° | 1 ONLY | |
| HRL-5-C | 180° | 90° | 1,4,7 | |
| HRL-5-R | 180° | 90° | 1,4 | |
| HRL-5-S | 180° | 90° | 1 ONLY | |
| HRL-5-N | 180° | 90° | 1,4,7 | |

SINGLE POLE LOCK SWITCH

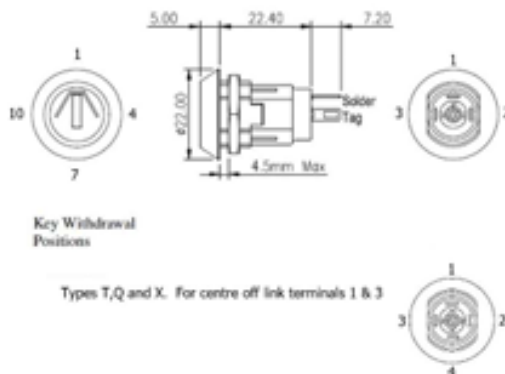

TAPERED LOCK HEAD 90° INDEXING

| BASIC PART No. | TOTAL MOVEMENT | INDEXING | KEY WITHDRAWAL POSITIONS | SWITCH CONFIGURATION |
|----------------|----------------|----------|--------------------------|----------------------|
| HRL-5-D | 90° 1-4 | 90° | 1,4 | |
| HRL-5-E | 90° 1-4 | 90° | 1 ONLY | |
| HRL-5-F | 180° 1-7 | 90° | 1,4,7 | |
| HRL-5-V | 180° 1-7 | 90° | 1,4 | |
| HRL-5-W | 180° 1-7 | 90° | 1 ONLY | |
| HRL-5-P | 180° 1-7 | 90° | 1,4,7 | |
| HRL-5-T | 180° 1-7 | 90° | 1,4,7 | |
| HRL-5-Q | 180° 1-7 | 90° | 4 ONLY | |
| HRL-5-X | 180° 10-4 | 90° | 1 ONLY | |

DOUBLE POLE LOCK SWITCH

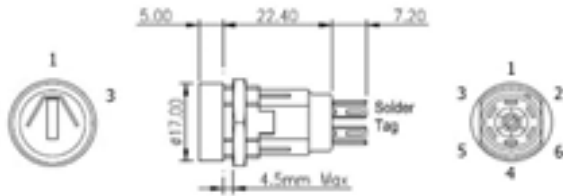

Key Withdrawal Positions

PARALLEL LOCK HEAD 60° INDEXING

| BASIC PART No. | TOTAL MOVEMENT | INDEXING | KEY WITHDRAWAL POSITIONS | SWITCH CONFIGURATION |
|----------------|----------------|----------|--------------------------|----------------------|
| HRL-5-J | 60° | 60° | 1,3 | |
| HRL-5-K | 60° | 60° | 1 ONLY | |

DOUBLE POLE LOCK SWITCH

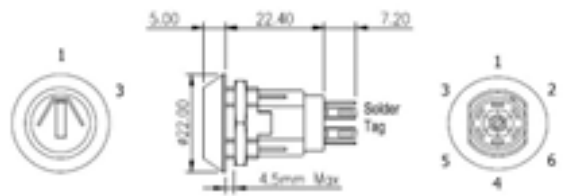

Key Withdrawal Positions

TAPERED LOCK HEAD 60° INDEXING

| BASIC PART No. | TOTAL MOVEMENT | INDEXING | KEY WITHDRAWAL POSITIONS | SWITCH CONFIGURATION |
|----------------|----------------|----------|--------------------------|----------------------|
| HRL-5-L | 60° | 60° | 1,3 | |
| HRL-5-M | 60° | 60° | 1 ONLY | |

OPTIONAL MOULDED BEZEL

FOR PARALLEL LOCK HEADED VERSIONS

PART NUMBER SRL02101

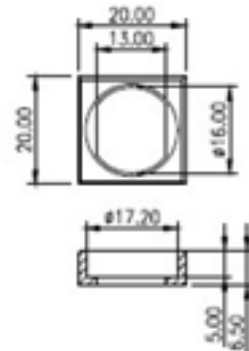

HRL ORDERING CODE

H R L - 5 - [] - [] - 2

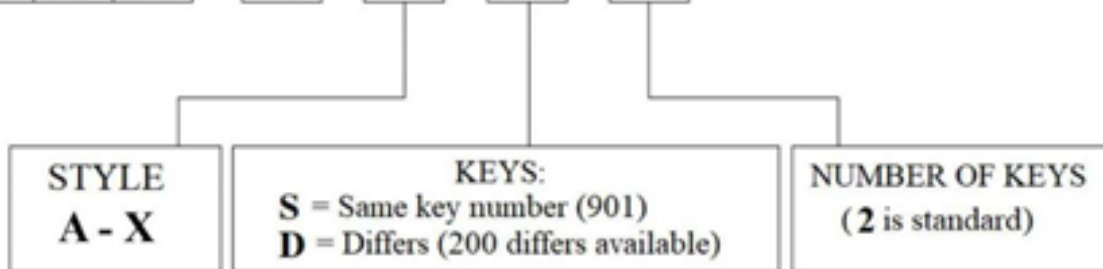

LOCK SWITCH

WRL IP66/IP67 SEALED LOCK SWITCH

ELECTRICAL & MECHANICAL SPECIFICATION

| | | | |
|-------------------------------|---|-------------------------------|-----------------------------|
| Switch Rating: | 1A @24V dc | Life: | >10,000 Cycles |
| Proof Voltage: | 750 Vac (Initial) | Lock Type: | 5 Disc |
| Insulation Resistance: | >999MΩ @ 500Vdc (Initial) | Operating Temperature: | -20°C to +65°C |
| Contact Resistance: | <20mΩ (Initial) | Lock Housing: | Zinc Alloy Bright Cr Plated |
| Contact Material: | Brass CZ108, Ag Plated | Moulding Material: | Polyamide 6.6 G.F. V0 Rated |
| Moulding Colour: | Single pole – Grey, Double pole - Green | | |

FEATURES

Suitable for Marine Environment Exposure to Severity One (EN60068-2-52) salt mist tested

- Front assembly
- Single or Double pole
- Max panel thickness 3.5mm
- Rear panel depth - <30mm
- Made in UK
- 2 keys per switch
- Up to 200 differ key combinations available
- Keys are double entry (can be inserted into lock either way up)

Oil regularly if used outside

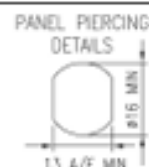

SINGLE POLE LOCK SWITCH

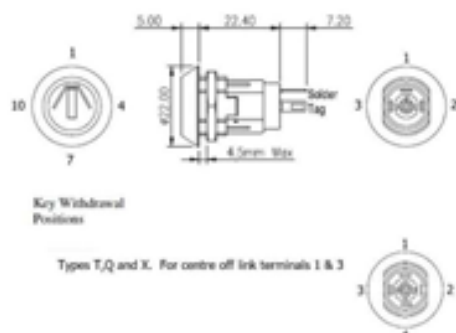

TAPERED LOCK HEAD 90° INDEXING

| BASIC PART No. | TOTAL MOVEMENT | INDEXING | KEY WITHDRAWAL POSITIONS | SWITCH CONFIGURATION |
|----------------|----------------|----------|--------------------------|----------------------|
| WRL-5-D | 90° 1-4 | 90° | 1,4 | |
| WRL-5-E | 90° 1-4 | 90° | 1 ONLY | |
| WRL-5-F | 180° 1-7 | 90° | 1,4,7 | |
| WRL-5-V | 180° 1-7 | 90° | 1,4 | |
| WRL-5-W | 180° 1-7 | 90° | 1 ONLY | |
| WRL-5-P | 180° 1-7 | 90° | 1,4,7 | |
| WRL-5-T | 180° 1-7 | 90° | 1,4,7 | |
| WRL-5-Q | 180° 1-7 | 90° | 4 ONLY | |
| WRL-5-X | 180° 10-4 | 90° | 1 ONLY | |

DOUBLE POLE LOCK SWITCH

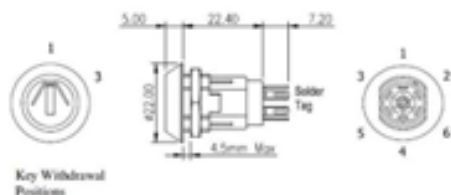

TAPERED LOCK HEAD 60° INDEXING

| BASIC PART No. | TOTAL MOVEMENT | INDEXING | KEY WITHDRAWAL POSITIONS | SWITCH CONFIGURATION |
|----------------|----------------|----------|--------------------------|----------------------|
| WRL-5-L | 60° | 60° | 1,3 | |
| WRL-5-M | 60° | 60° | 1 ONLY | |

WRL ORDERING CODE

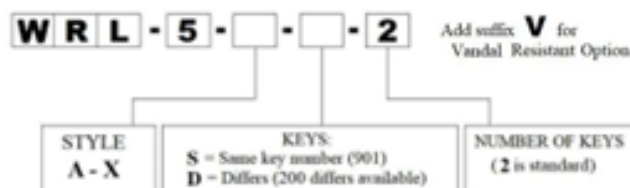

LOCK SWITCH

WIRL IP66/IP67 SEALED IMPULSION LOCK SWITCH 2 & 3 POSITION

ELECTRICAL & MECHANICAL SPECIFICATION

| | | | |
|-------------------------------|---------------------------|-------------------------------|-----------------------------|
| Switch Rating: | 1A @24V ac/dv | Life: | >10,000 Cycles |
| Proof Voltage: | 750 Vac (Initial) | Lock Type: | 5 Disc |
| Insulation Resistance: | >999MΩ @ 500Vdc (Initial) | Operating Temperature: | -20°C to +65°C |
| Contact Resistance: | <20mΩ (Initial) | Lock Housing: | Zinc Alloy Bright Cr Plated |
| Contact Material: | Brass CZ108, Ag Plated | Moulding Material: | Polyamide 6.6 G.F. V0 Rated |

FEATURES

Suitable for Marine Environment Exposure to Severity One (EN60068-2-52) salt mist tested

- Spring return
- Double Pole DPST
- Rear panel depth - <30mm
- Single Pole SPDT
- Rear panel depth - <35mm
- Vandal Resistant versions available
- Front assembly
- Made in UK
- Oil regularly if used outside
- 2 keys per switch, up to 200 differ key combinations available
- Keys can be inserted either way up
- Master key versions to order



DOUBLE POLE LOCK SWITCH

Tapered lock head 60° indexing Spring Return 2 Pole 2 Position

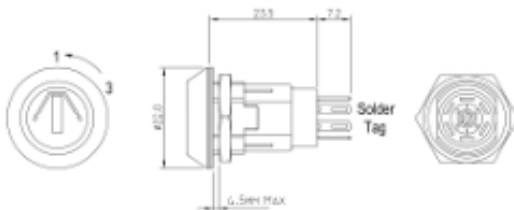

TAPERED LOCK HEAD 60° INDEXING

| BASIC PART No. | TOTAL MOVEMENT | INDEXING | KEY WITHDRAWAL POSITIONS | SWITCH CONFIGURATION |
|----------------|----------------|----------|--------------------------|----------------------|
| WIRL-5-M | 60° | 60° | 1 ONLY | |

SINGLE POLE 3 POSITION

Available in three versions:-

Type L - Left spring return with latching to the right.

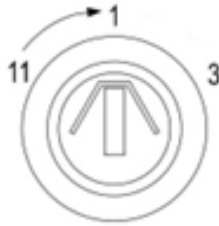

Type D - Double spring return.

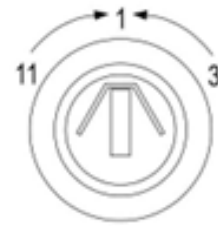

Type R - Right spring return with latching to the left.

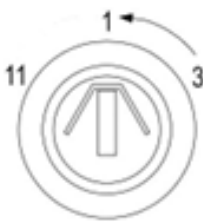

Type R Alternate mounting

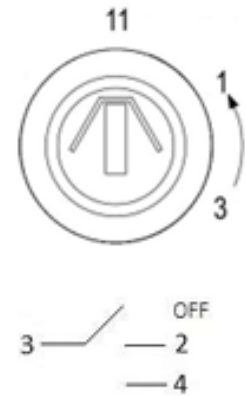
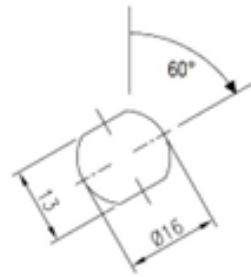

SINGLE POLE LOCK SWITCH

Tapered lock head 60° indexing Spring Return 1 Pole 3 Position

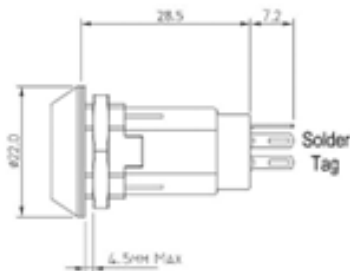

TAPERED LOCK HEAD 60° INDEXING

| BASIC PART No. | TOTAL MOVEMENT / INDEXING | KEY WITHDRAWAL POSITIONS | SWITCH CONFIGURATION |
|----------------|---------------------------|--------------------------|----------------------|
| WIRL-5-L | 120° / 60° | 1, 3 | |
| WIRL-5-D | 120° / 60° | 1 ONLY | |
| WIRL-5-R | 120° / 60° | 11, 1 | |

WIRL - 5 - [] - [] - 2

Add suffix **V** for Vandal Resistant Option

STYLE
D - R

KEYS:
S = Same key number (901)
D = Differs (200 differs available)

NUMBER OF KEYS
(2 is standard)