

Product features

- Unique Dual Sensitivity for improved detection of live conductors. Patent applied for.
- Power On/Off switch for longer battery life.
- Auto Power Off to further extend battery life.
- Bi-colour LED indication of correct operation (green) and volts present (red).
- Audible indication of correct operation and warning of volts present.

Specifications

- **Safety** complies with BSEN 61010 CAT IV 600V
-  **Double insulated**
- **Operating Range** 90 – 600 VAC
- **Operating Temperature** -10 to 50° C
- **Humidity** max 90%

Kewtech Corporation Limited

Midas House, Unit 2b, Stones Courtyard,
High Street, Chesham, Bucks HP5 1DE

T: **01494 792 212** F: 01494 791 826

E: sales@kewtechcorp.com

Instruction Manual

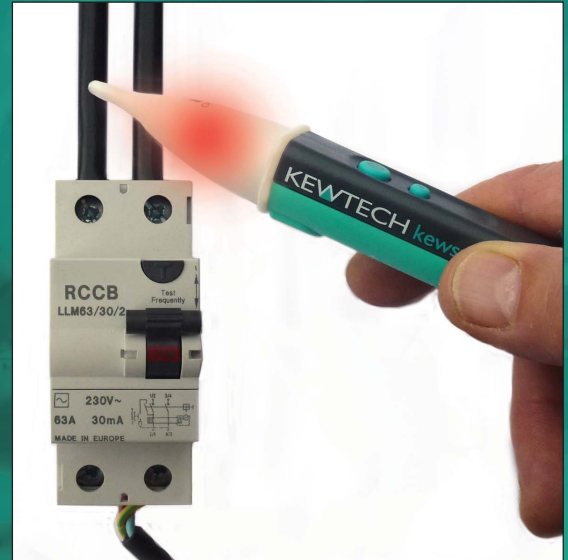

Kewstick Duo

With unique dual sensitivity

Safety

- This product is designed for use by a competent person with appropriate training.
- Do not use the product if there is any sign of cracks or other damage – to clean use only a dry cloth.
- Use only on electrical systems within the specified voltage range (90 – 600 VAC) – **always test for correct operation on a known live voltage source before and after use.**
- **Always hold the Voltage Indicator firmly as shown on the front cover of this manual** to avoid possible slipping onto a live conductor
- To maintain integrity of the category rating never move the tip into any electrical field beyond the clearly marked CAT IV ring on the tip.
- When testing flexible cables move the tip along the cable as the typical twisted construction of cables means the voltage field from the live and the neutral can cancel each other out giving a false indication.
- The tester may not indicate a live conductor within steel boxes, trunking, conduit or SWA (Steel Wire Armoured) cables
- The tester must be used in accordance with these instructions – it must not be used in any other non-intended way.
- When installing batteries observe correct polarity, do not mix old and new batteries. Dispose of used batteries in accordance with local regulations – never incinerate batteries.

Instructions

Bi-Colour LEDs

– steady flashing green and steady bleep indicate unit is switched on and correctly working – flashing red and warning bleep indicate volts present – flashing red and green indicates low battery

On/Off switch – press for power on - a green LED lights to confirm power on and working - for power off briefly hold the switch, a double bleep will confirm power is off. (Auto power off will operate after approximately 3 minutes if no activity is detected)

Sensitivity Attenuation button

- hold down to reduce the sensitivity of the Voltage Detection System. This unique feature is very useful for tracing or identifying live conductors in bunched or crowded cables

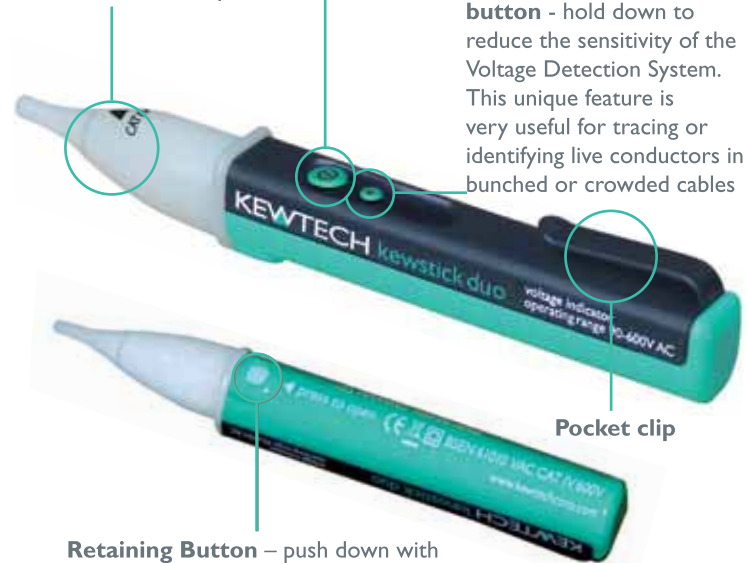

Retaining Button – push down with a pen (or similar) and slide cover back for access to battery compartment. The unit requires 2 X AAA batteries (included when unit is supplied new) - always replace with good quality alkaline batteries