



Digital Caliper 16 EX

with

marconnect

Digital Caliper 16 EX and **marconnect** – the innovative and efficient connection for data processing.

marconnect transmits your data directly and reliably via the electronic standard interfaces OPTO-RS-232C and Digimatic to a PC or printer. Just as required.



<http://www.mahr.com>

Digital Caliper 16 EX

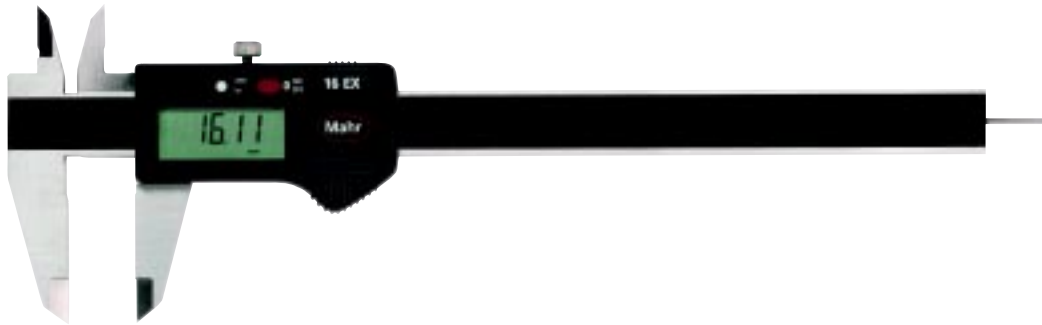

Features

- Functions: ON/OFF, RESET (Zero setting), mm/inch, DATA (in connection with data connecting cable)
- Capacitive measuring system, life of battery approx. 2 years
- Measuring speed 1,5 m/s (60"/s)
- High contrast 7,5 mm liquid crystal display
- Slide and beam made of stainless steel, hardened
- Measuring blades for inside measurement
- Depth measuring rod
- Step measuring function
- Locking screw
- Scope of delivery: Case and battery

Technical data

Measuring range mm (inch)	Resolution mm / inch	Error limit (DIN 862) mm (inch)	Order no.	Remarks
150 (6")	0,01 / .0005"	0,03 (.0015")	4102401	without data output
150 (6")	0,01 / .0005"	0,03 (.0015")	4102400	data output Opto RS232C/Digimatic

Accessories

	Order no.
Depth measuring bridge	16 Em 4102020
Battery 3V, type CR 2032	4102520
Data connecting cable RS232C (2 m), SUB-D-jack 9-pin	16 EXr 4102410
Data connecting cable Digimatic (2 m), flat-plug 10-pin	16 EXd 4102411

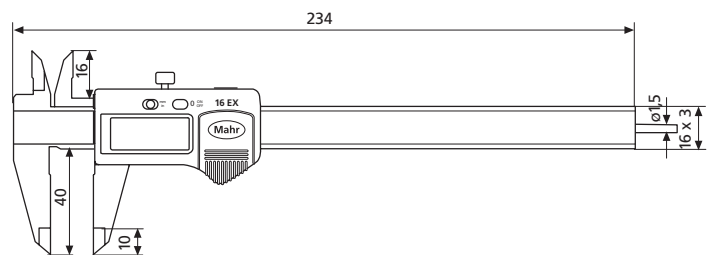

Accessories for data processing see General Catalogue „Dimensional Metrology - Hand Measuring Instruments“, chapter 9

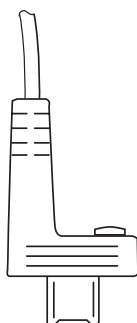

**Data connecting cable
16 EXr/16 EXd
with data button**

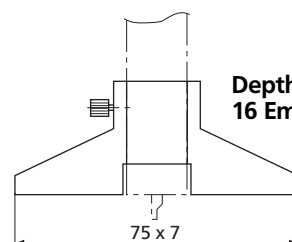

**Depth measuring bridge
16 Em**