

**KR5205-2RS**

Stud type track roller

Stud type track rollers KR52...-2RS, double row, lip seals on both sides

Technical information

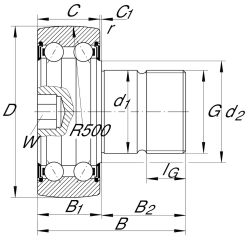

Your current product variant

Sealing	2RS	Lip seal on both sides, with axial sealing action
Outer Ring profile	R500	R500
Relubrication feature	Without	Without
Assembling aid head	I6	Hexagon socket

Main Dimensions & Performance Data

D	62 mm	Outside diameter
d 1	24 mm	Fit diameter of roller stud / stud
B	70.9 mm	Width
C r w	18,400 N	Basic dynamic load rating, radial
C 0r w	13,400 N	Basic static load rating, radial
C ur w	670 N	Fatigue load limit, radial
n D G	4,500 1/min	Speed on permanent grease lubrication
≈m	0.58 kg	Weight









Dimensions

B 1 max	21.5 mm	Maximum width of thrust washer
B 2	49.5 mm	Bolt/stud length effectively
C	20.6 mm	Width, outer ring
C 1	0.8 mm	Protrusion outer ring to thrust washer
d 2	30.3 mm	Stop diameter of thrust washer
r min	1 mm	Minimum chamfer dimension
G	M24X1,5	Thread
l G	25 mm	Thread length
W	10 mm	Width of flats
R	500 mm	Radius of outer ring outside profile

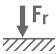
Additional information

M A	290 Nm	Tightening torque nut
-----	--------	-----------------------

Characteristics

	Radial load
	Axial load in one direction
	Axial load in two directions
	Lifetime lubrication, freedom from maintenance
	Grease Lubrication
	Sealed on both sides