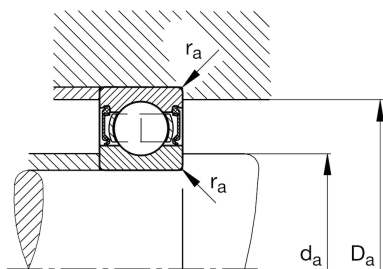
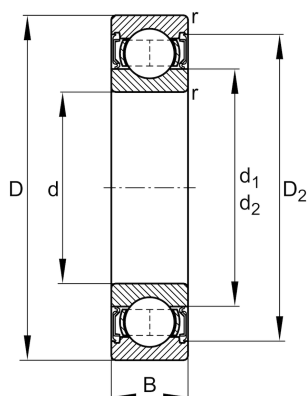

**FAG****61805-2RSR**

Deep groove ball bearing

Schaeffler ID:
0554550340000Deep groove ball bearing 618..-2RSR,
single row, seals, steel sheet metal cage

Technical information

**Main Dimensions & Performance Data**

d	25 mm	Bore diameter
D	37 mm	Outside diameter
B	7 mm	Width
C_r	4,300 N	Basic dynamic load rating, radial
C_{0r}	2,940 N	Basic static load rating, radial
C_{ur}	132 N	Fatigue load limit, radial
n_G	9,500 1/min	Limiting speed
	0.021 kg	Weight

Mounting dimensions

$d_{a \min}$	27 mm	Minimum diameter shaft shoulder
$D_{a \max}$	35 mm	Maximum diameter of housing shoulder
$r_{a \max}$	0.3 mm	Maximum fillet radius

Dimensions

r_{\min}	0.3 mm	Minimum chamfer dimension
D_2	34.2 mm	Caliber diameter outer ring
d_1	28.2 mm	Shoulder diameter inner ring

Temperature range

T_{\min}	-30 °C	Operating temperature min.
T_{\max}	100 °C	Operating temperature max.

Calculation factors

f_0	16	Calculation factor
-------	----	--------------------