

**FAG****6220-2RSR-C3**

Deep groove ball bearing

Deep groove ball bearing 62...-2RSR, single row, seals, steel sheet metal cage

Technical information

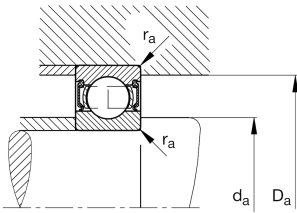
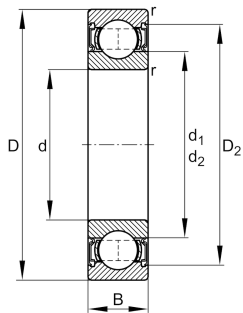

Your current product variant

Sealing	2RSR	Contact seal on both sides
Cage	JN	Steel sheet metal
Tolerance class	PN	Normal (PN)
Dimensional / heat stabilization	S0	Rings dimensional stabilized up to 150°
Lubricant	GA13	Ball bearing and insert bearing grease, standard for D>62mm
Radial internal clearance	C3 (Group 3)	Internal clearance larger than CN
Bore type	Z	Cylindrical

Main Dimensions & Performance Data

d	100 mm	Bore diameter
D	180 mm	Outside diameter
B	34 mm	Width
C _r	130,000 N	Basic dynamic load rating, radial
C _{0r}	93,000 N	Basic static load rating, radial
C _{ur}	5,500 N	Fatigue load limit, radial
n _G	2,140 1/min	Limiting speed
≈m	3.28 kg	Weight

Mounting dimensions

d _{a min}	112 mm	Minimum diameter shaft shoulder
D _{a max}	168 mm	Maximum diameter of housing shoulder
r _{a max}	2.1 mm	Maximum fillet radius



Dimensions

r_{min}	2.1 mm	Minimum chamfer dimension
D_1	154.94 mm	Shoulder diameter outer ring
D_2	158.9 mm	Caliber diameter outer ring
d_1	124.7 mm	Shoulder diameter inner ring





Temperature range

T_{min}	-20 °C	Operating temperature min.
T_{max}	100 °C	Operating temperature max.

Calculation factors

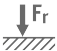
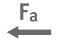
f_0	14.4	Calculation factor
-------	------	--------------------

Characteristics

-  Radial load
-  Axial load in one direction
-  Axial load in two directions
-  Lifetime lubrication, freedom from maintenance
-  Grease Lubrication
-  Sealed on both sides