

METTEC 19" RACK CASES

1U – VERSION A

For rack mounting only; the front bezel is painted in light grey, RAL 7035 to match popular 19" racks and the rest of the case is coated in Alocrom 1200 for good EMC shielding and corrosion resistance.

ASSEMBLY

Strong and secure construction in aluminium assembled by four M4 screws. For high shielding attenuation all components are masked and interlock with each other. The top and base panels have EMC contact points on each edge for secure connection. The front panel mounting face is also masked for electrical contact. The base panels are fitted with an M4 earth stud.

All cases are supplied assembled and include the fixings for the accessory front panel kits.

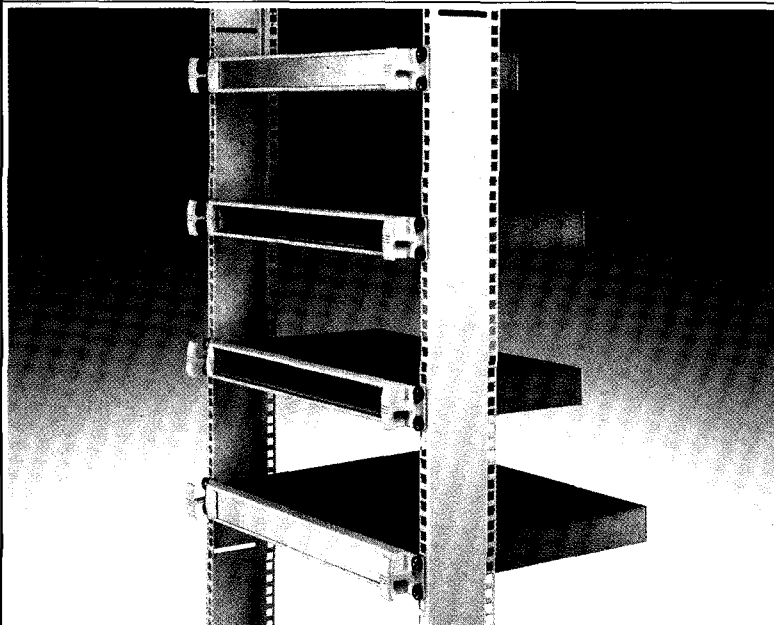

ACCESSORIES

FRONT PANEL KIT:

Recessed for easy assembly of membrane keyboards (see page 38).

RACK MOUNTING KIT:

All screws and fixings for fitting the case to a rack.

CHASSIS TRAYS:

For mounting PCBs, subassemblies and heavy components (see page 38).

SUPPLY

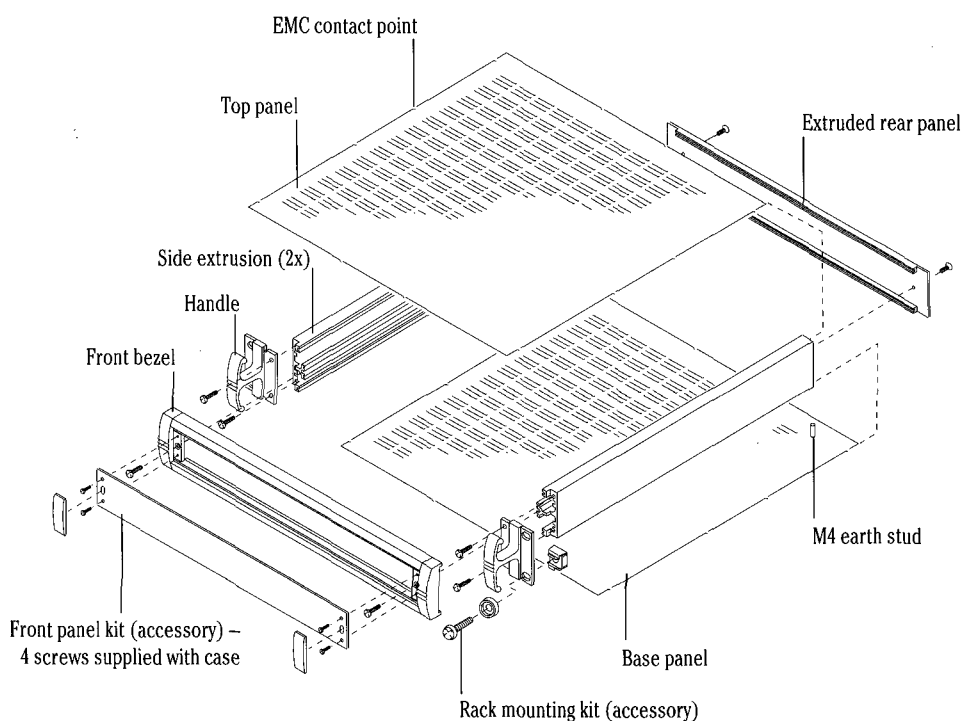

Part No.		METTEC 19" RACK CASES – 1U – VERSION A							
No ventilation	Ventilated	Type	Outside dim. in mm			Inside dim. in mm			
			Height	Width	Depth	a	b	c	d
M 59 10 015		1 U, Version A	44	482.6	167.5	147.5	150	159	121
M 59 10 025	M 59 10 205	1 U, Version A	44	482.6	267.5	247.5	250	259	221
M 59 10 035	M 59 10 305	1 U, Version A	44	482.6	367.5	347.5	350	359	321
		ACCESSORIES							
		Article	Application / Supply						
		M 59 00 010	1U front panel kit						
		M 59 00 016	Rack mounting kit						

Chassis trays (separate article) for mounting PCBs, subassemblies and heavy components see page 38.

METTEC 19" RACK CASES 1U – VERSION A

OKW

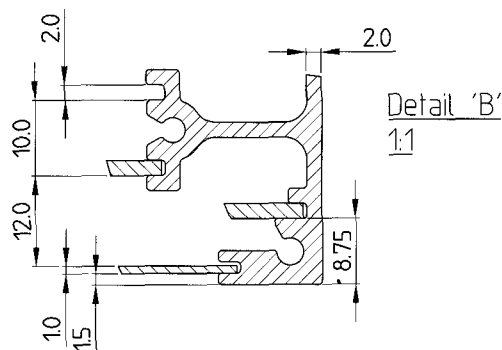
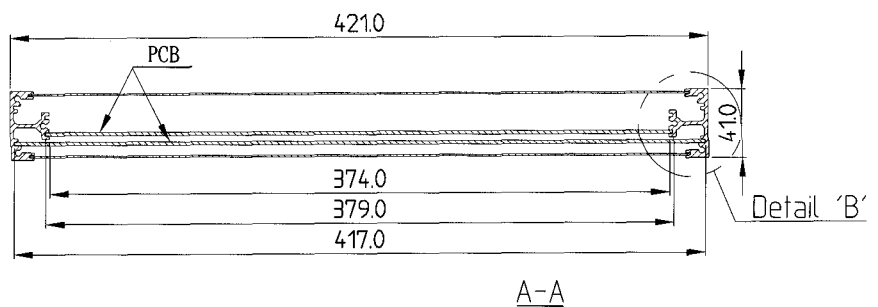
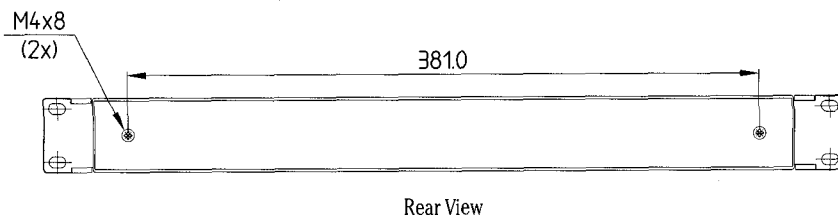
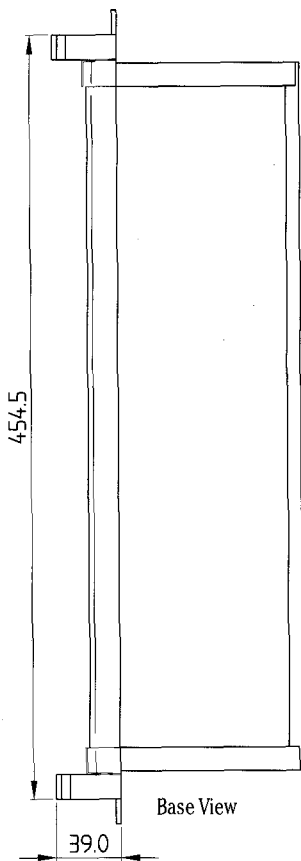
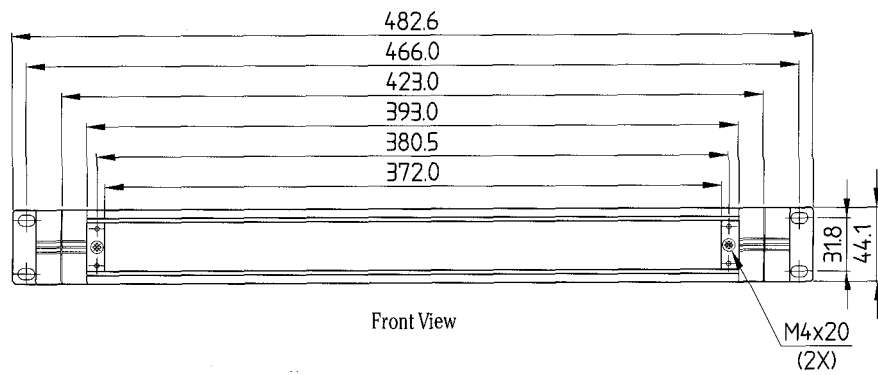
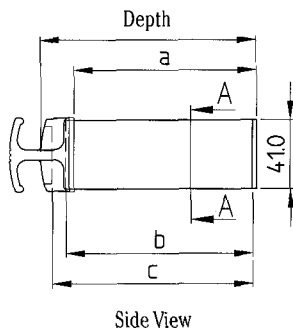

19" RACK CASES