



HRC fuse base ceramic Sz.00 1-pole 160A 690V (1000V) flat terminal

Model		
product brand name	SENTRON	
product designation	LV HRC fuse base	
design of the thread of the nut	M8	
design of the thread of the connection screw	M8	
General technical data		
number of poles	1	
size of fuse system according to EN 60269-1	NH00	
utilization category	Without	
Supply voltage		
supply voltage		
• at AC	690 V	
• at DC	690 V	
Product details		
product component swivel-in mechanism	No	
maximum short-circuit current breaking capacity (I _{cu})		
• at AC rated value	120 kA	
• at DC rated value	120 kA	
Connections		
connectable conductor cross-section on terminal strip		
• minimum	6 mm ²	
• maximum	95 mm ²	
tightening torque of the screw for securing the equipment maximum	6 N·m	
tightening torque with screw-type terminals maximum	32 N·m	
type of electrical connection	With flat-type terminal	
• for main current circuit	with flat-type terminal	
Mechanical Design		
height	120 mm	
width	30 mm	
depth	58.5 mm	
fastening method	fixed mounting	
fastening method bus-mounting	No	
Net Weight	189.3 g	
Approvals Certificates		
General Product Approval	other	Environment



EG-Konf.



UR

[Confirmation](#)



[Environmental Confirmations](#)

Further information

Information on the packaging

<https://support.industry.siemens.com/cs/ww/en/view/109813875>

Information- and Downloadcenter (Catalogs, Brochures,...)

<http://www.siemens.com/lowvoltage/catalogs>

Industry Mall (Online ordering system)

<https://mall.industry.siemens.com/mall/en/en/Catalog/product?mlfb=3NH6030>

Service&Support (Manuals, Certificates, Characteristics, FAQs,...)

<https://support.industry.siemens.com/cs/ww/en/ps/3NH6030>

Image database (product images, 2D dimension drawings, 3D models, device circuit diagrams, ...)

http://www.automation.siemens.com/bilddb/cax_en.aspx?mlfb=3NH6030

CAX-Online-Generator

<http://www.siemens.com/cax>

Tender specifications

<http://www.siemens.com/specifications>

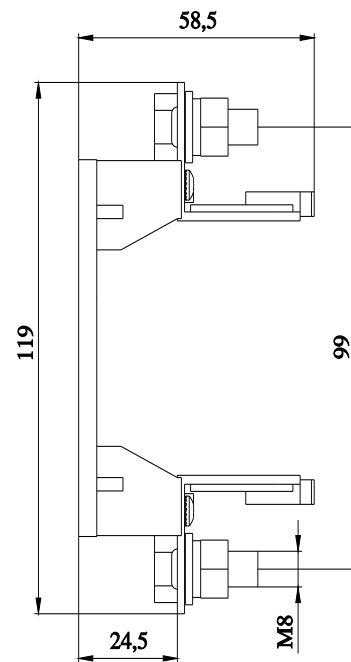
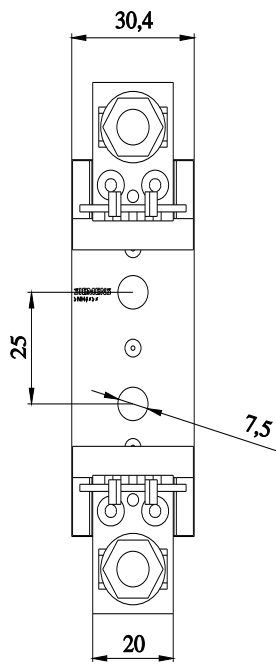

last modified:

8/8/2025

