

## DETAILS

<b>Product Number</b>	FCA12077_IRIS
<b>Family</b>	Iris
<b>Type</b>	Assembly
<b>Color</b>	black
<b>Diameter</b>	38 mm
<b>Height</b>	27.1 mm
<b>Style</b>	round
<b>Optic Material</b>	PMMA
<b>Holder Material</b>	PC
<b>Fastening</b>	screw, pin, tape
<b>Status</b>	ready
<b>ROHS Compliant</b>	Yes
<b>Date Updated</b>	27/09/2013



## OPTICAL PROPERTIES

LED	Viewing	Light	Effi-	cd/lm	Connector
	Angle	Beam	ciency		
LUXEON H50-2	sim: 7	Real spot	-	sim: 0.000	-
XQ-E	sim: 5	Real spot	sim: 93 %	sim: 80.000	-
Oslon SSL 80	4 deg	Real spot	90 %	89.000	-
Oslon SSL 150	4 deg	Real spot	-	76.800	-
XP-E	4 deg	Real spot	93 %	87.400	-
LUXEON Z ES	4 deg	Real spot	93 %	94.060	-
XP-E2	5 deg	Real spot	-	103.900	-
LUXEON Rebel	5 deg	Real spot	-	75.600	-
NCSxx19A	5 deg	Real spot	-	-	-
XP-G	6 deg	Real spot	95 %	sim: 0.000	-
NVSxx19A	6 deg	Real spot	93 %	38.700	-
XP-G2	6 deg	Real spot	95 %	46.000	-
LUXEON TX	6.9 deg	Real spot	89 %	43.100	-
LUXEON Rebel ES	7 deg	Real spot	93 %	38.500	-
LUXEON T	7 deg	Real spot	94 %	40.200	-
LH351Z	7 deg	Real spot	89 %	48.100	-
H35C1 (LEMWA33)	8 deg	Real spot	89 %	40.400	-

Relative intensity of FCA12077-IRIS\_(XPE2)

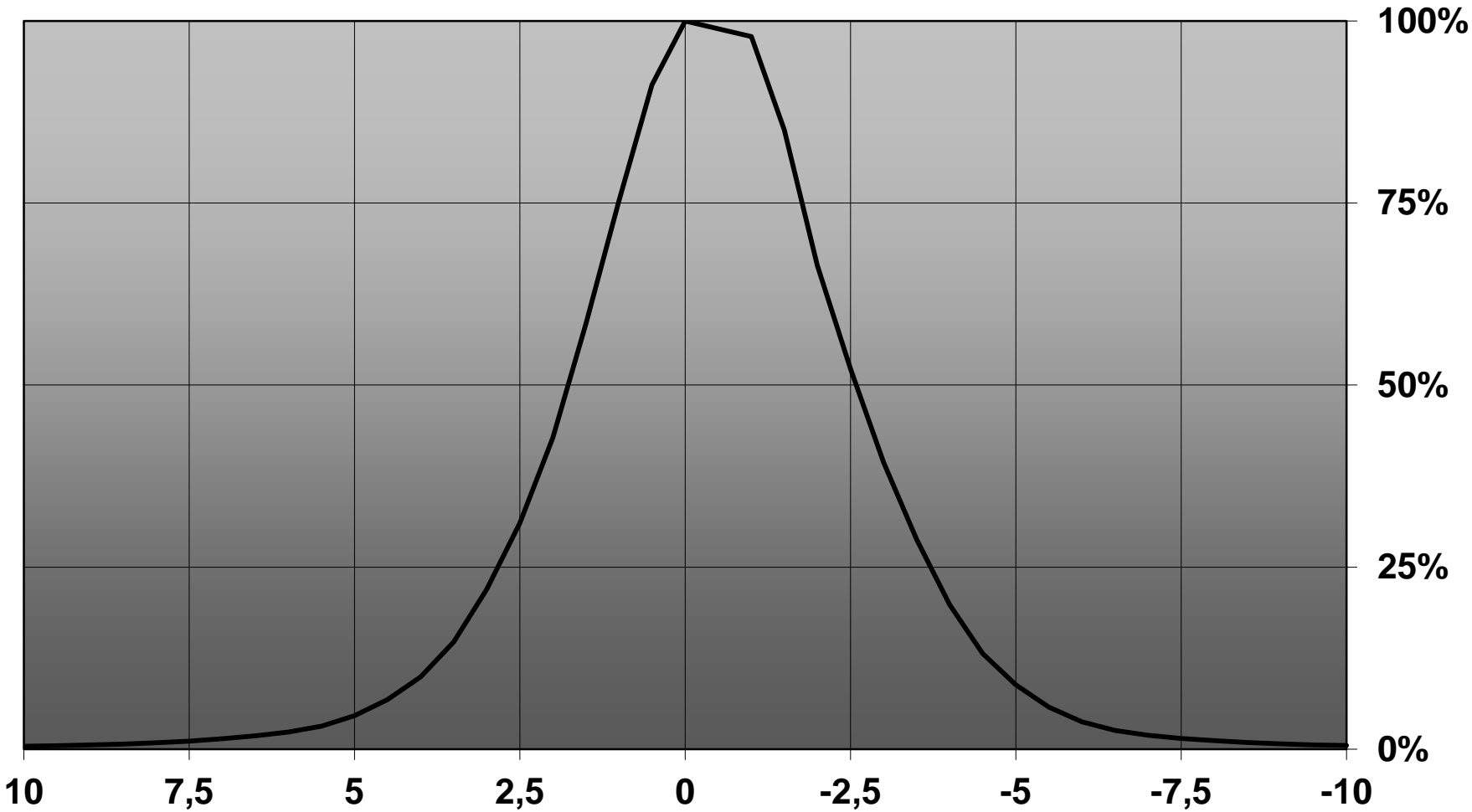

Relative intensity of C4F12077\_Iris-RE-tape

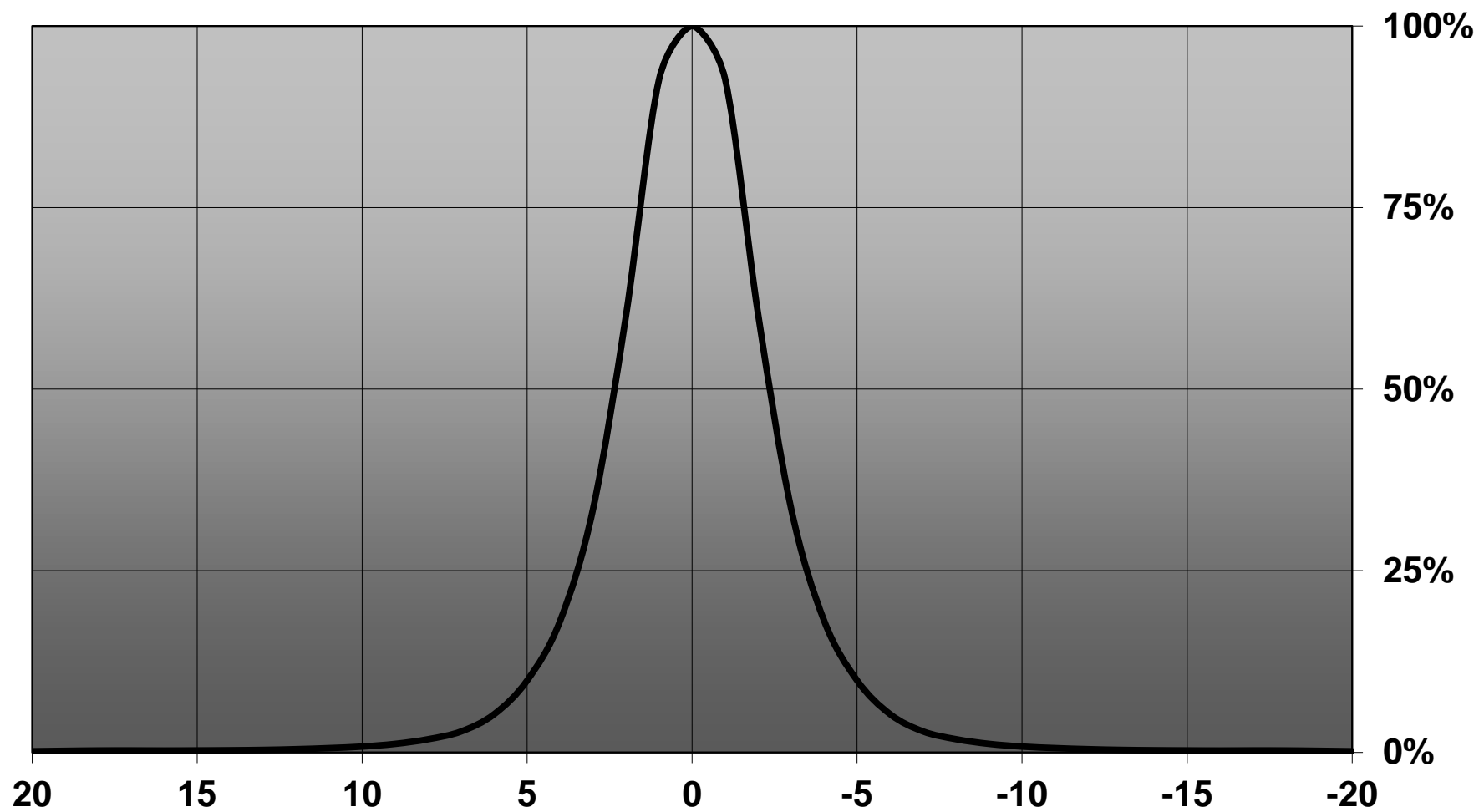

Relative intensity of C4F12077\_Iris-RE-ES-tape

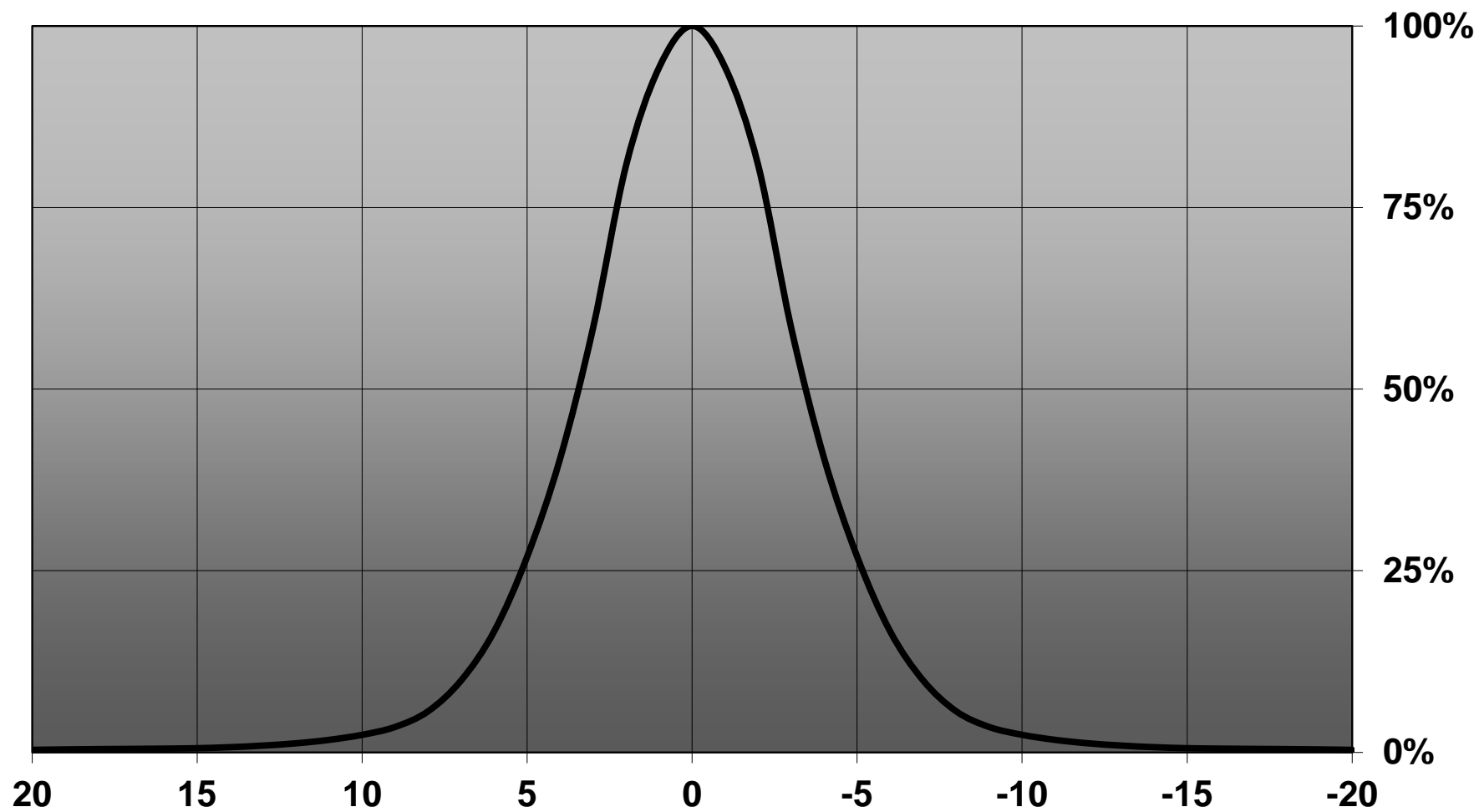

INDEX	PART NO	DESCRIPTION	MATERIAL
1	C10253	Sputnik-tape	PU 2-sided foam tape, adhesive
2	F12075	IRIS lens	PMMA
3	C12202	IRIS-XP-HLD holder	PC, black

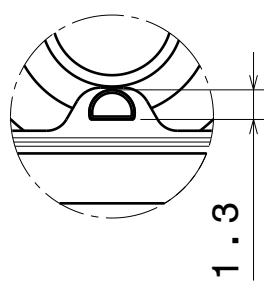
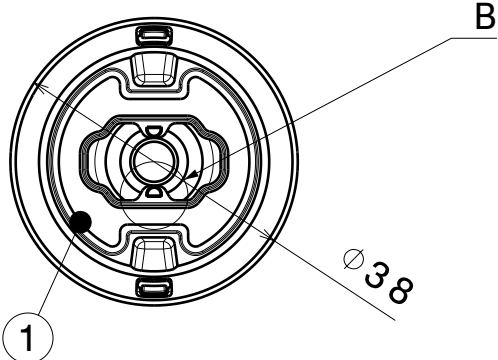

Detail B  
Scale: 3:1

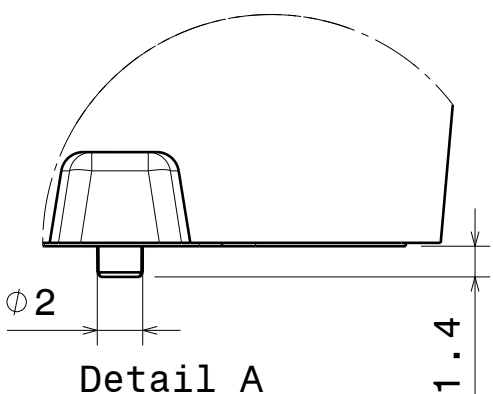
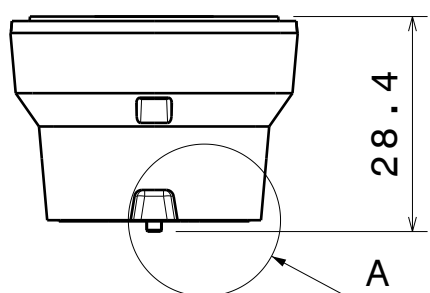
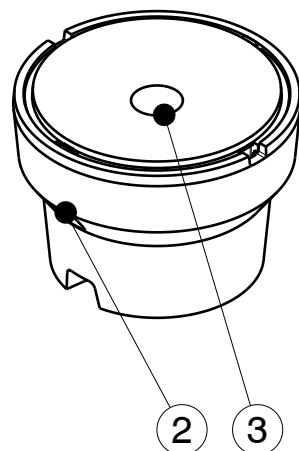

Detail A  
Scale: 3:1

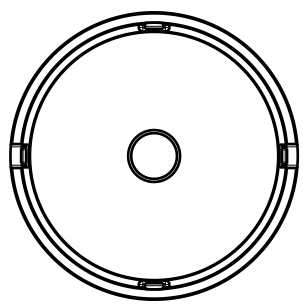

Tolerances for dimensions:  
 0-20mm tolerance value  $\pm 0.1$   
 21-45mm tolerance value  $\pm 0.2$   
 46-90mm tolerance value  $\pm 0.3$   
 91-100mm tolerance value  $\pm 0.4$   
 101-mm tolerance value  $\pm 0.5$

This drawing is our property.  
 It can't be reproduced  
 or communicated without  
 our written agreement.



Ledil Oy  
 Salorankatu 10  
 FIN 24240 SALO  
 Finland

DRAWING TITLE

Datasheet IRIS

DRAWN BY OHa	DATE 25.5.2012	SIZE A4		DRAWING NUMBER FCA12077		REV 01
CHECKED BY SN	DATE -	SCALE 1:1		WEIGHT (g) 20		SHEET 1/1
DESIGNED BY pv	DATE 25.5.2012					

Luminaire: LEDiL Oy FCA12077\_IRIS\_(Z\_ES)  
Lamps: 1 x Philips\_Lumileds\_Luxeon\_Z\_ES\_(LX22-5070)  
\_84.6528lm@250mA\_P=0.730483W\_I=249.9mA

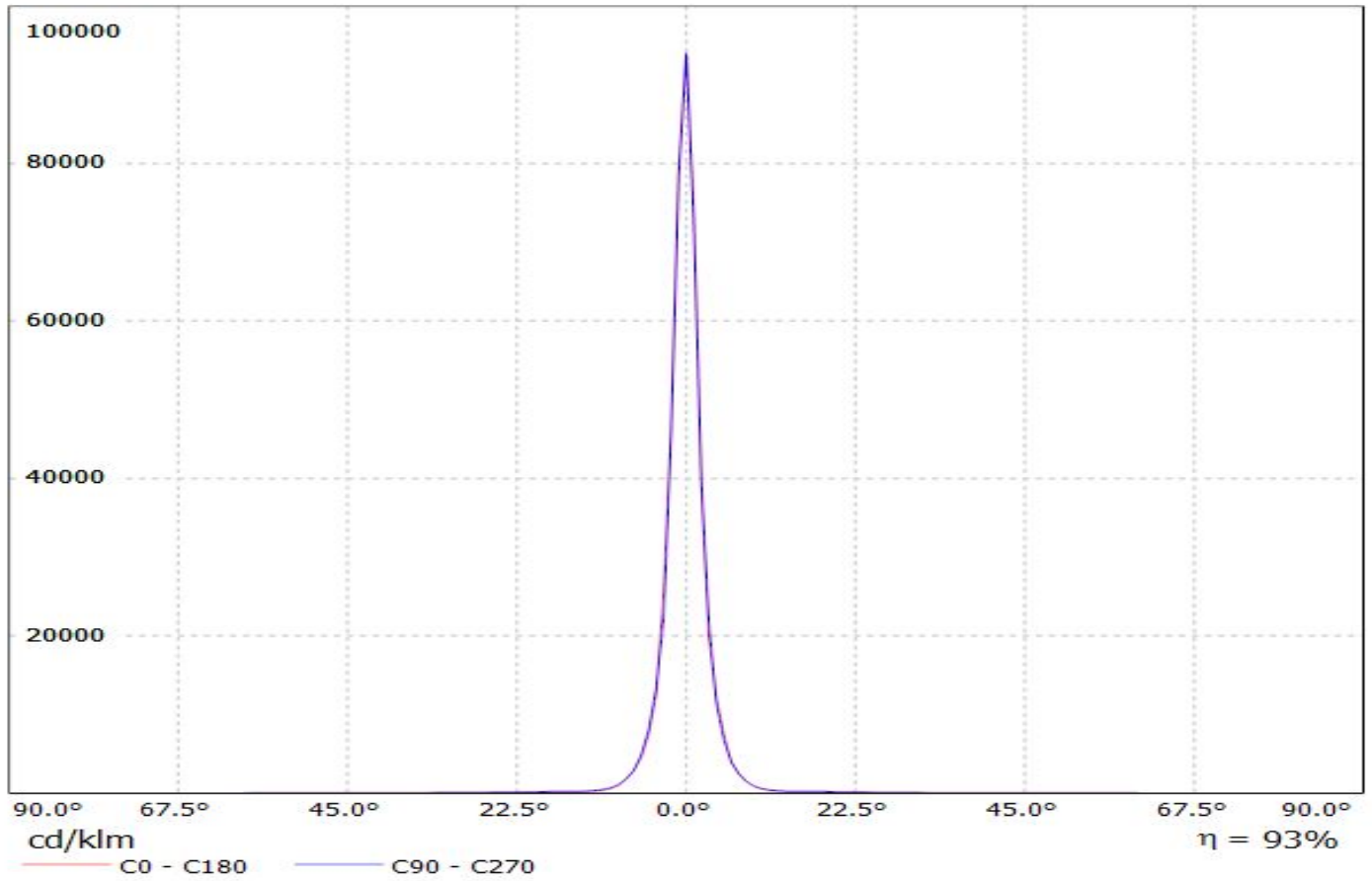

Valaisin: LEDIL OY FCA12077\_IRIS\_(XP-G2) Efficiency=95%  
Lamput: 1 x Cree XP-G2 (109.1lm @ 250mA)

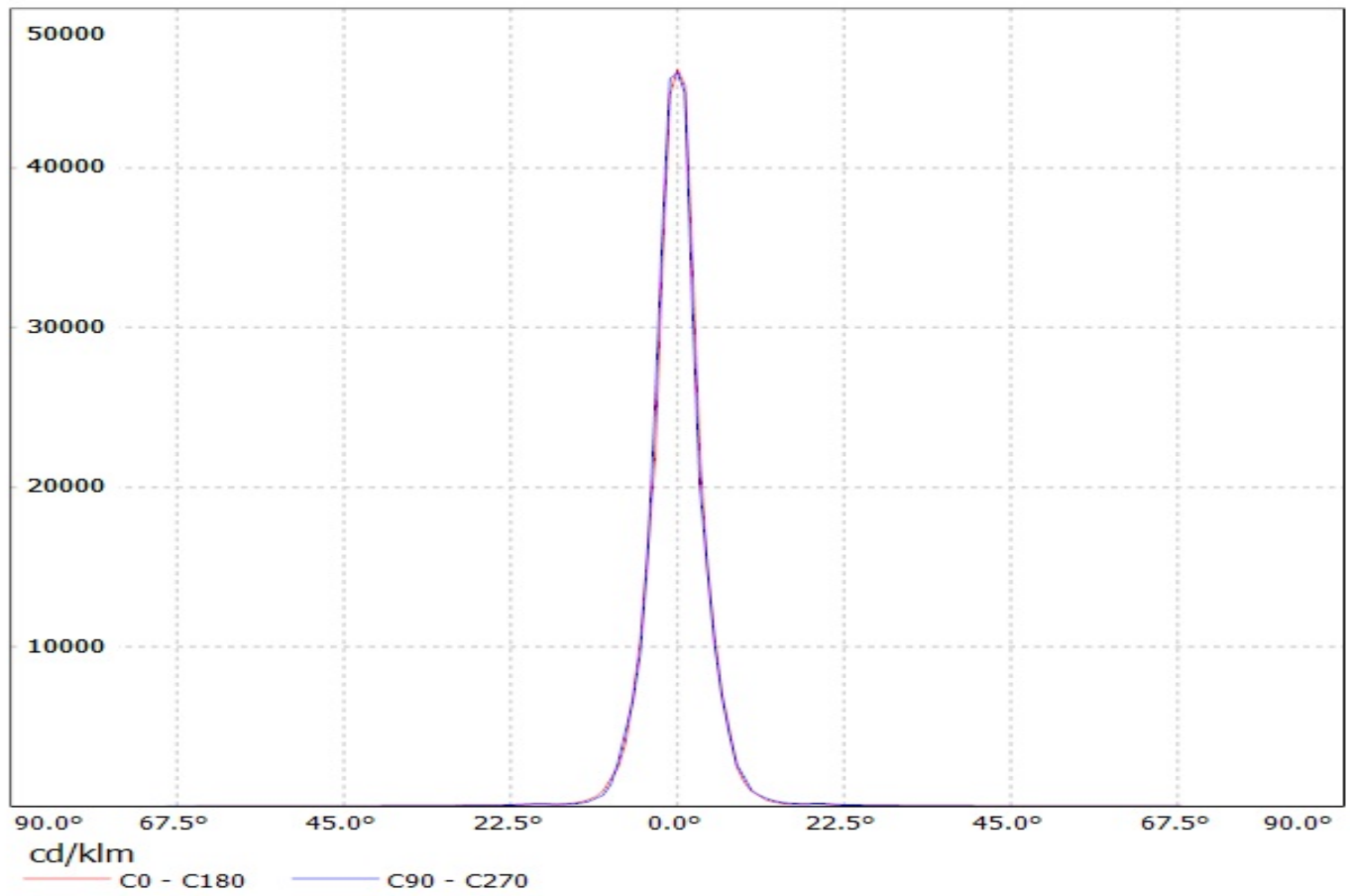

Luminaire: Ledil Oy FCA12077\_IRIS\_(Luxeon\_TX)

Lamps: 1 x Philips Lumileds Luxeon TX (80.78lm @ 250mA) P=0.7W I=250mA

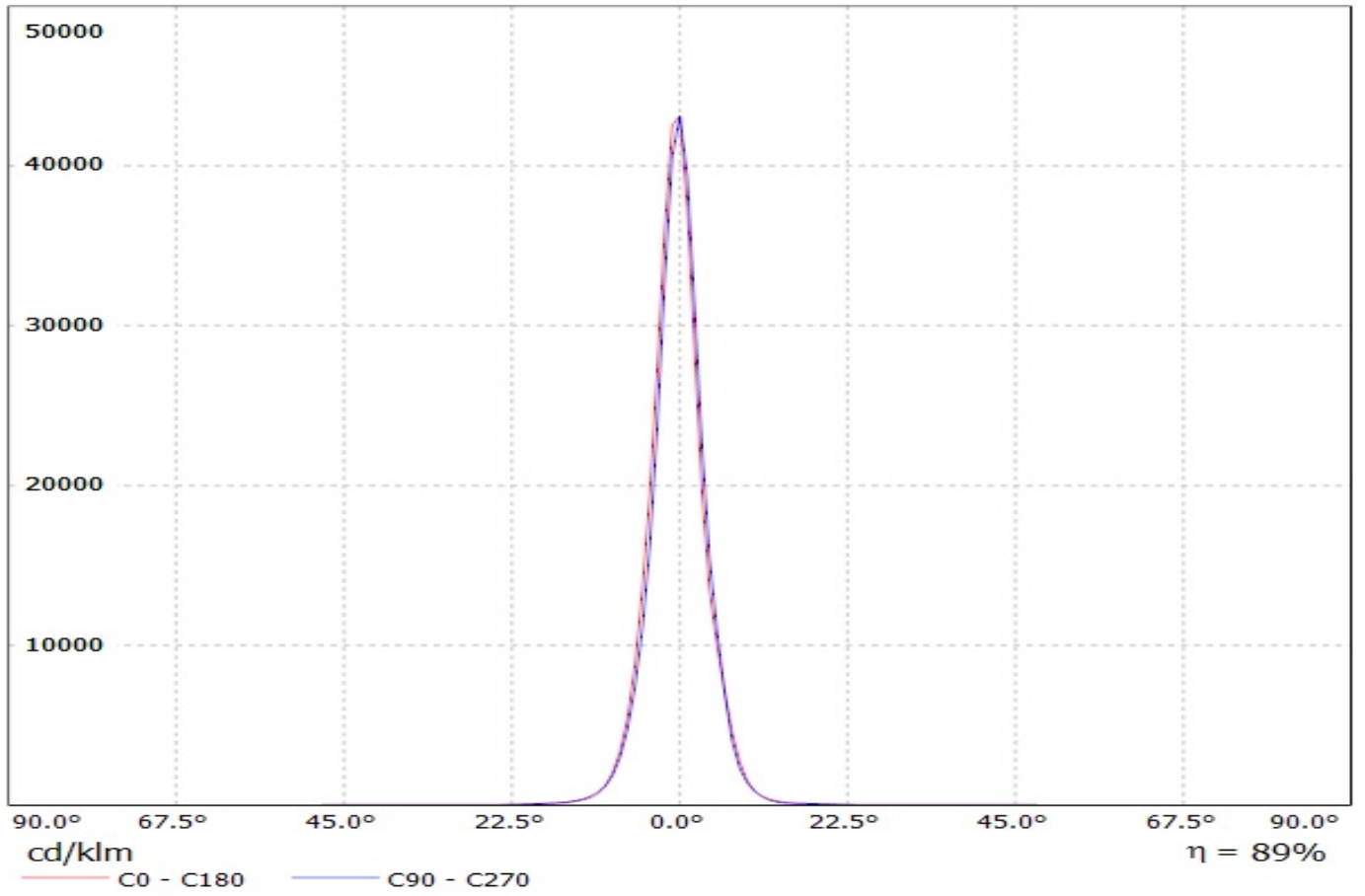



# LEDiL Oy FCA12077\_IRIS\_(LUXEON\_T)\_1 Eff.94.6% / LDC (Linear)

Luminaire: LEDiL Oy FCA12077\_IRIS\_(LUXEON\_T)\_1 Eff.94.6%  
Lamps: 1 x LUXEON T (74lm@250mA)

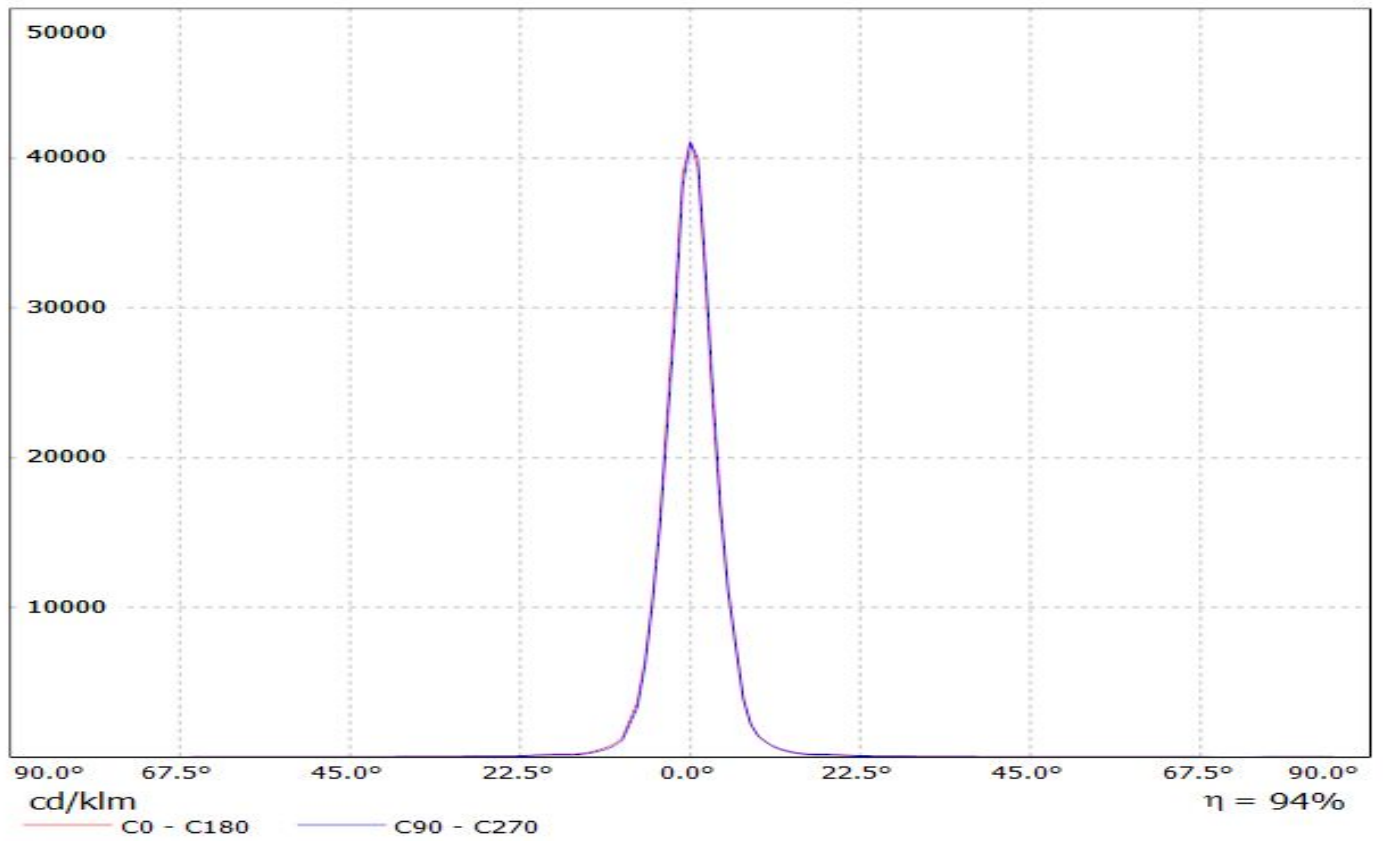

Luminaire: LEDil Oy FCA12077\_IRIS\_(LH351Z)

Lamps: 1 x Samsung LH351Z (90.14lm @ 250mA) CCT=6500K P=0.7W I=250mA

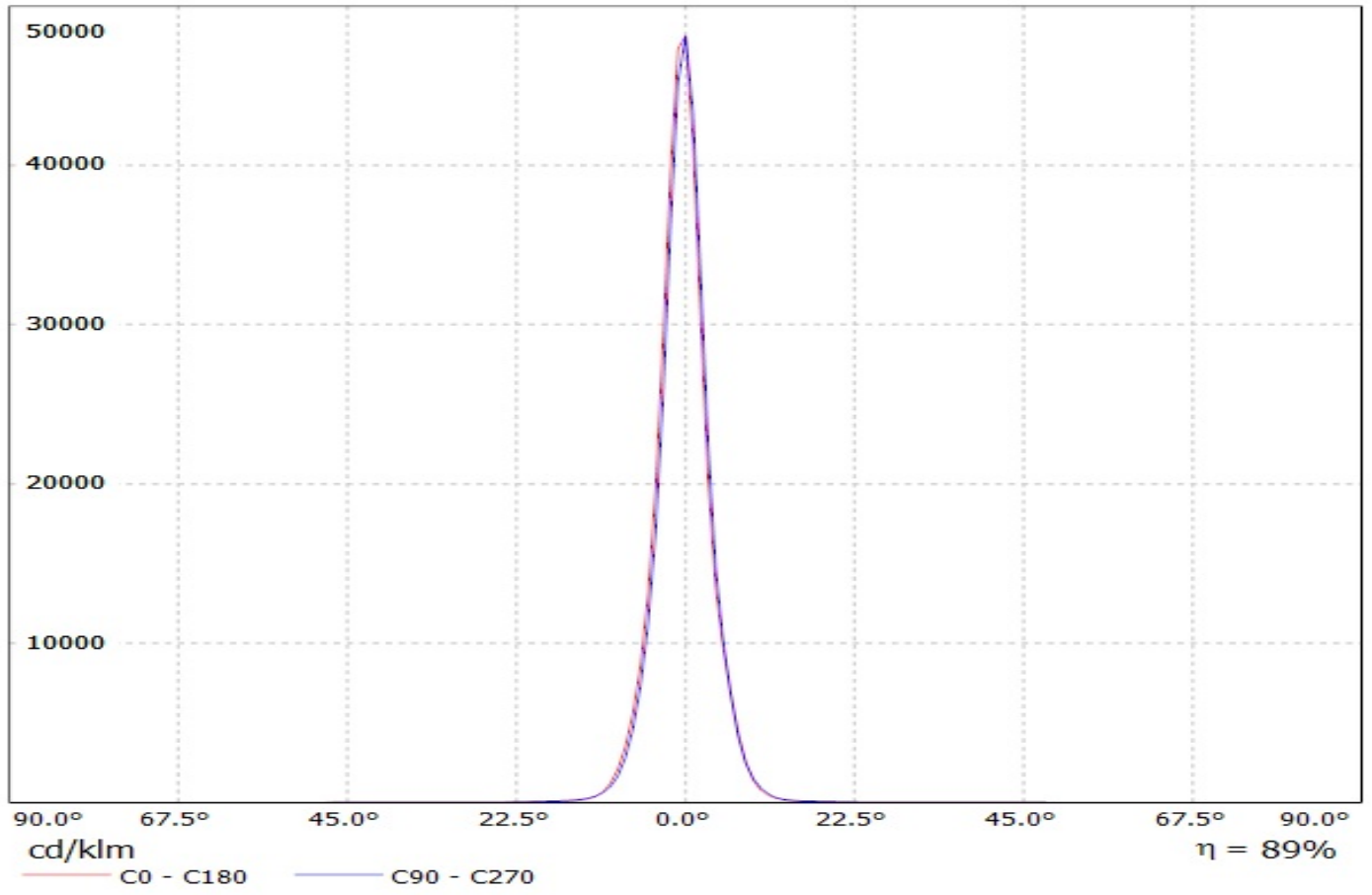

Luminaire: Ledil Oy FCA12077\_IRIS\_(3535\_Ceramic\_gen2) Efficiency=89%  
Lamps: 1 x LG 3535 Ceramic gen2 (PKG5700k) 116lm @ 250mA CCT=6200k P=0.7 I=250mA

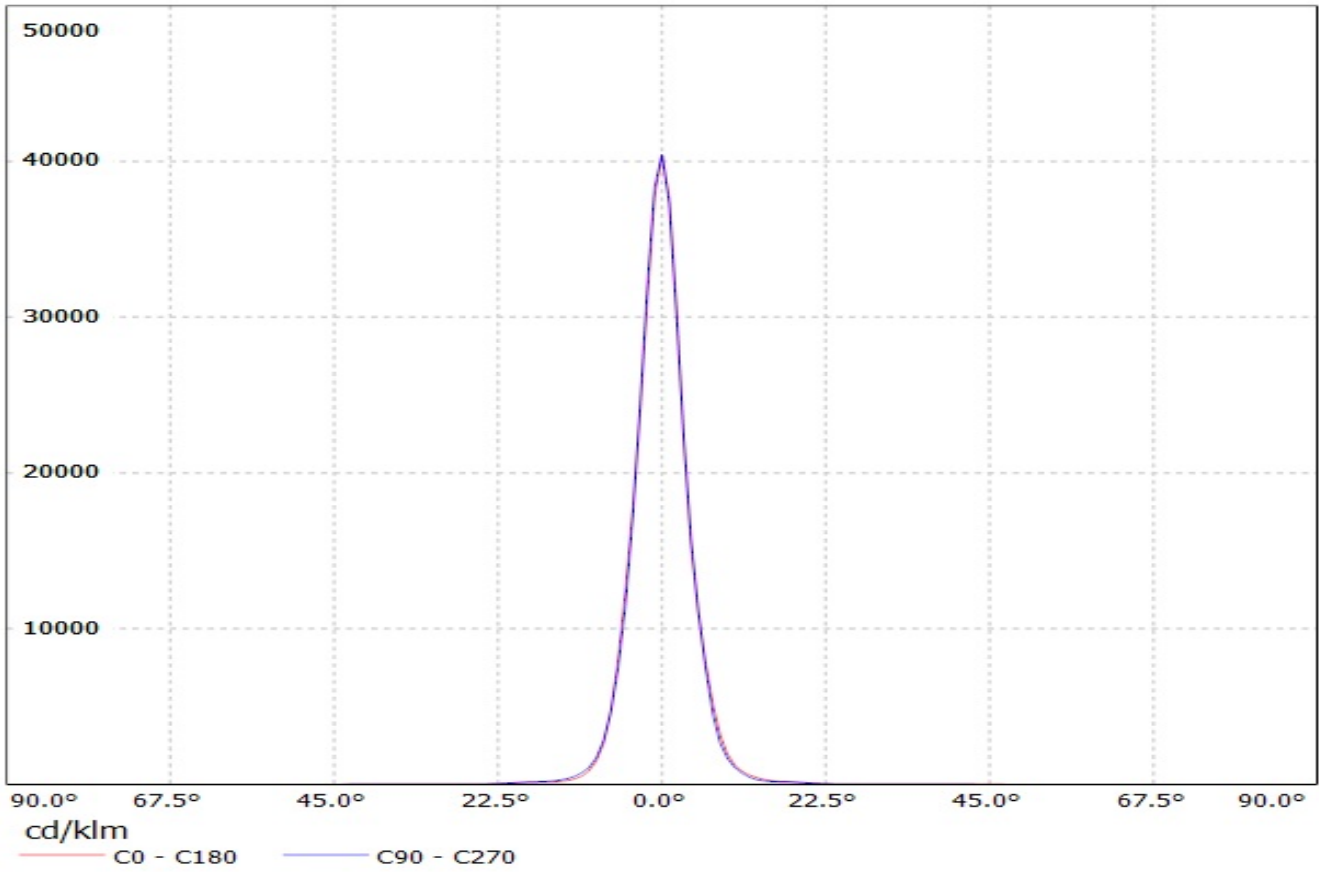

Luminaire: LEDiL Oy FCA12077\_IRIS\_(Z\_ES)  
Lamps: 1 x Philips\_Lumileds\_Luxeon\_Z\_ES\_(LXZ2-5070)  
\_84.6528lm@250mA\_P=0.730483W\_I=249.9mA

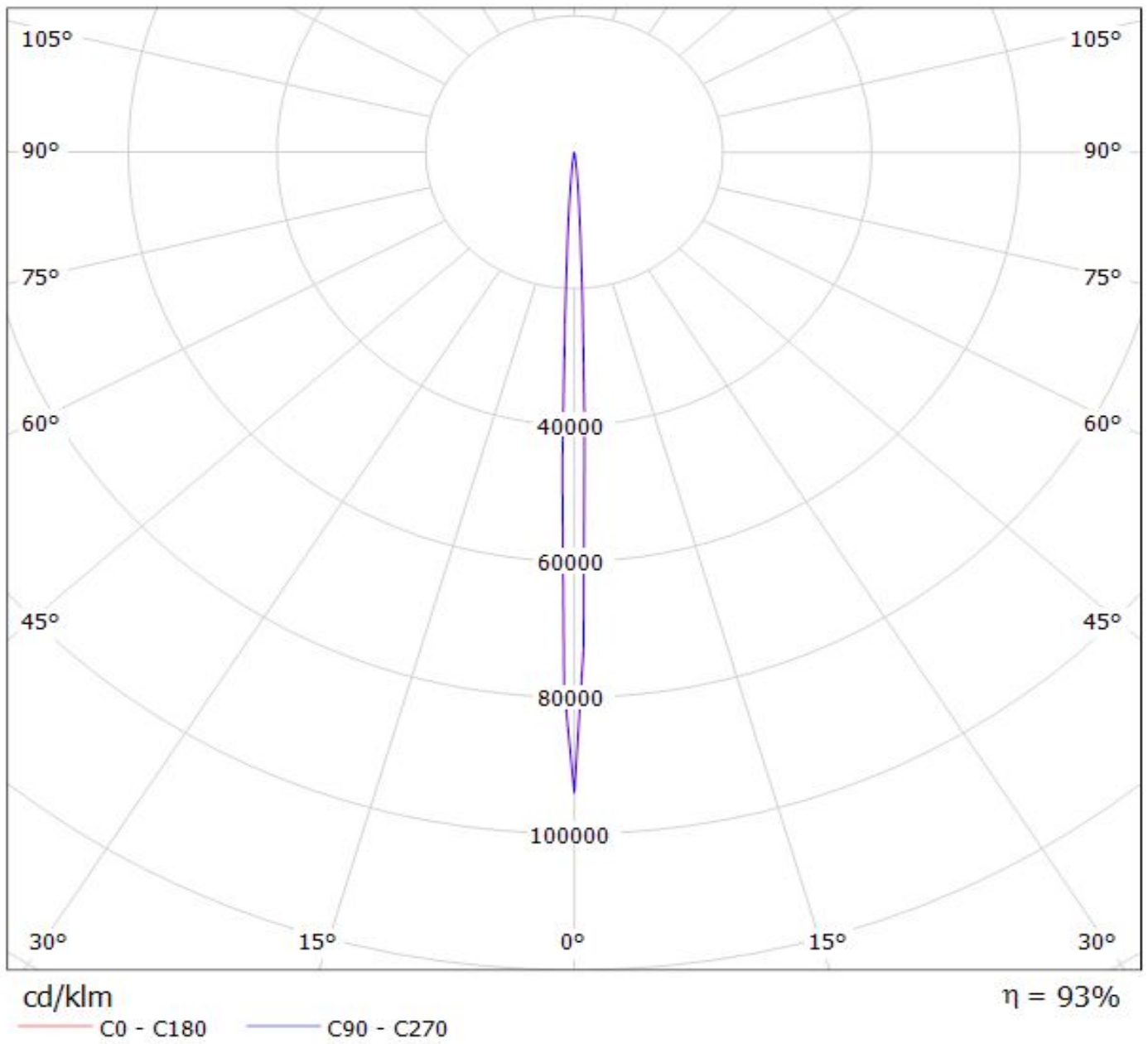

Valaisin: LEDIL OY FCA12077\_IRIS\_(XP-G2) Efficiency=95%  
Lamput: 1 x Cree XP-G2 (109.1lm @ 250mA)

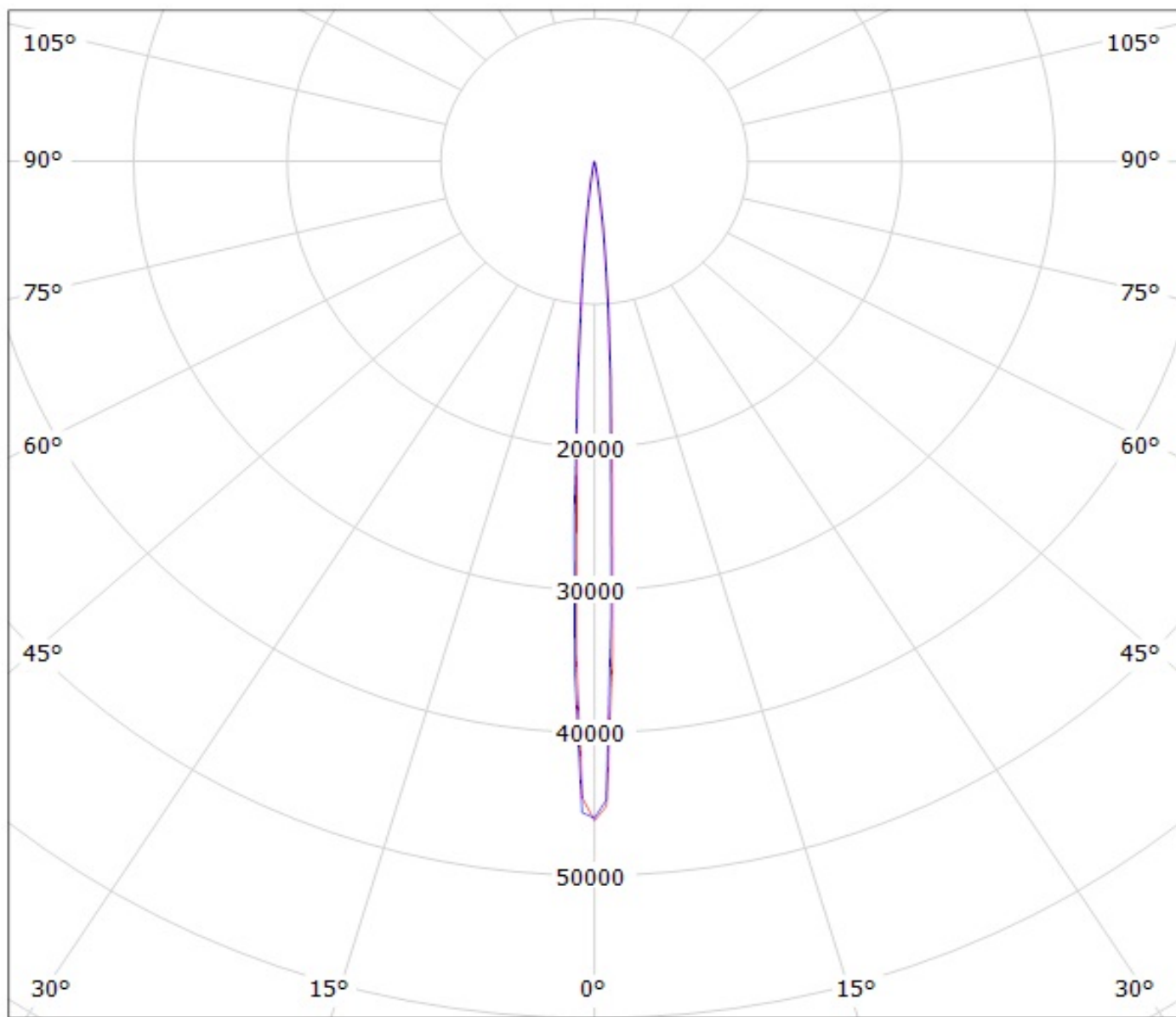

cd/klm

— C0 - C180    — C90 - C270

Luminaire: Ledil Oy FCA12077\_IRIS\_(Luxeon\_TX)

Lamps: 1 x Philips Lumileds Luxeon TX (80.78lm @ 250mA) P=0.7W I=250mA

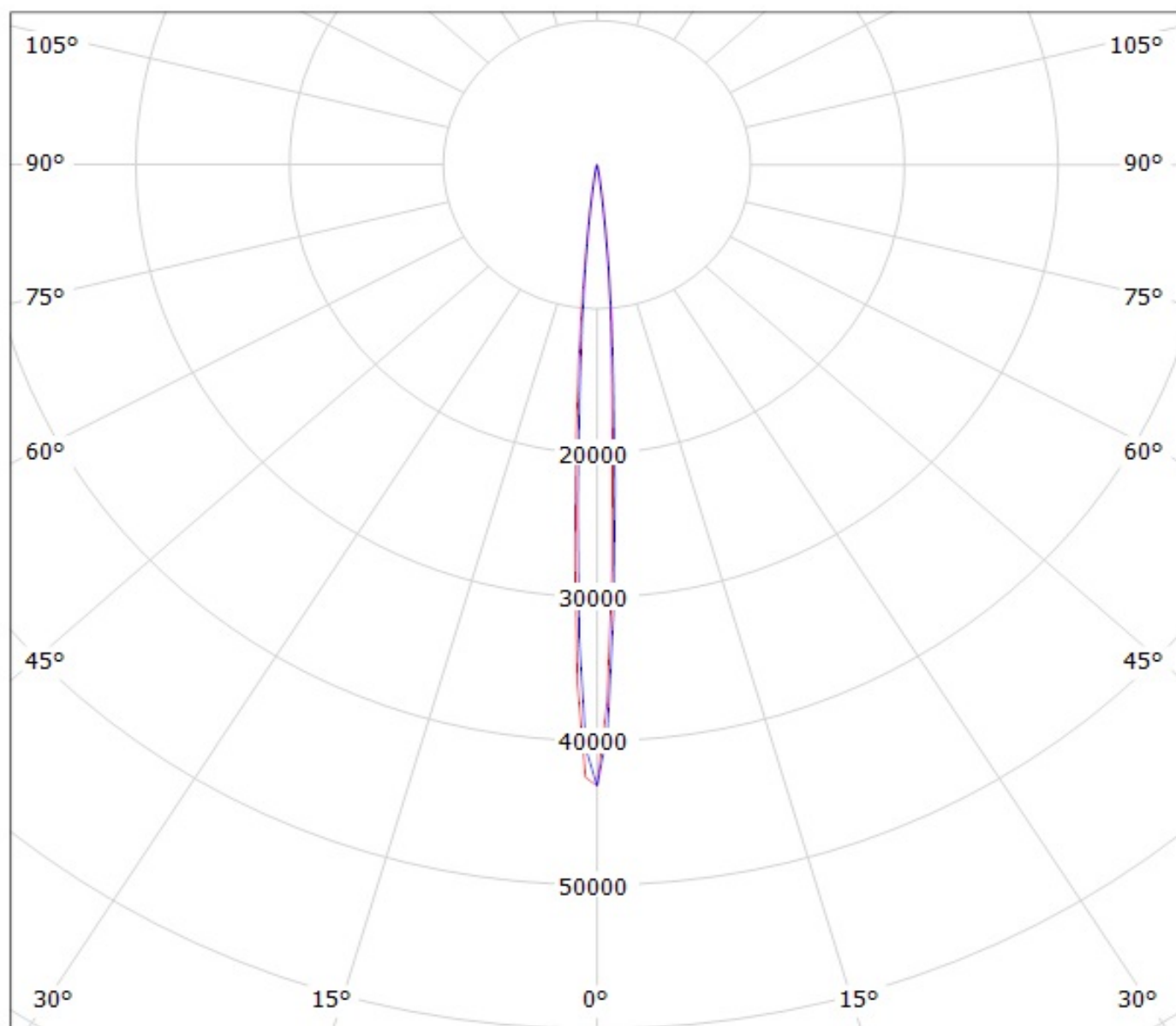

cd/klm

— C0 - C180

— C90 - C270

$\eta = 89\%$

# LEDiL Oy FCA12077\_IRIS\_(LUXEON\_T)\_1 Eff.94.6% / LDC (Polar)

Luminaire: LEDiL Oy FCA12077\_IRIS\_(LUXEON\_T)\_1 Eff.94.6%  
Lamps: 1 x LUXEON T (74lm@250mA)

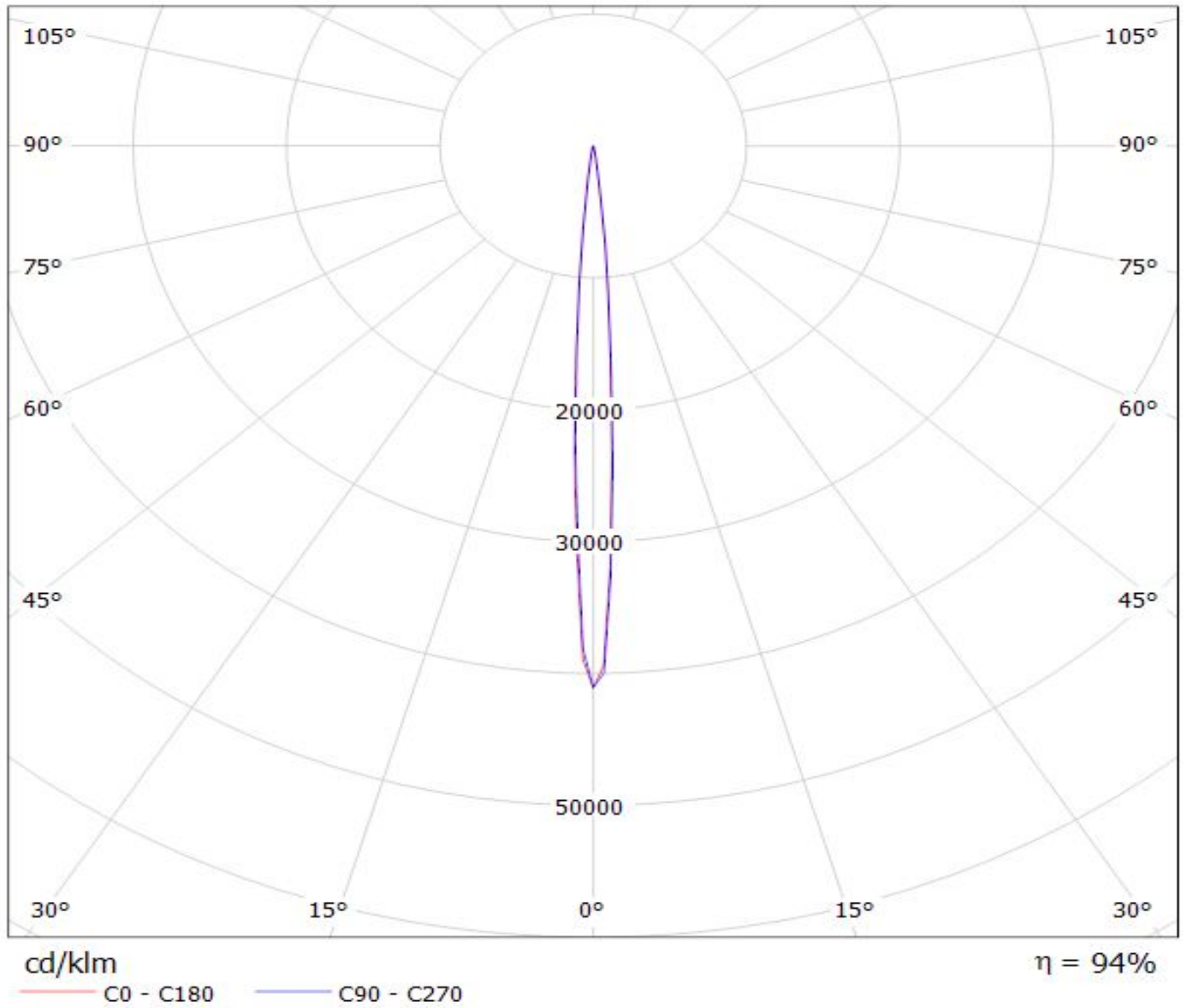

Luminaire: LEDil Oy FCA12077\_IRIS\_(LH351Z)

Lamps: 1 x Samsung LH351Z (90.14lm @ 250mA) CCT=6500K P=0.7W I=250mA

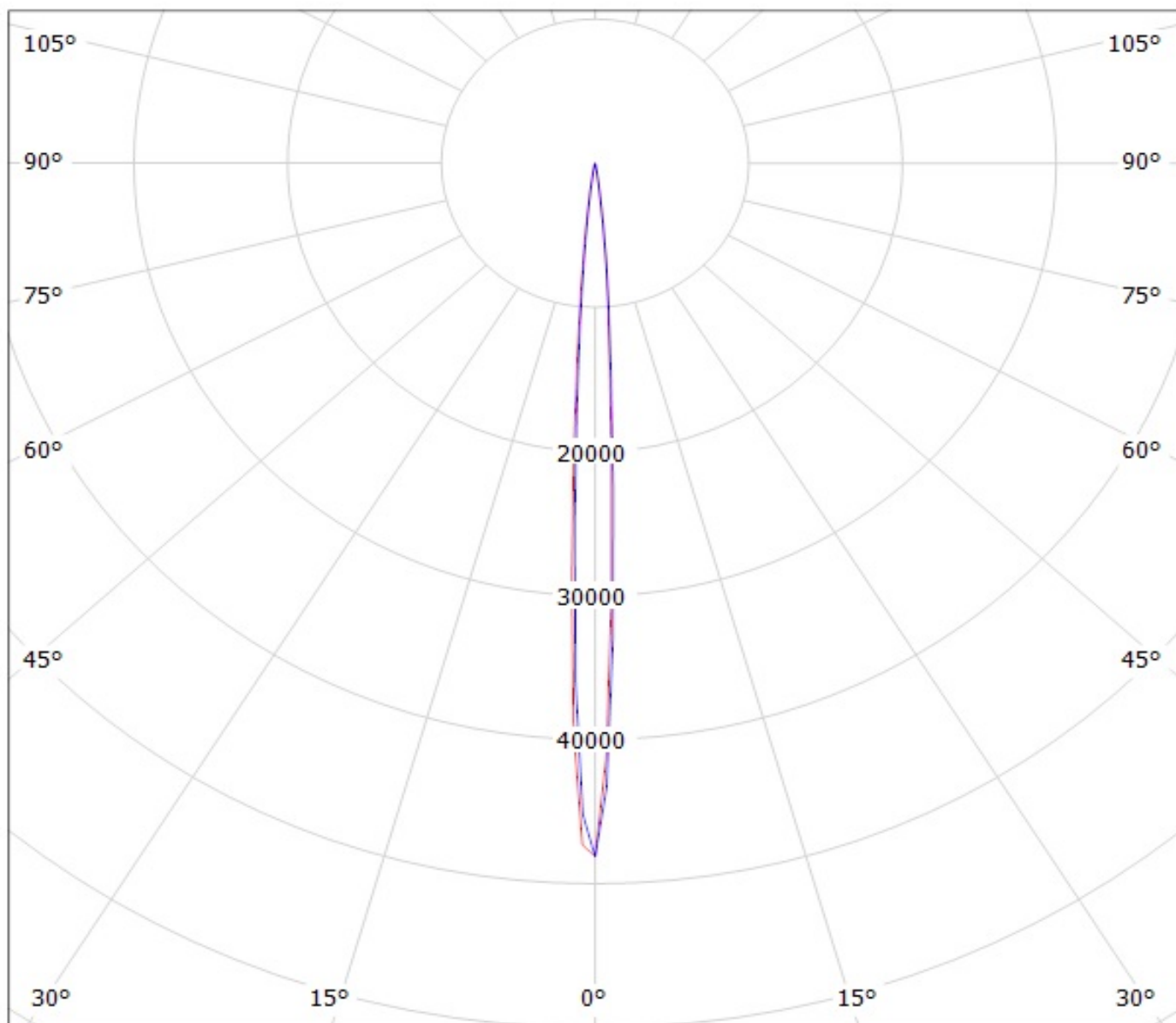

cd/klm

— C0 - C180

— C90 - C270

$\eta = 89\%$



Luminaire: Ledil Oy FCA12077\_IRIS\_(3535\_Ceramic\_gen2) Efficiency=89%  
Lamps: 1 x LG 3535 Ceramic gen2 (PKG5700k) 116lm @ 250mA CCT=6200k P=0.7 I=250mA

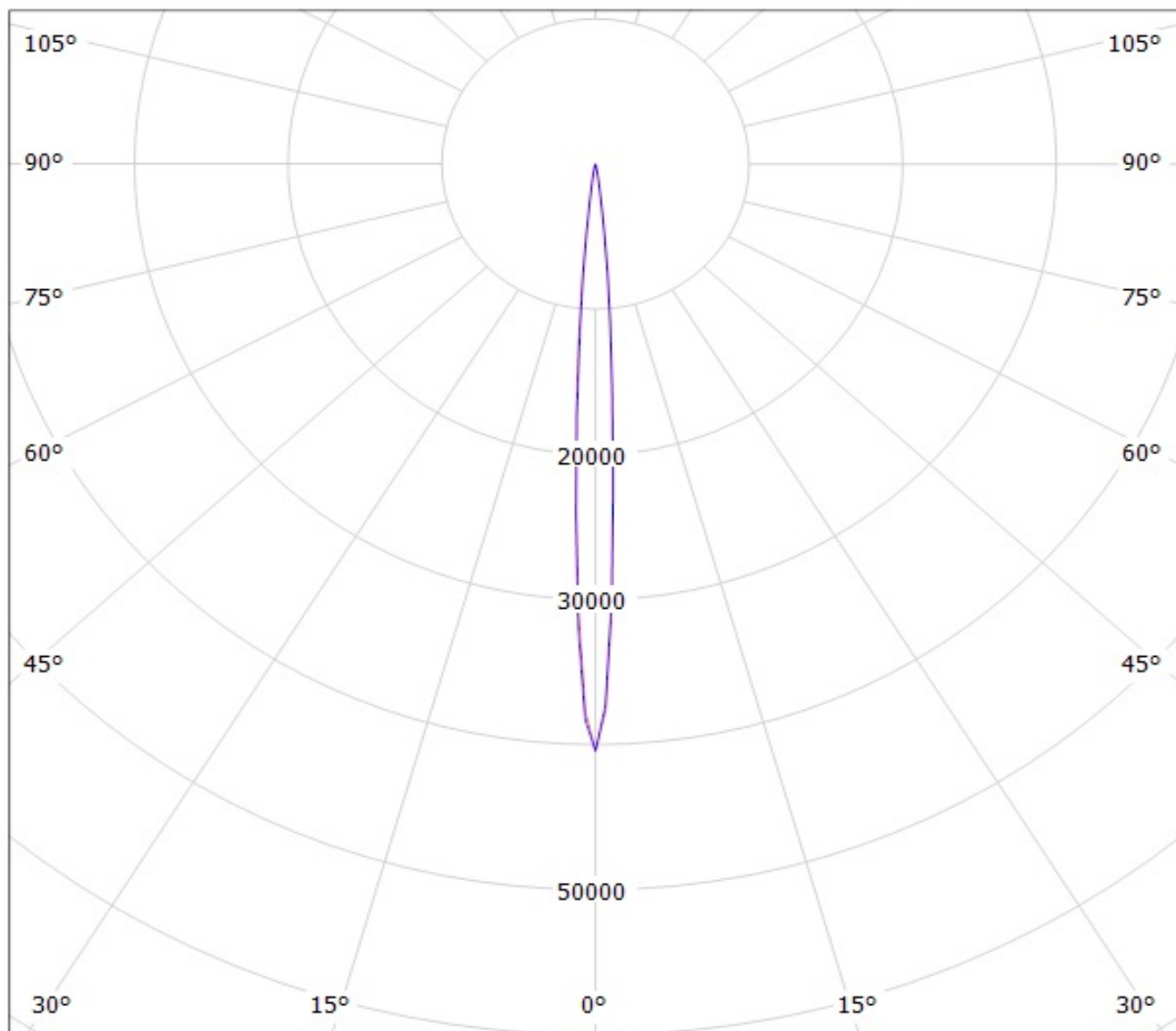

cd/klm

— C0 - C180    — C90 - C270

**NOTE: The typical divergence will be changed by different color, chip size and chip position tolerance. The typical total divergence is the full angle measured where the luminous intensity is half of the peak value.**