

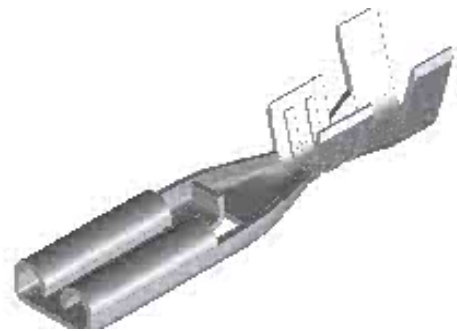

Part Number : [350729802](#)
Series Number : 35072
Status : Active - Proprietary
Product Category : Quick Disconnects



Specifications

[PK-35072-001-001.pdf](#)
[PS-35960-001-001.pdf](#)

Product Environment Compliance

Compliance

GADSL/IMDS	Compliant with Exemption 44
China RoHS	 per SJ/T 11365-2006
EU ELV	Not Relevant
Low-Halogen Status	Low-Halogen per IEC 61249-2-21
REACH SVHC	Not Contained per D(2025)4165-DC (25 June 2025)
EU RoHS	Compliant per EU 2015/863

Compliance Statements

- EU RoHS
- REACH SVHC
- Low-Halogen

Industry Documents

- IPC 1752A Class C
- IPC 1752A Class D
- Molex Product Compliance Declaration
- IEC-62474
- chemSHERPA (xml)

Substances of Interest

- PFAS

EU RoHS Certificate of Compliance

Part Details

General

Status	Active - Proprietary
Category	Quick Disconnects
Series	35072
Description	MP-Lock Quick Disconnect, Female, for 18-14 AWG (2.00-0.80mm ²), Metal Strip, Tab 6.35 x 0.81mm, Pre-Tin Plated
Product Name	MP-Lock
Type	Quick Disconnect
UPC	800754239226

Agency

CSA	LR95446
UL	E92853

Electrical

Voltage - Maximum	300V
-------------------	------

Physical

Barrel Type	Open
Gender	Female
Glow-Wire Capable	No
Insulated	No
Insulation	None
Lock to Mating Part	Yes
Material - Metal	Brass
Material - Plating Mating	Tin
Material - Plating Termination	Tin
Net Weight	0.866/g
Orientation	Straight
Packaging Type	Reel
Plating min - Mating	0.813µm

Plating min - Termination	0.813µm
Polarized to Mating Part	Yes
Tab Thickness	0.81mm
Tab Width	6.35mm
Temperature Range - Operating	-40° to +105°C
Termination Interface Style	Crimp or Compression
Wire Insulation Diameter	2.20-3.40mm
Wire Size (AWG)	14, 16, 18

Solder Process Data

Lead-Free Process Capability	N/A
------------------------------	-----

Mates With / Use With

Use with Part(s)

Description	Part Number
6.35mm Tab MP-Lock Housings	<u>35196</u>

Application Tooling

Global

Description	Part Number
Mini-Mac Applicator Rear Feed	<u>638025000</u>
Extraction Tool for Quick Disconnect	<u>638135500</u>
Hand Crimp Tool for .250" Crimp Terminals	<u>638196400</u>