

Recycled Materials

Matériaux recyclés

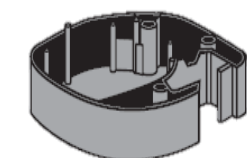
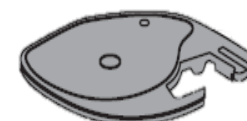
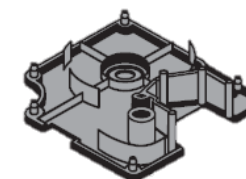
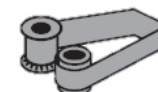
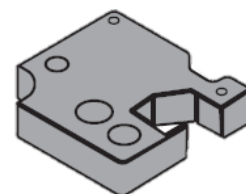

Model of D1 and Letratag cassette

80% 

80% Post Industrial Waste (PIS)

Our materials are coming from scrap materials created by manufacturers that were headed for a landfill. These scraps are then processed and re-used to create our label cassettes.

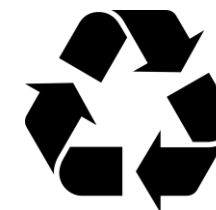

Certified via SGS – Declaration RC-006/2 – available upon request.

Recycled Materials

Matériaux recyclés

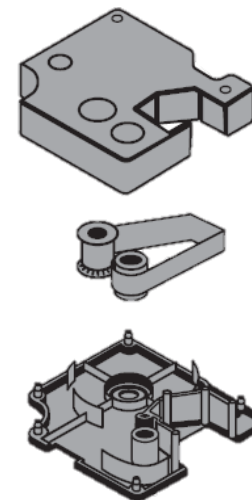

Model of D1 and Letratag cassette

75% 

75% Post Industrial Waste (PIS)

Our materials are coming from scrap materials created by manufacturers that were headed for a landfill. These scraps are then processed and re-used to create our label cassettes.

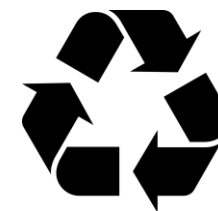

Certified via SGS – Declaration RC-006/2 – available upon request.