



POSITION SWITCH IN COMPACT DESIGN 30MM WIDE  
WITH CONNECTION CABLE 5M SNAP-ACTION  
CONTACTS 1NO+1NC WITH ROLLER PLUNGER,

**General technical details:**

<b>product designation</b>		compact switch
<b>Insulation voltage</b>		
• rated value	V	400
<b>Degree of pollution</b>		3
<b>Thermal current</b>	A	10
<b>Operating current</b>		
• at AC-15		
• at 125 V / rated value	A	6
• at 230 V / rated value	A	3
• at DC-13		
• at 125 V / rated value	A	0.55
• at 230 V / rated value	A	0.27
<b>Continuous current</b>		
• of the slow DIAZED fuse link	A	10
• of the quick DIAZED fuse link	A	10
• of the C characteristic circuit breaker	A	3
<b>Mechanical operating cycles as operating time</b>		
• typical		5,000,000
<b>Electrical operating cycles as operating time</b>		

<ul style="list-style-type: none"> <li>with contactor 3RH11, 3RT1016, 3RT1017, 3RT1024, 3RT1025, 3RT1026 / typical</li> </ul>		500,000
<ul style="list-style-type: none"> <li>at AC-15 / at 230 V / typical</li> </ul>		100,000
<b>Electrical operating cycles in one hour</b>		
<ul style="list-style-type: none"> <li>with contactor 3RH11, 3RT1016, 3RT1017, 3RT1024, 3RT1025, 3RT1026</li> </ul>		1,800
<b>Repeat accuracy</b>	mm	0.05
<b>Design of the contact element</b>		snap-action contacts
<b>Number of NC contacts</b>		
<ul style="list-style-type: none"> <li>for auxiliary contacts</li> </ul>		1
<b>Design of the switching function</b>		snap-action contact
<b>Number of NO contacts</b>		
<ul style="list-style-type: none"> <li>for auxiliary contacts</li> </ul>		1
<b>Resistance against vibration</b>		0.35 mm / 5g
<b>Resistance against shock</b>		30g / 11 ms
<b>Ambient temperature</b>		
<ul style="list-style-type: none"> <li>during operating</li> </ul>	°C	-25 ... 85
<ul style="list-style-type: none"> <li>during storage</li> </ul>	°C	-25 ... 85
<b>Width of the sensor</b>	mm	30
<b>material</b>		
<ul style="list-style-type: none"> <li>of the housing</li> </ul>		metal
<b>Material / of the housing / of the switch head</b>		stainless steel
<b>Design of the operating mechanism</b>		roller plunger
<b>Actuating speed</b>	mm/s / m/s	0.05 ... 2
<b>Minimum actuating force / in activation direction</b>	N	15
<b>Protection class IP</b>		IP67
<b>Built in orientation</b>		any
<b>Design of the electrical connection</b>		cable connection 5x 0.75 m2 PVC
<b>Item designation</b>		
<ul style="list-style-type: none"> <li>according to DIN 40719 extendable after IEC 204-2</li> </ul>		S
<ul style="list-style-type: none"> <li>according to DIN EN 61346-2</li> </ul>		B

#### Certificates/approvals:

**General Product Approval**

**other**

[ROSTEST](#)

[Manufacturer](#)

#### Further information:

**Information- and Downloadcenter (Catalogs, Brochures,...)**

<http://www.siemens.com/industrial-controls/catalogs>

**Industry Mall (Online ordering system)**

<http://www.siemens.com/industrial-controls/mall>

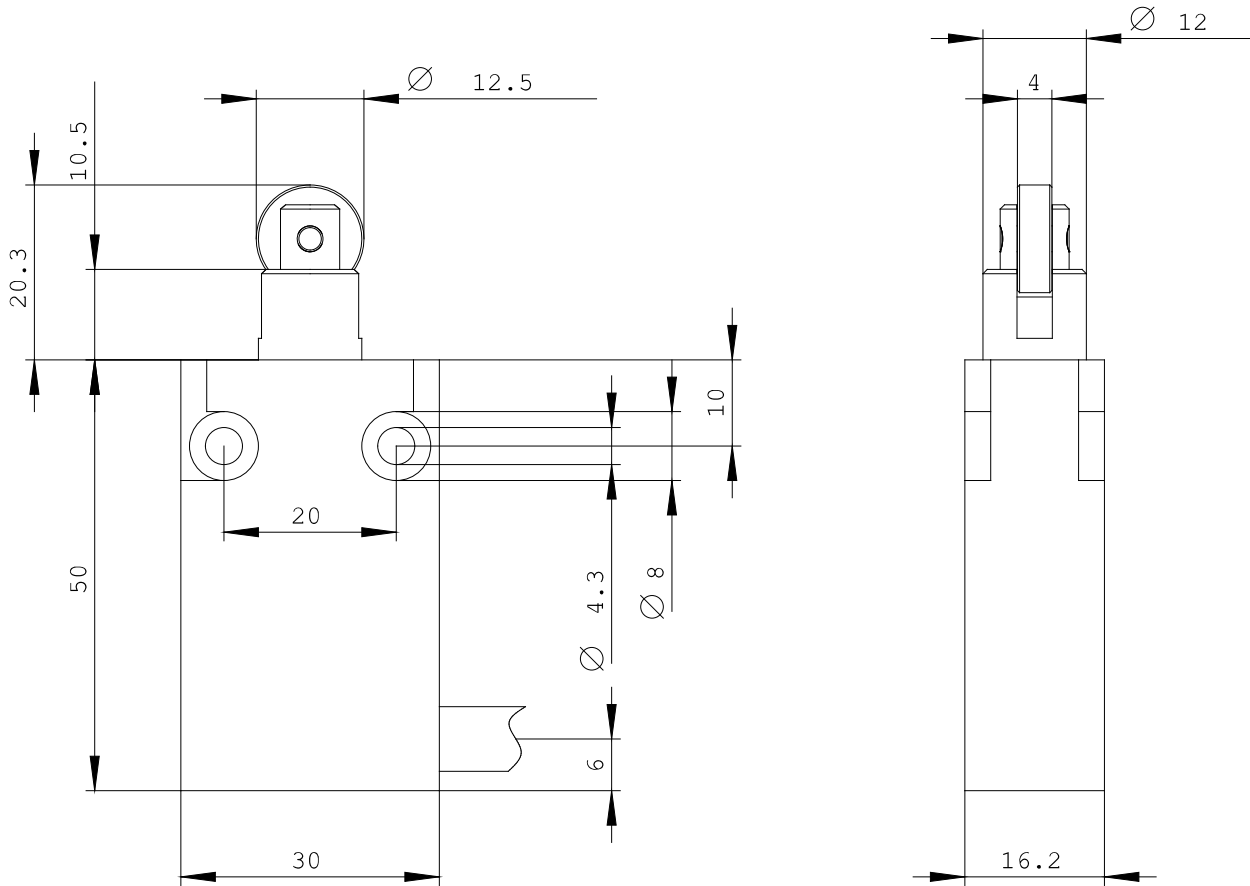

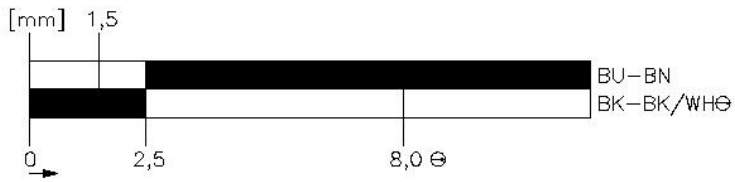

**last change:**

Aug 25, 2011