

1

2

3

4

5

6

7

**Male**

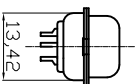
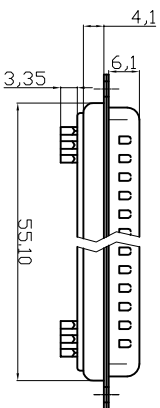
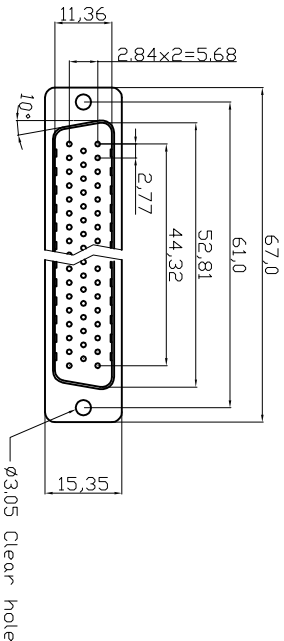
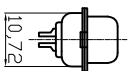
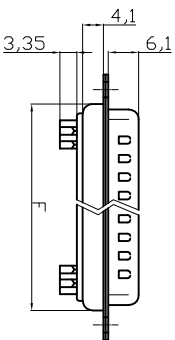
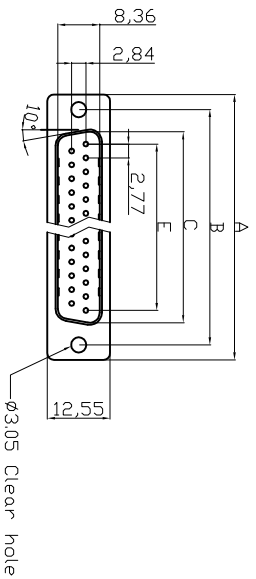

**50 Positions**

Positions	A	B	C	E	F
9	30.81	24.99	16.92	11.08	19.20
15	39.20	33.30	25.25	19.39	27.70
25	53.04	47.04	38.96	33.24	41.10
37	69.40	63.50	55.42	49.86	57.30

**Electrical**  
 Contact Resistance : 20 milliohms Max at 1 AMP DC.  
 Insulation Resistance : 1000 megohms at 500 VDC  
 Dielectric Withstanding Voltage : 1000 VAC/rms 60Hz for 1 minute  
 Current Rating : 3 AMP  
 Voltage Rating : 250 VAC/rms 60Hz  
 Ⓢ OPERATING TEMPERATURE:-55°C+105°C  
 Order Code:

**A-Dx xx LLZ**  
 Contact style: LLZ - Selective gold\*  
 F - Female  
 S - Male  
 No. of Contacts  
 09 / 15 / 29 / 37  
 \* Quality class III

**ROHS compliant**  
Unit: mm

Scale	Free				
<b>TOLERANCE</b>					
X.	±0.38				
X.X	±0.25				
X.XX	±0.13				
<b>DIM</b>					
X.	±3°	Ⓢ	Update operation temperature range	13.05.2014	Winnie
X.X°	±1.0°	Ⓢ	Drawn	15.08.2012	Lucas
Angle	TOL	Id.	Modification	Date	Name

Customer-No.

ASSMANN WSW-No.

**A-Dx xx LLZ**

Drawing-No.

**ASS 4884 CO**

rev01



Replace

Sheet 1/2

1

2

3

4

5

6

7

H

G

F

E

D

C

B

A

H

G

F

E

D

C

B

A

1

2

3

4

5

6

7

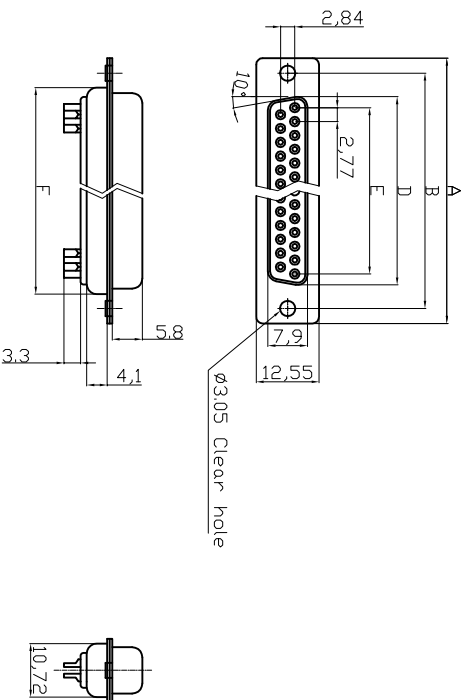
**Female**

**Product Specification**  
**Material**  
 Insulator : Glass-Filled Thermoplastic PBT, UL94V-0, White  
 Contact : Brass or Phosphor Bronze, Gold flash selective gold plating  
 Shell : Steel, refer to ordering information for plating  
 Clinch Nut : Brass, Nickel Plated  
 Boardlock : Brass, Nickel Plated  
 Screwlock : Brass, Nickel Plated

**Electrical**  
 Contact Resistance : 20 milliohms Max at 1 AMP DC,  
 Insulation Resistance : 1000 megohms at 500 VDC  
 Dielectric Withstanding Voltage : 1000 VAC/rms 60Hz for 1 minute  
 Current Rating : 3 AMP  
 Voltage Rating : 250 VAC/rms 60Hz  
 Operating Temperature : -55°C+105°C

Dimensions	A	B	D	E	F
Positions					
9	30.81	24.99	16.33	11.08	19.20
15	39.20	33.30	24.70	19.39	27.70
25	53.05	47.04	38.40	33.24	41.10
37	69.40	63.50	54.84	49.86	57.30

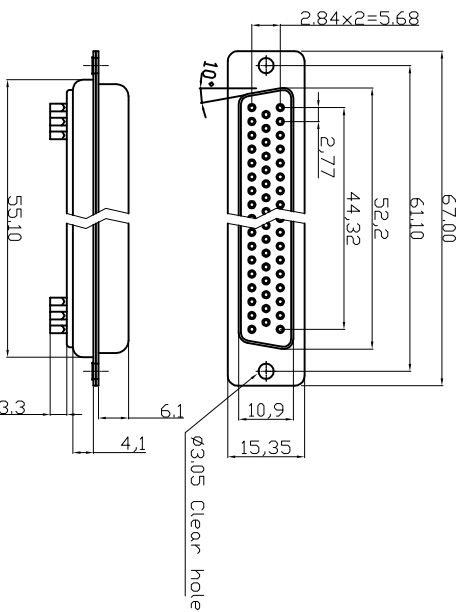
**50 Positions****ROHS compliant**  
Unit:mm

Scale	Free				
<b>TOLERANCE</b>					
X.	±0.38				
X.X	±0.25				
X.XX	±0.13				
<b>DIM</b>					
<b>TOL</b>					
X.°	±3°	①	Update operation temperature range	13.05.2014	Winnie
X.X°	±1.0°	②	Drawn	15.08.2012	Lucas
Angle	TOL	Id.	Modification	Date	Name

Customer-No.

ASSMANN WSW-No.

**A-Dx xx LL/Z**

Drawing-No.

**ASS 4884 CO**

rev01

**ASSMANN**  
WSW/ components

Replace

Sheet  
2/2

1

2

3

4

5

6

7

H

G

F

E

D

C

B

A

H

G

F

E

D

C

B

A