

THIS DRAWING IS UNPUBLISHED. RELEASED FOR PUBLICATION 2008  
 © COPYRIGHT 2008 BY - ALL RIGHTS RESERVED.

LOC		DIST		REVISIONS			
P	LTR	DESCRIPTION	DATE	DWN	APVD		
GP	00						
	12	REVISED PER ECO-11-005027	18MAR2011	RK	HMR		

ISOMETRIC VIEW  
 INSIDE/TOP ANGLE  
 SCALE 2:1

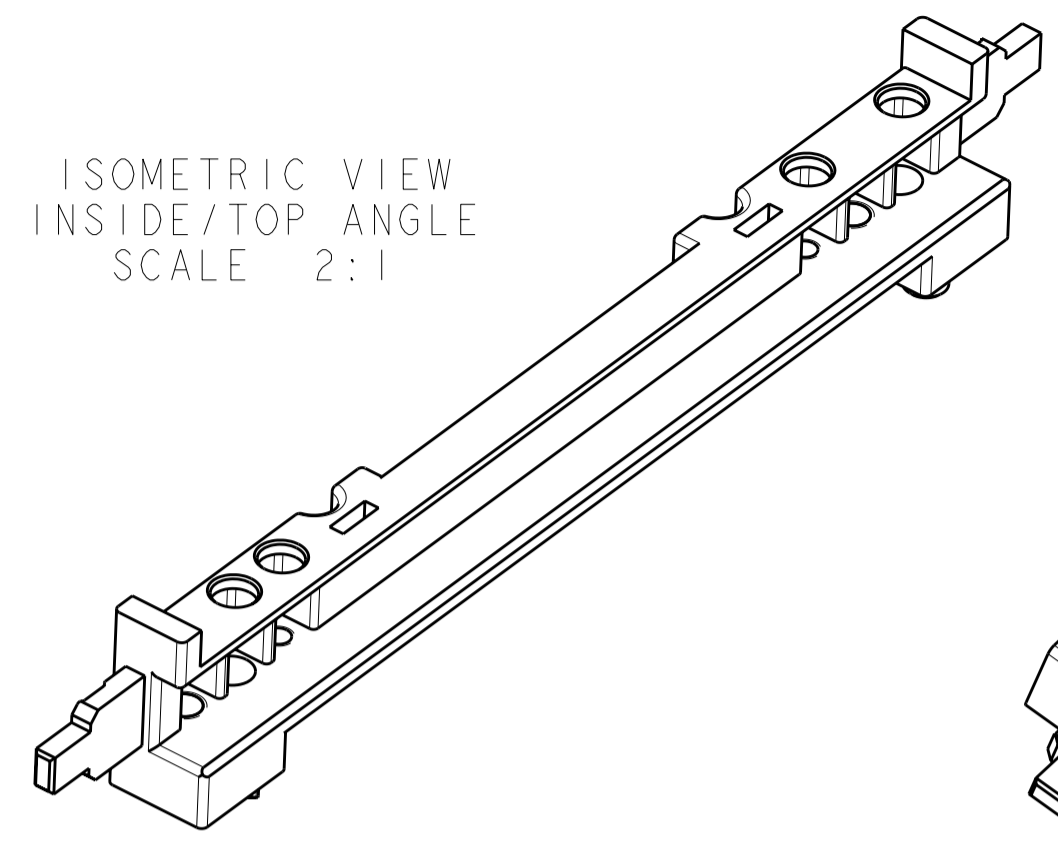

ISOMETRIC VIEW  
 OUTSIDE/BOTTOM ANGLE  
 SCALE 2:1

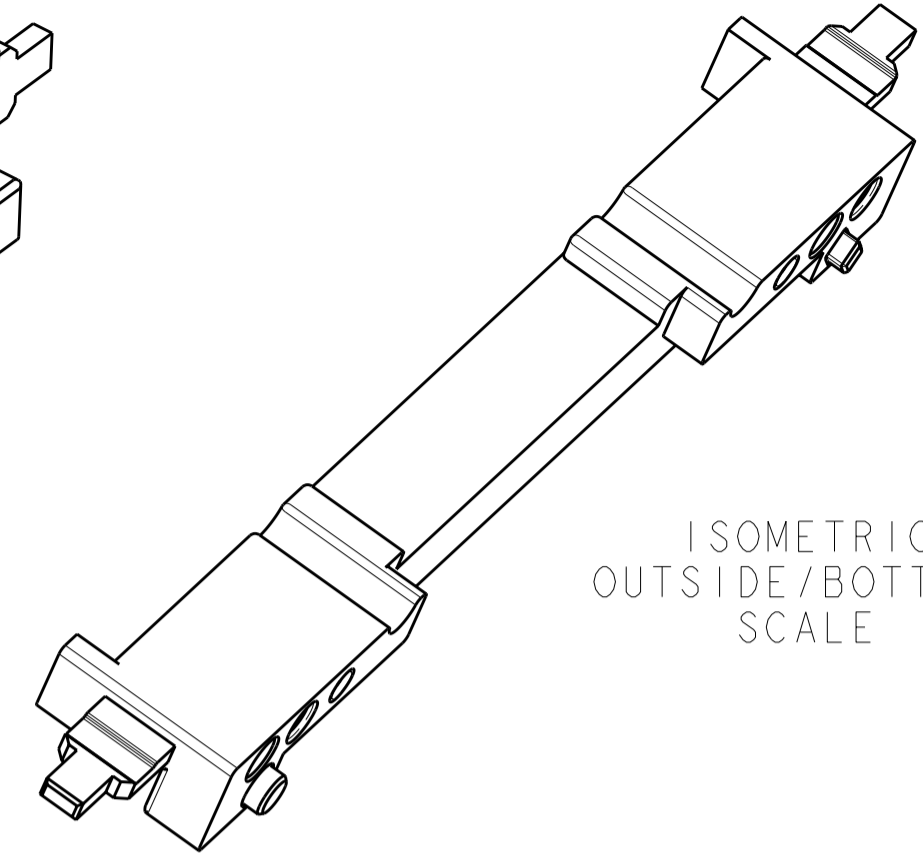

- ① MATERIAL: ZINC ALLOY PER ASTM B 86, AG40A.
- ② FINISH: 1.27µm MIN NICKEL PLATE PER QQ-N-290  
 OVER 5.08µm MIN COPPER PLATE PER AMS 2418.

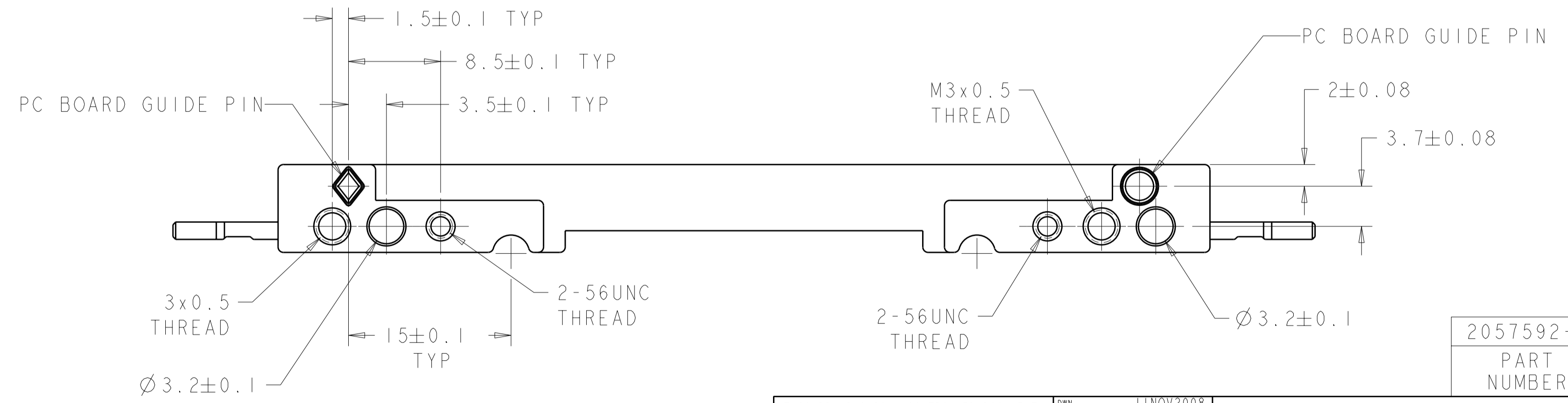
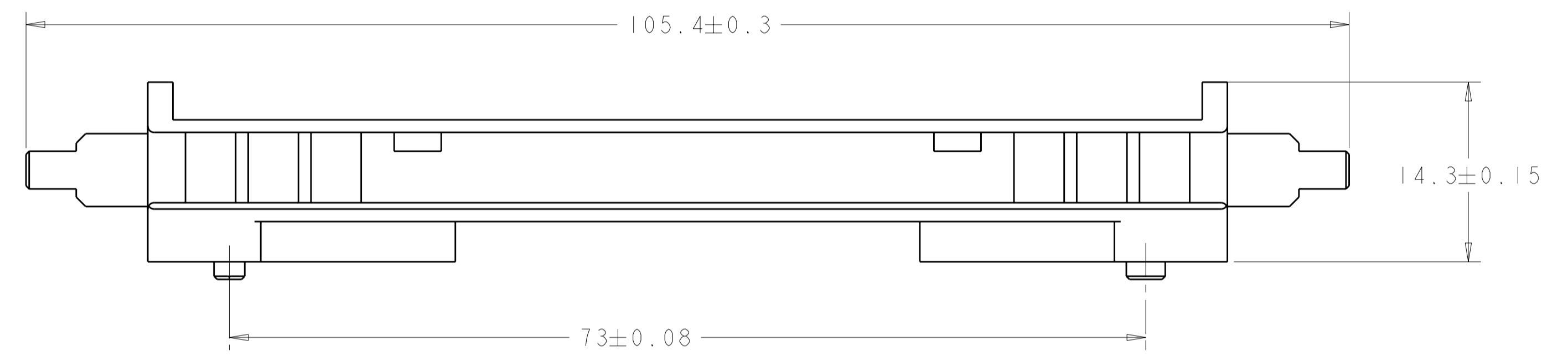
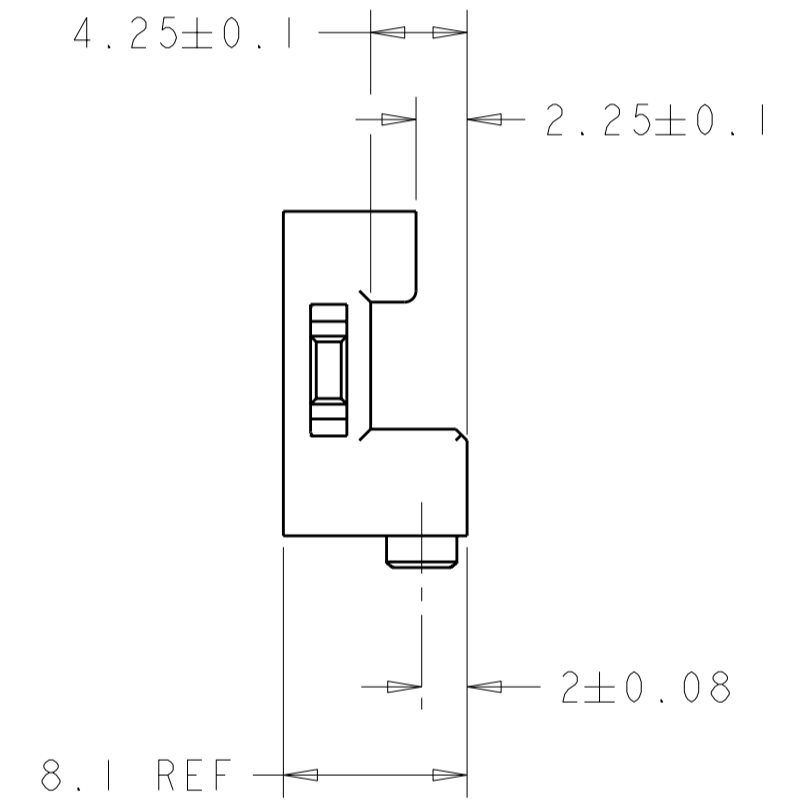

2057592-2  
 PART NUMBER

THIS DRAWING IS A CONTROLLED DOCUMENT.		DWN C. VALENTINE 11NOV2008	TE Connectivity	
DIMENSIONS: mm		CHK E. BRIGHT 11NOV2008		
TOLERANCES UNLESS OTHERWISE SPECIFIED:		APVD E. BRIGHT 11NOV2008	NAME GUIDE RAIL, 100 GIG PLUGGABLE	
0 PLC ± 1 PLC ± 2 PLC ± 3 PLC ± 4 PLC ± ANGLES ± FINISH		PRODUCT SPEC -	SIZE A200779	DRAWING NO C-2057592
MATERIAL		WEIGHT -	CAGE CODE A200779	RESTRICTED TO -
MATERIAL ① FINISH ②		CUSTOMER DRAWING	SCALE 3:1	SHEET 1 OF 1 REV 12