

Product data sheet

Specifications



Photoelectric sensors XU, XUY, fork, laser, pot +/-, 120X95mm, 12...24 VDC, M8

XUYFLNEP100120

Main

| | |
|-------------------------------|-------------------------------------------------------------------------------------------------------------------------------|
| Range of product | Telemecanique Photoelectric sensors XU |
| Series name | Application |
| Electronic sensor type | Photo-electric sensor |
| Sensor name | XUY |
| Sensor design | Fork |
| Detection system | Thru beam |
| Emission | Infrared laser, modulated - class 1 conforming to IEC 825-1 |
| Passage width | 120 mm |
| Passage depth | 95 mm |
| Material | Metal/plastic |
| Supply circuit type | DC |
| Wiring technique | 4-wire |
| Discrete output type | PNP and NPN |
| Discrete output function | 1 NO or 1 NC programmable |
| Electrical connection | 1 male connector M8, 4 pins |
| Product specific application | Detection of transparent object Detection of reference marks Detection on small conveyor Detection on vibrating rail |
| [Sn] nominal sensing distance | 120 mm |

Complementary

| | |
|---------------------------------------|---------------------------------------------------------------------------------|
| Enclosure material | Painted aluminium and polyamide/glass |
| Keypad type | Green |
| Minimum object diameter for detection | 0.05 mm |
| Type of output signal | Discrete |
| Output type | Solid state |
| Status LED | Adjustment mode and keypad locking: 1 LED (red) Output state: 1 LED (yellow) |
| [Us] rated supply voltage | 12...24 V DC with reverse polarity protection |
| Supply voltage limits | 10...30 V DC |

| | |
|--------------------------|------------------------------------------------|
| Switching capacity in mA | 100 mA (overload and short-circuit protection) |
| Switching frequency | 10 kHz |
| Maximum voltage drop | <2 V (closed state) |
| Current consumption | 40 mA no-load |
| Load capacitance | 330 nF |
| Time response | -20...20 µs |
| Setting-up | Sensitivity by numeric potentiometer |
| Net weight | 0.19 kg |

Environment

| | |
|---------------------------------------|----------------------------------------------------------------------------|
| Product certifications | CE cULus |
| Ambient air temperature for operation | -20...60 °C |
| Ambient air temperature for storage | -30...80 °C |
| Immunity to ambient light | 10000 lux natural light 5000 lux incandescent bulb |
| Vibration resistance | 7 gn, amplitude = +/- 0.75 mm (f = 10...55 Hz) conforming to IEC 60068-2-6 |
| Shock resistance | 30 gn (duration = 11 ms) conforming to IEC 60068-2-27 |
| IP degree of protection | IP65 conforming to IEC 60529 |

Packing Units

| | |
|------------------------------|---------|
| Unit Type of Package 1 | PCE |
| Number of Units in Package 1 | 1 |
| Package 1 Weight | 128.0 g |
| Package 1 Height | 1.5 cm |
| Package 1 width | 16 cm |
| Package 1 Length | 13 cm |

Offer Sustainability

| | |
|----------------------------|-----------------------------------------------------------------------------------------------------------------------------------------------------------------------------------------------------------------------------------------------------------------------------------------------------------------------------------------------------------------------------------|
| REACH Regulation | REACH Declaration |
| EU RoHS Directive | Pro-active compliance (Product out of EU RoHS legal scope) EU RoHS Declaration |
| Mercury free | Yes |
| RoHS exemption information | Yes |
| California proposition 65 | WARNING: This product can expose you to chemicals including: Diisononyl phthalate (DINP), which is known to the State of California to cause cancer, and Di-isodecyl phthalate (DIDP), which is known to the State of California to cause birth defects or other reproductive harm. For more information go to www.P65Warnings.ca.gov |

Contractual warranty

| | |
|----------|-----------|
| Warranty | 18 months |
|----------|-----------|

Dimensions

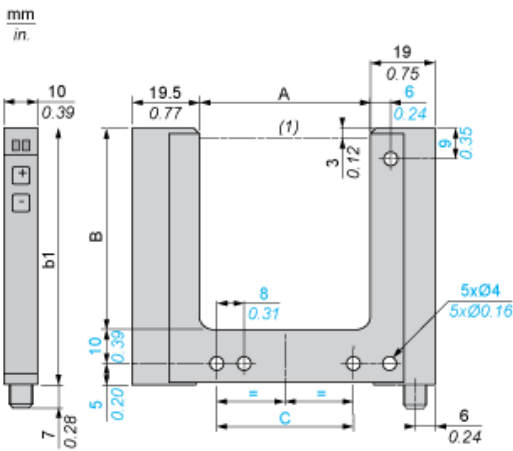

(1) Optical axis

Dimensions in mm

| A | B | b1 | C |
|-----|----|-----|-----|
| 120 | 95 | 110 | 110 |

Dimensions in in.

| A | B | b1 | C |
|------|------|------|------|
| 4.72 | 3.74 | 4.33 | 4.33 |

Wiring Schemes

M8 Connector

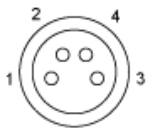

- 1 : BN: Brown
- 2 : WH: White
- 3 : BU: Blue
- 4 : BK: Black

4-Wire, PNP/NPN Outputs

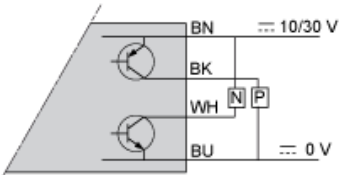

- BN : Brown
- WH : White
- BK : Black
- BU : Blue