

M/scale 1:1

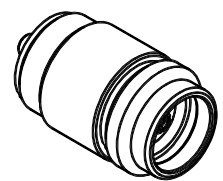

				general tolerance ISO 2768 mH angle: $\pm 2^\circ$		scale: 5:1	
				generate 29.06.06 checked Norm 47497		Assembly instruction: Stripping dimension: SN-Chassisbuchse Bulkhead jack	
Design	a	Tol. addition	10.08.06	RSc	date	name	4170.SN.2010.09'
						Schwaer	
nr.	rev.	alteration	date	name			Rev. a