

REVISIONS					
P	LTR	DESCRIPTION	DATE	DWN	APVD
A		INITIAL RELEASE	09JUL2025	WB	SA

NOTES:  
 1.MATERIAL:  
 HOUSING:HIGH TEMP THERMO PLASTIC UL94V-0  
 CONTACT:COPPER ALLOY  
 SOLDER PEG:COPPER ALLOY  
 2.FINISH  
 UNDERPLATED:30U".NICKEL ALL OVER  
 CONTACT MATING AREA:AU 8U"  
 SOLDER AREA:GOLD FLASH

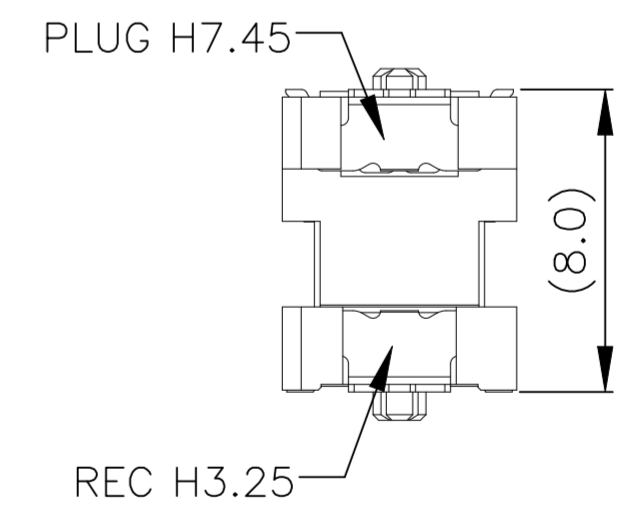
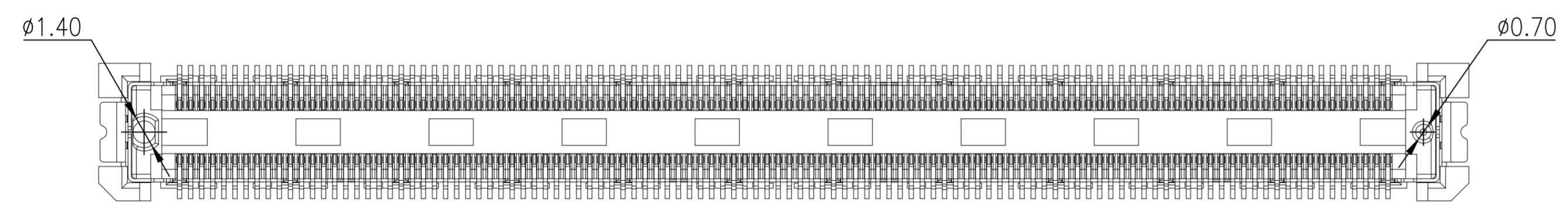
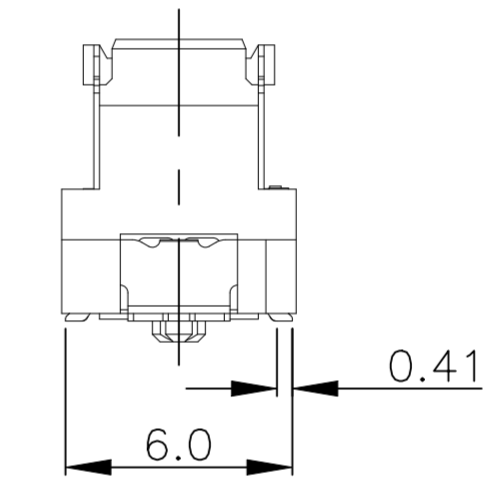
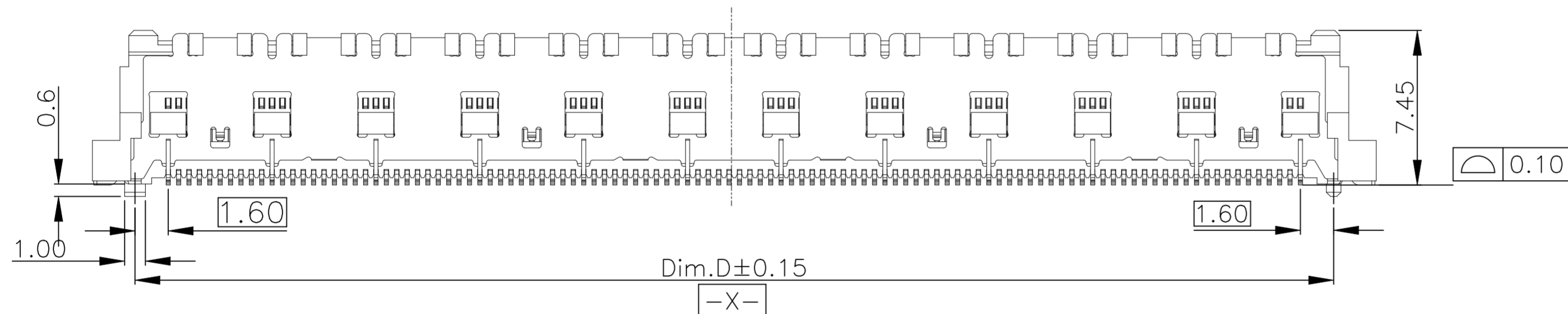
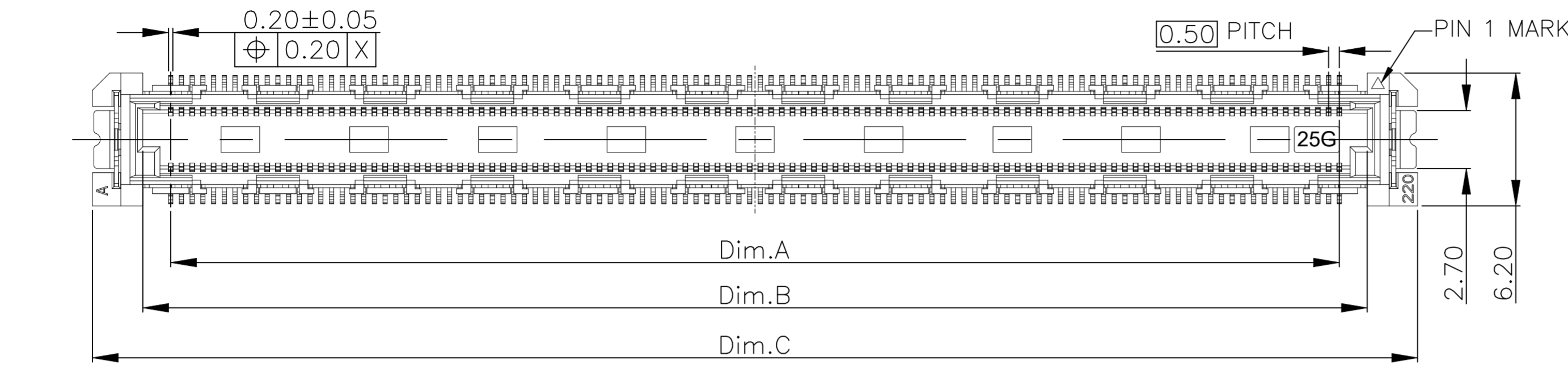

220	2499538-5	54.50	57.10	61.8	57.70	55.50
160	2499538-4	39.50	42.10	46.8	42.70	40.50
120	2499538-3	29.50	32.10	36.8	32.70	30.50
80	2499538-2	19.50	22.10	26.8	22.70	20.50
40	2499538-1	9.50	12.10	16.8	12.70	10.50
PIN NO.	TE PN's	DIM.'A'	DIM.'B'	DIM.'C'	DIM.'D'	DIM.'E'

MATED HIGHT

THIS DRAWING IS A CONTROLLED DOCUMENT.		DWN MANOJ K 13DEC2024	TE Connectivity	
DIMENSIONS: mm		CHK GOWTHAM CHITTY 13DEC2024		
TOLERANCES UNLESS OTHERWISE SPECIFIED:		APVD JAGRUTI MOHANTY 13DEC2024	NAME -	
0 PLC ± 0.50		PRODUCT SPEC -		
1 PLC ± 0.20		108-161908		
2 PLC ± 0.10		APPLICATION SPEC -		
3 PLC ± 0.05		114-161404		
4 PLC ±		SIZE A2		
ANGLES ± 3'		CAGE CODE 00779		
MATERIAL SEE NOTE		DRAWING NO 2499538		
FINISH SEE NOTE		RESTRICTED TO -		
		CUSTOMER DRAWING		
		SCALE 1:1		SHEET 1 OF 10
		REV A		

2499538

REVISIONS				
P	LTR	DESCRIPTION	DATE	APVD
-	-	SEE SHEET 1	-	-

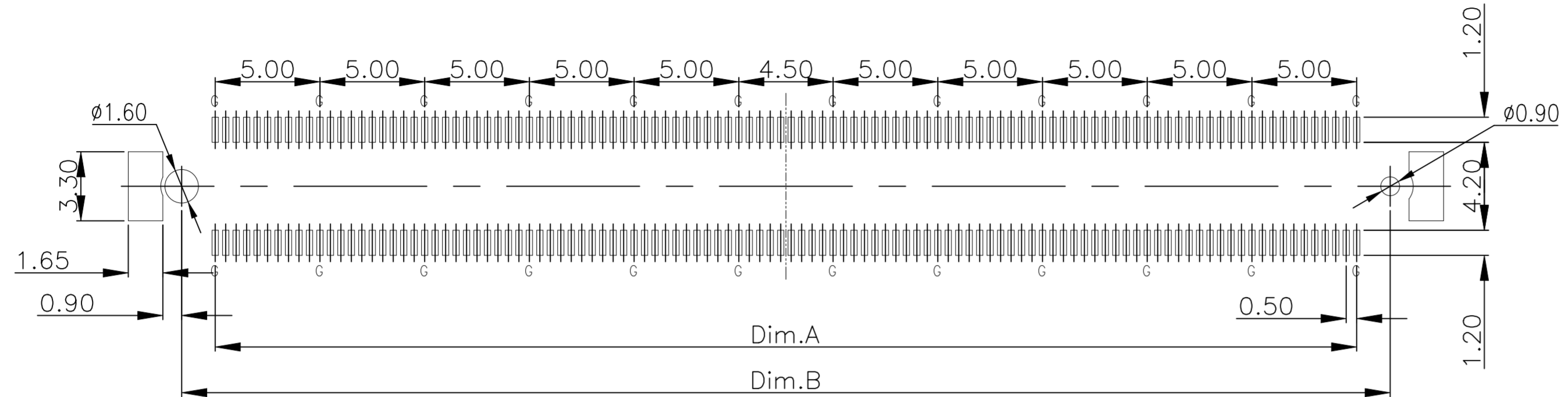

REFERENCE P.C.B LAYOUT

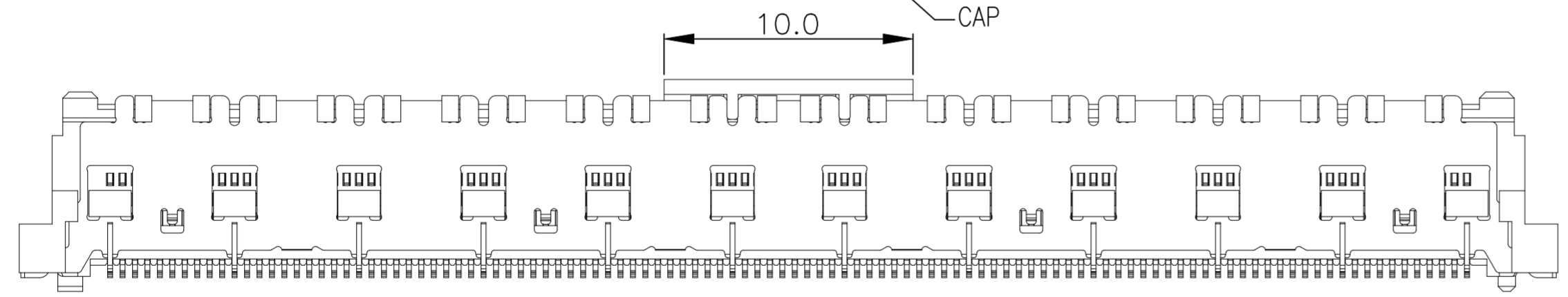
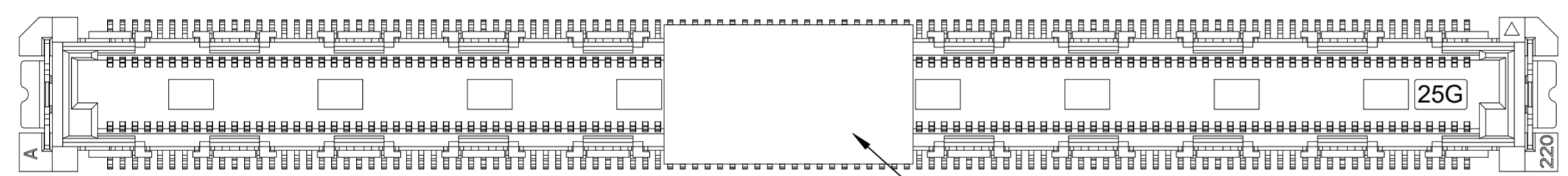

WITH CAP

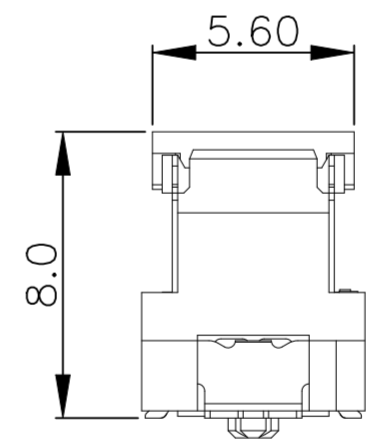

CAP	220	2499538-5
	160	2499538-4
	120	2499538-3
	80	2499538-2
	40	2499538-1
PICK MODE	PIN NO.	TE PN's

THIS DRAWING IS A CONTROLLED DOCUMENT.

DIMENSIONS: mm	TOLERANCES UNLESS OTHERWISE SPECIFIED: 0 PLC ± 0.50 1 PLC ± 0.20 2 PLC ± 0.10 3 PLC ± 0.05 4 PLC ± 0.05 ANGLES ± 3°	DWN MANOJ K 13DEC2024 CHK GOWTHAM CHITTY 13DEC2024 APVD JAGRUTI MOHANTY 13DEC2024	TE Connectivity	
MATERIAL SEE NOTE	FINISH SEE NOTE	PRODUCT SPEC 108-161908 APPLICATION SPEC 114-161404	NAME 0.5 BTB Plug H7.45	
		WEIGHT 0	SIZE A2	CAGE CODE 00779
		CUSTOMER DRAWING	DRAWING NO. G-2499538	RESTRICTED TO -
		SCALE 1:1	SHEET 2 OF 10	REV A

2499538

REVISIONS				
P	LTR	DESCRIPTION	DATE	APVD
-	-	SEE SHEET 1	-	-

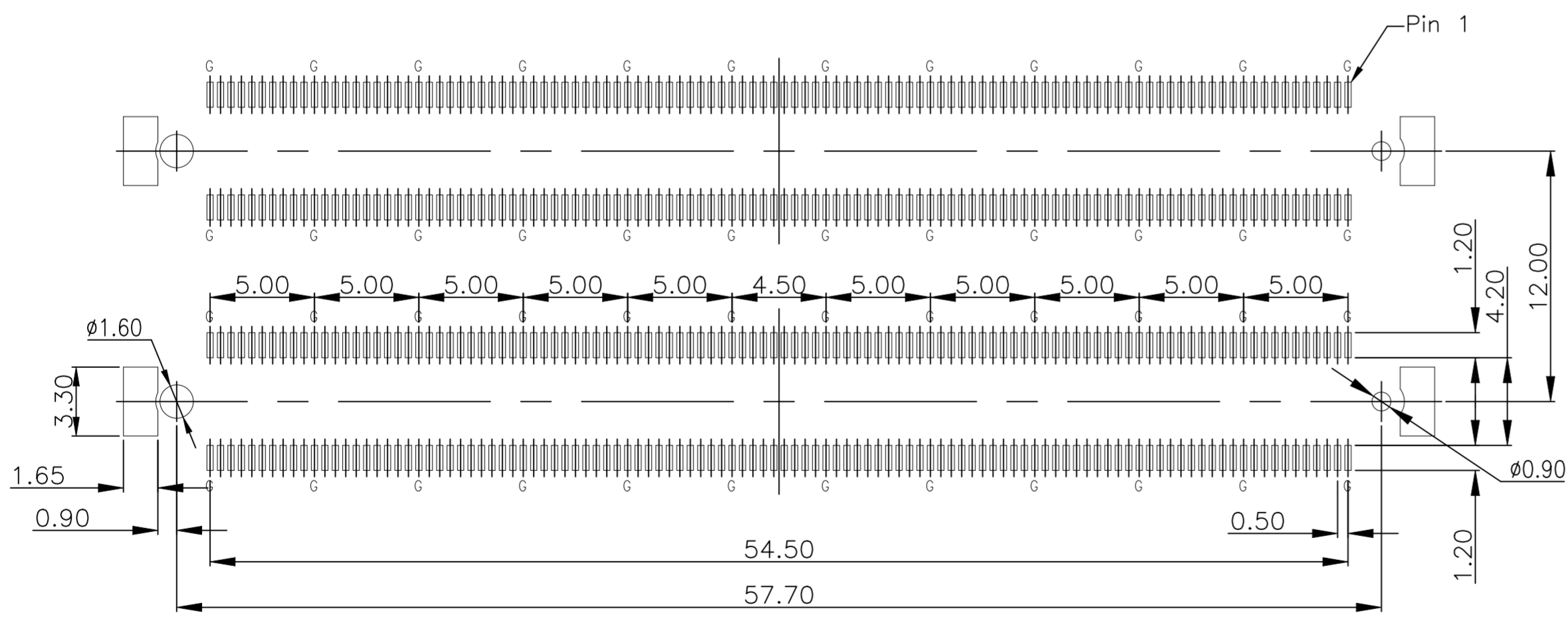
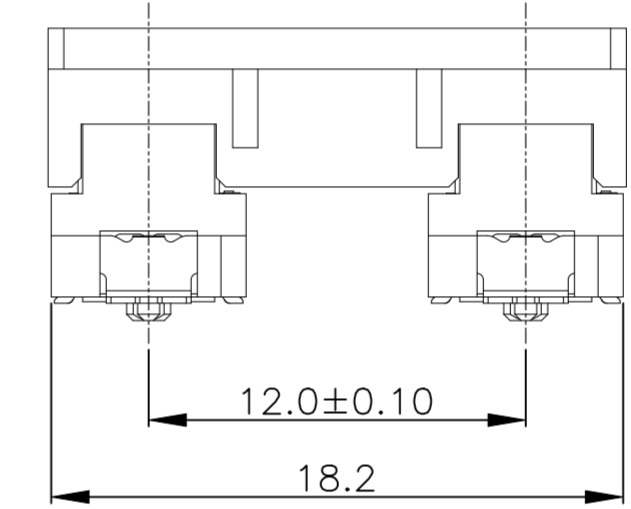
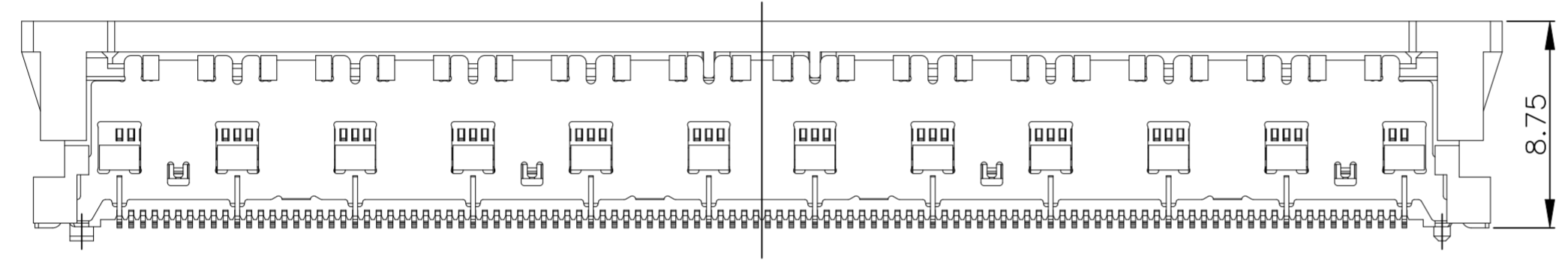
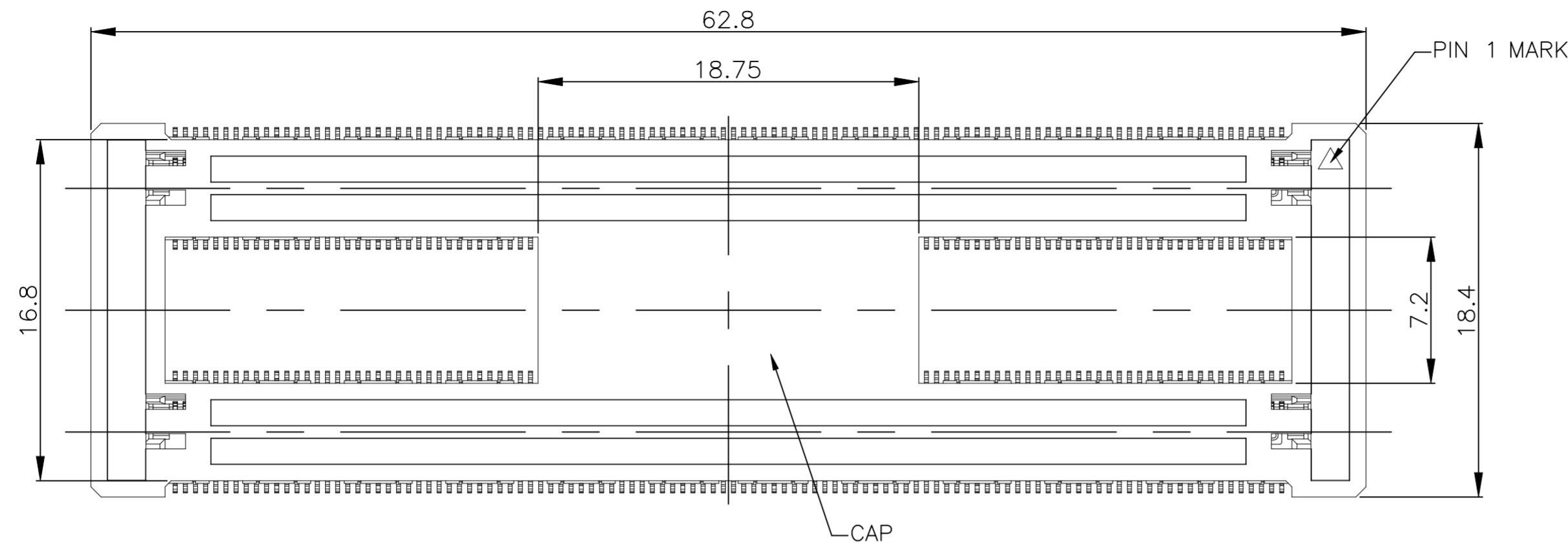

REFERENCE P.C.B LAYOUT

ABOVE SHOWN 2499538-6(440PINS)

THIS DRAWING IS A CONTROLLED DOCUMENT.		DWN MANOJ K 13DEC2024	TE Connectivity	
DIMENSIONS: mm		CHK GOWTHAM CHITTY 13DEC2024		
TOLERANCES UNLESS OTHERWISE SPECIFIED:		APVD JAGRUTI MOHANTY 13DEC2024	NAME -	
0 PLC ± 0.50 1 PLC ± 0.20 2 PLC ± 0.10 3 PLC ± 0.05 4 PLC ± 0.05 ANGLES ± 3°		PRODUCT SPEC 108-161908	0.5 BTB Plug H7.45	
MATERIAL SEE NOTE		APPLICATION SPEC 114-161404	SIZE A2	RESTRICTED TO -
FINISH SEE NOTE		WEIGHT 0	CAGE CODE 00779	DRAWING NO 2499538
		CUSTOMER DRAWING	SCALE 1:1	SHEET 3 OF 10
			REV A	

2499538

REVISIONS				
P	LTR	DESCRIPTION	DATE	APVD
-	-	SEE SHEET 1	-	-

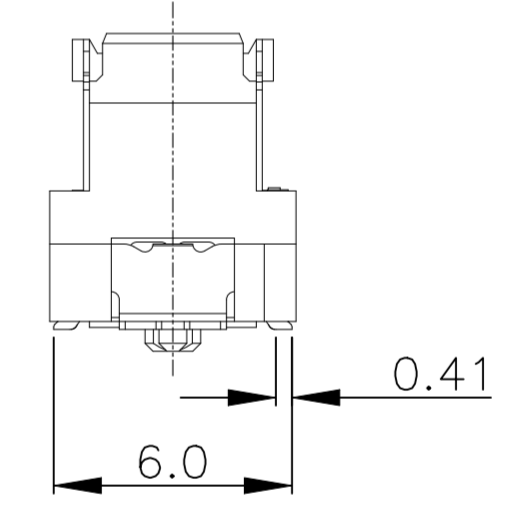
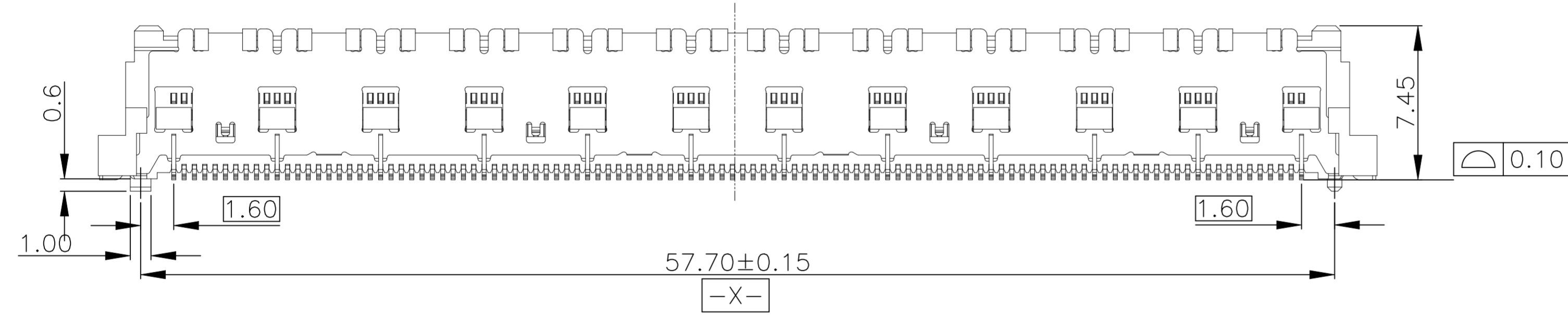
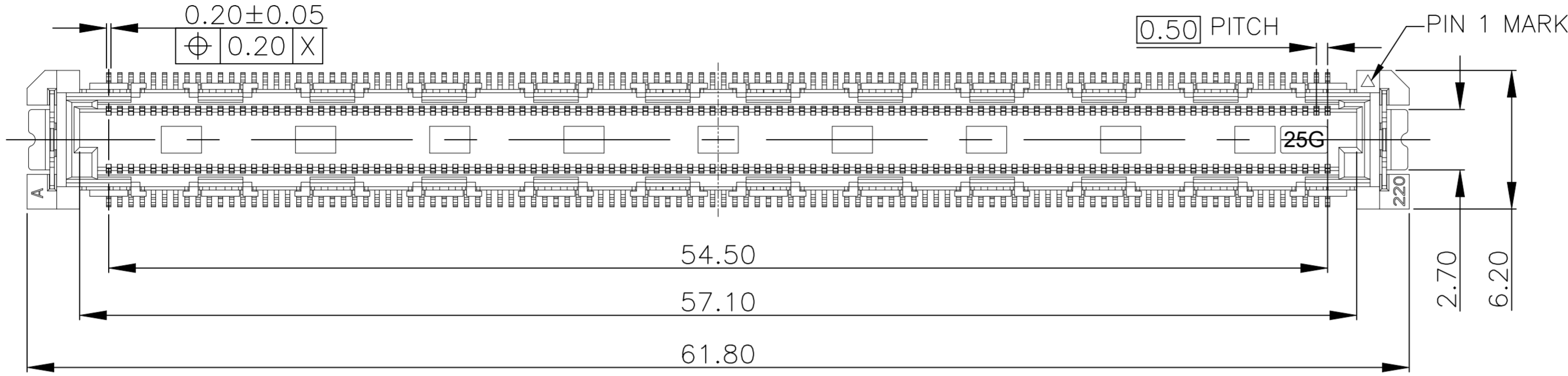

ABOVE SHOWN 2499538-6(440PINS)

THIS DRAWING IS A CONTROLLED DOCUMENT.		DWN MANOJ K 13DEC2024	TE Connectivity	
DIMENSIONS: mm		CHK GOWTHAM CHITTY 13DEC2024		
TOLERANCES UNLESS OTHERWISE SPECIFIED:		APVD JAGRUTI MOHANTY 13DEC2024	NAME -	
0 PLC ± 0.50 1 PLC ± 0.20 2 PLC ± 0.10 3 PLC ± 0.05 4 PLC ± 0.05 ANGLES ± 3°		PRODUCT SPEC 108-161908	-	
MATERIAL SEE NOTE		APPLICATION SPEC 114-161404	SIZE A2	CAGE CODE 00779
FINISH SEE NOTE		WEIGHT 0	DRAWING NO C-2499538	RESTRICTED TO -
CUSTOMER DRAWING			SCALE 1:1	SHEET 4 OF 10
			REV A	

2499538

REVISIONS					
P	LTR	DESCRIPTION	DATE	DWN	APVD
-	-	SEE SHEET 1	-	-	-

NOTES:

- CORRECTLY PLACED, THE TRIANGLE SYMBOL OF THE TRAY DISK IS PLACED IN THE UPPER LEFT CORNER; THE TRIANGLE SYMBOL ON THE PRODUCT IS PIN 1, WHICH CORRESPONDS TO THE TRIANGLE IN THE UPPER LEFT CORNER OF THE TRAY DISK IN THE SAME DIRECTION, AND THE ANTI MISOPERATION PORT IS IN THE SAME DIRECTION AS THE TRAY ANTI MISOPERATION PORT.
- THE ENTIRE TRAY IS FILLED WITH PRODUCTS, AND THE TRAY IS STACKED IN THE SAME DIRECTION. 10 TRAYS OF PRODUCTS PLUS 1 EMPTY TRAY FORM 1 BUNDLE, WITH LABELS ATTACHED TO THE EMPTY TRAYS. PE FILM IS USED TO CROSS WRAP AT LEAST 2 TURNS (WIDTH 60MM) AS SHOWN IN FIGURE 2.

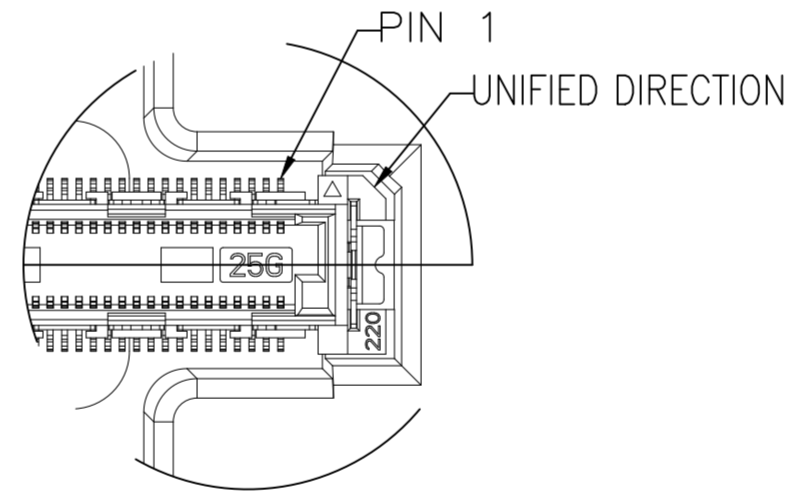
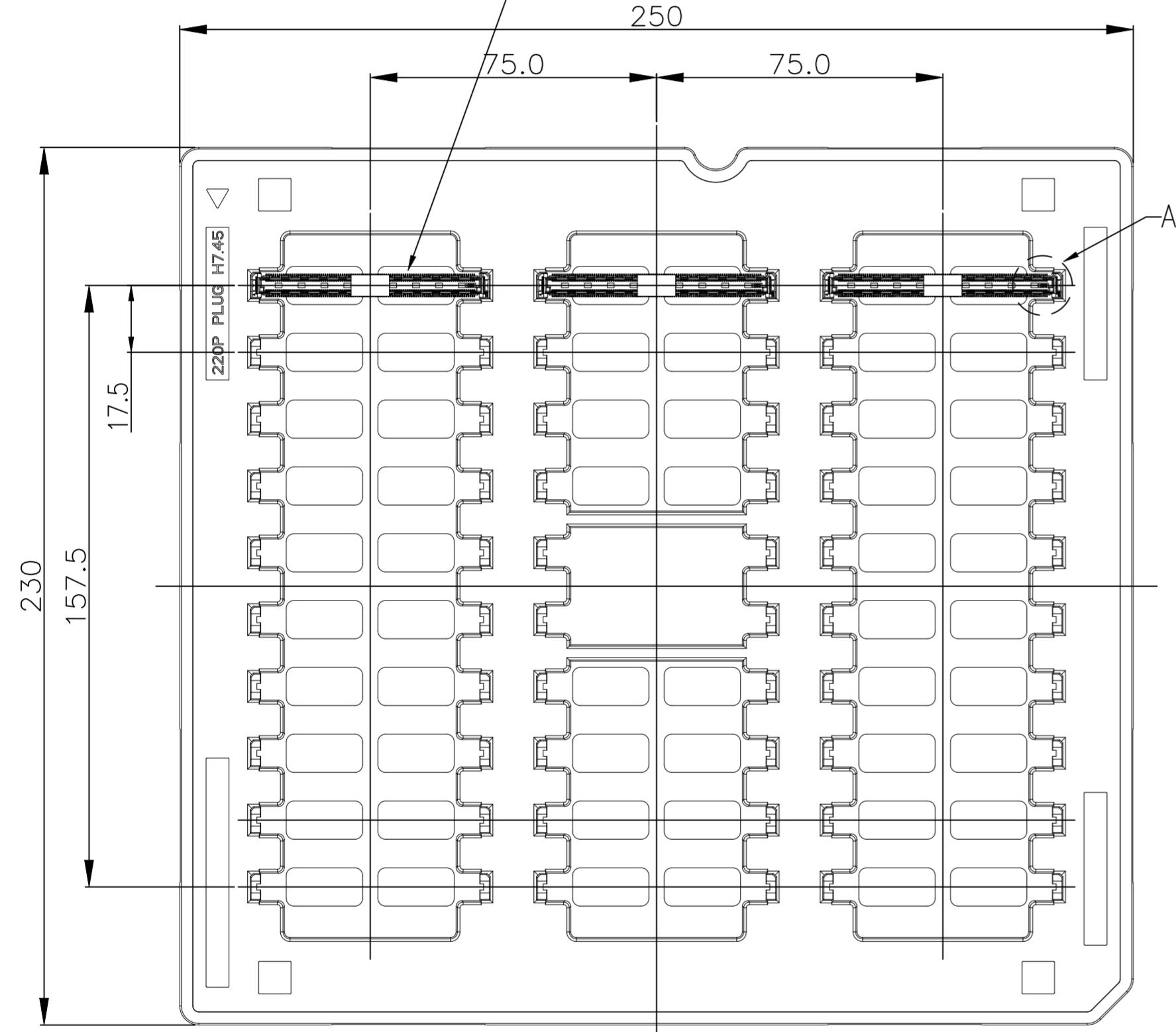
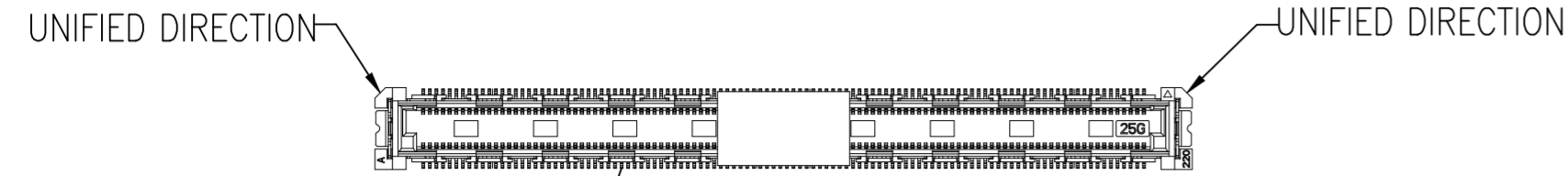

DETAIL A  
SCALE 5:1

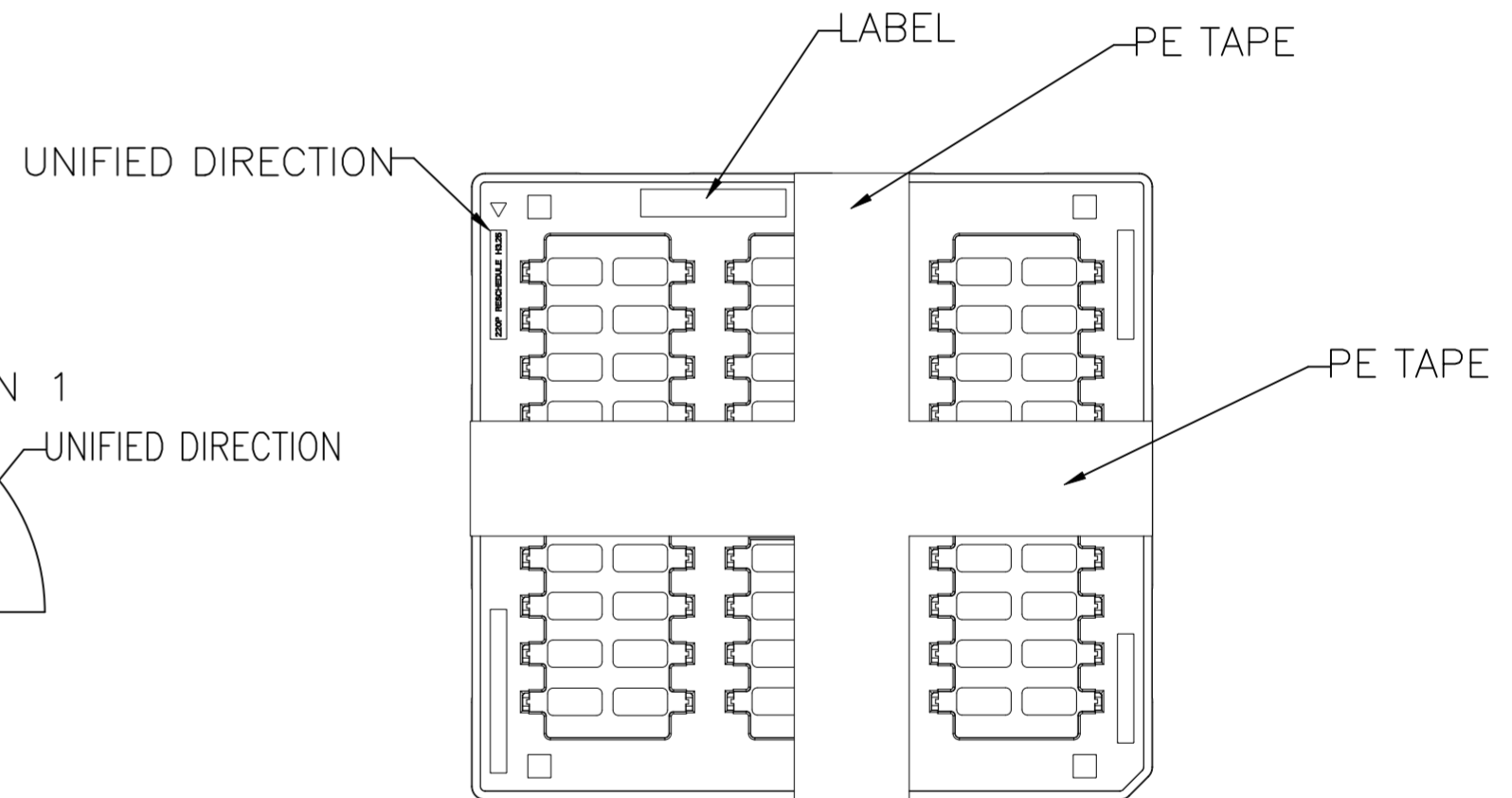

FIGURE 2

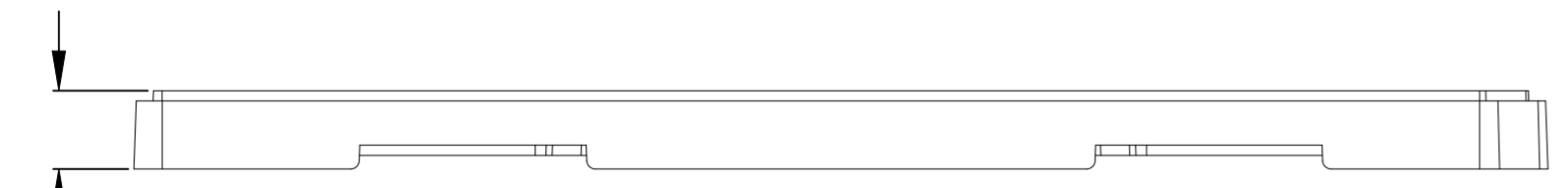
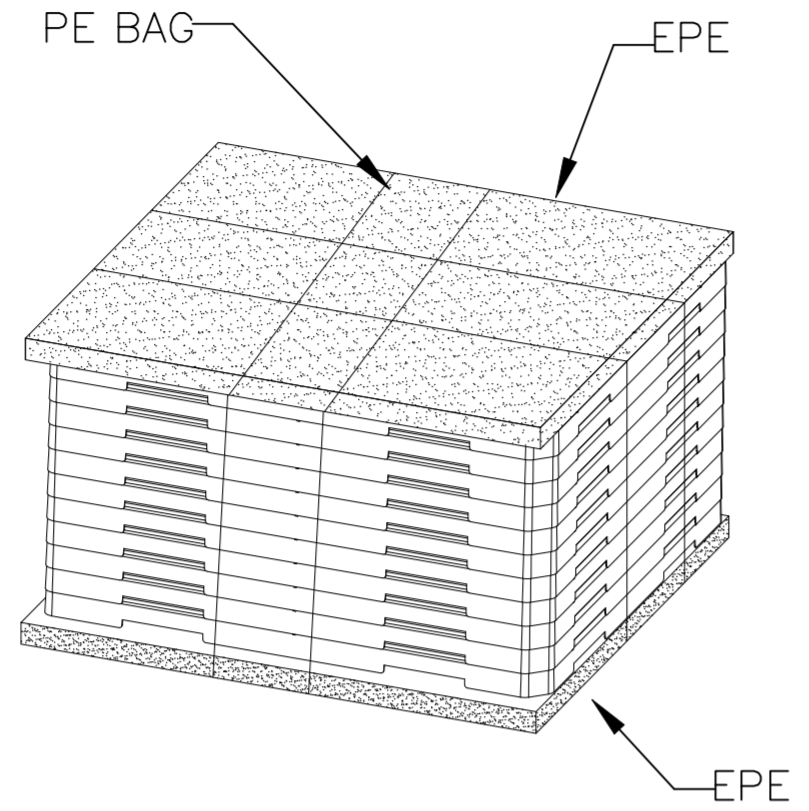

FIGURE 1

THIS DRAWING IS A CONTROLLED DOCUMENT.		DWN MANOJ K 13DEC2024	TE Connectivity	
DIMENSIONS: mm		CHK GOWTHAM CHITTY 13DEC2024		
TOLERANCES UNLESS OTHERWISE SPECIFIED:		APVD JAGRUTI MOHANTY 13DEC2024	NAME -	
0 PLC ± 0.50		PRODUCT SPEC	-	
1 PLC ± 0.20		108-161908	0.5 BTB Plug H7.45	
2 PLC ± 0.10		APPLICATION SPEC	-	
3 PLC ± 0.05		114-161404	SIZE A2	CAGE CODE 00779
4 PLC ±		0	DRAWING NO 2499538	RESTRICTED TO -
ANGLES ± 3'		MATERIAL SEE NOTE	SCALE 1:1	SHEET 5 OF 10
MATERIAL SEE NOTE		FINISH SEE NOTE	WEIGHT 0	REV A
		CUSTOMER DRAWING		

REVISIONS				
P	LTR	DESCRIPTION	DATE	APVD
-	-	SEE SHEET 1	-	-



NOTES:

1. WATERPROOF BAGS NEED TO BE TAPED TIGHTLY AND SEALED. IF THERE ARE ANY UNFILLED BOXES, THEY MUST BE FILLED WITH CUSHIONING MATERIALS
2. FILL THE OUTER BOX WITH FINISHED PRODUCTS, MAXIMUM NUMBER OF STACKED BOXES: 5 BOXES.
3. WRAP THE WHOLE BUNDLE OF PRODUCTS FIRMLY WITH PE FILM;
4. PLACE ONE PEARL AT THE BOTTOM OF THE BOX, AND ONE PEARL COTTON ON EACH SIDE OF THE INNER BOX; WRAP THE PRODUCT IN THE THIRD STEP AND PUT IT IN A PE BAG, THEN PLACE A DESICCANT INSIDE. PUT IT INTO A CARDBOARD BOX AND SEAL THE PE BAG WITH ADHESIVE TAPE (WITH THE BOTTOM OF THE TRAY FACING DOWNWARDS). PLACE A PIECE OF PEARL COTTON ON TOP OF IT; (AS SHOWN IN FIGURE 3)
5. THE CARDBOARD BOX IS SEALED WITH A "WORKER" AND A LABEL IS ATTACHED AT THE LABEL STICKING POINT; (AS SHOWN IN FIGURE 4)

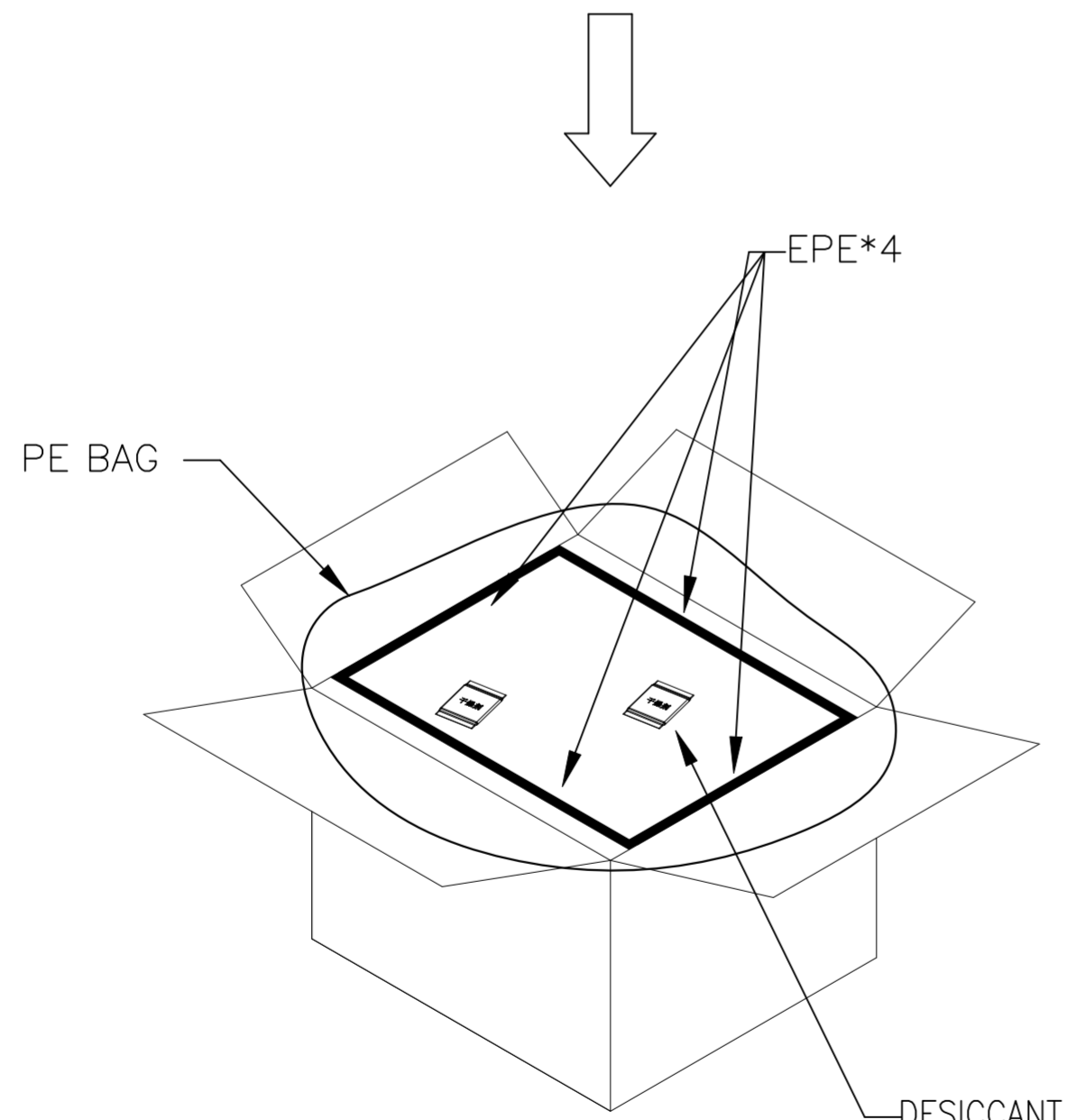

FIGURE 3

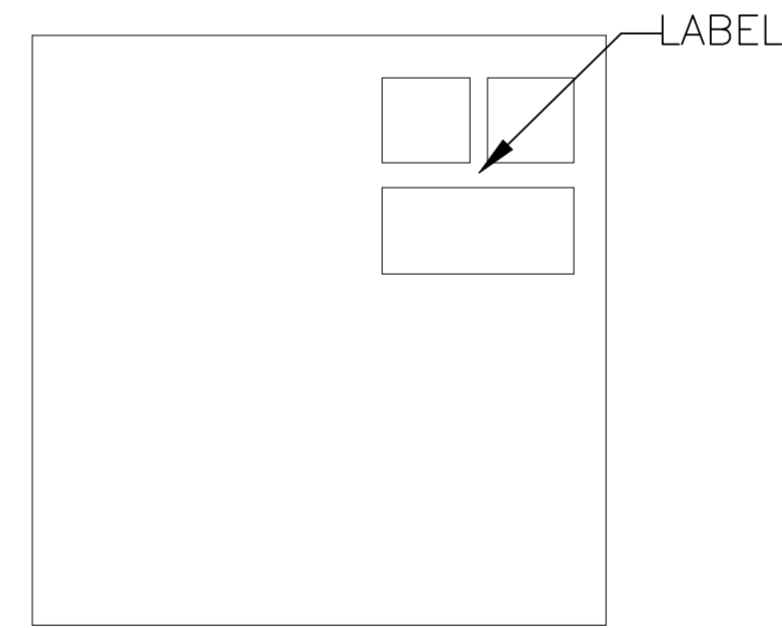

FIGURE 4

TRAY	250*230*13.8
Pcs/TRAY	30
TRAY/CARTON	10
Pcs/CARTON	300
CARTON SIZE	300*280*220

THIS DRAWING IS A CONTROLLED DOCUMENT.		DWN	13DEC2024	 TE Connectivity
		CHK	13DEC2024	
		APVD	13DEC2024	
		NAME		
DIMENSIONS:		TOLERANCES UNLESS OTHERWISE SPECIFIED:		PRODUCT SPEC
mm				108-161908
		0 PLC	± 0.50	APPLICATION SPEC
		1 PLC	± 0.20	114-161404
		2 PLC	± 0.10	WEIGHT
		3 PLC	± 0.05	0
		4 PLC	±	SIZE
		ANGLES	± 3'	A2
MATERIAL		FINISH		CAGE CODE
SEE NOTE		SEE NOTE		00779
				DRAWING NO
				2499538
				RESTRICTED TO
				-
				CUSTOMER DRAWING
				SCALE
				1:1
				SHEET
				6 OF 10
				REV
				A

REVISIONS					
P	LTR	DESCRIPTION	DATE	DWN	APVD
-	-	SEE SHEET 1	-	-	-

1. 22 SPACES ARE RESERVED AT THE BEGINNING OF THE PACKAGING, AND THE CARRIER TAPE AND SELF-ADHESIVE FILM ARE CUT FLAT WITH THE CARRIER TAPE AND TAPED TOGETHER ADHERE TIGHTLY TO THE AXIS OF THE REEL, ALIGN THE PRODUCT DIRECTION, AND PLACE THEM IN SEQUENCE, AS SHOWN IN FIGURE 1.

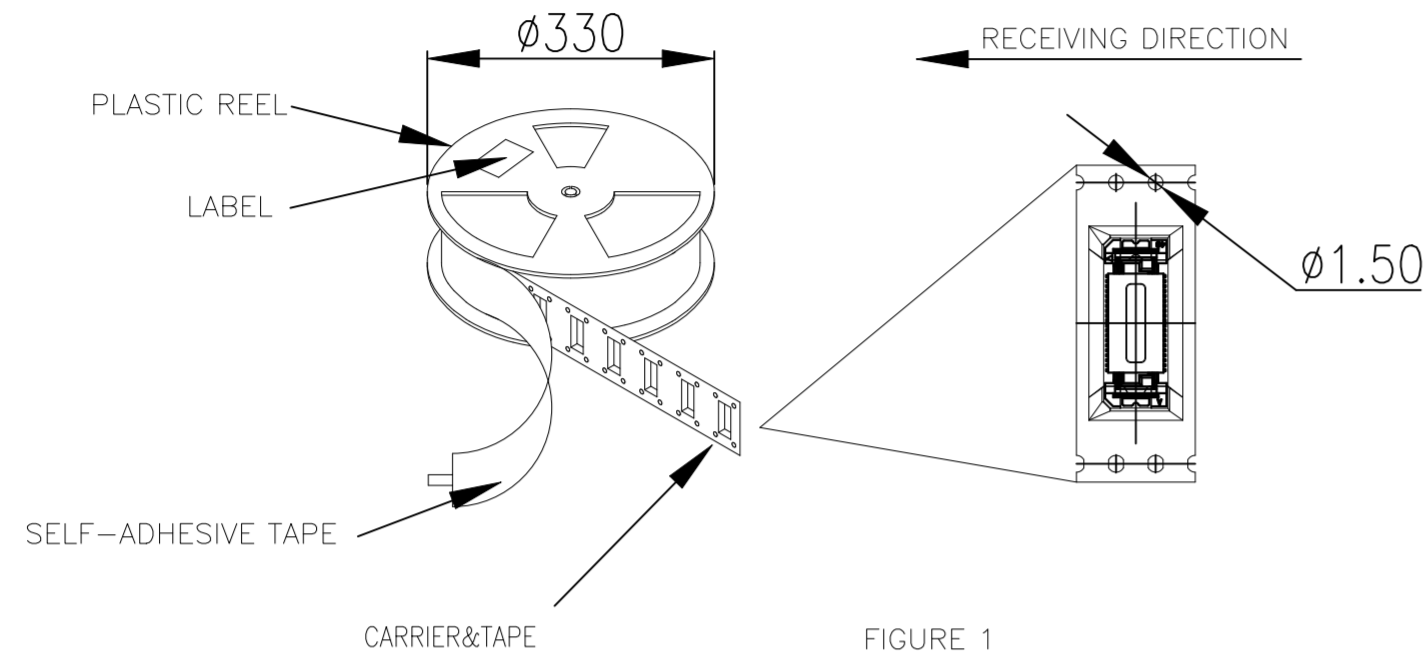

FIGURE 1

2. 22 SPACES SHOULD BE RESERVED FOR THE FINAL CARRIER TAPE OF THE PACKAGING, AND THE LAST END SHOULD BE SELF-ADHESIVE FILM AND CARRIER TAPE CUT IT FLAT AND FIX IT WITH ADHESIVE TAPE. THE EDGE OF THE REEL ALSO NEEDS TO BE FIXED WITH ADHESIVE TAPE. STICK IT ON THE REEL PRODUCT PACKAGING LABEL (ATTACHED TO ONE SIDE OF THE SMALL HOLE ON THE REEL), INDICATING THE PART NUMBER, QUANTITY, AND MANUFACTURING DATE, AS SHOWN IN FIGURE 2 (IF THE CUSTOMER HAS SPECIAL REQUIREMENTS, FOLLOW THE CUSTOMER'S REQUIREMENTS).

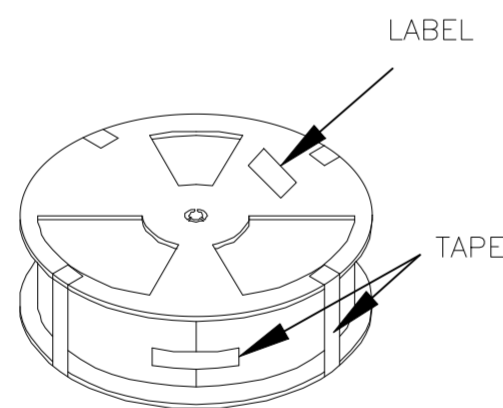

FIGURE 2

3. a). PACKAGING AS SHOWN IN THE DIAGRAM: THE REEL IS PACKED IN A WATERPROOF BAG, WITH 2PCS DESICCANT PLACED ON TOP AND BOTTOM, AND PADDING PLACED ON TOP AND BOTTOM 1PCS PEARL COTTON. THE TAPE SHALL NOT BE BROKEN, AND THE REEL THAT IS NOT FULLY ROLLED SHALL BE PACKED INTO ZERO BOXES AND SEALED WITH TAPE.  
 b). PLEASE REFER TO THE NEXT PAGE FOR THE QUANTITY OF PACKAGING IN ONE ROLL.  
 c). PLEASE REFER TO THE NEXT PAGE FOR THE QUANTITY OF PACKAGING IN ONE CARDBOARD BOX.

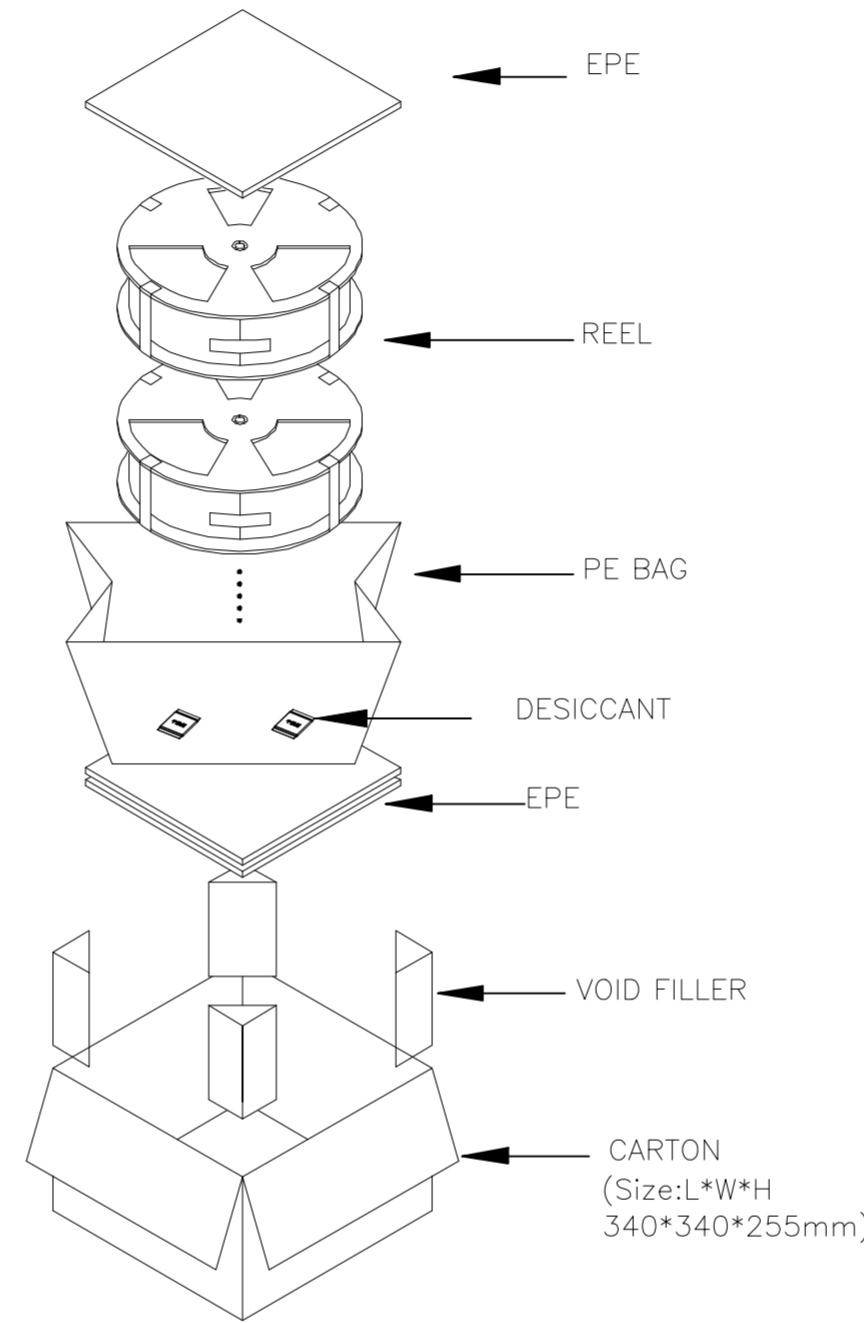

FIGURE 3

4. STICK THE LABEL ON THE TOP SIDE OF THE CARDBOARD BOX. IF THE CUSTOMER HAS SPECIAL REQUIREMENTS, FOLLOW THEM.

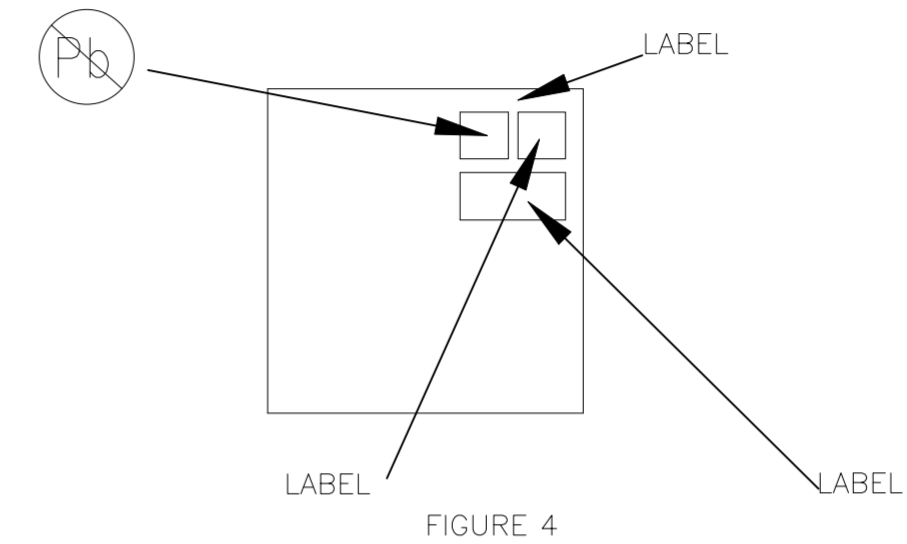
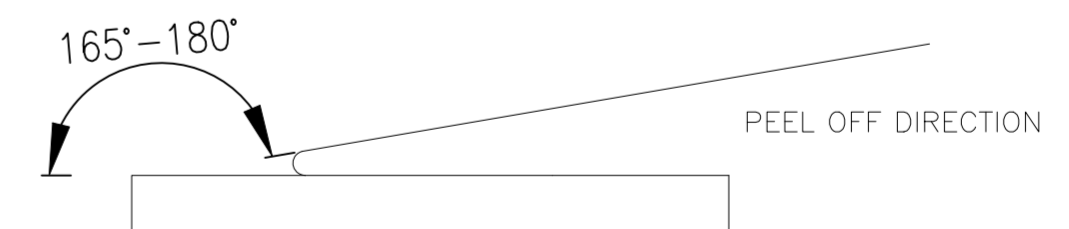

FIGURE 4

5. THE REQUIREMENT FOR UPPER TAPE PEELING FORCE IS:  
 CARRIER TAPE WIDTH ≤56MM:10-130GF  
 CARRIER TAPE WIDTH ≥72MM:10-150GF



THIS DRAWING IS A CONTROLLED DOCUMENT.		DWN MANOJ K 13DEC2024	TE Connectivity	
DIMENSIONS: mm		CHK GOWTHAM CHITTY 13DEC2024		
TOLERANCES UNLESS OTHERWISE SPECIFIED:		APVD JAGRUTI MOHANTY 13DEC2024	NAME -	
0 PLC ± 0.50		PRODUCT SPEC -		
1 PLC ± 0.20		108-161908		
2 PLC ± 0.10		APPLICATION SPEC -		
3 PLC ± 0.05		114-161404		
4 PLC ± 0.05		SIZE A2		
ANGLES ± 3'		CAGE CODE 00779		
MATERIAL SEE NOTE		DRAWING NO G-2499538		
FINISH SEE NOTE		WEIGHT 0		
		CUSTOMER DRAWING		
		SCALE 1:1		SHEET 7 OF 10
				REV A

REVISIONS					
P	LTR	DESCRIPTION	DATE	DWN	APVD
-	-	SEE SHEET 1	-	-	-

- NOTES:
1. THERE ARE EMPTY BOXES THAT MUST BE FILLED WITH CUSHIONING MATERIALS
  2. PACKAGING MATERIALS CAN BE FOUND ON THIS PAGE
  3. WATERPROOF BAGS NEED TO BE TAPED TIGHTLY AND SEALED
  4. FILL THE OUTER BOX WITH FINISHED PRODUCTS, MAXIMUM NUMBER OF STACKED BOXES: 5 BOXES

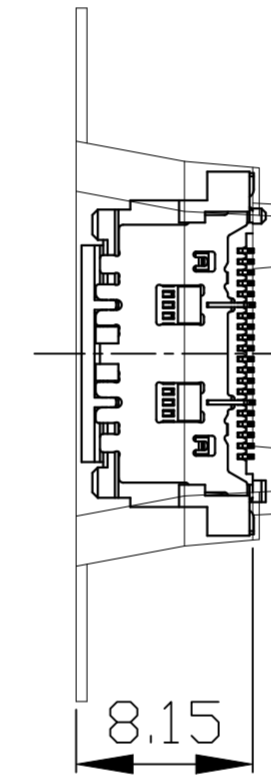
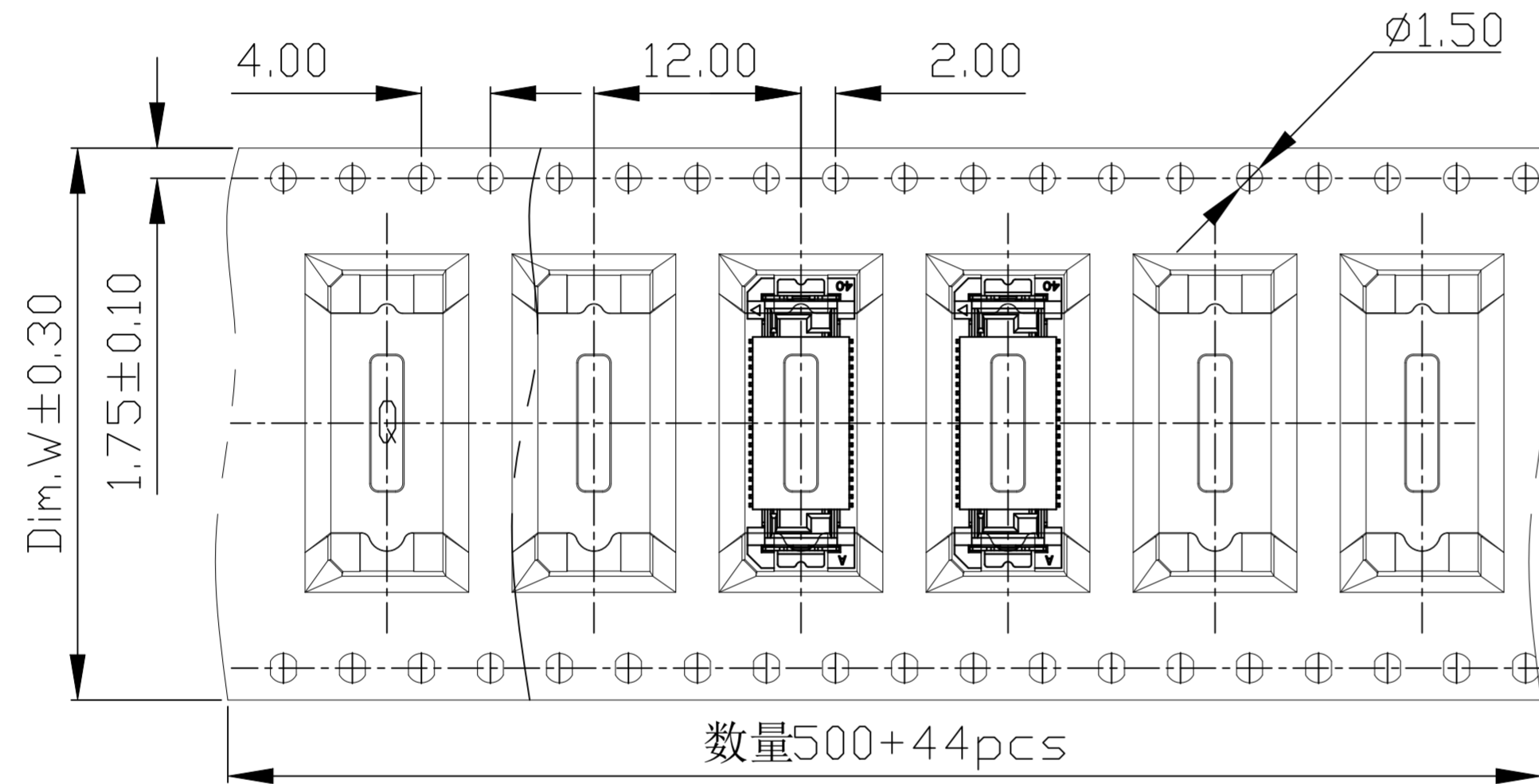

ITEM	QTY
CARTON	1 Pcs
PE BAG	1 Pcs
EPE	2 Pcs
DESICCANT	2 Pcs
CARRIER&TAPE	X/R(See table)
PLASTIC REEL	X/R(See table)
SELF-ADHESIVE TAPE	A/R
VOID FILLER	4 Pcs

Pin No.	PRODUCT NO.	PACKING CAPACITY			
		DIM.W	pcs/REEL	REELS/CARTON	Pcs/CARTON
160	2499538-4	72mm	500	3R	1500
120	2499538-3	56mm	500	4R	2000
80	2499538-2	44mm	500	5R	2500
40	2499538-1	32mm	500	6R	3000

THIS DRAWING IS A CONTROLLED DOCUMENT.		DWN MANOJ K 13DEC2024	TE Connectivity	
DIMENSIONS: mm		CHK GOWTHAM CHITTY 13DEC2024		
TOLERANCES UNLESS OTHERWISE SPECIFIED:		APVD JAGRUTI MOHANTY 13DEC2024	NAME -	
0 PLC ± 0.50		PRODUCT SPEC	-	
1 PLC ± 0.20		108-161908	0.5 BTB Plug H7.45	
2 PLC ± 0.10		APPLICATION SPEC	-	
3 PLC ± 0.05		114-161404	SIZE	CAGE CODE
4 PLC ± 0.05		0	A2	00779
ANGLES ± 3'		WEIGHT	DRAWING NO	RESTRICTED TO
MATERIAL SEE NOTE		CUSTOMER DRAWING	G-2499538	-
		SCALE	SHEET	REV
		1:1	8 of 10	A

REVISIONS				
P	LTR	DESCRIPTION	DATE	APVD
-	-	SEE SHEET 1	-	-

NOTES:

- CORRECTLY PLACED, THE TRIANGLE SYMBOL OF THE TRAY DISK IS PLACED IN THE UPPER LEFT CORNER; THE TRIANGLE SYMBOL ON THE PRODUCT IS PIN 1, WHICH CORRESPONDS TO THE TRIANGLE IN THE UPPER LEFT CORNER OF THE TRAY DISK IN THE SAME DIRECTION, AND THE ANTI MISOPERATION PORT IS IN THE SAME DIRECTION AS THE TRAY ANTI MISOPERATION PORT.
- THE ENTIRE TRAY IS FILLED WITH PRODUCTS, AND THE TRAY IS STACKED IN THE SAME DIRECTION. 10 TRAYS OF PRODUCTS PLUS 1 EMPTY TRAY FORM 1 BUNDLE, WITH LABELS ATTACHED TO THE EMPTY TRAYS. PE TAPE IS USED TO CROSS WRAP AT LEAST 2 TURNS (WIDTH 60MM) AS SHOWN IN FIGURE 2

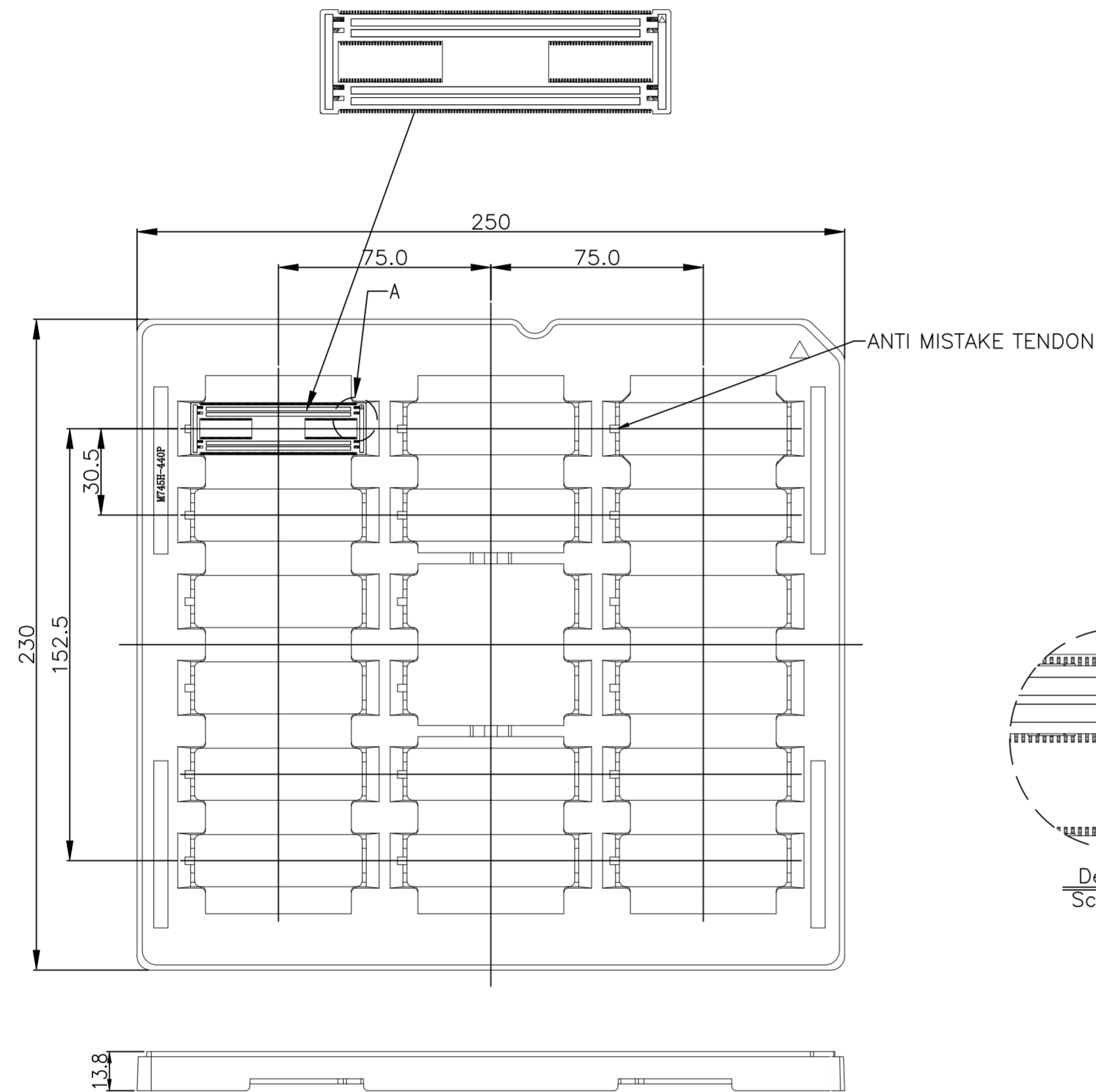
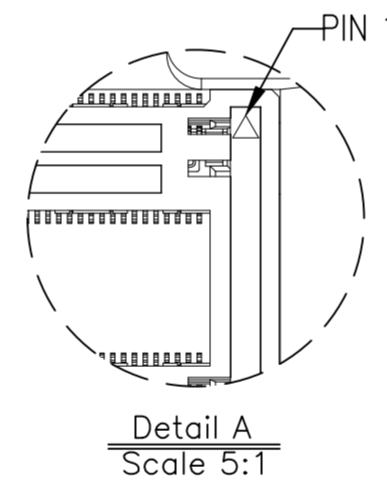

FIGURE 1



Detail A  
Scale 5:1

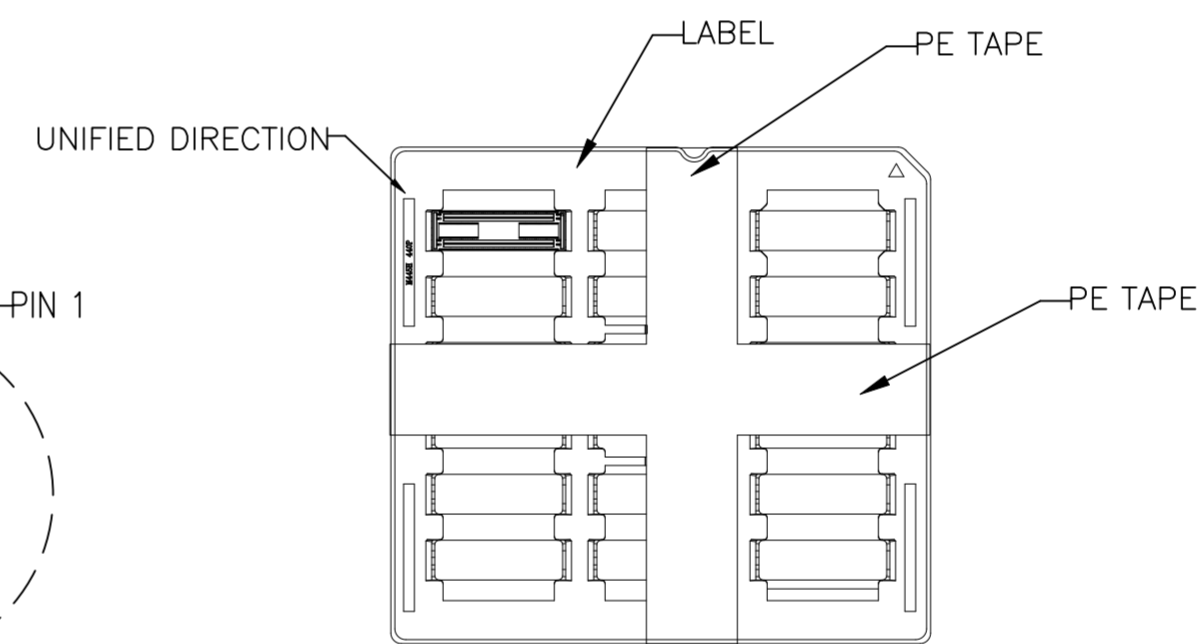
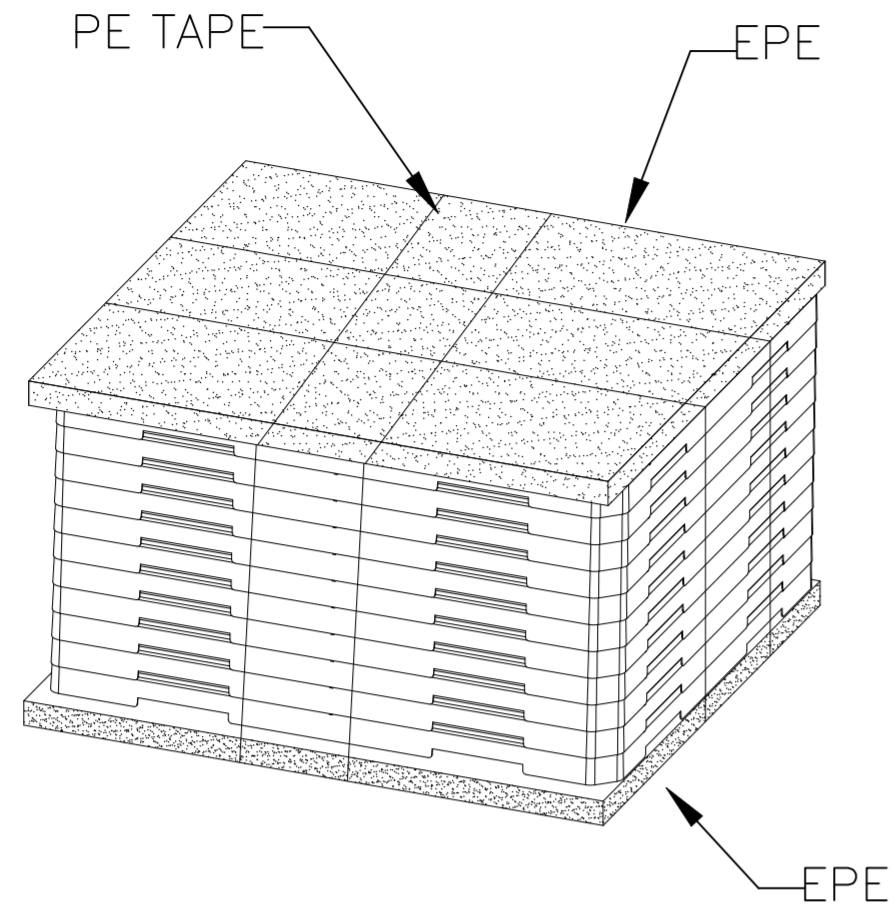

FIGURE 2

FOR PN: 2499538-6

THIS DRAWING IS A CONTROLLED DOCUMENT.		DWN MANOJ K 13DEC2024	TE Connectivity	
DIMENSIONS: mm		CHK GOWTHAM CHITTY 13DEC2024		
TOLERANCES UNLESS OTHERWISE SPECIFIED:		APVD JAGRUTI MOHANTY 13DEC2024	NAME -	
0 PLC ± 0.50		PRODUCT SPEC	-	
1 PLC ± 0.20		108-161908	0.5 BTB Plug H7.45	
2 PLC ± 0.10		APPLICATION SPEC	-	
3 PLC ± 0.05		114-161404	SIZE A2	CAGE CODE 00779
4 PLC ± ± 3'		WEIGHT 0	DRAWING NO G-2499538	RESTRICTED TO -
MATERIAL SEE NOTE	FINISH SEE NOTE	CUSTOMER DRAWING	SCALE 1:1	SHEET 9 of 10
			REV A	

REVISIONS					
P	LTR	DESCRIPTION	DATE	DWN	APVD
-	-	SEE SHEET 1	-	-	-



- NOTES:
1. WATERPROOF BAGS NEED TO BE TAPED TIGHTLY AND SEALED. IF THERE ARE ANY UNFILLED BOXES, THEY MUST BE FILLED WITH CUSHIONING MATERIALS
  2. FILL THE OUTER BOX WITH FINISHED PRODUCTS, MAXIMUM NUMBER OF STACKED BOXES: 5 BOXES.
  3. WRAP THE WHOLE BUNDLE OF PRODUCTS FIRMLY WITH PE FILM;
  4. PLACE ONE PEARL AT THE BOTTOM OF THE BOX, AND ONE PEARL COTTON ON EACH SIDE OF THE INNER BOX; WRAP THE PRODUCT IN THE THIRD STEP AND PUT IT IN A PE BAG, THEN PLACE A DESICCANT INSIDE. PUT IT INTO A CARDBOARD BOX AND SEAL THE PE BAG WITH ADHESIVE TAPE (WITH THE BOTTOM OF THE TRAY FACING DOWNWARDS). PLACE A PIECE OF PEARL COTTON ON TOP OF IT; (AS SHOWN IN FIGURE 3)
  5. THE CARDBOARD BOX IS SEALED WITH A "WORKER" AND A LABEL IS ATTACHED AT THE LABEL STICKING POINT; (AS SHOWN IN FIGURE 4)

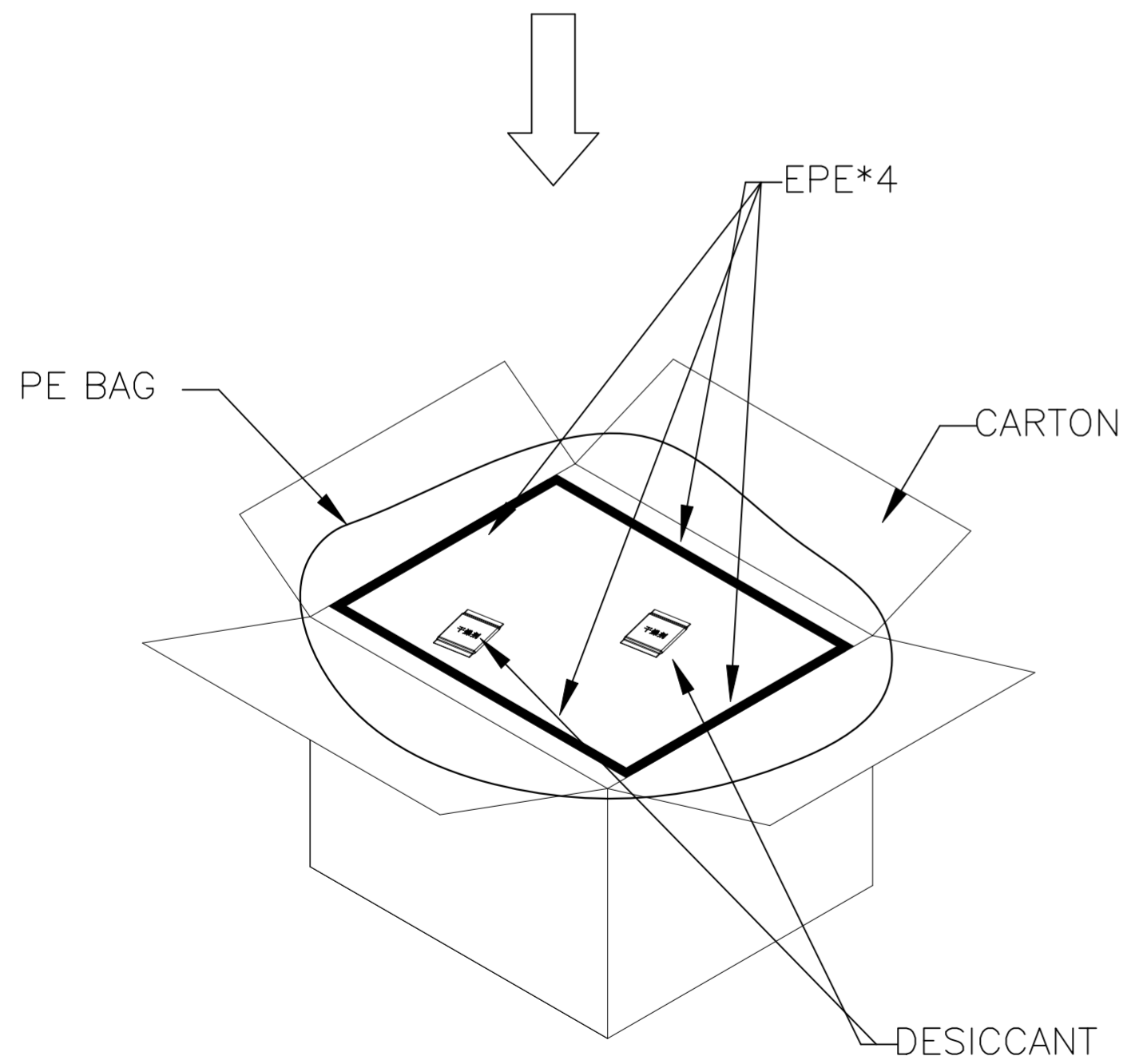

FIGURE 3

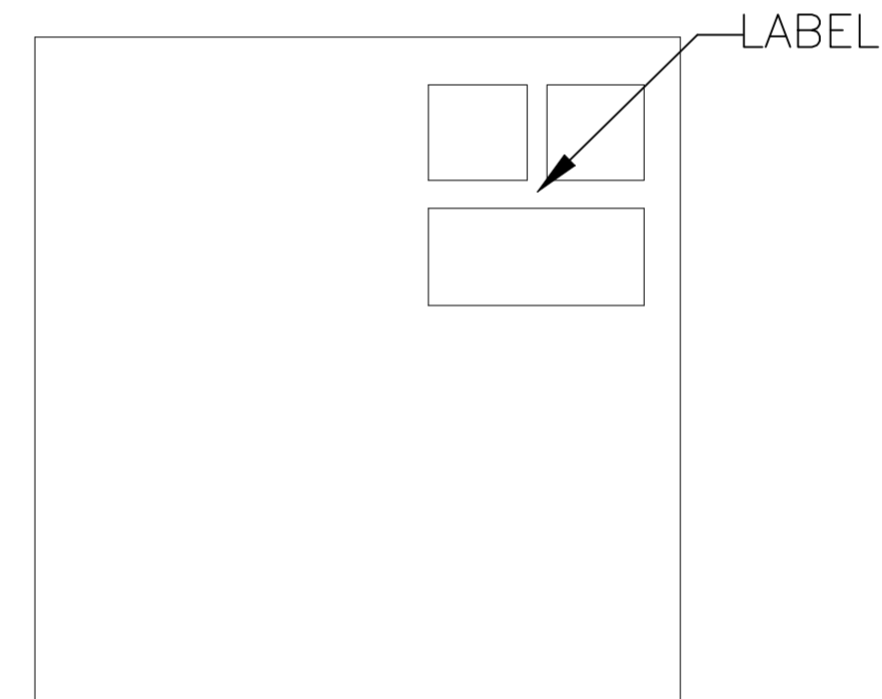

FIGURE 4

TRAY	250*230*13.8
Pcs/TRAY	18
TRAY/CARTON	10
Pcs/CARTON	180
CARTON SIZE	300*280*220

THIS DRAWING IS A CONTROLLED DOCUMENT.		DWN MANOJ K 13DEC2024	TE Connectivity	
DIMENSIONS: mm		CHK GOWTHAM CHITTY 13DEC2024	NAME -	
TOLERANCES UNLESS OTHERWISE SPECIFIED:		APVD JAGRUTI MOHANTY 13DEC2024	PRODUCT SPEC 0.5 BTB Plug H7.45	
0 PLC ± 0.50		APPLICATION SPEC 108-161908	SIZE A2	CAGE CODE 00779
1 PLC ± 0.20		114-161404	DRAWING NO C-2499538	RESTRICTED TO -
2 PLC ± 0.10		WEIGHT 0	SCALE 1:1	SHEET 10 of 10
3 PLC ± 0.05		MATERIAL SEE NOTE	REV A	
4 PLC ± 0.05				
ANGLES ± 3'		CUSTOMER DRAWING		