

UNIT DIMENSIONS

Silver-Lube mounting details are interchangeable with the traditional RHP Self-Lube range. Some non-critical dimensions do, however differ, see tables below.

For bearing permissible speed details please see page 10.

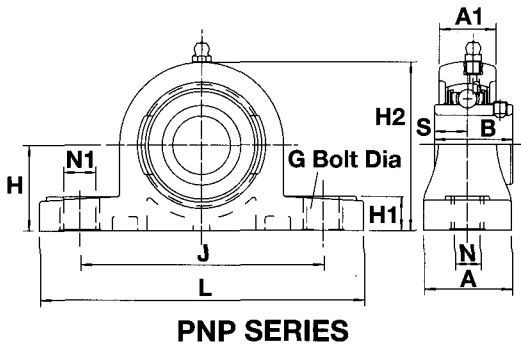

PNP SERIES

Table 1

RHP DESIGNATION	SHAFT DIA.	BASIC INSERT	HOUSING GROUP	L	H	H1	H2	J	N	N1	G	A	A1	B	S	WEIGHT (kg)
PNP20CR	20	J1020	2	127.2	33.3	14.2	65.9	94.9	11.0	14.2	M10	37.8	22.5	31.0	12.7	0.27
PNP3/4CR	3/4"	J1020	2	127.2	33.3	14.2	65.9	94.9	11.0	14.2	M10	37.8	22.5	31.0	12.7	0.27
PNP25CR	25	J1025	3	140.2	36.5	14.5	71.9	104.9	11.0	14.2	M10	37.8	24.5	34.0	14.3	0.39
PNP1CR	1"	J1025	3	140.2	36.5	14.5	71.9	104.9	11.0	14.2	M10	37.8	24.5	34.0	14.3	0.39
PNP30CR	30	J1030	4	162.2	42.9	17.8	83.9	118.9	14.0	18.2	M12	45.8	27.0	38.1	15.9	0.52
PNP1.3/16CR	1.3/16"	J1030	4	162.2	42.9	17.8	83.9	118.9	14.0	18.2	M12	45.8	27.0	38.1	15.9	0.52
PNP1.1/4RCR	1.1/4"	J1030	4	162.2	42.9	17.8	83.9	118.9	14.0	18.2	M12	45.8	27.0	38.1	15.9	0.52
PNP35CR	35	J1035	5	167.2	47.6	18.0	94.9	126.9	14.0	18.2	M12	47.8	32.5	42.9	17.5	0.72
PNP1.1/4CR	1.1/4"	J1035	5	167.2	47.6	18.0	94.9	126.9	14.0	18.2	M12	47.8	32.5	42.9	17.5	0.72
PNP1.7/16CR	1.7/16"	J1035	5	167.2	47.6	18.0	94.9	126.9	14.0	18.2	M12	47.8	32.5	42.9	17.5	0.72

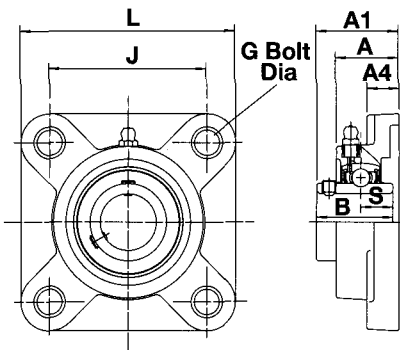

PSF SERIES

Table 2

RHP DESIGNATION	SHAFT DIA.	BASIC INSERT	HOUSING GROUP	L	J	G	A	A1	A4	B	S	WEIGHT (kg)
PSF20CR	20	J1020	2	86.5	63.5	M10	27.8	36.3	13.4	31.0	12.7	0.28
PSF3/4CR	3/4"	J1020	2	86.5	63.5	M10	27.8	36.3	13.4	31.0	12.7	0.28
PSF25CR	25	J1025	3	95.0	70.0	M10	27.9	36.7	14.3	34.0	14.3	0.34
PSF1CR	1"	J1025	3	95.0	70.0	M10	27.9	36.7	14.3	34.0	14.3	0.34
PSF30CR	30	J1030	4	107.5	83.0	M10	31.5	41.4	14.3	38.1	15.9	0.50
PSF1.3/16CR	1.3/16"	J1030	4	107.5	83.0	M10	31.5	41.4	14.3	38.1	15.9	0.50
PSF1.1/4RCR	1.1/4"	J1030	4	107.5	83.0	M10	31.5	41.4	14.3	38.1	15.9	0.50
PSF35CR	35	J1035	5	117.5	92.0	M12	34.8	46.9	15.5	42.9	17.5	0.74
PSF1.1/4CR	1.1/4"	J1035	5	117.5	92.0	M12	34.8	46.9	15.5	42.9	17.5	0.74
PSF1.7/16CR	1.7/16"	J1035	5	117.5	92.0	M12	34.8	46.9	15.5	42.9	17.5	0.74

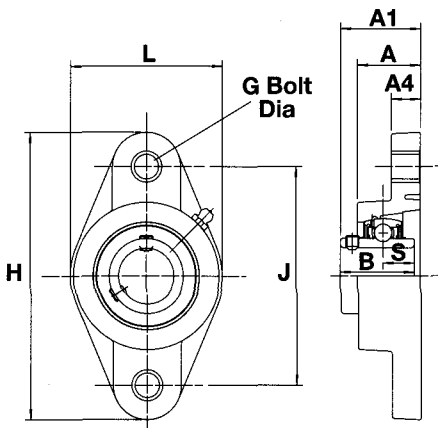

PSFT SERIES

Table 3

RHP DESIGNATION	SHAFT DIA.	BASIC INSERT	HOUSING GROUP	L	H	J	G	A	A1	A4	B	S	WEIGHT (kg)
PSFT20CR	20	J1020	2	64.1	113.3	90.0	M10	26.5	33.7	11.4	31.0	12.7	0.24
PSFT3/4CR	3/4"	J1020	2	64.1	113.3	90.0	M10	26.5	33.7	11.4	31.0	12.7	0.24
PSFT25CR	25	J1025	3	68.4	130.3	99.0	M10	29.1	36.7	13.4	34.0	14.3	0.30
PSFT1CR	1"	J1025	3	68.4	130.3	99.0	M10	29.1	36.7	13.4	34.0	14.3	0.30
PSFT30CR	30	J1030	4	80.1	148.3	117.0	M10	30.5	41.2	13.4	38.1	15.9	0.44
PSFT1.3/16CR	1.3/16"	J1030	4	80.1	148.3	117.0	M10	30.5	41.2	13.4	38.1	15.9	0.44
PSFT1.1/4RCR	1.1/4"	J1030	4	80.1	148.3	117.0	M10	30.5	41.2	13.4	38.1	15.9	0.44
PSFT35CR	35	J1035	5	90.1	163.3	130.0	M12	32.8	43.4	16.1	42.9	17.5	0.64
PSFT1.1/4CR	1.1/4"	J1035	5	90.1	163.3	130.0	M12	32.8	43.4	16.1	42.9	17.5	0.64
PSFT1.7/16CR	1.7/16"	J1035	5	90.1	163.3	130.0	M12	32.8	43.4	16.1	42.9	17.5	0.64

All dimensions in mm except inch shaft sizes.

HOUSING STRENGTH

Housing load carrying capacity varies depending on the application loading regime, which may be intermittent, continuous or cyclic. Maximum housing loads are given in tables 8, 9 and 10. These loads must not be exceeded without prior consultation with NSK-RHP.

Published housing maximum load capacities do not allow for any reduction in housing strength caused by exposure of the housing to chemicals, water, steam, heat, ultraviolet light or any combination of these factors. If any of these factors are present in the application the designer or end user must establish the effect of these exposures and reduce the published maximum housing load accordingly.

To maximise load carrying capacity it is recommended that washers are used with the fixing bolts. Tables 8, 9 and 10 also detail maximum fixing bolt tightening torques.

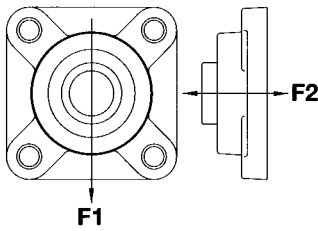

PSF SERIES

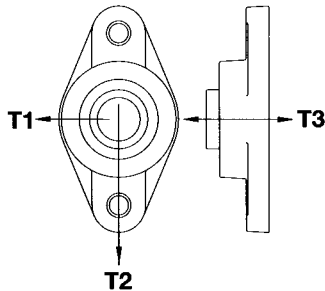

PSFT SERIES

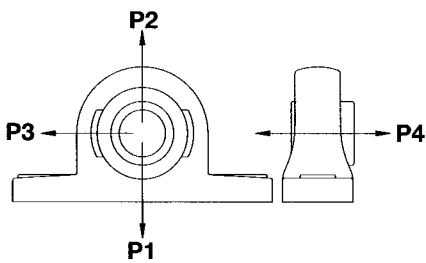

PNP SERIES

Table 8

RHP DESIGNATION	MAXIMUM HOUSING LOAD (N) AT 20°C						MAXIMUM FIXING BOLT TORQUE (Nm)
	F1			F2			
	INTERMITTENT LOADING	CONTINUOUS LOADING	CYCLIC LOADING	INTERMITTENT LOADING	CONTINUOUS LOADING	CYCLIC LOADING	
PSF20CR	3100	1600	900	1300	700	400	18
PSF3/4CR	3100	1600	900	1300	700	400	18
PSF25CR	3500	1700	1000	1300	700	400	25
PSF1CR	3500	1700	1000	1300	700	400	25
PSF30CR	4600	2300	1300	2200	1100	600	30
PSF1.3/16CR	4600	2300	1300	2200	1100	600	30
PSF1.1/4RCR	4600	2300	1300	2200	1100	600	30
PSF35CR	6200	3100	1700	2600	1300	700	35
PSF1.1/4CR	6200	3100	1700	2600	1300	700	35
PSF1.7/16CR	6200	3100	1700	2600	1300	700	35

Table 9

RHP DESIGNATION	MAXIMUM HOUSING LOAD (N) AT 20°C									MAXIMUM FIXING BOLT TORQUE (Nm)
	T1			T2			T3			
	INTERMITTENT LOADING	CONTINUOUS LOADING	CYCLIC LOADING	INTERMITTENT LOADING	CONTINUOUS LOADING	CYCLIC LOADING	INTERMITTENT LOADING	CONTINUOUS LOADING	CYCLIC LOADING	
PSFT20CR	4400	2200	1200	1900	900	500	1300	700	400	18
PSFT3/4CR	4400	2200	1200	1900	900	500	1300	700	400	18
PSFT25CR	4400	2200	1200	3000	1500	800	1400	700	400	25
PSFT1CR	4400	2200	1200	3000	1500	800	1400	700	400	25
PSFT30CR	5900	2900	1600	3300	1600	900	2000	1000	500	30
PSFT1.3/16CR	5900	2900	1600	3300	1600	900	2000	1000	500	30
PSFT1.1/4RCR	5900	2900	1600	3300	1600	900	2000	1000	500	30
PSFT35CR	6400	3200	1700	3900	2000	1100	2800	1400	800	35
PSFT1.1/4CR	6400	3200	1700	3900	2000	1100	2800	1400	800	35
PSFT1.7/16CR	6400	3200	1700	3900	2000	1100	2800	1400	800	35

Table 10

RHP DESIGNATION	MAXIMUM HOUSING LOAD (N) AT 20°C												MAXIMUM FIXING BOLT TORQUE (Nm)
	P1			P2			P3			P4			
	INTERMITTENT LOADING	CONTINUOUS LOADING	CYCLIC LOADING	INTERMITTENT LOADING	CONTINUOUS LOADING	CYCLIC LOADING	INTERMITTENT LOADING	CONTINUOUS LOADING	CYCLIC LOADING	INTERMITTENT LOADING	CONTINUOUS LOADING	CYCLIC LOADING	
PNP20CR	3500	1700	800	2800	1400	800	2600	1300	700	1300	700	400	18
PNP3/4CR	3500	1700	800	2800	1400	800	2600	1300	700	1300	700	400	18
PNP25CR	4000	2000	1000	3100	1500	800	2600	1300	700	1700	900	500	25
PNP1CR	4000	2000	1000	3100	1500	800	2600	1300	700	1700	900	500	25
PNP30CR	5000	2500	1200	3500	1800	1000	4000	2000	1100	2600	1300	700	30
PNP1.3/16CR	5000	2500	1200	3500	1800	1000	4000	2000	1100	2600	1300	700	30
PNP1.1/4RCR	5000	2500	1200	3500	1800	1000	4000	2000	1100	2600	1300	700	30
PNP35CR	6000	3000	1500	4300	2100	1200	4100	2100	1100	3200	1600	900	35
PNP1.1/4CR	6000	3000	1500	4300	2100	1200	4100	2100	1100	3200	1600	900	35
PNP1.7/16CR	6000	3000	1500	4300	2100	1200	4100	2100	1100	3200	1600	900	35