

IFR200

IFK3004BBPKG/AM/SC/US-104-DPS

Inductive sensors

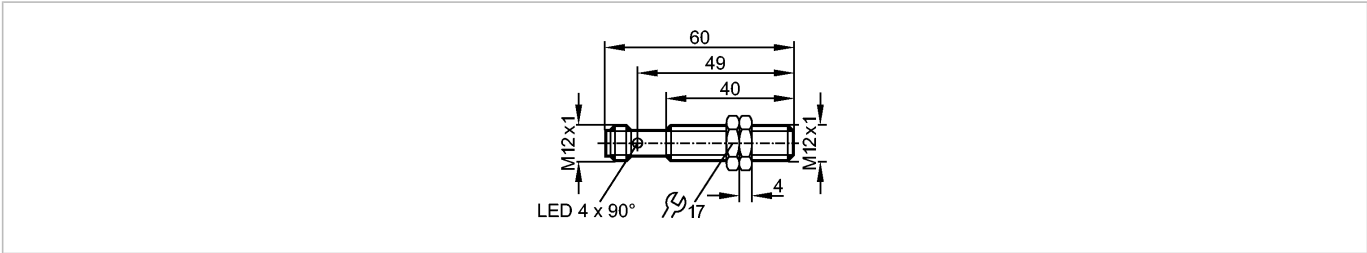

Made in Germany



Product characteristics

Inductive sensor
Metal thread M12 x 1
Connector
Full metal housing
Electromagnetic-field immune *)
Increased sensing range
Gold-plated contacts
Sensing range 4 mm; [f] flush mountable

Electrical data

Electrical design	DC PNP
Operating voltage [V]	10...36 DC
Current consumption [mA]	< 20
Protection class	III
Reverse polarity protection	yes

Outputs

Output function	normally open
Voltage drop [V]	< 2.5
Leakage current [mA]	< 0.1
Current rating [mA]	100
Short-circuit protection	pulsed
Overload protection	yes
Switching frequency [Hz]	2

Range

Sensing range [mm]	4
Operating distance [mm]	0...3.25

Accuracy / deviations

Correction factors	mild steel = 1 / stainless steel approx. 0.7 / brass approx. 0.2 / aluminium approx. 0.1 / copper = 0
Hysteresis [% of Sr]	1...20

Environment

Pressure rating [bar]	100; **)
Ambient temperature [°C]	0...85
Protection	IP 67

Tests / approvals

EMC	EN 61000-4-2 ESD: 4 kV CD / 8 kV AD
	EN 61000-4-3 HF radiated: 10 V/m (80...2000 MHz)
	EN 61000-4-4 Burst: 2 kV
	EN 61000-4-6 HF conducted: 10 V (0.15...80 MHz)

IFR200

IFK3004BBPKG/AM/SC/US-104-DPS

Inductive sensors

	EN 55011 (Emission):	class B
MTTF	[Years]	1315

Mechanical data

Mounting	flush mountable
Housing materials	housing: stainless steel 316L / 1.4404 anti-spatter; active face: stainless steel 316L / 1.4404 anti-spatter; connector: PA; lock nuts: stainless steel 316L / 1.4404 anti-spatter

Installation

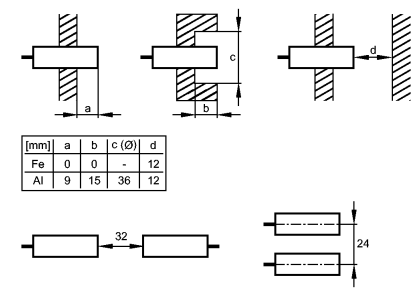

[mm]	a	b	c (Ø)	d
Fe	0	0	-	12
Al	9	15	36	12

Tightening torque	[Nm]	10
Weight	[kg]	0.036

Displays / operating elements

Output status indication	LED	yellow (4 x 90°)
Operation	LED	green

Electrical connection

Connection	M12 connector; Gold-plated contacts
------------	-------------------------------------

Wiring

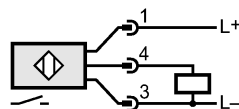

Accessories

Accessories (included)	2 lock nuts
------------------------	-------------

Remarks

Remarks	*) if pulse duration of the welding current < 200 ms **) sensing face
---------	--

Pack quantity	[piece]	1
---------------	---------	---