



22MM ROUND METAL ACTUATOR: RONIS LOCK WITH 2 KEYS MOMENTARY CONTACT 2 SWITCH POSITIONS O-I
LOCK NUMBER SB 30,
REMOVE O WITH HOLDER POSSIBLE SPECIAL LOCKS
FOR RONIS KEYSWITCHES: SB31,
455, 421

Actuato/ signaling device:

| | | |
|---|----|---------------------|
| Design of the product | | Single device round |
| Design of the operating mechanism | | Key-operated switch |
| External diameter / of the activation element | mm | 28.5 |
| Type of unlocking device | | without |
| Color / of the activation element | | Silver |
| Material / of the activation element | | metal |
| Make of the lock | | RONIS |
| Number of switching positions | | 2 |
| Switch position for key distraction | | O |
| Actuating angle | | |
| • clockwise | ° | 50 |
| Product component / front ring | | Yes |
| Material / of the front ring | | metal |
| Color / of the front ring | | silver |
| Design of the front ring | | Standard |
| Product function / EMERGENCY STOP function | | No |

Holder:

| | | |
|--------------------------|--|-------|
| Material / of the holder | | Metal |
|--------------------------|--|-------|

General technical details:

| | | |
|--|-----|-------------------|
| Resistance against shock | | |
| <ul style="list-style-type: none"> for devices without incandescent lamp / according to IEC 60068-2-27 | | <= 50g |
| Resistance against vibration / according to IEC 60068-2-6 | | 20 ... 200 Hz: 5g |
| Operating cycles / maximum | 1/h | 1,000 |
| Mechanical operating cycles as operating time / typical | | 300,000 |
| Product extension / optional / fluorescent materials | | No |
| Item designation | | |
| <ul style="list-style-type: none"> according to DIN EN 61346-2 | | S |
| <ul style="list-style-type: none"> according to DIN 40719 extendable after IEC 204-2 / according to IEC 750 | | S |
| Tightening torque / of the screws in the bracket / maximum | N·m | 1 |
| Ambient temperature | | |
| <ul style="list-style-type: none"> during operating | °C | -25 ... +70 |
| <ul style="list-style-type: none"> during storage | °C | -40 ... +80 |
| Protection class IP | | IP67 |
| climatic class / during the operating phase / according to EN 60721 | | 3K6 |
| Type of mounting | | front mounting |
| Shape / of the installation hole | | round |
| Installation width | mm | 28.5 |
| Mounting diameter | mm | 22 |
| Mounting height | mm | 44 |
| Mounting depth | mm | 29 |

Certificates/ approvals:

General Product Approval



[Special Test Certificate](#)

EG-Konf.

Shipping Approval



other

[Confirmation](#)

[other](#)

[Environmental Confirmations](#)

Further information:

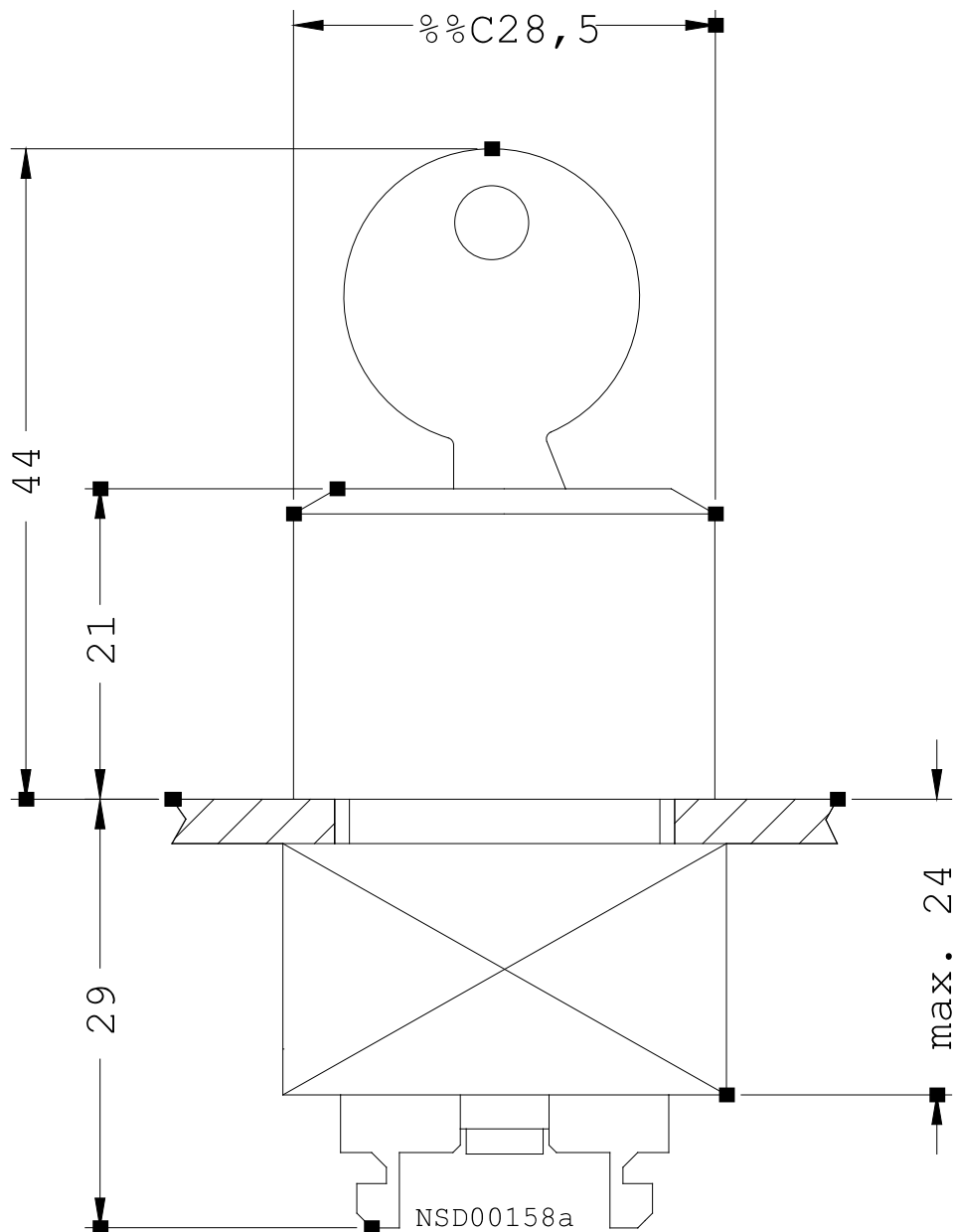

last change:

Apr 15, 2013