

LED module, green, 110-230 V AC



General technical data

Display version LED	Yes
Protection class IP	IP00
Design of the switching function positively driven	No
Reference code acc. to DIN EN 81346-2	P

Control circuit/ Control

Control supply voltage at AC	
<ul style="list-style-type: none"> • at 50 Hz rated value • at 60 Hz rated value 	110 ... 230 V
Control supply voltage frequency	
<ul style="list-style-type: none"> • 1 rated value • 2 rated value 	50 Hz 60 Hz
Supply voltage frequency for auxiliary and control current circuit rated value	50 ... 60 Hz
Product component Plug-in socket	No

Auxiliary circuit

Number of NC contacts for auxiliary contacts	0
Number of NO contacts for auxiliary contacts	0

Number of CO contacts	
<ul style="list-style-type: none"> for auxiliary contacts 	0

Main circuit

Type of voltage	AC
------------------------	----

Display

Display version	
<ul style="list-style-type: none"> as status display by LED 	LED green

Connections/ Terminals

Product function	
<ul style="list-style-type: none"> removable terminal 	No





Installation/ mounting/ dimensions

Mounting position	any
Width	15.5 mm

Ambient conditions

Ambient temperature	
<ul style="list-style-type: none"> during storage 	-25 ... +70 °C
<ul style="list-style-type: none"> during transport 	-25 ... +70 °C

Certificates/ approvals

General Product Approval		Declaration of Conformity		other	
				Miscellaneous	Confirmation
UL	VDE		EG-Konf.		

Further information

- Information- and Downloadcenter (Catalogs, Brochures,...)**
<https://www.siemens.com/ic10>
- Industry Mall (Online ordering system)**
<https://mall.industry.siemens.com/mall/en/en/Catalog/product?mlfb=LZS:PTMG0730>
- Cax online generator**
<http://support.automation.siemens.com/WW/CAXorder/default.aspx?lang=en&mlfb=LZS:PTMG0730>
- Service&Support (Manuals, Certificates, Characteristics, FAQs,...)**
<https://support.industry.siemens.com/cs/ww/en/ps/LZS:PTMG0730>
- Image database (product images, 2D dimension drawings, 3D models, device circuit diagrams, EPLAN macros, ...)**
http://www.automation.siemens.com/bilddb/cax_de.aspx?mlfb=LZS:PTMG0730&lang=en

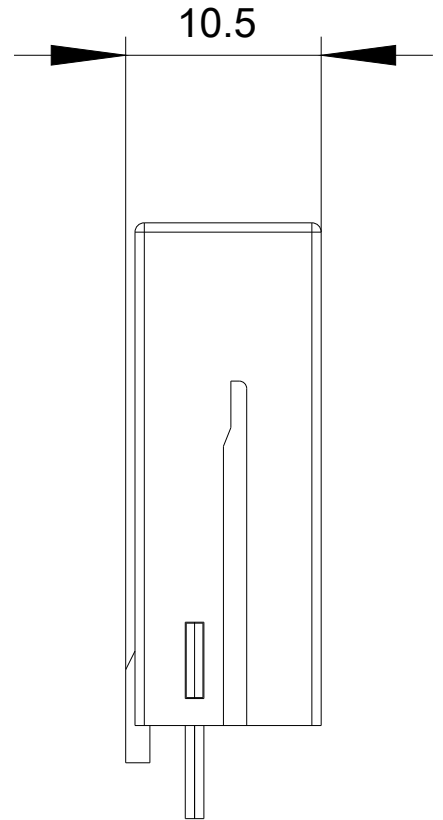
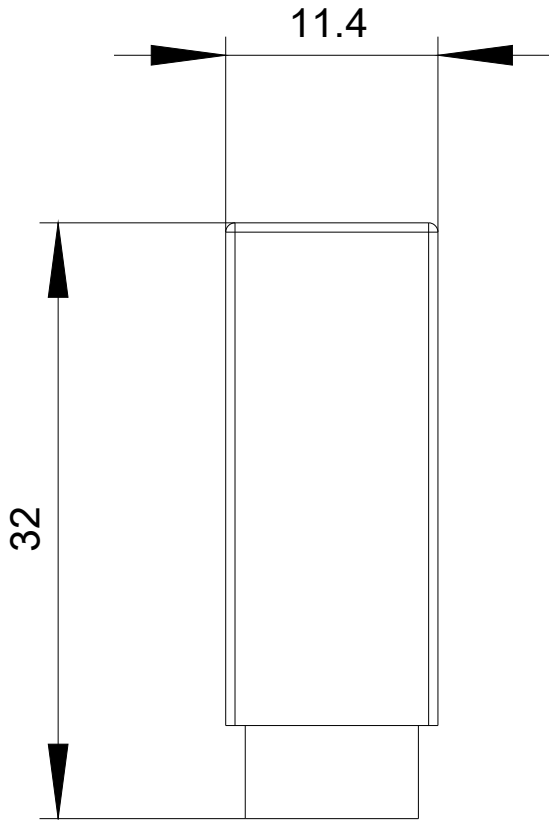

last modified:

05/15/2020