

STRAIGHT PLUGS, FULL CRIMP TYPE, FOR FLEXIBLE CABLE

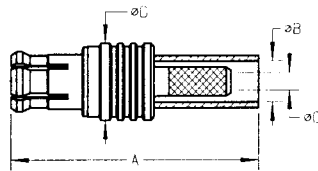
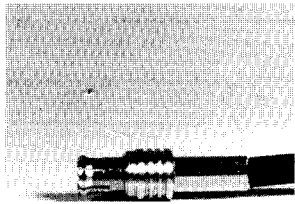

Fig. 1

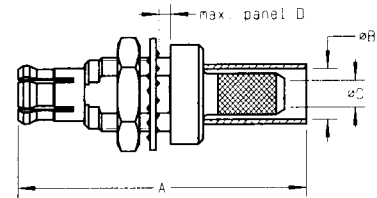
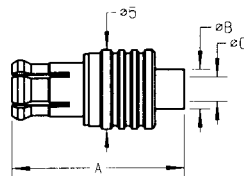

Fig. 2

cable group	part number	fig.	imp. (Ω)	dimensions (mm)				captive center contact	mounting	panel	finish
				A	B	C	D				
2 /50/ S	R113 081 000	1	50	16.3	2.55	1.1	5	no	M 01		Gold
2 /50/ S	R113 081 020	1	50	16.3	2.55	1.1	5	no	M 01		Nickel
2.6/50/ S	R113 082 000	1	50	16.3	2.95	1.65	5	yes	M 01		Gold
2.6/50/ S	R113 082 020	1	50	16.3	2.95	1.65	5	yes	M 01		Nickel
2.6/50/ S	R113 030 005●	2	50	21.55	3.25	1.72	2.5	yes	M 01	P 02	Nickel
2.6/50/ D	R113 083 000	1	50	16.3	3.25	1.65	5	yes	M 01		Gold
2.6/50/ D	R113 083 020	1	50	16.3	3.25	1.65	5	yes	M 01		Nickel
2.6/75/ S	R213 082 007	1	75	18.2	2.95	1.7	5.8	yes	M 01		BBR
2.6/75/ D	R213 083 007	1	75	18.3	3.25	1.7	5.8	yes	M 01		BBR

STRAIGHT PLUGS, SOLDER TYPE, FOR SEMI-RIGID CABLE



cable group	part number	imp. (Ω)	dimensions (mm)			captive center contact	mounting	finish
			A	B	C			
.047	R113 051 000●	50	11.3	2	1.3	no	M 04	Gold
.047	R113 051 020●	50	11.3	2	1.3	no	M 04	BBR
.085	R113 053 000	50	11.3	3	2.25	no	M 04	Gold
.085	R113 053 020●	50	11.3	3	2.25	no	M 04	BBR

● Upon request.