



# Angle Grinder

**100 mm (4'')**

**MODEL 9523NBH**

**115 mm (4-1/2'')**

**MODEL 9524NB**

**125 mm (5'')**

**MODEL 9525NB**

## INSTRUCTION MANUAL

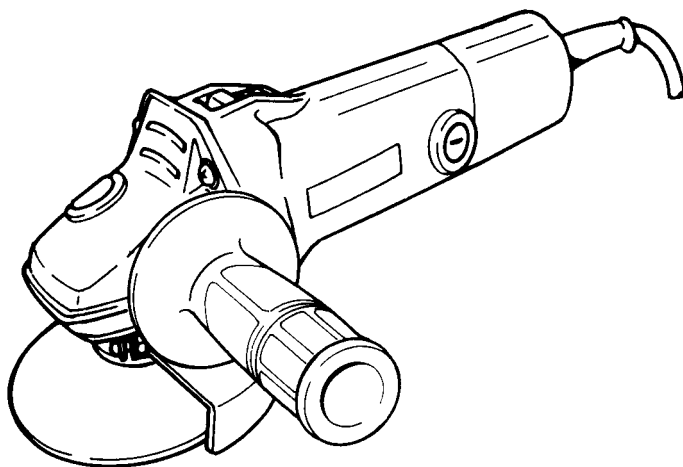

**DOUBLE  
INSULATION**

### SPECIFICATIONS

MODEL	No load speed (RPM)	Overall length	Net weight	Spindle thread
9523NBH	11,000	256 mm (10'')	1.4 kg (3.1 lbs)	M10 x 1.25
9524NB	11,000	256 mm (10'')	1.4 kg (3.1 lbs)	5/8''
9525NB	10,000	256 mm (10'')	1.4 kg (3.1 lbs)	5/8''

\* Manufacturer reserves the right to change specifications without notice.

\* Specifications may differ from country to country.

**WARNING:** For your personal safety, **READ** and **UNDERSTAND** before using.

**SAVE THESE INSTRUCTIONS FOR FUTURE REFERENCE.**

# GENERAL SAFETY RULES

## (For All Tools)

**WARNING! Read and understand all instructions.** Failure to follow all instructions listed below, may result in electric shock, fire and/or serious personal injury.

# SAVE THESE INSTRUCTIONS

## READ ALL INSTRUCTIONS.

### WORK AREA

1. **Keep your work area clean and well lit.** Cluttered benches and dark areas invite accidents.
2. **Do not operate power tools in explosive atmospheres, such as in the presence of flammable liquids, gases, or dust.** Power tools create sparks which may ignite the dust or fumes.
3. **Keep bystanders, children, and visitors away while operating a power tool.** Distractions can cause you to lose control.

### ELECTRICAL SAFETY

4. **Double Insulated tools are equipped with a polarized plug (one blade is wider than the other.) This plug will fit in a polarized outlet only one way. If the plug does not fit fully in the outlet, reverse the plug. If it still does not fit, contact a qualified electrician to install a polarized outlet. Do not change the plug in any way.** Double insulation  eliminates the need for the three wire grounded power cord and grounded power supply system.
5. **Avoid body contact with grounded surfaces such as pipes, radiators, ranges and refrigerators.** There is an increased risk of electric shock if your body is grounded.
6. **Don't expose power tools to rain or wet conditions.** Water entering a power tool will increase the risk of electric shock.
7. **Do not abuse the cord. Never use the cord to carry the tools or pull the plug from an outlet. Keep cord away from heat, oil, sharp edges or moving parts. Replace damaged cords immediately.** Damaged cords increase the risk of electric shock.
8. **When operating a power tool outside, use an outdoor extension cord marked "W-A" or "W."** These cords are rated for outdoor use and reduce the risk of electric shock.

### PERSONAL SAFETY

9. **Stay alert, watch what you are doing and use common sense when operating a power tool. Do not use tool while tired or under the influence of drugs, alcohol, or medication.** A moment of inattention while operating power tools may result in serious personal injury.
10. **Dress properly. Do not wear loose clothing or jewelry. Contain long hair. Keep your hair, clothing, and gloves away from moving parts.** Loose clothes, jewelry or long hair can be caught in moving parts.

- 11. Avoid accidental starting. Be sure switch is off before plugging in.** Carrying tools with your finger on the switch or plugging in tools that have the switch on invites accidents.
- 12. Remove adjusting keys or switches before turning the tool on.** A wrench or a key that is left attached to a rotating part of the tool may result in personal injury.
- 13. Do not overreach. Keep proper footing and balance at all times.** Proper footing and balance enables better control of the tool in unexpected situations.
- 14. Use safety equipment. Always wear eye protection.** Dust mask, non-skid safety shoes, hard hat, or hearing protection must be used for appropriate conditions.

## **TOOL USE AND CARE**

- 15. Use clamps or other practical way to secure and support the workpiece to a stable platform.** Holding the work by hand or against your body is unstable and may lead to loss of control.
- 16. Do not force tool. Use the correct tool for your application.** The correct tool will do the job better and safer at the rate for which it is designed.
- 17. Do not use tool if switch does not turn it on or off.** Any tool that cannot be controlled with the switch is dangerous and must be repaired.
- 18. Disconnect the plug from the power source before making any adjustments, changing accessories, or storing the tool.** Such preventive safety measures reduce the risk of starting the tool accidentally.
- 19. Store idle tools out of reach of children and other untrained persons.** Tools are dangerous in the hands of untrained users.
- 20. Maintain tools with care. Keep cutting tools sharp and clean.** Properly maintained tools, with sharp cutting edges are less likely to bind and are easier to control.
- 21. Check for misalignment or binding of moving parts, breakage of parts, and any other condition that may affect the tools operation. If damaged, have the tool serviced before using.** Many accidents are caused by poorly maintained tools.
- 22. Use only accessories that are recommended by the manufacturer for your model.** Accessories that may be suitable for one tool, may become hazardous when used on another tool.

## **SERVICE**







- 23. Tool service must be performed only by qualified repair personnel.** Service or maintenance performed by unqualified personnel could result in a risk of injury.
- 24. When servicing a tool, use only identical replacement parts. Follow instructions in the Maintenance section of this manual.** Use of unauthorized parts or failure to follow Maintenance Instructions may create a risk of electric shock or injury.

## ***SPECIFIC SAFETY RULES FOR GRINDER***

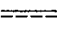
- 1. Always use proper guard with grinding wheel.** A guard protects operator from broken wheel fragments.
- 2. Accessories must be rated for at least the speed recommended on the tool warning label.** Wheels and other accessories running over rated speed can fly apart and cause injury.
- 3. Hold tool by insulated gripping surfaces when performing an operation where the cutting tool may contact hidden wiring or its own cord.** Contact with a "live" wire will make exposed metal parts of the tool "live" and shock the operator.
- 4. Never use hubbed grinding wheels on this tool (for 9523NBH only).**

## **SYMBOLS**

The followings show the symbols used for tool.

V	.....	volts
A	.....	amperes
Hz	.....	hertz
kg	.....	kilograms
h	.....	hours
min	.....	minutes
s	.....	seconds
	.....	alternating current
	.....	direct current
$n_0$	.....	no load speed
	.....	alternating or direct current
	.....	Class II Construction
	.....	splash-proof construction
	.....	watertight construction
.../min	.....	revolutions or reciprocation per minute
	.....	number of blow

### Installing the wheel guard

Mount the wheel guard with the tab on the wheel guard band aligned with the notch on the bearing box. Then rotate the wheel guard 180° clockwise (for 9523NBH) or counter-clockwise (for 9524NB and 9525NB). Be sure to tighten the screws securely.

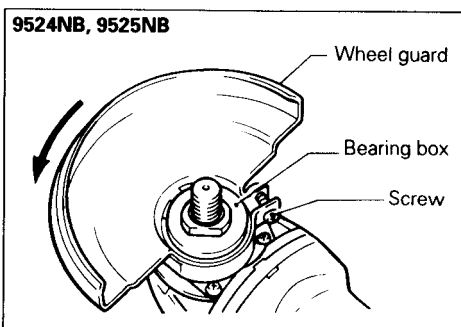
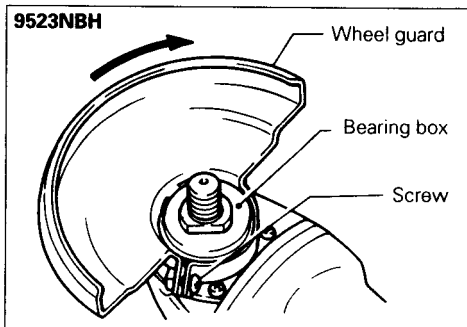

### Installing side grip (auxiliary handle)

Screw the side grip on the tool securely. The side grip can be installed on either side of the tool, whichever is convenient.

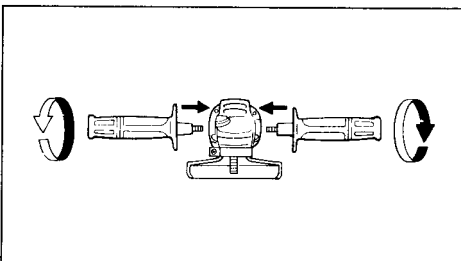

### Installing or removing the depressed center wheel

#### CAUTION:

Always be sure that the tool is switched off and unplugged before installing or removing the wheel.

Mount the inner flange onto the spindle. Fit the wheel on over the inner flange and screw the lock nut onto the spindle.

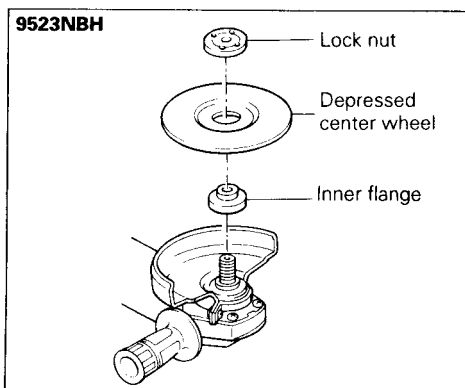
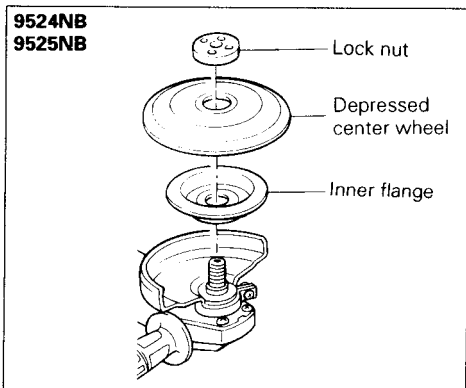

To tighten the lock nut, press the shaft lock firmly so that the spindle cannot revolve, then use the lock nut wrench and securely tighten clockwise.

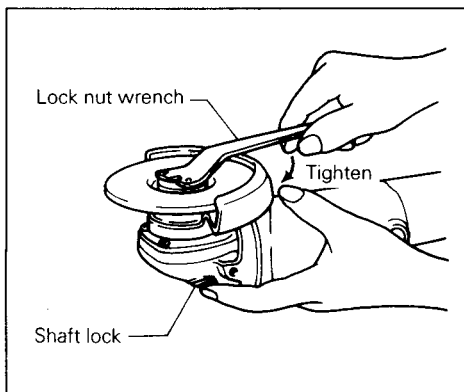

**WARNING:**

Only actuate the shaft lock when the spindle is not moving.

**Switch action**

**CAUTION:**

Before plugging in the tool, always check to see that the switch actuates properly and returns to the "OFF" position when the rear of the switch lever is depressed.

To switch on, depress the rear of the switch lever and push it forward. Then depress the front of the switch lever to lock it.

To switch off, depress the rear of the switch lever.

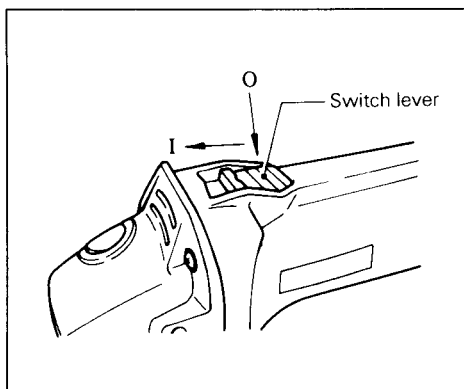

## Operation

Hold the tool firmly. Turn the tool on and then apply the wheel or disc to the workpiece.

In general, keep the edge of the wheel or disc at an angle of about  $15^{\circ}$  –  $30^{\circ}$  to the workpiece surface.

During the break-in period with a new wheel, do not work the grinder in the B direction or it will cut into the workpiece. Once the edge of the wheel has been rounded off by use, the wheel may be worked in both A and B direction.

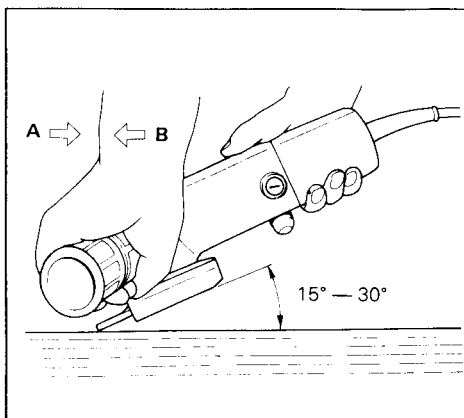

## WARNING:

- It should never be necessary to force the tool. The weight of the tool applied adequate pressure. Forcing and excessive pressure could cause dangerous when wheel breakage.
- Continued use of a worn-out wheel may result in wheel explosion and serious personal injury. Depressed center wheel should not be used after it has been worn down to 75 mm (3") in diameter for Model 9523NBH or 90 mm (3-1/2") for Models 9524NB and 9525NB in diameter. Use of the wheel after this point is unsafe and it should be removed from service and rendered unusable by intentional destruction.

## MAINTENANCE

### CAUTION:

Always be sure that the tool is switched off and unplugged before attempting to perform inspection or maintenance.

### Replacing carbon brushes

Remove and check the carbon brushes regularly. Replace when they wear down to the limit mark. Keep the carbon brushes clean and free to slip in the holders. Both carbon brushes should be replaced at the same time. Use only identical carbon brushes.

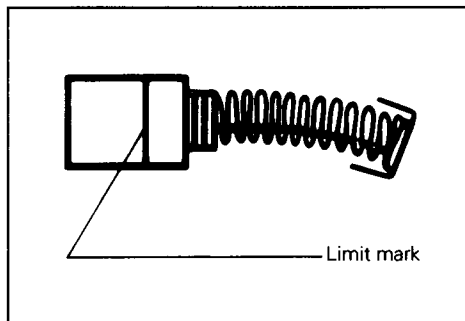

Use a screwdriver to remove the brush holder caps. Take out the worn carbon brushes, insert the new ones and secure the brush holder caps.

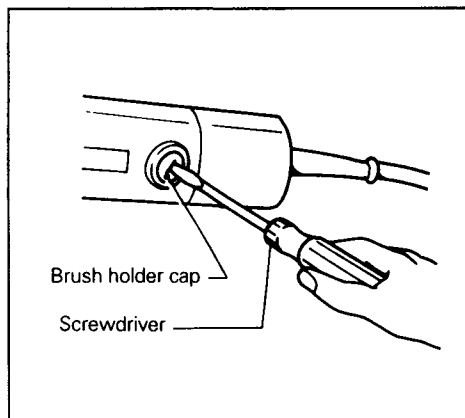

To maintain product SAFETY and RELIABILITY, repairs, any other maintenance or adjustment should be performed by Makita Authorized or Factory Service Centers, always using Makita replacement parts.



# ACCESSORIES

## CAUTION:

These accessories or attachments are recommended for use with your Makita tool specified in this manual. The use of any other accessories or attachments might present a risk of injury to persons. The accessories or attachments should be used only in the proper and intended manner.

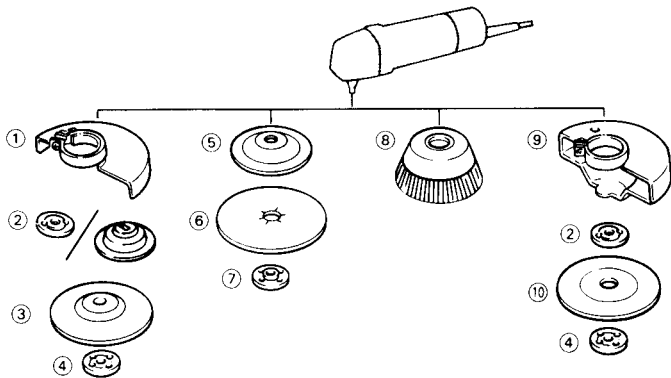

### ① Wheel cover

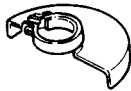

Part No.	For Model
165171-1	9523NBH
165053-7	9524NB
165055-3	9525NB

### ② Inner flange



35



82

Size	Part No.	For Model
35	224337-3	9523NBH
82	224361-6	9524NB 9525NB

### ③ Depressed center wheels

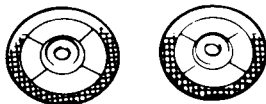

Part No.	Size	Grit	Wheels per pkg.	For Model
741402 B (Bulk)	4" x 3/16" x 5/8"	24	1	9523NBH
741402 8 1	4" x 1/4" x 5/8"			
741402 9-1				
741402 C				
741425 B				
741402 8	4" x 3/16" x 5/8"	C24R	5	
741402 9AP	4" x 1/4" x 5/8"			
741405 2-1	4" x 3/16" x 5/8"	24	5	
741405 2P			1	
741423 0 1	4 1/2" x 1/4" x 7/8"	24	5	9524NB
741423 B			1	
741423 0			5	
741426 B		C24R	1	
741424 8 1		36	1	
741424 8	5			
741407 B	5" x 1/4" x 7/8"	24	1	9525NB
741427 B		C24R	1	

### ③ Multi-disc

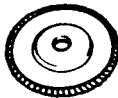

Part No.	Size	Grit	For Model
742038-0A	4" x 1/2" x 5/8"	40	9523NBH
742038-0B		60	
742038-0C		80	
742038-0D		100	
794332 2A	4-1/2" x 5/8" x 7/8"	40	9524NB
794332-2B		60	
794332 2C		80	
794332 2D		100	
794331 4A	5" x 5/8" x 7/8"	40	9525NB
794331-4B		60	
794331-4C		80	
794331-4D		100	

### ④ Lock nut



Size	Part No.	For Model
10-35	224545-6	9523NBH
5/8-40	224509-0	9524NB 9525NB

⑤ Rubber pad



Part No.	For Model
743009-6	9523NBH
743036-3	9524NB
743015-1	9525NB

⑥ Abrasive discs



Part No.	Diameter	Grit	Qty. per pkg.	For Model
742036-0-3	4"	24	3	9523NBH
742037-8-3		36		
742038-6-3		50		
742039-4-3		80		
742087-3-3		100		
742040-9-3		120	5	
742036-A-5		24		
742037-A-5		36		
742038-A-5		50		
742039-A-5		80		
742087-A-5		100		
742040-A-5		120	1	
742036-B		24		
742037-B		36		
742038-B		50		
742039-B	80			
742087-B	100			
742040-B	120			
794104-A-5	4-1/2"	24	5	9524NB
794105-A-5		30		
794106-A-5		50		
794107-A-5		80		
794108-A-5		120		
794104-B		24	1	
794105-B		30		
794106-B		50		
794107-B		80		
794108-B		120		
742072-A-5	5"	24	5	9525NB
742073-A-5		30		
742074-A-5		50		
742075-A-5		80		
742076-A-5		120		
742072-B		24	1	
742073-B		36		
742074-B		50		
742075-B		80		
742076-B		120		

⑦ Lock nut 10—30  
(For abrasive disc)



Part No.	For Model
224501-6	9523NBH
224517-1	9524NB 9525NB

⑧ Wire cup brush 75



Part No.	For Model
743205-6	9524NB 9525NB

⑧ Wire bevel brush 85



Part No.	For Model
743210-A	9524NB 9525NB

⑨ Wheel guard assembly  
(For cut-off wheel) For Model 9523NBH  
Part No. 192626-3



⑩ Cut-off wheel



Part No.	Size	Grit	Wheels per pkg.	For use	For Model
724104-110	4" x 3/32" x 5/8"	36	10	For masonry and concrete.	9523NBH
724107-510	4" x 5/64" x 5/8"	46	10	For steel and cast iron.	

• Knot-Type  
Wire cup brush



Part No.	For Model
743209-A	9524NB 9525NB
743209-B	
743208-0A	

• Knotted Twist  
Wire brush wheel



Part No.	For Model
743212-A	9524NB 9525NB

• Stringer Bead Twist  
Wire brush wheel



Part No.	For Model
743213-A	9524NB 9525NB
743216-A	
743213-B	

• Lock nut wrench



Part No.	For Model
782401-1	9523NBH
782412-6	9524NB 9525NB

• Full Cable Twist  
Wire brush wheel



Part No.	For Model
743211-A	9524NB 9525NB
743217-A	
743214-A	

• Grip  
Part No. 152487-3

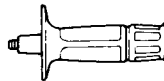

# 100 mm (4") ANGLE GRINDER Model 9523NBH

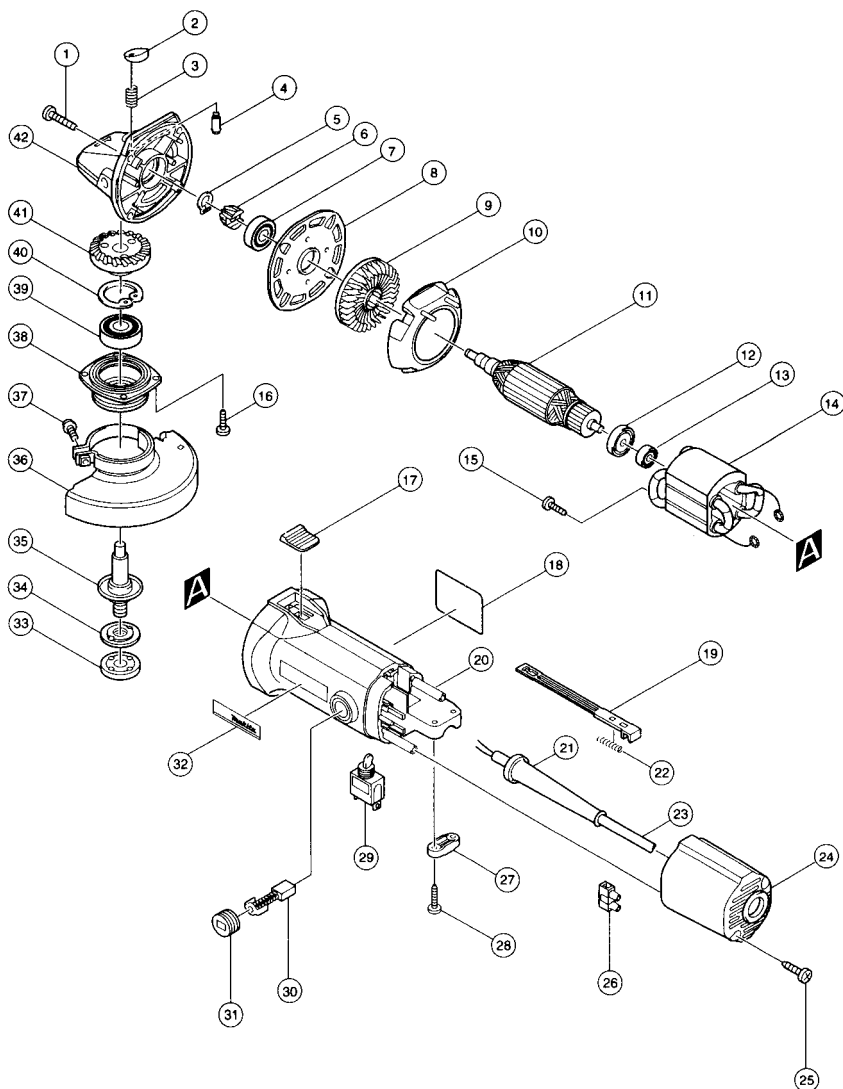

Note: The switch and other part configurations may differ from country to country.

ITEM NO.	NO. USED	DESCRIPTION	ITEM NO.	NO. USED	DESCRIPTION
<b>MACHINE</b>			<b>MACHINE</b>		
1	4	Tapping Screw Flange PT 5x25	22	1	Compression Spring 4
2	1	Pin Cap	23	1	Cord
3	1	Compression Spring 8	24	1	Rear Cover
4	1	Pin 4	25	2	Tapping Screw Flange PT 4x18
5	1	Retaining Ring S 6	26	1	Terminal Block 1P
6	1	Spiral Bevel Gear 11	27	1	Strain Relief
7	1	Ball Bearing 6000ZZ	28	2	Tapping Screw Flange PT 4x18
8	1	Bearing Retainer 52	29	1	Switch
9	1	Fan 57	30	2	Carbon Brush
10	1	Baffle Plate	31	2	Holder Cap
11	1	ARMATURE ARMATURE (With Item 12 & 13)	32	1	Makita Label
12	1	Insulation Washer	33	1	Lock Nut 10 - 35
13	1	Ball Bearing 606ZZ	34	1	Inner Flange 35
14	1	FIELD ASSEMBLY	35	1	Spindle Complete
15	2	Tapping Screw Bnd PT 3x10	36	1	Wheel Cover
16	4	Tapping Screw CT 4x16	37	1	Pan Head Screw M5x16
17	1	Switch Knob	38	1	Bearing Box
18	1	Name Plate	39	1	Ball Bearing 6201DDW
19	1	Switch Lever	40	1	Retaining Ring R-32
20	1	Motor Housing Complete	41	1	Spiral Bevel Gear 36
21	1	Cord Guard	42	1	Gear Housing Complete

Note: The switch and other part specifications may differ from country to country

# ANGLE GRINDER

115 mm (4-1/2")  
125 mm (5")

Model 9524NB  
Model 9525NB

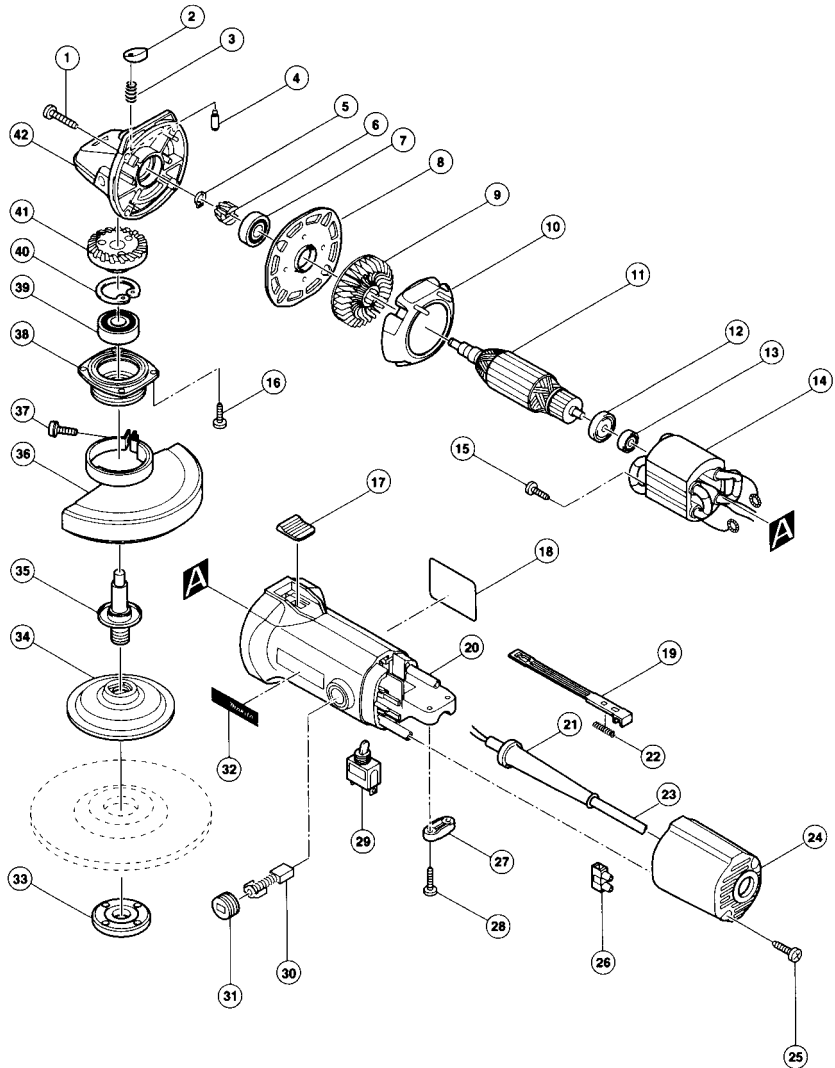

Note: The switch and other part configurations may differ from country to country.

ITEM NO.	NO. USED	DESCRIPTION	ITEM NO.	NO. USED	DESCRIPTION
MACHINE			MACHINE		
1	4	Tapping Screw Flange PT 5x25	21	1	Cord Guard
2	1	Pin Cap	22	1	Compression Spring 4
3	1	Compression Spring 8	23	1	Cord
4	1	Pin 4	24	1	Rear Cover
5	1	Retaining Ring S 6	25	2	Tapping Screw Flange PT 4x18
6		Spiral Bevel Gear	26	1	Terminal Block 1P
	1	11 For Model 9524NB	27	1	Strain Relief
	1	10 For Model 9525NB	28	2	Tapping Screw Flange PT 4x18
7	1	Ball Bearing 6000ZZ	29	1	Switch
8	1	Bearing Retainer 52	30	2	Carbon Brush
9	1	Fan 57	31	2	Holder Cap
10	1	Baffle Plate	32	1	Makita Label
11	1	ARMATURE ARMATURE (With Item 12 & 13)	33	1	Lock Nut 5/8-40
12	1	Insulation Washer	34	1	Inner Flange 82
13	1	Ball Bearing 606ZZ	35	1	Spindle Complete
14	1	FIELD ASSEMBLY	36	1	Wheel Cover
15	2	Tapping Screw Bind PT 3x10	37	1	Pan Head Screw M5x16
16	4	Tapping Screw CT 4x16	38	1	Bearing Box
17	1	Switch Knob	39	1	Ball Bearing 6201DDW
18	1	Name Plate	40	1	Retaining Ring R-32
19	1	Switch Lever	41	1	Spiral Bevel Gear 36
20	1	Motor Housing Complete	42	1	Gear Housing Complete

Note: The switch and other part specifications may differ from country to country.

## MAKITA LIMITED ONE YEAR WARRANTY

### Warranty Policy

Every Makita tool is thoroughly inspected and tested before leaving the factory. It is warranted to be free of defects from workmanship and materials for the period of ONE YEAR from the date of original purchase. Should any trouble develop during this one-year period, return the COMPLETE tool, freight prepaid, to one of Makita's Factory or Authorized Service Centers. If inspection shows the trouble is caused by defective workmanship or material, Makita will repair (or at our option, replace) without charge.

This Warranty does not apply where:

- repairs have been made or attempted by others;
- repairs are required because of normal wear and tear;
- The tool has been abused, misused or improperly maintained;
- alterations have been made to the tool.

IN NO EVENT SHALL MAKITA BE LIABLE FOR ANY INDIRECT, INCIDENTAL OR CONSEQUENTIAL DAMAGES FROM THE SALE OR USE OF THE PRODUCT. THIS DISCLAIMER APPLIES BOTH DURING AND AFTER THE TERM OF THIS WARRANTY.

MAKITA DISCLAIMS LIABILITY FOR ANY IMPLIED WARRANTIES, INCLUDING IMPLIED WARRANTIES OF "MERCHANTABILITY" AND "FITNESS FOR A SPECIFIC PURPOSE," AFTER THE ONE-YEAR TERM OF THIS WARRANTY.

This Warranty gives you specific legal rights, and you may also have other rights which vary from state to state. Some states do not allow the exclusion or limitation of incidental or consequential damages, so the above limitation or exclusion may not apply to you. Some states do not allow limitation on how long an implied warranty lasts, so the above limitation may not apply to you.

**Makita Corporation**

3-11-8, Sumiyoshi-cho,  
Anjo, Aichi 446-8502 Japan

884194-069

PRINTED IN JAPAN

1998-6-N