

FEATURES

- Light-weight aluminium alloy
- Suitable for cut to length applications
- Structural element type: Strut profile
- Compatible with support and connector accessories

RS PRO Strut, 40 x 40 mm, 8mm Groove , 2000mm Length

RS Stock No.: 761-3313



RS Professionally Approved Products bring to you professional quality parts across all product categories. Our product range has been tested by engineers and provides a comparable quality to the leading brands without paying a premium price.

Product Description

RS PRO structural systems offer a modular solution for general workplace furniture construction. Offering strong, light-weight, easily interchangeable components in a variety of profile types. The modular system offers alloy struts available in 1m, 2m and 3m lengths with profiles from 20mm to 80mm.

This range includes the following Aluminium Alloy Struts:

[761-3319](#) - 40 x 40 mm, 8mm Groove, 1000mm Length, Series Profile 8

[761-3313](#) - 40 x 40 mm, 8mm Groove, 2000mm Length, Series Profile 8

[761-3322](#) - 40 x 40 mm, 8mm Groove, 3000mm Length, Series Profile 8

General Specifications

Structural Element Type	Strut Profile
Number of Grooves	4
Material	Anodised Aluminium
Applications	Construction, Industrial equipment, Automotive manufacturing, Plumbing

Mechanical Specifications

Strut Profile	40mm x 40mm
Length	2000mm
Groove Size	8mm
Mass (G)	1.5kg/m
Moment of Inertia (I₂)	9.18 cm ⁴
Section Modulus (W_x)	4.59 cm ³

Compatible Accessories for Groove

Stock No.	Items
<u>767-5601, 767-5604, 767-5608</u>	End Caps
<u>767-5695, 767-5718, 767-5737, 767-5715, 767-5761, 767-5692, 767-5721, 767-5709, 767-5702</u>	Connector Bracket and Joint
<u>767-5727</u>	Floor Bracket
<u>767-5645, 767-5642, 767-5654, 767-5667, 767-5648, 767-5651, 767-5658, 767-5660, 767-5664, 767-5673, 767-5636</u>	T-Slot Nut
<u>767-5822, 767-5686, 767-5689</u>	Screws
<u>767-5711</u>	Cube Connector
<u>767-5730, 767-5670, 767-5676</u>	Universal Connector
<u>767-5686, 767-5682</u>	T-Matic Connector
<u>767-5689</u>	Screw connector
<u>767-5695, 767-5698</u>	Connection Angle
<u>767-5743</u>	Roller

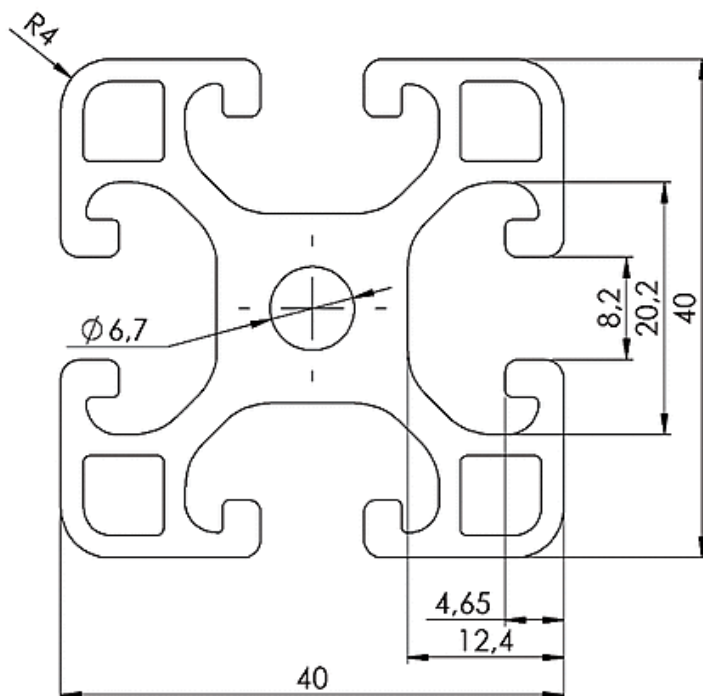

RS Article no.	40 Character Description	Profile Length
7613319	Profile 8 40x40 light 1m	1000mm
7613313	Profile 8 40x40 light 2m	2000mm
7613322	Profile 8 40x40 light 3m	3000mm