



FAG

SES530-L

Plummer block housing

Split plummer block housing for various bearing designs. The SNV series will be replaced by the new SES series in 2022.

Technical information

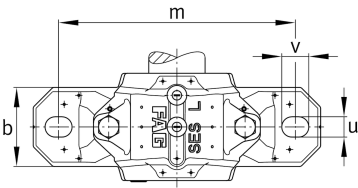

Main Dimensions & Performance Data

D	270 mm	Outside diameter bearing
a	530 mm	Length base
h ₁	323 mm	Height
g	220 mm	Width housing body
K	106 mm	Width bearing seat
≈m	48.7 kg	Weight

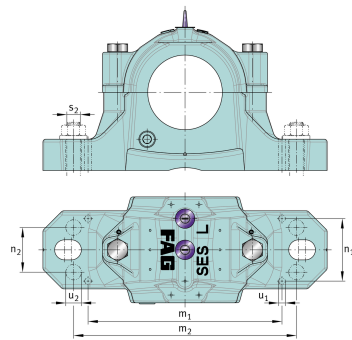
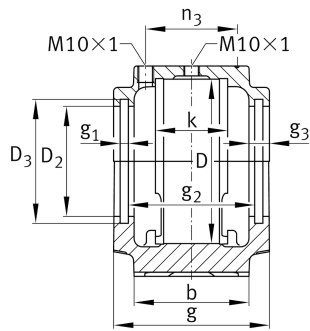
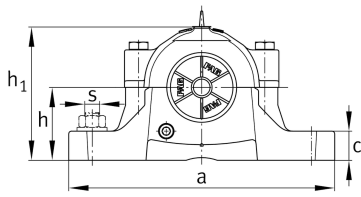

Dimensions

b	160 mm	Width base
c	60 mm	Height base
h	160 mm	Base to shaft centerline height
m	450 mm	Distance fixing bore
s	31.75 mm	Screw size
s	M30	Size of fixing screws
u	35 mm	Width slot
v	42 mm	Length slot
D ₂	192.5 mm	Diameter sealing
D ₃	202.5 mm	Diameter sealing groove
D ₅	199.2 mm	Outside diameter sealing labyrinth
g ₁	6 mm	Width sealing groove
g ₂	198 mm	Distance sealing
g ₃	15 mm	Wall thickness
g ₄	40 mm	Distance oil lubrication
m ₁	374 mm	Distance holes aligned pins m1
n ₃	140 mm	Distance lubrication
n ₄	203 mm	Distance lubrication sealing
u ₁	12 mm	Bore diameter u1
u ₂	26 mm	Bore diameter u2