



Cert. No. LRQ 0963008

ISO 9001

spirax sarco

TI-P145-11
ST Issue 3

FTGS14 Ball Float Steam Trap (Screwed)

Description

The FTGS14 is a maintainable ball float steam trap with integral automatic air venting facility. It is available with horizontal connections and has a stainless steel body and an electroless nickel plated SG iron cover offering increased resistance to erosion.

All FTGS14's are provided with a drilled, tapped and plugged hole, therefore a steam lock release (SLR) valve can be retrofitted to the standard trap.

Optional extras

FTGS14C - An optional (SLR) valve (designated 'C' on the nomenclature) can be fitted to the trap to prevent steam locking of the system, this feature is available in addition to the air vent. For further information, please consult Spirax Sarco.

Standards

The product fully complies with the requirements of the European Pressure Equipment Directive 97/23/EC.

Certification

This product is available with material certification to EN 10204 2.2.

Note: All certification/inspection requirements must be stated at the time of order placement.

Sizes and pipe connections

1/2" and 3/4" screwed BSP or NPT.

Pressure/temperature limits (ISO 6552)

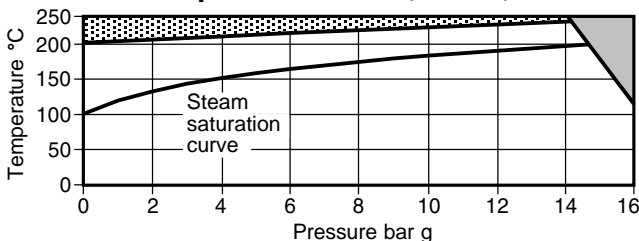

The product **must not** be used in this region.

The product should not be used in this region as damage to the internals may occur.

Body design conditions		PN16
PMA	Maximum allowable pressure	16 bar g @ 120°C
TMA	Maximum allowable temperature	250°C
Minimum allowable temperature		-10°C
PMO	Maximum operating pressure for saturated steam service	14.6 bar g @ 200°C
TMO	Maximum operating temperature	235°C @ 14.3 bar g
Minimum operating temperature		0°C
	Maximum	FTGS14-4.5 4.5 bar
ΔPMX	differential pressure	FTGS14-10 10 bar
		FTGS14-14 14 bar

Designed for a maximum cold hydraulic test pressure of 24 bar g

Materials

No. Part	Material
1 Body	Austenitic stainless steel EN 10213-4 (1.4308) ASTM A351 CF8
2 Cover bolts	Steel
3 Cover gasket	Reinforced exfoliated graphite
4 Cover	Electroless nickel plated SG iron DIN 1693 GGG 40

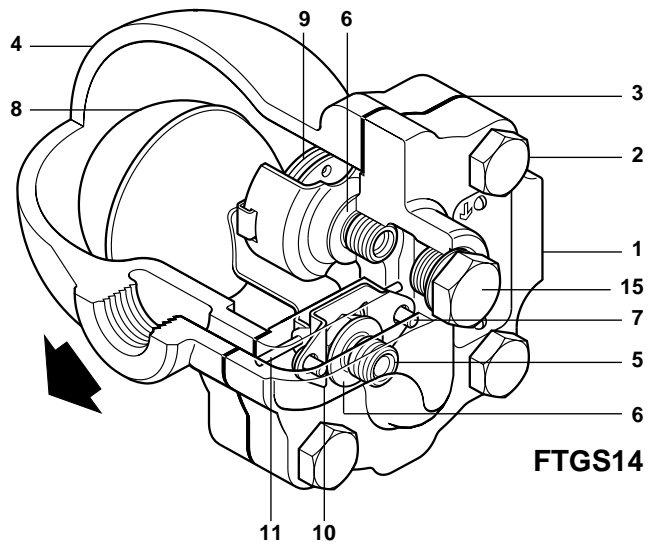

FTGS14

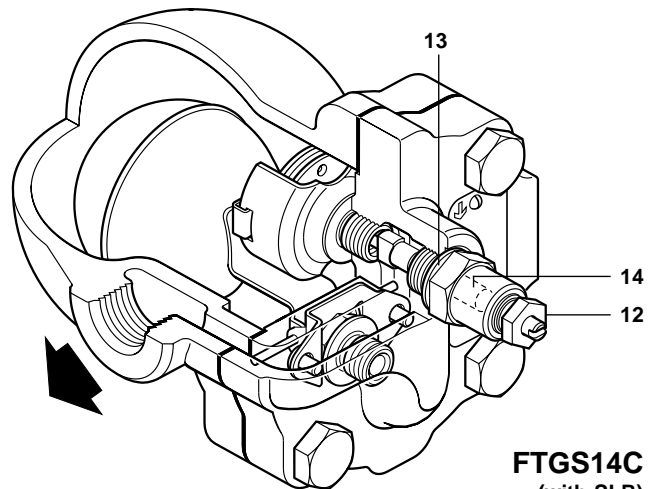

FTGS14C
(with SLR)

No. Part	Material
5 Main valve seat	Stainless steel
6 Main valve/air vent seat gasket	Stainless steel
7 Main valve assembly screws	Stainless steel
8 Ball float and lever	Stainless steel
9 Air vent assembly	Stainless steel
10 Pivot frame	Stainless steel
11 Pivot pin	Stainless steel
12 SLR assembly	Stainless steel
13 SLR gasket	Stainless steel
14 SLR seal	Graphite
15 SLR plug	Stainless steel

Dimensions/weights (approximate) in mm and kg

Size	A	B	B1	C	D	E	Withdrawal distance	F	Weight
½" and ¾"	121	107	96	77	158	105		27	3.15

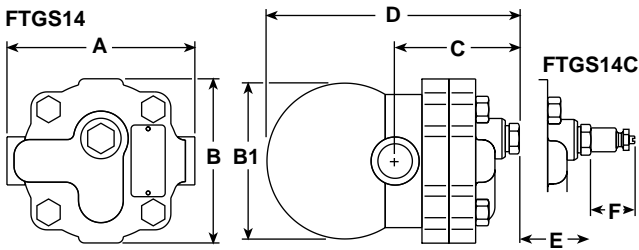

Capacities

Note. Capacities shown are based on discharge at steam saturation temperature. When discharging sub-cooled condensate the air vent provides extra capacity. Under start-up conditions the thermostatic air vent will be open, and will provide additional condensate capacity to the main valve assembly. On 4.5 bar units this will provide a minimum of 50% increased capacity above the hot condensate figures shown. On 10 and 14 bar units this will be a minimum increase of 100% on the published capacity. For full details see TI-S02-28.

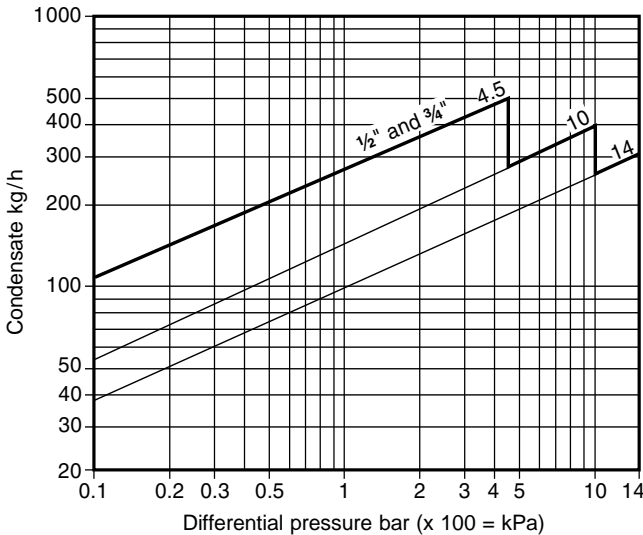

Safety information, installation and maintenance

For full details see the Installation and Maintenance Instructions (IM-P145-12) supplied with the product.

Installation note - The FTGS14 must be installed with the direction of flow as indicated on the cover, and with the float arm in a horizontal plain so that it rises and falls vertically. The FTGS14 has been designed for use in a right to left flow direction when viewed from the name plate end, however, it can also be installed in a left to right orientation, by simply rotating the complete trap through 180°. **Caution:** Ensure that adequate distance is allowed for removal of the body and internals in the event of maintenance. See 'Dimensions/weights' for withdrawal distances.

Disposal - This product is recyclable. No ecological hazard is anticipated with the disposal of this product providing due care is taken.

How to order

Example: 1 off Spirax Sarco ½" FTGS14-4.5 ball float steam trap with screwed BSP connections and integral air vent.

Spare parts

The spare parts available are shown in solid outline. Parts drawn in broken line are not supplied as spares.

Available spares

Maintenance kit	3, 5, 6 (2 off), 7 (2 off), 8, 9, 10, 11
Main valve assembly	3, 5, 6, 7, 8, 10, 11
Air vent assembly	3, 6, 9
Steam lock release	12 + 14, 13
Cover gasket (packet of 3)	3

How to order spares

Always order spares by using the description given in the column headed 'Available spares' and state the size, type of trap and pressure range.

Example: 1 - Main valve assembly for a Spirax Sarco ½" FTGS14-10 ball float steam trap.

Recommended tightening torques

Item	or mm	N m
2	17 A/F	47 - 50
5	17 A/F	50 - 55
7	Pozidrive	2.5 - 3.0
9	17 A/F	50 - 55
12	19 A/F	57 - 63
15	19 A/F	57 - 63

