

Datasheet

Toroidal Transformers – twin primary, UL type

Scandinavian Transformer

Standard toroidal transformers designed according to the following specifications.

- High quality safety and isolating transformers designed for use in control circuits and general applications
- High quality, low loss and low noise toroidal core
- Environmentally friendly, low energy dissipation
- Dual primary windings for parallel or serial connection.
- High efficiency, low regulation design
- Dual secondary windings
- Detailed product specification on permanent label
- Designed and manufactured to conform to BS EN 61558-1 and UL506
- 100% electrical and flash tested
- Mounting kit included: 2 rubber washers, 1 metal disc, bolt and nut

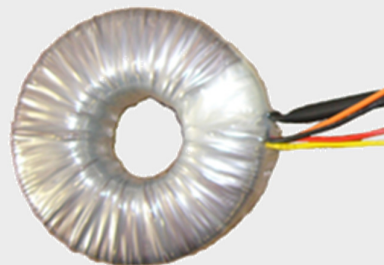

Specifications

Power:	100 – 1000 VA
Frequency:	50/60 Hz
Primary:	2 x 115 VAC
Secondary:	2 x (6, 9, 12, 15, 18, 24, 30, 40, 45, 50, 55, 115) VAC
Isolation:	4 kV RMS
Temp. rise:	Typ. 55°C
Temp. class:	A (105°)
According to:	EN61558-1
Approved to:	UL 506 (E244301)



Schematic/connections:

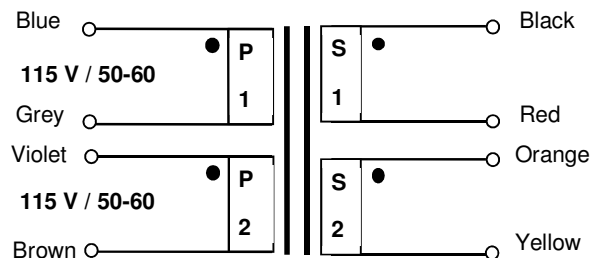

Scandinavian Transformer

Ordering details:

RS Stock number	ST number	Power VA	Specification	No-load voltage	According to
1176050	ST190530	80	2 Output Toroidal Transformer 80VA, 9V	2 x 10.5	BS/EN61558-2-6
1176052	ST190542	100	2 Output Toroidal Transformer 100VA, 15V	2 x 17.3	BS/EN61558-2-6
1176053	ST190543	100	2 Output Toroidal Transformer 100VA, 18V	2 x 20.5	BS/EN61558-2-6
1176054	ST190544	100	2 Output Toroidal Transformer 100VA, 24V	2 x 27.2	BS/EN61558-2-6
1176055	ST190545	100	2 Output Toroidal Transformer 100VA, 55V	2 x 62.3	BS/EN61558-2-4
1176056	ST190553	120	2 Output Toroidal Transformer 120VA, 24V	2 x 27	BS/EN61558-2-6
1176057	ST190563	160	2 Output Toroidal Transformer 160VA, 24V	2 x 26.4	BS/EN61558-2-6
1176059	ST190573	200	2 Output Toroidal Transformer 200VA, 24V	2 x 26.1	BS/EN61558-2-6
1176060	ST190575	200	2 Output Toroidal Transformer 200VA, 115V	2 x 124.1	BS/EN61558-2-4
1176062	ST190590	300	2 Output Toroidal Transformer 300VA, 24V	2 x 25.8	BS/EN61558-2-6
1176064	ST190591	300	2 Output Toroidal Transformer, 300VA, 30V	2 x 32.3	BS/EN61558-2-6
1176065	ST190592	300	2 Output Toroidal Transformer, 300VA, 40V	2 x 42.7	BS/EN61558-2-6
1176067	ST190595	300	2 Output Toroidal Transformer, 300VA, 55V	2 x 58.9	BS/EN61558-2-4
1176071	ST190610	500	2 Output Toroidal Transformer, 500VA, 24 V	2 x 25.6	BS/EN61558-2-6
1176072	ST190611	500	2 Output Toroidal Transformer, 500VA, 30V	2 x 31.9	BS/EN61558-2-6
1176073	ST190612	500	2 Output Toroidal Transformer, 500VA, 40V	2 x 42.6	BS/EN61558-2-6
1176074	ST190614	500	2 Output Toroidal Transformer, 500VA, 50V	2 x 53.4	BS/EN61558-2-4
1176075	ST190615	500	2 Output Toroidal Transformer, 500VA, 55V	2 x 58.8	BS/EN61558-2-4
1176076	ST190622	800	2 Output Toroidal Transformer, 800VA, 45V	2 x 47.3	BS/EN61558-2-6
1176077	ST190623	800	2 Output Toroidal Transformer, 800VA, 50V	2 x 52.9	BS/EN61558-2-4
1176078	ST190624	800	2 Output Toroidal Transformer, 800VA, 55V	2 x 57.8	BS/EN61558-2-4
1176079	ST190632	1000	2 Output Toroidal Transformer, 1000VA, 45V	2 x 47.3	BS/EN61558-2-6
1176080	ST190633	1000	2 Output Toroidal Transformer, 1000VA, 50V	2 x 52.5	BS/EN61558-2-4

Scandinavian Transformer

Dimensions:

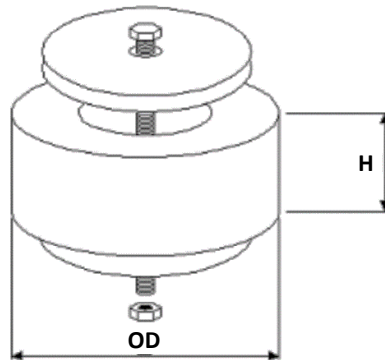

Power [VA]	Secondary [V]	Overall Size OD x ID x H [mm]	Weight [kg]
80	2x (9, 12, 15, 18, 24, 55, 115)	90 x 35 x 38	0.90
100	2x (9, 12, 15, 18, 24, 55, 115)	90 x 37 x 45	1.10
120	2x (12, 15, 18, 24, 55, 115)	92 x 37 x 48	1.30
160	2x (12, 15, 18, 24, 55, 115)	100 x 35 x 46	1.55
200	2x (12, 15, 18, 24, 55, 115)	115 x 40 x 48	1.90
250	2x (24, 30, 40, 45, 50, 55, 115)	115 x 40 x 54	2.40
300	2x (24, 30, 40, 45, 50, 55, 115)	117 x 40 x 60	2.70
500	2x (24, 30, 40, 45, 50, 55, 115)	135 x 50 x 68	4.00
800	2x (24, 30, 45, 50, 55, 115)	160 x 58 x 78	6.40
1000	2x (24, 30, 45, 50, 55, 115)	175 x 70 x 85	8.40