

PCB layout, component side

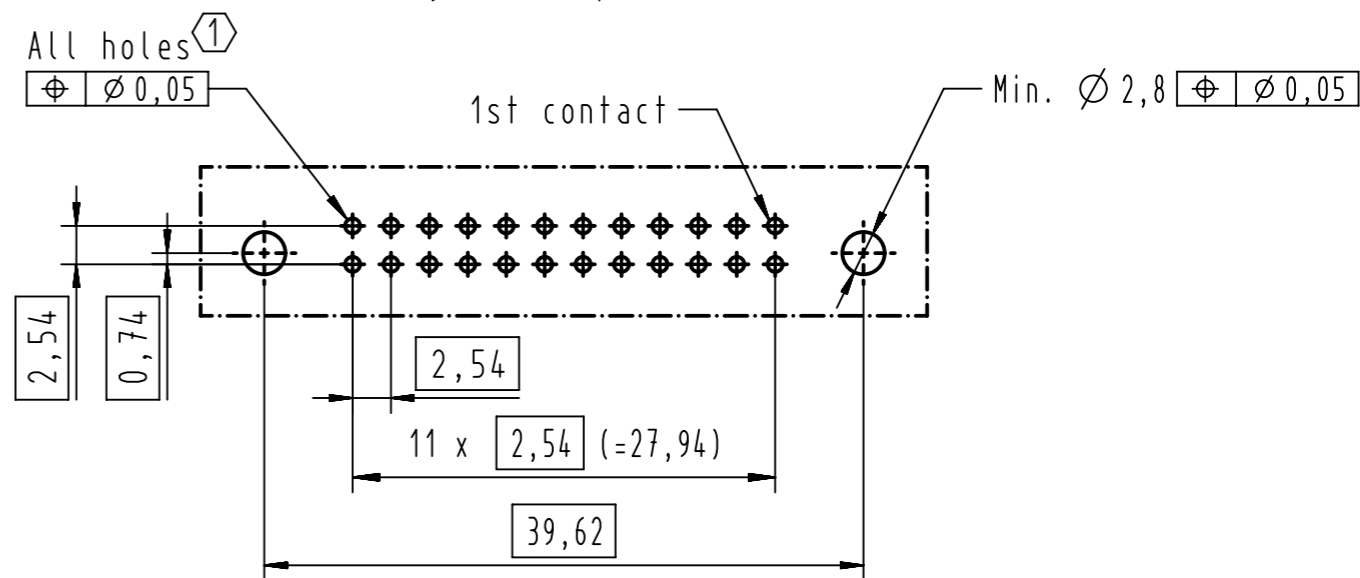

① Solder pins for PCB connections $\varnothing 1 \pm 0,1$ according to IEC 60 326-3

09 18 524 7923 001	3	2,9	black insulator
09 18 524 6923 001	2	2,9	black insulator
09 18 524 5923 001	0,76µm Au or equivalent PdNi	2,9	black insulator
09 18 524 7923	3	2,9	standard insulator color
09 18 524 6923	2	2,9	standard insulator color
09 18 524 5923	0,76µm Au or equivalent PdNi	2,9	standard insulator color
Part number	Performance level	a	Index designation

	All Dimensions in mm Original Size DIN A3		Scale 2:1	Free size tol.		Ref.	
	All rights reserved		Created by HUCBOURG	Inspected by BAGDIKIAN	Standardisation HOFFMANN	Date 2013-01-31	State Final Release
Department EC PD - FR		Title SEK male STD 24P angled pins-W/O LL				Doc-Key / ECM-Nr. 100528595/UGD/001/A 50000058744	
HARTING Electronics GmbH D-32339 Espelkamp		Type TB	Number 0918524X923			Rev. A	Page 1/1