



Brand of NTN Group

Technical data

ESPP202
Bearing units



Sheet metal housing, radial insert ball bearing with eccentric locking collar, single lip seal

KIT CONTENT

ES202G2, PP203

VISUAL (S)

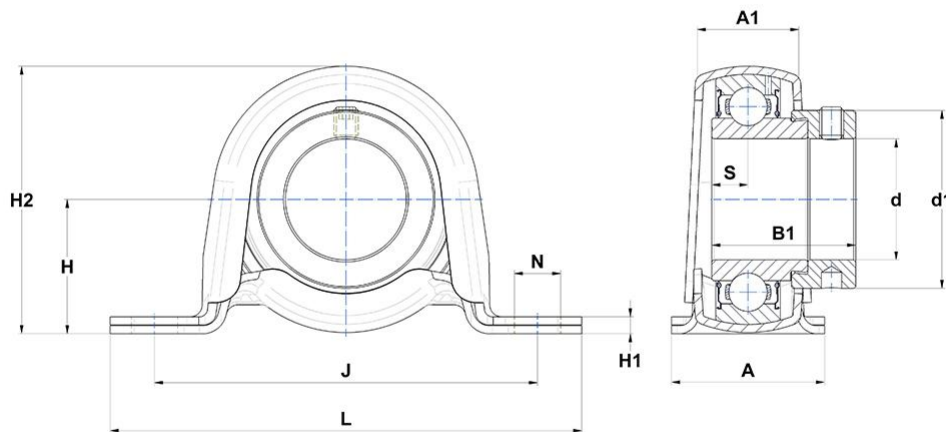

PRODUCT DEFINITION

Brand	SNR
A - Housing width	25,4 mm
A1 - Housing top width	15,9 mm
B - Width of Inner Ring	19,1 mm
d - Shaft diameter	15 mm
d1 - Outer dia of eccent. Lock. collar / nut of adapter sleeve	27,2 mm



NTN Europe

1 rue des Usines · BP 2017 · 74010 Annecy Cedex · France · Tel. +33 (0)4 50 65 30 00
S.A. au capital de 322 639 919 € · RCS ANNECY B 325 821 072 · Id. Fiscale : FR 48 325 821 072
SIRET 325 821 072 00015 · Code APE 2815 Z · Code NACE 28.15

PRODUCT DEFINITION

H - Distance mounting base to centerline spheric. seating diam.	22,2 mm
H1 - Housing foot height	2,4 mm
H2 - Housing height	43,2 mm
J - Mounting holes distance	68 mm
L - Housing length	85,7 mm
N - Mounting hole dimension	9 mm
S - Distance front side/bearing centre	6,5 mm

PRODUCT PERFORMANCE

C - Dynamic load rating	9550000 mN
C0 - Static load rating	4780000 mN
Operating temperature min.	253,15 °K
Operating temperature max.	373,15 °K

OTHER FEATURES

Mass	0,19 kg
Recommended tightening torque for set screw	5.5 N-m

