



FAG

SES215-L

Plummer block housing

Split plummer block housing for various bearing designs. The SNV series will be replaced by the new SES series in 2022.

Technical information

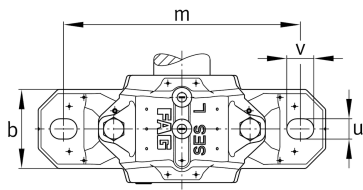

Main Dimensions & Performance Data

D	130 mm	Outside diameter bearing
a	280 mm	Length base
h ₁	156 mm	Height
g	115 mm	Width housing body
K	56 mm	Width bearing seat
≈m	6.6 kg	Weight

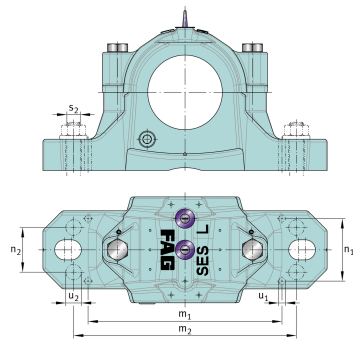
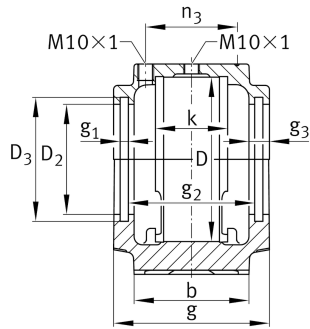
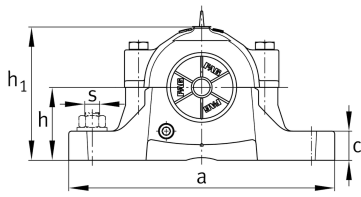

Dimensions

b	80 mm	Width base
c	30 mm	Height base
h	80 mm	Base to shaft centerline height
m	230 mm	Distance fixing bore
s	15.875 mm	Screw size
s	M16	Size of fixing screws
u	18 mm	Width slot
v	24 mm	Length slot
D 2	102.5 mm	Diameter sealing
D 3	111 mm	Diameter sealing groove
D 5	108.7 mm	Outside diameter sealing labyrinth
g 1	5 mm	Width sealing groove
g 2	97 mm	Distance sealing
g 3	13 mm	Wall thickness
g 4	28 mm	Distance oil lubrication
m 1	194 mm	Distance holes aligned pins m1
n 3	71 mm	Distance lubrication
n 4	101 mm	Distance lubrication sealing
u 1	8 mm	Bore diameter u1
u 2	14 mm	Bore diameter u2