

Empty Cupboard and Janitorial Shelf pack

Datasheet and Assembly Instructions

The empty cupboard RS 349-9762 is 1830x457x915mm.

RS 349-9784 is for a kit to make the internal layout of the empty cupboard look like the 2D image below.

The kit consists of:

- 1 x central divider $\frac{3}{4}$ height
- 1 x full width shelf to go above divider
- 1 x full height divider to slot into the full width shelf
- 2 x half width shelves
- 1 x half width rail with 2 x coat hooks
- 12 x shelf clips
- Fixings including 4 x steel rivets and 6 nuts and bolts
- 1 x Instructions for assembly

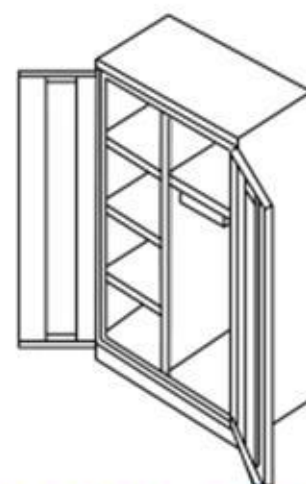
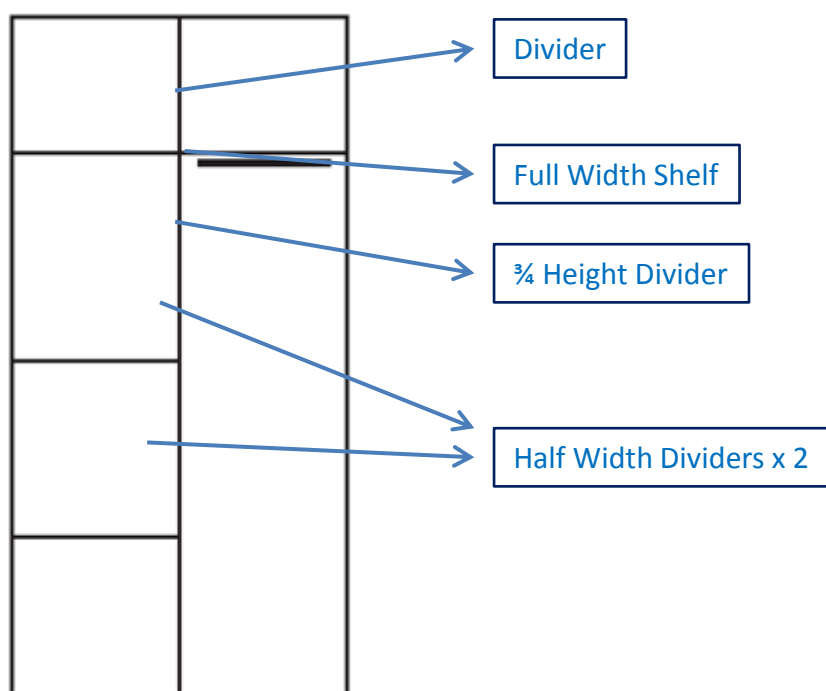

349-9762 + 349-9784

Advice regarding assembly:

- Fit the full width top shelf first (this sits on 4 shelf clips)
- Fit the full height divider at the top (use 2 bolts to secure to the top of the cupboard, the bottom of the divider slots into the shelf)
- Fit the $\frac{3}{4}$ height divider (use 2 bolts to secure to the bottom and 2 for the top)
- Fit the 2 half width shelves (these both sit on 4 shelf clips)
- The 4 rivets are to attach the hanging rail to the shelf