

Nutenstein, einschwenkbar
Nutensteinprofil, einschwenkbar
Feder

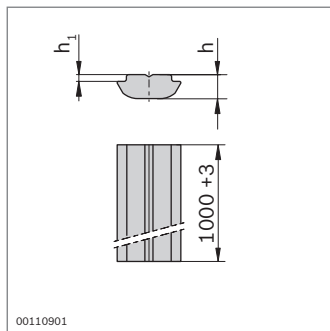

- ▶ Nutensteinprofil, einschwenkbar, zum Selbstbau individueller Befestigungselemente
- ▶ Nutenstein, einschwenkbar, zum direkten Einsetzen an der Montagestelle; besonders montagefreundlich
- ▶ Nutenstein, einschwenkbar, mit Feder, zum direkten Einsetzen an der Montagestelle und Lagefixierung durch angeheftete Feder
- ▶ Nutenstein, einschwenkbar, mit Gewindestift zur rüttelfesten Fixierung in allen Lagen
- ▶ Profilbearbeitung: Nicht erforderlich

Technische Daten (S. 19-5)



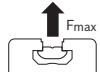

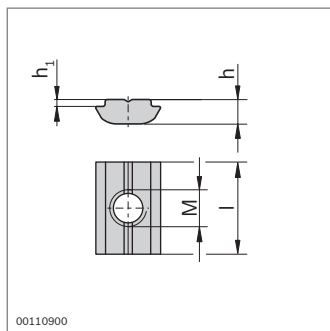

Nut	
8 (M8)	2 200 N
10 (M8)	8 000 ... 18 000 N ¹⁾

¹⁾ Abhängig vom Profil (S. 19-5)



Nutensteinprofil, einschwenkbar	Nut	h (mm)	h ₁ (mm)	l (mm)	Nr.
Stahl; verzinkt	8	4,8	1,0	1000	3 842 529 327
	10	5,3	1,5	1000	3 842 529 325

Nutenstein, einschwenkbar	Nut	M	h (mm)	h ₁ (mm)	l (mm)	ESD		Nr.
Stahl; verzinkt	8	M5	4,8	1,0	16		100	3 842 529 319
		M6	4,8	1,0	16		100	3 842 529 320
		M8	4,8	1,0	16		100	3 842 529 321
	10	M6	5,3	1,5	20		100	3 842 529 323
		M8	5,3	1,5	20		100	3 842 529 324
Stahl; nichtrostend	6	M3	3,0	0,9	12		100	3 842 547 826
		M4	3,0	0,9	12		100	3 842 536 669
		M5	3,0	0,9	12		100	3 842 547 825
	8	M6	4,8	1,0	16		100	3 842 530 321
		M8	5,3	1,5	20		100	3 842 530 316

Zubehör: Feder (S. 3-9)

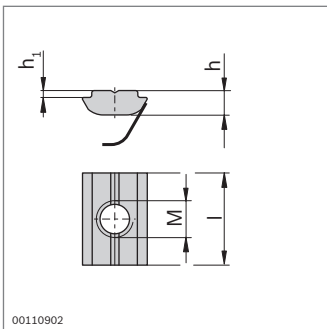
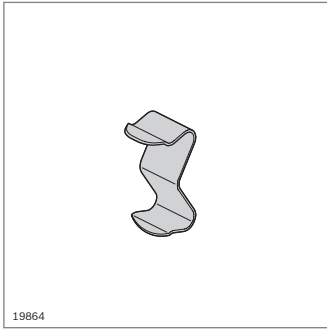

00110902

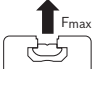
Nut	
8 (M8)	2 200 N
10 (M8)	8 000 ... 18 000 N ¹⁾

¹⁾ Abhängig vom Profil (S. 19-5)

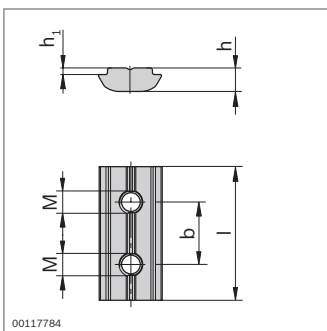

















00117784

► Feder als Montage- und Positionierhilfe für Nutenstein und einschwenkbaren Nutenstein

Feder	Nut		Nr.
Federstahl; nichtrostend	6	100	3 842 523 145
	8	100	3 842 516 685
	10	100	3 842 516 669

3

Nutstein, einschwenkbar, mit Feder	Nut	M	h (mm)	h ₁ (mm)	l (mm)	ESD 	Nr.
Stahl; verzinkt	8	M4	4,8	1,0	16		100 3 842 529 294
		M5	4,8	1,0	16		100 3 842 529 295
		M6	4,8	1,0	16		100 3 842 529 296
		M8	4,8	1,0	16		100 3 842 529 297
	10	M4	5,3	1,5	20		100 3 842 541 393
		M5	5,3	1,5	20		100 3 842 529 298
		M6	5,3	1,5	20		100 3 842 529 299
		M8	5,3	1,5	20		100 3 842 529 300
Stahl; nichtrostend	8	M4	4,8	1,0	16		100 3 842 547 824
		M5	4,8	1,0	16		100 3 842 547 823
		M6	4,8	1,0	16		100 3 842 547 822
		M8	4,8	1,0	16		100 3 842 547 821
	10	M5	5,3	1,5	20		100 3 842 547 808
		M6	5,3	1,5	20		100 3 842 547 807
		M8	5,3	1,5	20		100 3 842 547 806

Material: Feder: Federstahl; nichtrostend

Nutstein, einschwenkbar, mit Gewindestift	Nut	M	b (mm)	h (mm)	h ₁ (mm)	l (mm)	ESD 	Nr.
Stahl; verzinkt	8	M5	12	4,8	1,0	24	100	3 842 536 675
	10	M5	14	5,3	1,5	30	100	3 842 536 676
Stahl; nichtrostend	6	M4	8	3,0	0,9	15	100	3 842 536 673