

Accessories for push-through installation

Simple push-through installation in masonry



Car ports



Detail: Wood constructions in push-through installation

3

Applications

- Timber constructions
- Awnings
- Canopies
- Car ports
- Gates

Advantages

- The direct installation through the fixture reduces preliminary work wherever there are several fixing points for each fixture, and guarantees a significantly simpler installation process.
- The design of the push-through anchor sleeve FIS H K allows for a range of usable lengths with just one product, thus providing maximum flexibility and

cost-effectiveness.

- The movable edge, in combination with the scale, makes it easier to adapt the anchor sleeve to suit the desired usable length.
- The grating structure of the push-through anchor sleeve is adapted for the injection mortars FIS V Plus, FIS V, FIS GREEN and FIS P Plus, and ensures sparing mortar use with the best interlock.

Certificates



ETA-10/0383, for masonry

ETA-11/0419, for masonry

ETA-14/0471, for masonry

ETA-20/0729, for masonry

Building materials

Approved for:

- Vertically perforated brick
- Hollow blocks made from lightweight concrete
- Hollow blocks made from concrete
- Perforated sand-lime brick
- Solid sand-lime brick
- Solid brick

Also suitable for:

- Hollow pumice slabs
- Slabs made of hollow brick and other perforated brick
- Solid pumice and other solid building materials

Versions

- Zinc-plated steel
- Stainless steel

Functioning

- The system can be used with any of the following injection mortars: FIS V Plus, FIS V, FIS GREEN and FIS P Plus can be used but does not have approvals.
- The injection system is suitable for push-through installation when combined with the push-through anchor sleeve FIS H K.
- The push-through anchor sleeve is adapted to suit the fixture thickness using the scale and the movable edge, and cut as required.
- The anchor sleeve is placed in the drill hole, and filled with injection mortar from the anchor sleeve base. It should be ensured that the anchor sleeve is completely filled, including in the fixture region.
- Turning in the anchor causes the mortar to be pushed through the anchor sleeve's grating structure, so that it fits the base material perfectly. The load is borne by the interlock.

Installation with FIS V and FIS HK

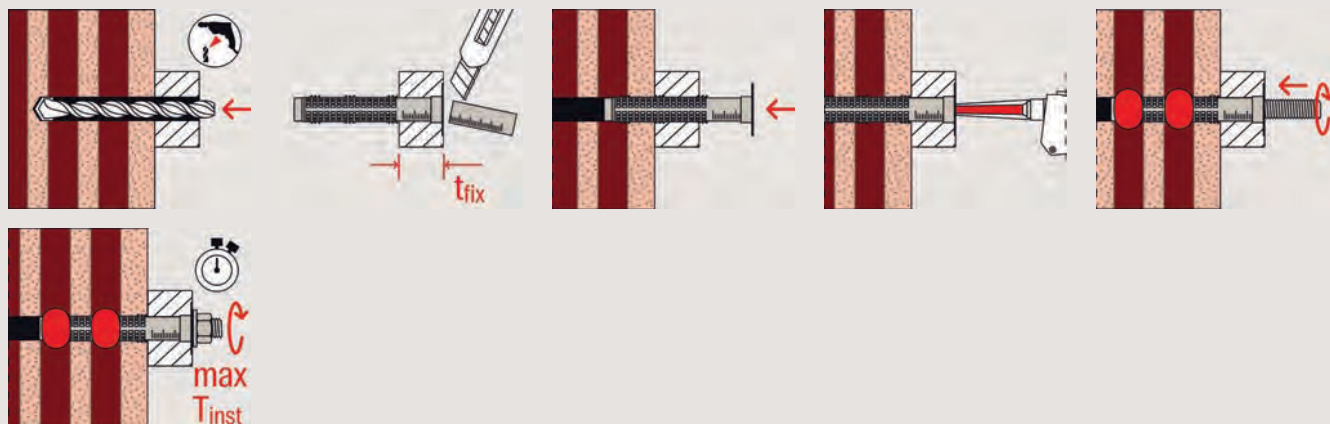

3

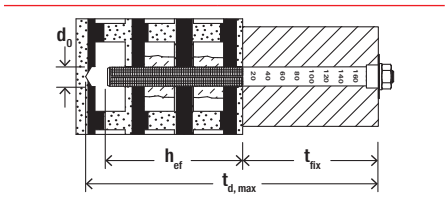

Technical data

Injections anchor sleeve FIS HK



FIS HK

Item	Item No. gvz	Approval ETA	Drill hole diameter d_0 [mm]	Max. drill hole depth [mm]	Effect. anchorage depth h_{ef} [mm]	Max. fixture thickness t_{fix} [mm]	Match	Fill quantity [scale units]	Sales unit [pcs]
FIS H 18 x 130/200 K	045707	●	18	340	130	200	M10 - M12	35	10
FIS H 22 x 130/200 K	045708	●	22	340	130	200	M 16	45	10

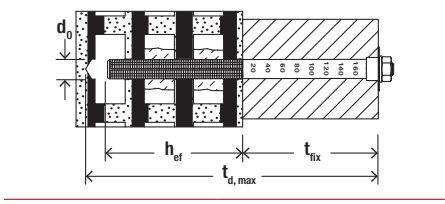

Technical data

FIS Set



FIS Set

Item	Zinc-plated steel Item No. gvz	Stainless steel Item No. R	Approval ETA	Drill hole diameter d_0 [mm]	Max. drill hole depth [mm]	Effect. anchorage depth h_{ef} [mm]	Max. fixture thickness t_{fix} [mm]	Fill quantity [scale units]	Sales unit [pcs]
FIS Set 18 x 130/200 M12/200	047443	047452	●	18	340	130	200	35	5

Injection anchor sleeves

FIS H K



Advantages

- The grating structure of the FIS H K anchor sleeve is adapted for the injection mortars FIS V Plus, FIS V, FIS VL, FIS GREEN, FIS P Plus and FIS P, and ensures sparing mortar use with the best interlock.
- The centring blades perfectly align the anchor in the anchor sleeve, and allow for use with various threaded rod diameters.
- The barbed hooks secure the anchor sleeve in the drill hole and allow for a trouble-free overhead installation.
- The geometry of the anchor sleeves allows for the bridging of non-bearing layers for a simple and convenient installation.

Functioning

- The system can be used with any of the following injection mortars: FIS V Plus, FIS VW Plus High Speed, FIS VS Plus Low Speed, [... FIS V], FIS VL, FIS GREEN or FIS P Plus. FIS P can be used but does not have approvals.
- The system is suitable for pre-positioned installation when combined with injection anchor sleeves and threaded rods FIS A or internal threaded anchors FIS E.
- The anchor sleeve is placed in the drill hole, and filled with injection mortar from the anchor sleeve base.
- Turning in the anchor causes the mortar to be pushed through the anchor sleeve's grating structure, so that it fits the base material perfectly. The load is borne by the interlock.

FIS H L



Advantages

- The metal anchor sleeve can be cut to the required length and thus allows for a range of usable lengths with just one produce, providing flexibility and cost-effectiveness.
- The grating structure of the anchor sleeve allows for uniform distribution of mortar in the drill hole and thus for secure hold.

Functioning

- The anchor sleeve is at first cut to the required length.
- The anchor sleeve is placed in the drill hole, and filled with injection mortar from the anchor sleeve base.
- Turning in the anchor causes the mortar to be pushed through the anchor sleeve's grating structure, so that it fits the base material perfectly.
- The load is borne by the interlock.

FIS H N



Advantage

- The net structure of the anchor sleeve allows for uniform distribution of mortar in the drill hole and thus for secure hold.

Functioning

- The anchor sleeve is placed in the drill hole, and filled with injection mortar from the anchor sleeve base.
- Turning in the anchor causes the mortar to be pushed through the anchor sleeve's grating structure, so that it fits the base material perfectly.
- The load is borne by the interlock.

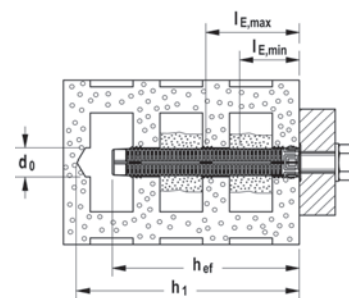

Technical data

3

Injection anchor sleeves FIS H K



FIS H K

Item	Item No.	Approval ETA	Drill hole diameter d_0 [mm]	Drill hole depth acc. ETA [mm]	Effect. anchorage depth h_{ef} [mm]	Match	Fill quantity per sleeve [scale units]	Sales unit [pcs]
FIS H 12 x 50 K	041900	●	12	55	50	FIS A M6-M8	5	50
FIS H 12 x 85 K	041901	●	12	90	85	FIS A M6-M8	10	50
FIS H 16 x 85 K	041902	●	16	90	85	FIS A M8-M10, FIS E M6-M8	12	50
FIS H 16 x 130 K	041903	●	16	135	110	FIS A M8-M10	15	20
FIS H 20 x 85 K	041904	●	20	90	85	FIS A M12-M16, FIS E M10-M12	15	20
FIS H 20 x 130 K	046703	●	20	135	110	FIS A M12-M16	25	20
FIS H 20 x 200 K	046704	●	20	205	180	FIS A M12-M16	40	20

Technical data

Injection anchor sleeves FIS H L



FIS H L

Item	Item No.	Drill hole diameter d_0 [mm]	Total length l [mm]	Match	Fill quantity per 10 cm	Sales unit [pcs]
FIS H 12 x 1000 L	050598	12	1000	Ø6/M6 - Ø8/M8	12	10
FIS H 16 x 1000 L	050599	16	1000	Ø8/M8 - Ø10/M10	14	10
FIS H 22 x 1000 L	045301	22	1000	Ø12/M12 - Ø16/M16	20	6
FIS H 30 x 1000 L	000645	30	1000	Ø16/M16 - Ø22/M22	26	4

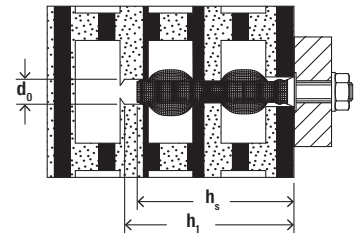

Technical data

Injection anchor sleeve with net FIS H N



FIS H N

Item	Item No.	Drill hole diameter d_0 [mm]	Min. drill hole depth h_1 [mm]	Min. anchorage depth anchor h_v [mm]	Fill quantity per sleeve [scale units]	Match	Sales unit [pcs]
FIS H 16 x 85 N	050470	16	95	85	15	Ø8/M8	20
FIS H 18 x 85 N	050472	18	95	85	17	Ø10/M10	20
FIS H 20 x 85 N	050474	20	95	90	18	Ø12/M12	20