

Spring-Clamp Connection Terminal Blocks

Internal Component Blocks (Diode, Resistor, Surge Suppressor)

	1492-LD4DF*	1492-LD4DR*	1492-LD4RB...*				
Dimensions are not intended to be used for manufacturing purposes. Note: Height dimension is measured from top of rail to top of terminal block.							
Specifications	Two-level terminal block with an IN4007 diode in forward bias between the 2 levels.		Two-level terminal block with an IN4007 diode in reverse bias between the 2 levels.		Two-level terminal block with a selectable metal oxide film resistor value between the 2 levels.		
Certifications	UL	CSA	IEC	UL	CSA	IEC	
Voltage Rating	600V AC/DC		800V AC/DC		600V AC/DC		
Maximum Current	25 A		32 A		25 A		
Component Current/Wattage Rating*	1 A		1 A		0.25 W		
Wire Range (Rated Cross Section)	26...10 AWG		4mm ²		26...10 AWG		
Wire Strip Length	0.39 in (10 mm)		0.39 in (10 mm)		0.39 in (10 mm)		
Density (Blocks per foot/meter)	49 per ft/163 per meter		49 per ft/163 per meter		49 per ft/163 per meter		
Housing Temperature Range	-58...+248 °F (-50...+120 °C)		-58...+248 °F (-50...+120 °C)		-58...+248 °F (-50...+120 °C)		
Terminal Blocks	Cat. No.	Pcs/ Pkg	Cat. No.	Pcs/ Pkg	Cat. No.	Pcs/ Pkg	
Color	Black	1492-LD4DF	1	1492-LD4DR	1	1492-LD4RB†	
Accessories	Cat. No.	Pcs/ Pkg	Cat. No.	Pcs/ Pkg	Cat. No.	Pcs/ Pkg	
Mounting Rails	199-DR1		199-DR1		199-DR1		
1 m Symmetrical DIN (Steel)	10		10		10		
1 m Symmetrical DIN (Aluminum)	1492-DR5		1492-DR5		1492-DR5		
1 m Hi-Rise Symmetrical DIN (Aluminum)	1492-DR6		1492-DR6		1492-DR6		
1 m Angled Hi-Rise Sym. DIN (Steel)	1492-DR7		1492-DR7		1492-DR7		
End Barrier	Gray	1492-EBLD4		1492-EBLD4		1492-EBLD4	
End Anchors and Retainers	1492-ERL35		1492-ERL35		1492-ERL35		
Screwless End Retainer	20		20		20		
DIN Rail — Normal Duty	1492-EAJ35		1492-EAJ35		1492-EAJ35		
DIN Rail — Heavy Duty	1492-EAHJ35		1492-EAHJ35		1492-EAHJ35		
Jumpers	1492-CJK6-10		1492-CJK6-10		1492-CJK6-10		
Plug-in Center Jumper — 10 pole	20		20		20		
Plug-in Center Jumper — 9 pole	1492-CJK6-9		1492-CJK6-9		1492-CJK6-9		
Plug-in Center Jumper — 8 pole	20		20		20		
Plug-in Center Jumper — 7 pole	1492-CJK6-7		1492-CJK6-7		1492-CJK6-7		
Plug-in Center Jumper — 6 pole	20		20		20		
Plug-in Center Jumper — 5 pole	1492-CJK6-5		1492-CJK6-5		1492-CJK6-5		
Plug-in Center Jumper — 4 pole	20		20		20		
Plug-in Center Jumper — 3 pole	1492-CJK6-4		1492-CJK6-4		1492-CJK6-4		
Plug-in Center Jumper — 2 pole	60		60		60		
Other Accessories	1492-TP23		1492-TP23		1492-TP23		
Test Plug	20		20		20		
Group Marking Carrier	1492-GM35		1492-GM35		1492-GM35		
Marking Systems	1492-M6X10 (120/card)		1492-M6X10 (120/card)		1492-M6X10 (120/card)		
Snap-In Marker Cards	5		5		5		
Snap-In Marker Cards	1492-M6X5 (200/card)		1492-M6X5 (200/card)		1492-M6X5 (200/card)		
	5		5		5		

* For component specifications, see page 12-155

† Cat. no. is incomplete. To complete the cat. no, see page 12-157 for resistor value (10...4750 Ω).

IEC Terminal Block Specifications *

Tie Point Terminal Blocks — Type JD3C, LD2C, LD3C, LD4C, and KD2C

ATTENTION

The total current flow through these terminal blocks (the sum of all inputs or the sum of all outputs) must not exceed the rated current for the device.

Description	Type	Rating
Maximum total current flow through the terminal block	LD2C, KD2C	10 A
	JD3C, LD3C	20 A
	LD4C	25 A
Maximum working voltage	LD2C, KD2C	300V
	JD3C, LD3C, LD4C	600V
Ambient temperature range	Operating	-4...+104°F (-20...+40°C)
	Storage	-40...+167°F (-40...+75°C)

Diode Terminal Blocks — Type JD3DR, JD3DF, LD4DF, LD4DR, KD2DF, and KD2DR

Description	Symbol	Type	Rating
Peak Repetitive Reverse Voltage	V (RRM)	KD2DF, KD2DR	300V
Working Peak Reverse Voltage	V (RWM)	JD3DF, JD3DR, LD4DF, LD4DR	600V
DC Blocking Voltage	V (R)		
Non-Repetitive Peak Reverse Voltage (Halfwave, single phase, 60 Hz)	V (RSM)	KD2DF, KD2DR	300V
		JD3DF, JD3DR, LD4DF, LD4DR	600V
RMS Reverse Voltage †	V (Rrms)	KD2DF, KD2DR	300V
		JD3DF, JD3DR, LD4DF, LD4DR	600V
Average Rectified Forward Current Single Phase, Resistive Load, 60 Hz	I (O)	All	1.0 A
Non-Repetitive Peak Surge Current (Surge applied at rated load)	I (FSM)	All	30 A (1 cycle)
Maximum Forward Voltage Drop [I (F) = 1.0 A]	V (F)	All	1.1V
Maximum Reverse Current	I (R)	All	10 μA
Ambient temperature range	Operating	All	-4...+104°F (-20...+40°C)
	Storage	All	-40...+167°F (-40...+75°C)

All parameters measured at 77 °F (25 °C).

Resistor Terminal Blocks — Types HM2RC, JD3RB, JD3RC, and LD4RB

Description	Model Code Identifier	Rating
Resistor Type	B	Metal Film Resistor §
	C	Wire Wound Precision Resistor
Standard Resistance Range	B	10Ω...4.75 MΩ
	C	249 Ω
Resistance Tolerance	B	± 1%
	C	± 1%
Power Rating (Resistor)	B	0.25 W
Maximum Continuous Watts at 86°F (30°C) Ambient	C	0.5 W
Rated Continuous Working Voltage (Resistor)	B	$\sqrt{(0.25 \times R)}$ or 250V Max.
	C	$\sqrt{(0.5 \times R)}$ or 250V Max.
Ambient temperature range	Operating	-4...+104°F (-20...+40°C)
	Storage	-40...+167°F (-40...+75°C)
Dielectric Withstanding Voltage (Resistor)	B & C	500V

* Performance Data — Performance data given in this catalog is provided as a guide for the user in determining suitability and does not constitute a warranty. It may represent the result of accelerated testing at elevated stress levels and the user should correlate it to actual application requirements. Actual performance is subject to Allen-Bradley WARRANTY and LIMIT OF LIABILITY.

† The maximum voltage rating of the diode terminal blocks listed in the above table should not be exceeded even though the maximum reverse voltage rating of the diode alone is 1000V.

§ For further information on resistor performance, consult your local Allen-Bradley distributor.

Resistor Codes for 1492-JD3RB... and -LD4RB...Terminal Blocks

Ordering Information

In order to complete the cat. no. for 1492-JD3RB... or 1492-LD4RB..., add the desired resistor code from the table below.

Example: Cat. No. 1492-JD3RB101 is a resistor terminal block with a 100 Ω -1/4 W resistor.

Resistor Value Ω	Resistor Code	Resistor Value Ω	Resistor Code	Resistor Value Ω	Resistor Code	Resistor Value Ω	Resistor Code
10	100	267	271	8250	822	0.221M	224
11	110	301	301	9090	912	0.243M	244
12.1	120	332	331	10000	103	0.267M	274
13	130	357	361	11000	113	0.301M	304
15	150	392	391	12100	123	0.332M	334
16	160	432	431	13000	133	0.357M	364
18.2	180	475	471	15000	153	0.392M	394
20	200	511	511	16200	163	0.432M	434
22.1	220	562	561	18200	183	0.475M	474
24.3	240	619	621	20000	203	0.511M	514
26.7	270	681	681	22100	223	0.562M	564
30.1	300	750	751	24300	243	0.619M	624
33.2	330	825	821	26700	273	0.681M	684
35.7	360	909	910	30100	303	0.75M	754
39.2	390	1000	102	33200	333	0.825M	824
43.2	430	1100	112	35700	363	0.909M	914
47.5	470	1210	122	39200	393	1.0M	105
51.1	510	1300	132	43200	433	1.1M	115
56.2	560	1500	152	47500	473	1.24M	125
61.9	620	1620	162	51100	513	1.3M	135
68.1	680	1820	182	56200	563	1.5M	155
75	750	2000	202	61900	623	1.62M	165
82.5	820	2210	222	68100	683	1.82M	185
90.9	910	2430	242	75000	753	2.0M	205
100	101	2670	272	82500	823	2.21M	225
110	111	2940	302	90900	913	2.43M	245
121	121	3320	332	0.10M	104	2.67M	275
130	131	3570	362	0.11M	114	3.01M	305
150	151	3920	392	0.121M	124	3.32M	335
162	161	4750	472	0.13M	134	3.57M	365
182	181	5110	512	0.15M	154	3.92M	395
200	201	5620	562	0.162M	164	4.32M	435
221	221	6810	682	0.182M	184	4.75M	475
243	241	7500	752	0.20M	204	249	001

Spring-Clamp Operating Instructions

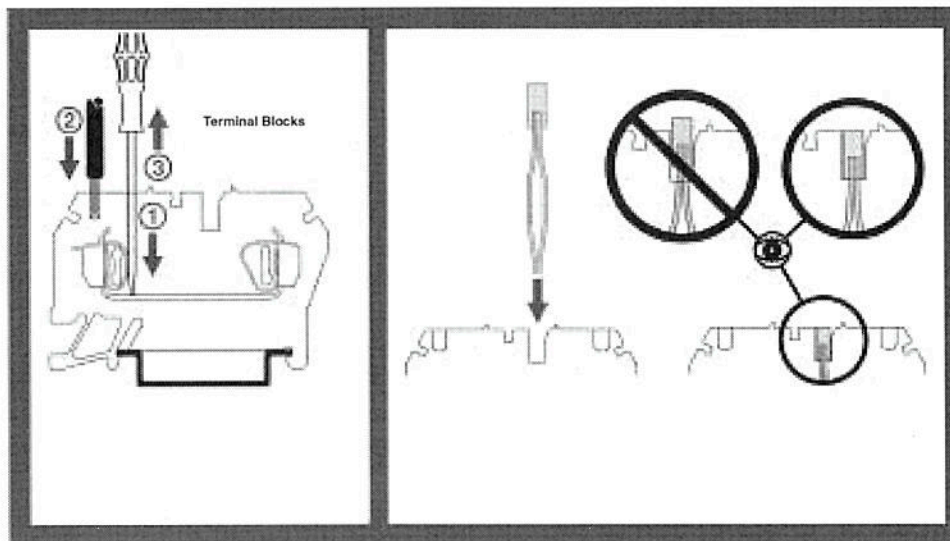

Cat. No. 1492-QCLABEL
(Adhesive Label — Actual Size)