



Operation of the **CF CRIMPHANDY** portable crimping tool

Original operating instructions

UM EN CF CRIMPHANDY
Order No. 2910936

Original operating instructions

Operation of the CF CRIMPHANDY portable crimping tool

2016-09-06

Designation: UM EN CF CRIMPHANDY

Revision: 07

Order No.: 2910936

This user manual is valid for:

Designation	Order No.
CF CRIMPHANDY 0,5	1212463
CF CRIMPHANDY 0,75	1212464
CF CRIMPHANDY 1,0	1212465
CF CRIMPHANDY 1,5	1212466

Please observe the following notes

User group of this manual

The use of products described in this manual is oriented exclusively to qualified electricians or persons instructed by them, who are familiar with applicable standards and other regulations regarding electrical engineering and, in particular, the relevant safety concepts.

Explanation of symbols used and signal words



This is the safety alert symbol. It is used to alert you to potential personal injury hazards. Obey all safety measures that follow this symbol to avoid possible injury or death.

There are three different categories of personal injury that are indicated with a signal word.

DANGER This indicates a hazardous situation which, if not avoided, will result in death or serious injury.

WARNING This indicates a hazardous situation which, if not avoided, could result in death or serious injury.

CAUTION This indicates a hazardous situation which, if not avoided, could result in minor or moderate injury.



This symbol together with the signal word **NOTE** and the accompanying text alert the reader to a situation which may cause damage or malfunction to the device, hardware/software, or surrounding property.



This symbol and the accompanying text provide the reader with additional information or refer to detailed sources of information.

How to contact us

Internet

Up-to-date information on Phoenix Contact products and our Terms and Conditions can be found on the Internet at:

phoenixcontact.com

Make sure you always use the latest documentation.

It can be downloaded at:

phoenixcontact.net/products

Subsidiaries

If there are any problems that cannot be solved using the documentation, please contact your Phoenix Contact subsidiary.

Subsidiary contact information is available at phoenixcontact.com.

Published by

PHOENIX CONTACT GmbH & Co. KG
Flachsmarktstraße 8
32825 Blomberg
GERMANY

Should you have any suggestions or recommendations for improvement of the contents and layout of our manuals, please send your comments to:

tecdoc@phoenixcontact.com

General terms and conditions of use for technical documentation

Phoenix Contact reserves the right to alter, correct, and/or improve the technical documentation and the products described in the technical documentation at its own discretion and without giving prior notice, insofar as this is reasonable for the user. The same applies to any technical changes that serve the purpose of technical progress.

The receipt of technical documentation (in particular user documentation) does not constitute any further duty on the part of Phoenix Contact to furnish information on modifications to products and/or technical documentation. You are responsible to verify the suitability and intended use of the products in your specific application, in particular with regard to observing the applicable standards and regulations. All information made available in the technical data is supplied without any accompanying guarantee, whether expressly mentioned, implied or tacitly assumed.

In general, the provisions of the current standard Terms and Conditions of Phoenix Contact apply exclusively, in particular as concerns any warranty liability.

This manual, including all illustrations contained herein, is copyright protected. Any changes to the contents or the publication of extracts of this document is prohibited.

Phoenix Contact reserves the right to register its own intellectual property rights for the product identifications of Phoenix Contact products that are used here. Registration of such intellectual property rights by third parties is prohibited.

Other product identifications may be afforded legal protection, even where they may not be indicated as such.

Table of contents

1	Basic information	7
1.2	Correct use of the battery and charger	9
1.3	Scope of supply	10
1.4	Operating elements	10
2	Operating the crimping tool	11
2.1	Charging the battery	11
2.2	Switching on the crimping tool	12
2.3	Inserting the taped ferrule	13
2.4	Crimping	14
2.5	Loading the taped ferrule	15
2.6	Removing the battery	15
3	Troubleshooting	16
3.1	Overview of possible faults	17
3.2	Meaning of the indicator lights	18
3.3	Troubleshooting sequences	19
3.4	Removing the conductor	20
3.5	Removing the ferrule	21
3.6	Relieving blockage at ferrule transport	22
3.7	Removing loose parts	24
3.8	Initializing the crimping tool (Reset)	26
3.9	Replacing waste guide plates	27
3.9.1	Replacing waste guide plate GP1	27
3.9.2	Replacing waste guide plate GP2	29
3.10	Returning a product	32
A	Appendix	33
A 1	Ordering data	33
A 2	Technical data	35

1 Basic information

The portable crimping tool strips conductors in one step and crimps on a ferrule. It crimps ferrules in square form.



NOTE: To ensure error-free use and the process reliability of the portable crimping tool, only use the conductors and ferrules described.

Using unsuitable materials may damage the crimping tool and lead to inferior work results. We recommend that you check the quality of the crimp connections every 5000 cycles or at the latest after a year.

The crimping tool is equipped with an inductive sensor which checks the actual conductor cross section. If the cross section exceeds or falls below the defined limits, the crimping tool does not trigger. The LEDs signal when a cross section is detected as being unsuitable.

In exceptional cases, conductors can be processed although they are not suitable. This leads of crimp results that do not conform with the standards.

1.1 Suitable conductors and ferrules

Suitable conductors

The mobile crimping tool is designed to process fine strand class 5 conductors according to IEC 60228 with PVC insulation. Only use type H05V-K and H07V-K conductors. Conductors with very hard insulation such as rubber, silicone, Teflon, and textile insulation are not suitable.

Avoid processing conductors that are very cold (e.g., directly from an unheated warehouse). The colder the materials to be processed are, the harder and more resistant they become. This can lead to increased wear or to mechanical damage.

Please note that the crimping tool can only process a specific conductor cross section. A significantly deviating conductor cross section is detected and not processed. It may be possible to process similar conductor cross sections, but this could endanger the electrical connection. Make sure that conductor cross section and ferrules fit together.

Device type	Conductor cross section, metric	Outside diameter	Conductor type
CF CRIMPHANDY 0,5	0.5 mm ²	1.7 mm ... 2.4 mm	H05V-K
CF CRIMPHANDY 0,75	0.75 mm ²	1.9 mm ... 2.6 mm	H05V-K
CF CRIMPHANDY 1,0	1.0 mm ²	2.0 mm ... 2.7 mm	H05V-K
CF CRIMPHANDY 1,5	1.5 mm ²	2.4 mm ... 3.1 mm	H07V-K

Wire check

For checking the outside conductor diameter, the mobile crimping tool has two openings that are labeled "wire check". The conductor has to fit in the opening that is labeled with the checkmark. If the conductor fits in the small opening with the cross, then it may not be used. Conductors that are too thick or too thin cause the crimping tool to be damaged.

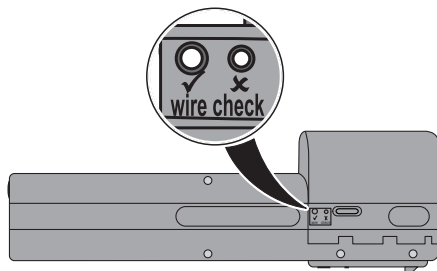



Figure 1-1 Checking the outside diameter of the conductor

Suitable ferrules

Only use taped ferrules from Phoenix Contact that have a specific function end. This special design is required for safe operation.

Device type	Taped ferrules from Phoenix Contact				
CF CRIMPHANDY 0,5	Al 0,5-8 WH-S,	1212521	Al 0,5-8 OG-S,	1212784	
CF CRIMPHANDY 0,75	Al 0,75-8 GY-S,	1212522	Al 0,75-8 BU-S,	1212785	
			Al 0,75-8 WH-S,	1212783	
CF CRIMPHANDY 1,0	Al 1,0-8 RD-S,	1212523	Al 1,0-8 YE-S,	1212782	
CF CRIMPHANDY 1,5	Al 1,5-8 BK-S,	1212524	Al 1,5-8 RD-S,	1212781	

Preparing the conductor

In order to ensure optimum operation of the portable crimping tool, the conductor must be prepared correctly. Make sure that the conductors are always cut straight. Conductors that have been squeezed, cut at an angle or already stripped must not be used. Even for very short conductors it may happen that they are not crimped correctly.

Only use cable cutters with sharp blades which cut the conductors and do not squeeze them. Do not use diagonal cutters or similar unsuitable tools.

Quality of the crimping result

The quality of the crimping result depends on:

- The stranding of the conductor
- The processing temperature
- The tolerance at the cross section



NOTE: The user has to make sure that only suitable materials are used.

1.2 Correct use of the battery and charger

The portable crimping tool works with a lithium-ion battery which is sufficient for up to 2000 crimping operations. The wide range power supply unit can be used worldwide with a mains plug adapter.



WARNING: Important safety notes for lithium-ion batteries

Risk of short circuit, fire, explosion, electric shock or damage to health

- Keep the battery away from metal objects. Paper clips, coins, keys, nails, and other metal objects that touch the contacts may cause a short circuit.
- Do not submerge the battery in liquids.
- Do not heat or burn the battery.
- Never touch the contact surfaces of the charger.
- Do not open the battery housing. Do not break apart the cells.

Note the following when charging the battery

- To ensure a long service life for the lithium-ion battery, store it without charging it.
- Charge the battery at ambient temperatures from 0°C ...+40°C, ideally at 15°C ... 25°C.
- During charging, the indicator light on the charger lights up red. When fully charged, the indicator light lights up green.
- Remove the battery from the charger once it has been fully charged and disconnect the charger from the mains.
- The charging time is 60 minutes, the battery can be used after 20 minutes.

Notes on disposal



Dispose of the used device and battery correctly

The portable crimping tool contains valuable recyclable materials, which should be utilized after the useful life (lifecycle) of the device has ended.

In addition, the crimping tool is equipped with a lithium-ion battery which must be disposed of in accordance with local regulations.

Please support us by contacting your local Phoenix Contact sales office to determine the best way of returning the old device. Phoenix Contact will then handle the necessary recycling and disposal measures.

1.3 Scope of supply

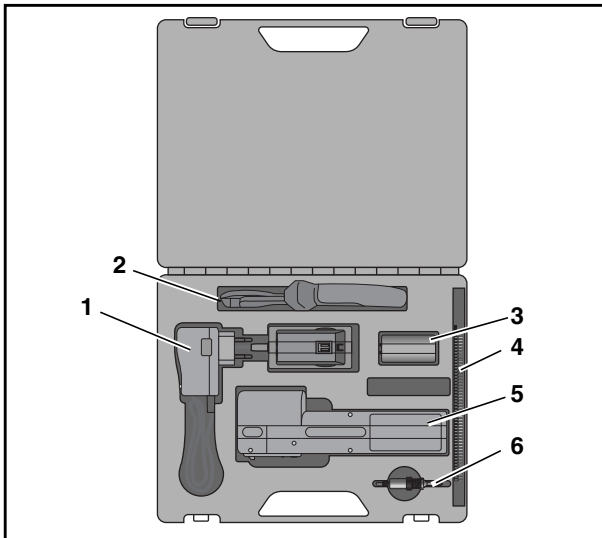

Contents of the case

- 1 Charger
- 2 Cable cutters
- 3 Battery
- 4 Taped ferrules
- 5 Crimping tool
- 6 Service tool

1.4 Operating elements

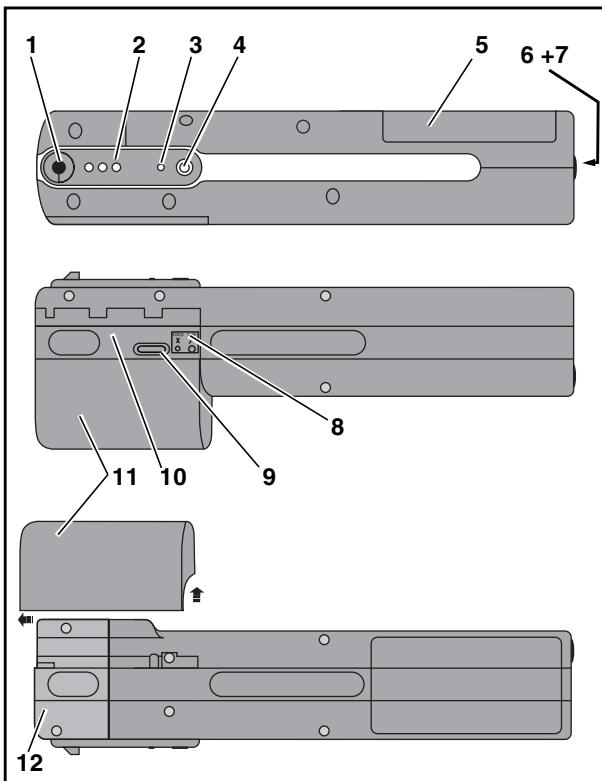

Crimping tool

- 1 Shaft for conductor
- 2 Indicator lights
- 3 Reset button
The reset button may only be used in the course of troubleshooting as described in section 3.
- 4 ON button
- 5 Battery compartment
- 6 Release button for battery compartment
- 7 M5 thread for attaching the crimping tool to a balancer
- 8 Wire check
- 9 Window for ferrule magazine
- 10 Flap for opening the ferrule magazine
- 11 Waste container
- 12 Service cover

2 Operating the crimping tool



NOTE: Only use the crimping tool at ambient temperatures of +15° C ... +30°C.



NOTE: Do not remove the battery during the crimping process.

2.1 Charging the battery

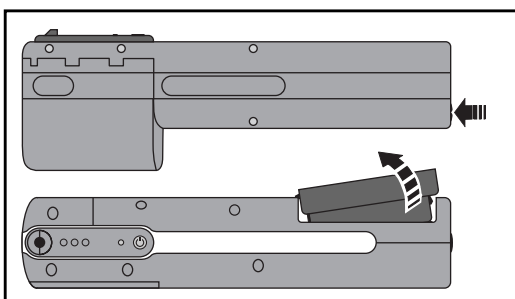

Unlocking the battery compartment

- Press the release button on the bottom of the crimping tool. The battery springs into the removal position.
- Remove the battery from the crimping tool.

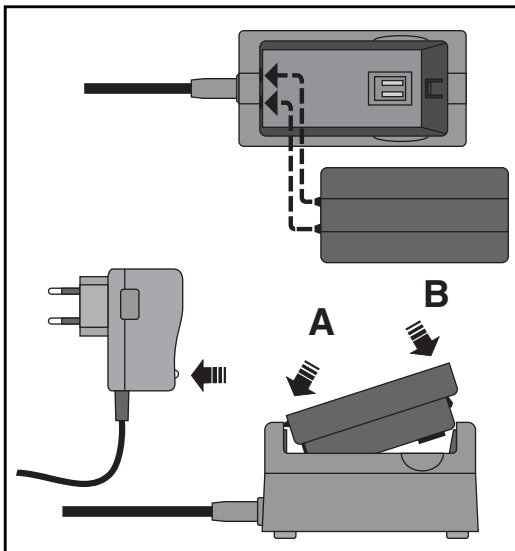

The battery is already charged when delivered.

Charging the battery



NOTE: When doing so, observe the section "Correct use of the battery and charger" on Page 9.

- Place both pins of the battery in the recesses on the cable side of the charger.
- Press down on the battery at the opposite end.
- Plug the mains plug into the socket.

During charging, the indicator light on the mains plug lights up red. It changes to green when the charging process has been completed.

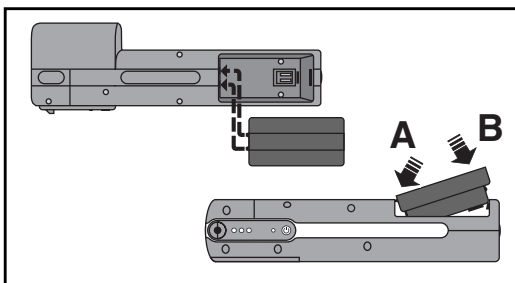

Inserting the battery in the crimping tool

- Insert the battery in the battery compartment of the crimping tool.
- Proceed in the same way as inserting the battery in the charger. The recesses are towards the front of the device. The battery engages with a click.

2.2 Switching on the crimping tool

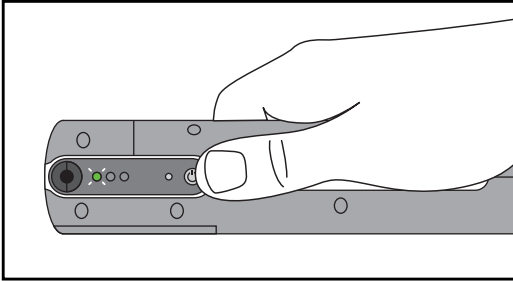

Switching on the crimping tool

- Press the ON button briefly. The green indicator light flashes. The crimping tool is ready for use. The yellow light flashes if no taped ferrule is inserted.
- If the ON button is held down longer when switching on, the three indicator lights indicate the charging state of the battery.
 - Green on = battery full
 - Yellow on = battery half full
 - Red on = battery almost empty

Troubleshooting

- When the green and red indicator lights flash simultaneously, the battery is empty. Follow the instructions for charging the battery (see Page 11).
- If the yellow indicator light flashes, follow the sequence for inserting a taped ferrule (see Page 13).

Switching off the crimping tool

- Press the ON button for approx. three seconds. The three indicator lights briefly show the charging state of the battery. After approximately five minutes of no activity, the crimping tool switches itself off automatically.

2.3 Inserting the taped ferrule

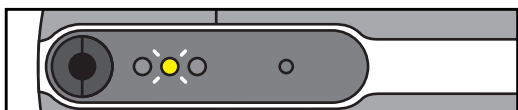

The yellow indicator light flashes.

- If the yellow indicator light is **not** flashing, do not insert a taped ferrule under any circumstances.

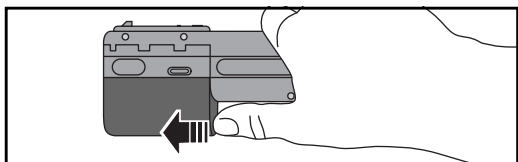

Removing the waste container

- Using your thumb, slide the waste container towards the front of the device and remove it with a downward motion.

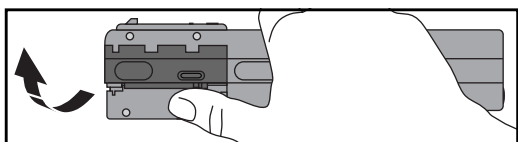

Opening the lid

- Flip the lid upwards to open. There will be slight resistance when doing this.

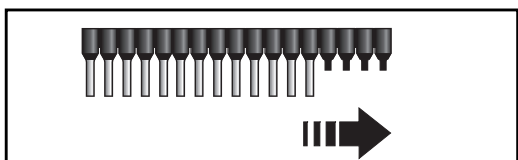

Inserting the taped ferrule



NOTE: Only use suitable taped ferrules (see Page 8). These tapes have a function end that is required for error-free operation. Do not insert damaged or bent tapes.

- Insert the taped ferrule, starting with the function end (four plastic ferrules), as far as it will go to the right into the guide shaft.
- Then push the taped ferrule to the left as far as it will go into the guide shaft until it engages.

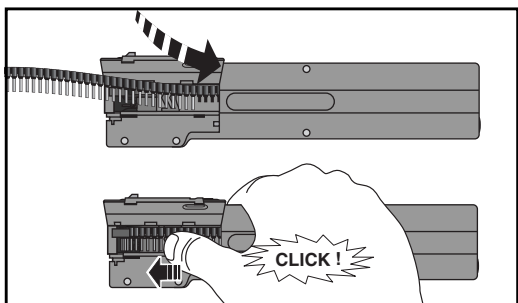

Closing the lid and attaching the waste container

- Close the lid.
- When attaching the waste container, place it so that it is flush with the lid (the waste container will be around five millimeters over the front edge of the crimping tool).
- Push the waste container into the end position parallel to the crimping tool until it snaps in and is flush with the front of the device.

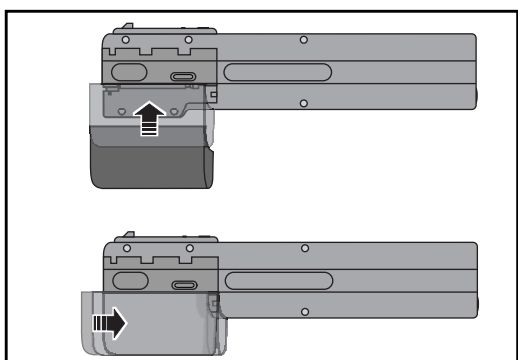

Loading the taped ferrule

- Press the ON button.
You hear a sound of movement and the green indicator light flashes. The crimping tool is ready for use.

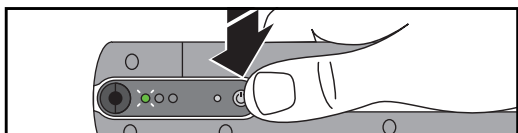

2.4 Crimping

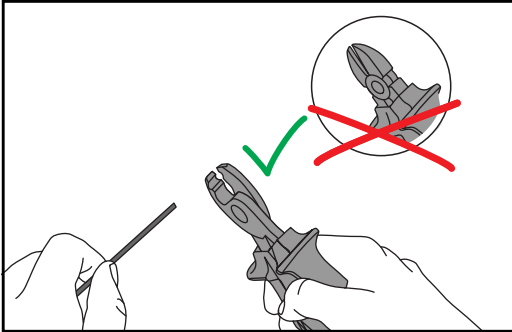

Cutting conductor to size



NOTE: Damage to the crimping tool

Make sure that the conductors are always cut straight. Conductors that have been squeezed, cut at an angle or already stripped must not be used.

Only use cable cutters with sharp blades which cut the conductors and do not squeeze them. Do not use diagonal cutters or similar unsuitable tools.

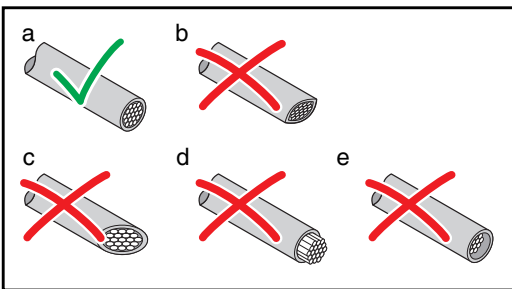

- Cut the conductor straight and cleanly with a CUTFOX 12 cable cutters. These cable cutters are supplied as standard.
 - Proper cut
 - Cut surface squeezed
 - Cut surface angled
 - Litz wires are longer than the insulation
 - Litz wires are shorter than the insulation
- Optionally, a cutting unit is available which is attached to the crimping tool (CF CRIMPHANDY CUTTER, 1212520).

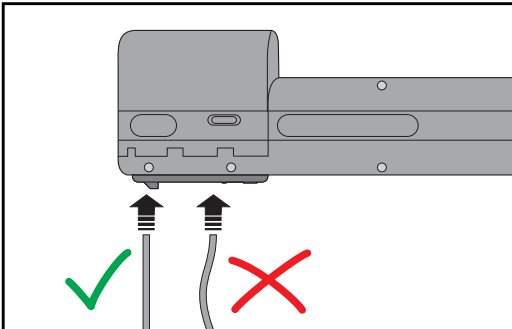

Inserting the conductor

- Insert the conductor straight and **without force** into the shaft. It may be helpful to turn the conductor slightly around its own axis.

The conductor is processed. You hear a crimping sound.

As soon as the conductor is being processed, you must not pull or push at it

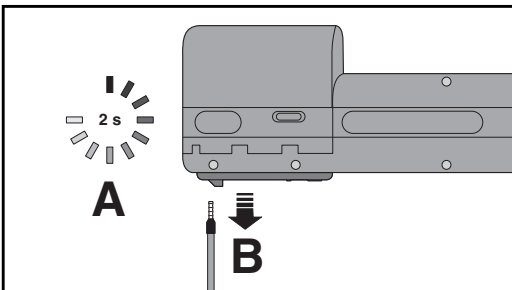

- When after approx. two seconds the process is concluded, pull the conductor out straight.

When the green indicator light flashes, the crimping tool is ready for use again.



We recommend checking the pull-out forces regularly. Check if ferrule and conductor are correctly crimped.

2.5 Loading the taped ferrule

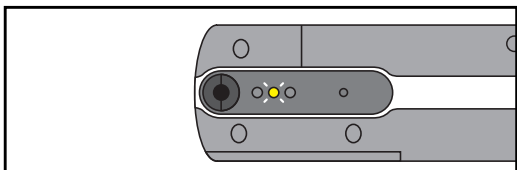

The yellow indicator light flashes. The ferrule magazine is empty.

- Remove the waste container and dispose of the insulation remnants.

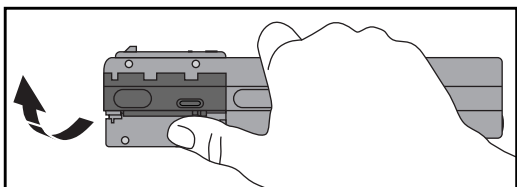

Opening the lid

- Flip the lid upwards to open. There will be slight resistance when doing this.

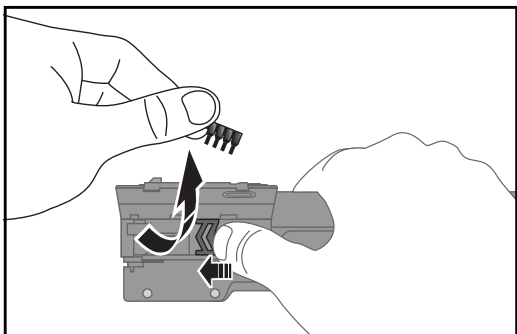

Removing the remnants of the tape

- Push the slide towards the front of the device.
- Hold the slide in this position and remove the remnants of the tape. Please make sure that the remnants of the tape do not fall into the guide shaft.

Inserting the taped ferrule

- See Page 13.

2.6 Removing the battery



NOTE: Damage to the crimping tool

Never remove the battery during the crimping process or troubleshooting. The conductor should be taken out before the battery is removed.

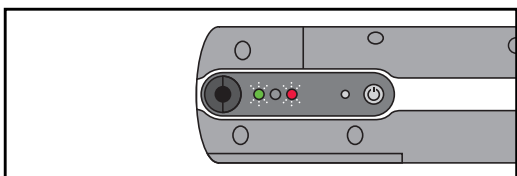

The green and red indicator lights flash simultaneously at short intervals. The battery is empty and has to be charged.

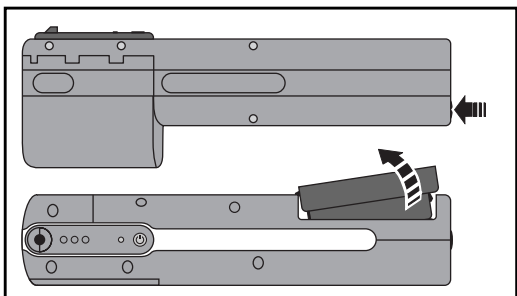

Unlocking the battery compartment

- Press the release button on the bottom of the crimping tool. The battery springs into the removal position.
- Remove the battery from the crimping tool.

Charging the battery

- See Page 11.

3 Troubleshooting



NOTE: Damage to the crimping tool

Faults, such as a jammed conductor, can be remedied using the steps described below. Never remove the battery during troubleshooting.









You may open the service cover to shake out loose parts. Do not loosen the screws of the housing to open it. This can damage the crimping tool.

The print "DO NOT OPEN" on the crimping tool indicates that the crimping tool will be damaged if the housing is opened.

3.1 Overview of possible faults

Error	Cause	Solution
The device will not switch on	<ul style="list-style-type: none"> Problems with the power supply 	<ul style="list-style-type: none"> Check the battery Clean the battery compartment
The green indicator light flashes, but the device does not trip or the conductor cannot be inserted	<ul style="list-style-type: none"> The battery was removed during a crimping cycle Problems with the power supply The conductor is not recognized The crimping unit has been shifted manually 	<ul style="list-style-type: none"> Initialize device (see Page 26)
The green indicator light flashes, but there is still a conductor in the device	<ul style="list-style-type: none"> The conductor was not correctly prepared (see Page 14) The conductor was inserted with too much force The conductor was pulled out too early The conductor does not correspond to the specifications 	<ul style="list-style-type: none"> Carefully turn the conductor and pull it out
	<ul style="list-style-type: none"> The battery was removed during the crimping process 	<ul style="list-style-type: none"> Screw in the service tool and remove the conductor Then initialize device (see Page 26)
The green and red indicator lights flash slowly, but the conductor is correct	<ul style="list-style-type: none"> The conductor is not recognized The conductor is recognized as having an incorrect cross-section 	<ul style="list-style-type: none"> Switch off the device without the conductor, and then switch on again Check the stranding of the wires Check if the conductor corresponds to the specifications Check the temperature range
Errors re-occur several times	<ul style="list-style-type: none"> The conductor does not correspond to the specifications 	<ul style="list-style-type: none"> Check if the conductor corresponds to the specifications
	<ul style="list-style-type: none"> Wear of the stripping blade Indications for wear of the blade are rough and asymmetrical cut edges on the insulation remnants in the waste container 	<ul style="list-style-type: none"> Please contact Phoenix Contact
	<ul style="list-style-type: none"> The conductor was not correctly prepared (see Page 14). 	<ul style="list-style-type: none"> Prepare the conductor according to specifications

3.2 Meaning of the indicator lights

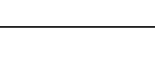
	Green	Yellow	Red	Meaning or action	For remedy see
	Long flashing	–	–	Ready for operation	–
	Short flashing	–	Short flashing	Battery is empty	Page 15
	Long flashing	–	Long flashing	Conductor cross section is too small or too big	–
	–	Long flashing	–	Insert taped ferrule. Press the ON switch.	Page 13
	–	On	–	Remove the taped ferrule. If none is inserted, actuate the tape slide.	Page 22
	On	On	On	A conductor is stuck in the crimping tool. Screw in the service tool on the threaded side and remove the conductor.	Page 20
	–	On	On	Press the reset button.	–
	–	–	On	Check if a ferrule without conductor is stuck in the crimping tool. To do so, push in the service tool on the plastic side until the red indicator light goes out. Then carefully remove the service tool.	Page 21
	–	–	Long flashing	Open the service cover. Remove loose parts from the device and close the service cover again. First remove any conductor that is stuck in the device. For this, screw in the service tool on the threaded side and remove the conductor. Remove the service tool. Press the ON switch.	Page 24
	Running light			No action is required if the running light appears briefly. If the running light appears continuously, start initializing the device. If this does not work, please contact Phoenix Contact.	Page 26

3.3 Troubleshooting sequences

The diagram of the sequences is to provide you with an overview. The crimping tool guides the user through the entire troubleshooting procedure

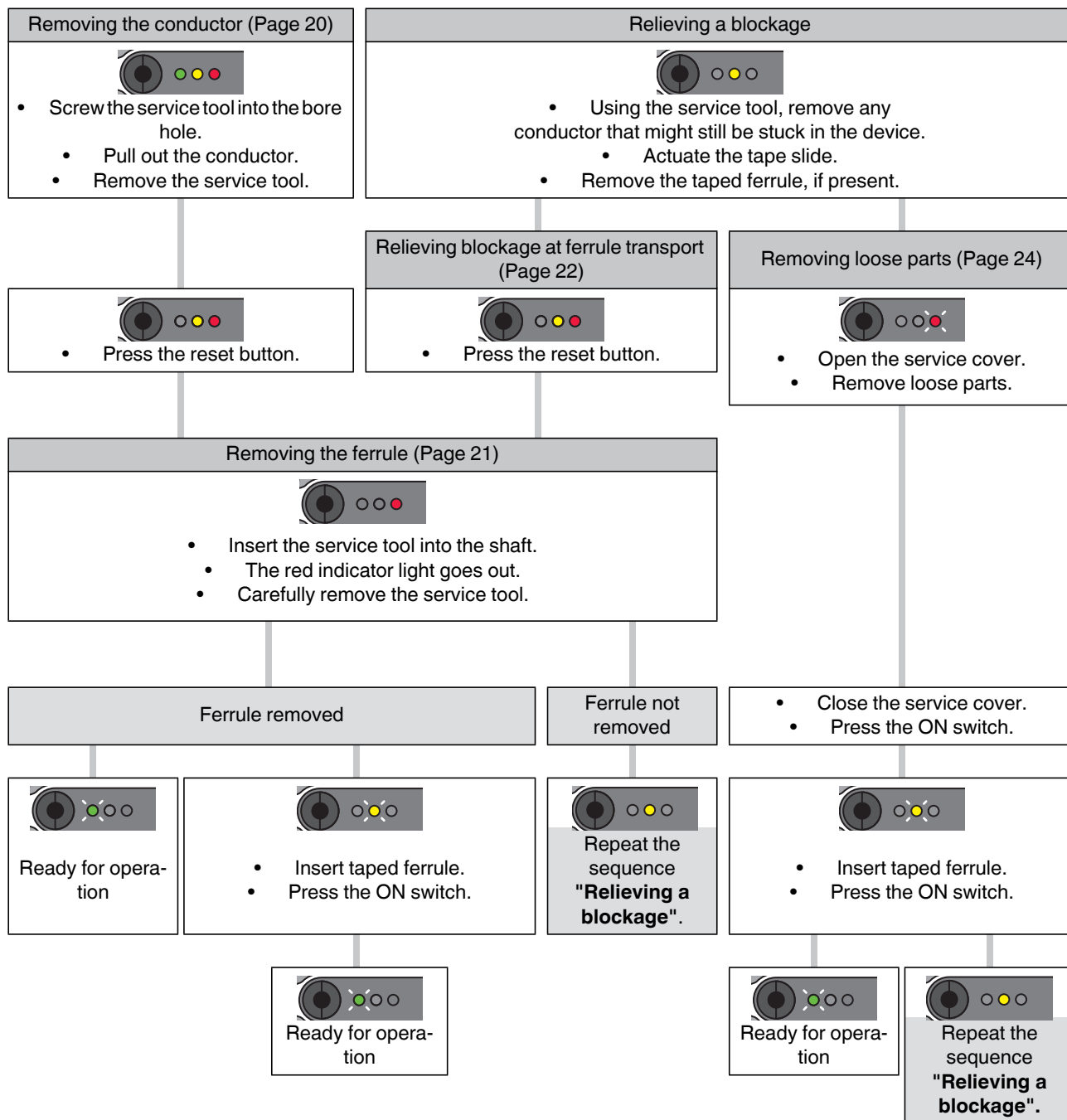

3.4 Removing the conductor

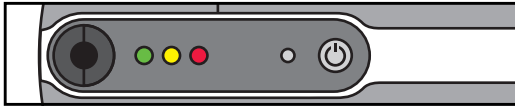

The three indicator lights light up simultaneously.

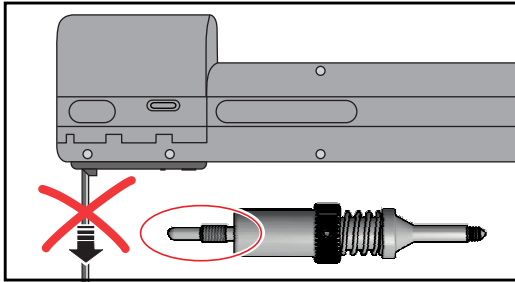

Following crimping, the conductor cannot be removed from the crimping tool.

- Take the service tool from the storage case.

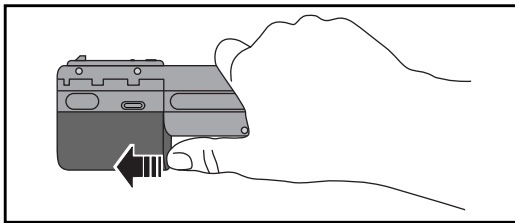

Removing the waste container

- Using your thumb, slide the waste container towards the front of the device and remove it with a downward motion.

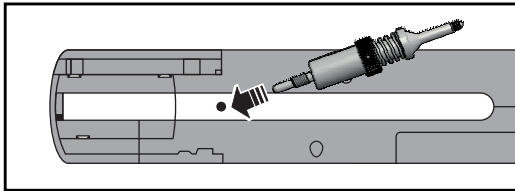

Screwing in the service tool and removing the conductor

On the bottom of the crimping tool you will see a bore hole with an inner thread.

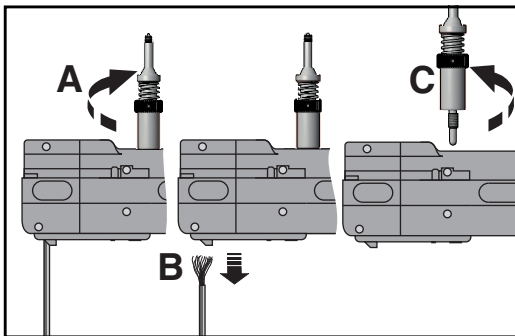

NOTE: Under no circumstances should you press the reset button while the service tool is screwed in. This will damage the crimping tool.

- Screw the service tool with the thread into the bore hole as far as it will go. Make sure that the service tool is not screwed too tight.
- Now carefully remove the conductor from the shaft.
- Screw out the service tool again.
- Reattach the waste container (see Page 13).

The yellow and red indicator lights light up.

- Press the reset button with the service tool.

If the red indicator light lights up, follow the sequence for removing a ferrule from the shaft (see Page 21).

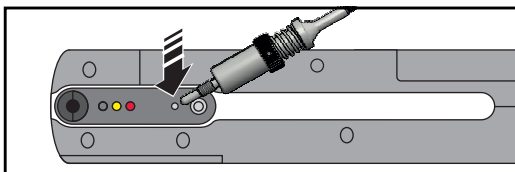

3.5 Removing the ferrule

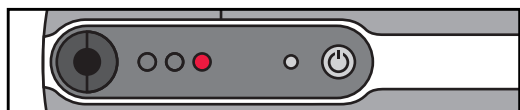

The red indicator light lights up.

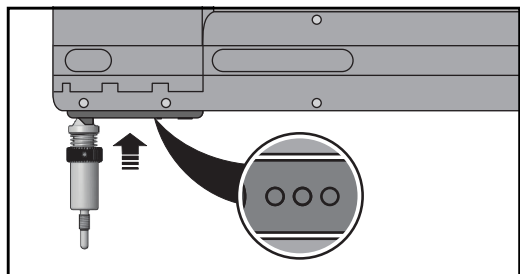

Inserting the service tool in the shaft

- Insert the service tool with the plastic side straight into the shaft as far as it will go.
- Press in the spring until the red indicator light goes out.

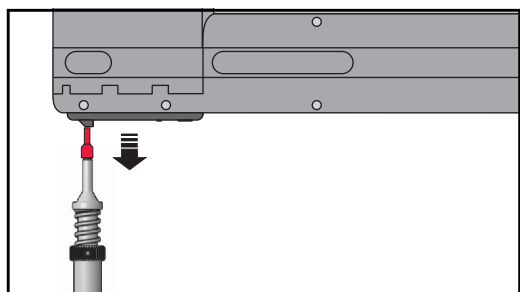

- Carefully pull the service tool out straight.
If there is a ferrule in the crimping die, it sticks to the service tool.
It is possible that no ferrule has been caught. The crimping tool detects this and continues with further measures for remedying the fault.

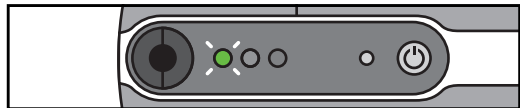

If the green indicator light flashes, the crimping tool is ready.

If the yellow indicator light flashes, no ferrule could be removed. Follow the sequence for removing loose parts from the device (see Page 24).

3.6 Relieving blockage at ferrule transport

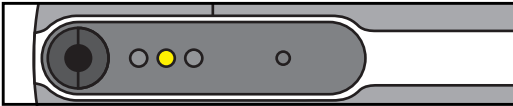

The yellow indicator light lights up. There is a mechanical blockage in the ferrule transport.

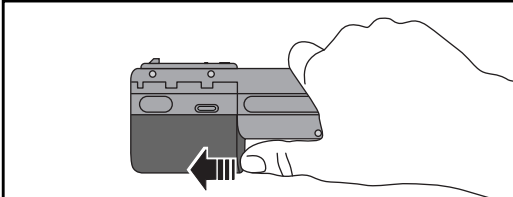

Removing the waste container

- Using your thumb, slide the waste container towards the front of the device and remove it with a downward motion.

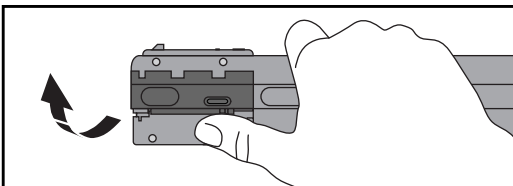

Opening the lid

- Flip the lid upwards to open. There will be slight resistance when doing this.

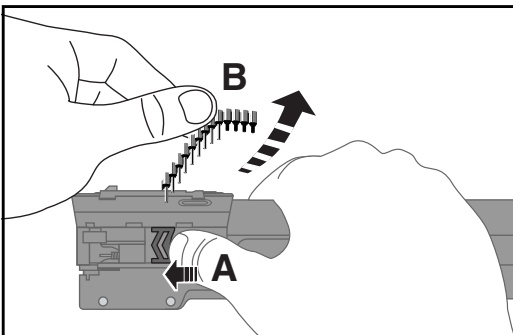

Removing the taped ferrule

- Push the slide towards the front of the device.
- Hold the slide in this position and remove the taped ferrule.
- **Always actuate the slide even if no tape was inserted.**



NOTE: No taped ferrules may remain in the device.

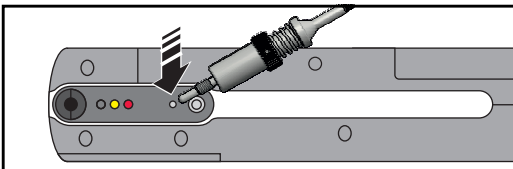

The yellow and red indicator lights light up.

- Press the reset button with the service tool.

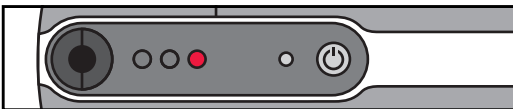

The red indicator light lights up.

If the red indicator light flashes, follow the sequence for removing loose parts (see Page 24, from "Taking off the service cover").

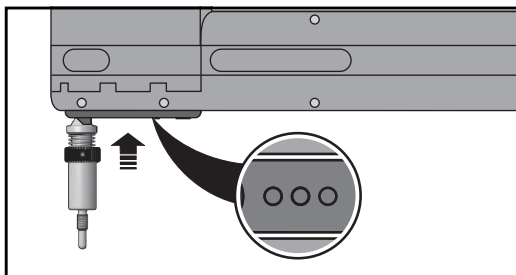

Inserting the service tool in the shaft

- Insert the service tool with the plastic side straight into the shaft as far as it will go.
- Press in the spring until the red indicator light goes out.

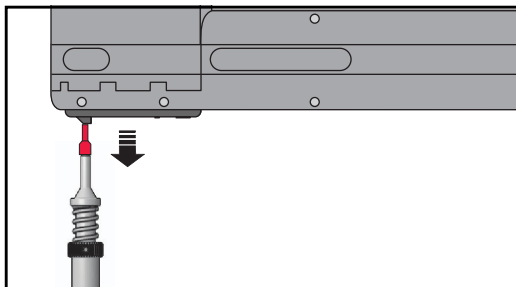

- Carefully pull the service tool out straight.
If there is a ferrule in the crimping die, it sticks to the service tool.
It is possible that no ferrule has been caught. The crimping tool detects this and continues with further measures for remedying the fault.

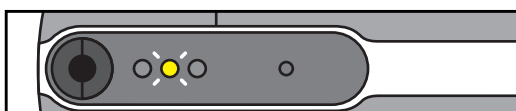

The yellow indicator light flashes.

If the yellow indicator light flashes, no ferrule could be removed. Follow the sequence for removing loose parts from the device (see Page 24).

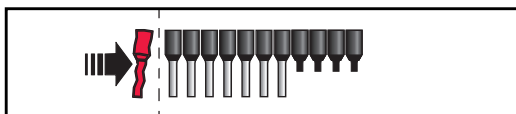

Inserting the taped ferrule

- Check if the taped ferrule is damaged.
- Detach damaged ferrules from the tape.
- Re-insert the taped ferrule (see Page 13).
- Reattach the waste container (see Page 13).

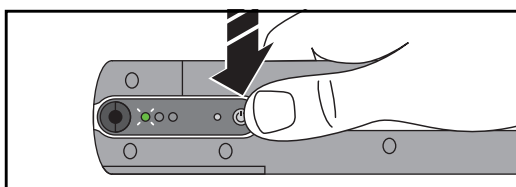
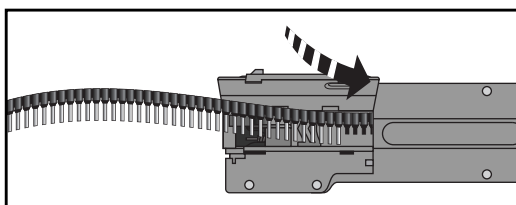

Loading the taped ferrule

- Press the ON button.

You hear a sound of movement and the green indicator light flashes. The crimping tool is ready for use.

3.7 Removing loose parts

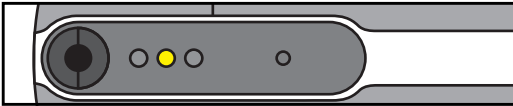

The yellow indicator light lights up.

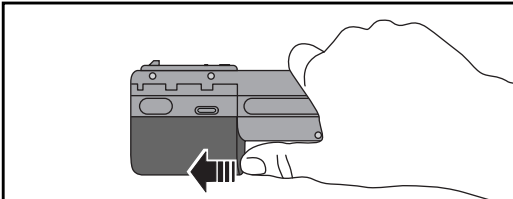

Removing the waste container

- Using your thumb, slide the waste container towards the front of the device and remove it with a downward motion.

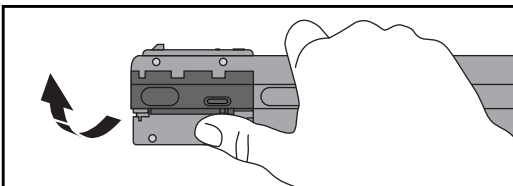

Opening the lid

- Flip the lid upwards to open. There will be slight resistance when doing this.

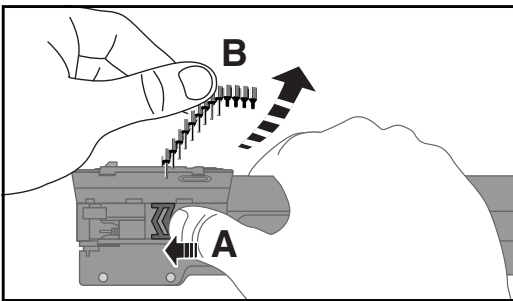

Removing the taped ferrule

- Push the slide towards the front of the device.
- Hold the slide in this position and remove the taped ferrule.
- **Always actuate the slide even if no tape was inserted.**



NOTE: No taped ferrules may remain in the device.

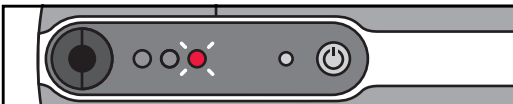

The red indicator light flashes.

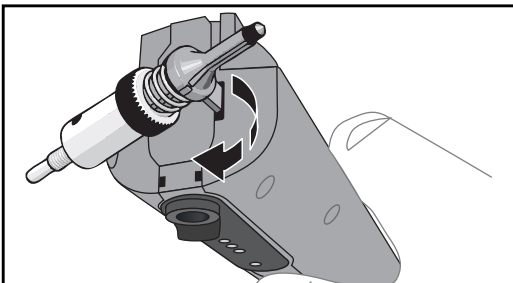

Taking off the service cover

- Loosen the service cover with the service tool.
For this, the service tool has a plastic protrusion that fits in a recess at the front side of the device.
With a slight turning movement, pry open the service cover.
- Take off the service cover. The crimping tool turns off automatically.

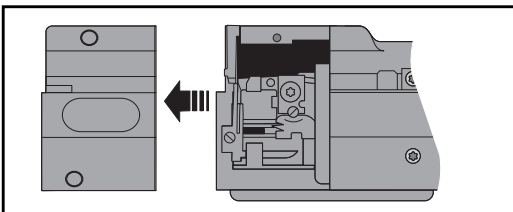

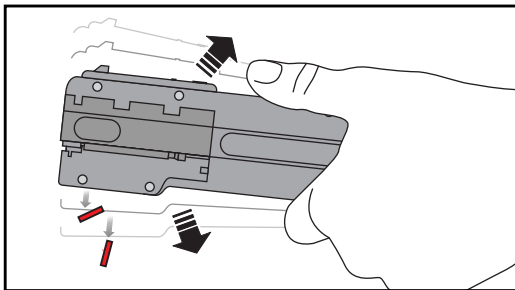

Shaking out loose parts

- Check if there are any loose parts in the device.
- Shake the loose parts out of the device. Do not use any tool that could damage the crimping tool.
- If a conductor is still sticking in the device, remove it as described on Page 20.

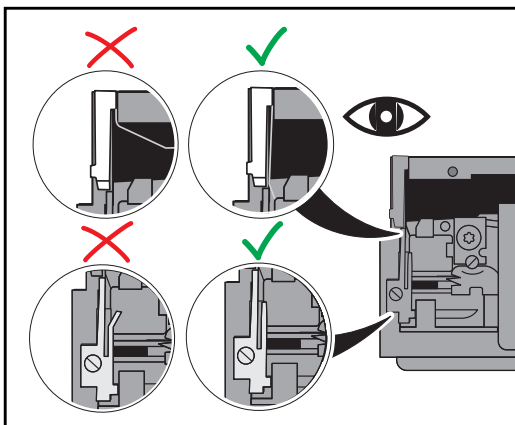

Checking waste guide plates

- Check whether the two waste guide plates are undamaged.
- If a waste guide plate is bent, you must replace it (see Page 27).

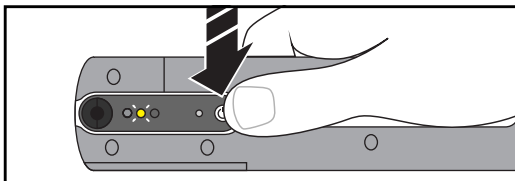

Switching on the crimping tool

- **Reattach the service cover.**
- Press the ON button.
The yellow indicator light flashes.

If the yellow indicator light lights up, follow the sequence for relieving a blockage (see Page 22).

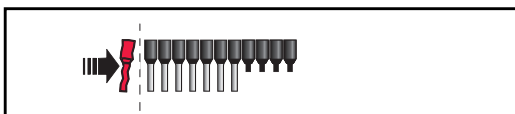

Inserting the taped ferrule

- Check if the taped ferrule is damaged.
- Detach damaged ferrules from the tape.
- Re-insert the taped ferrule (see Page 13).
- Reattach the waste container (see Page 13).

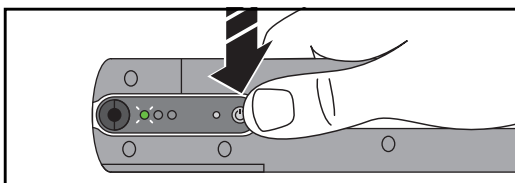
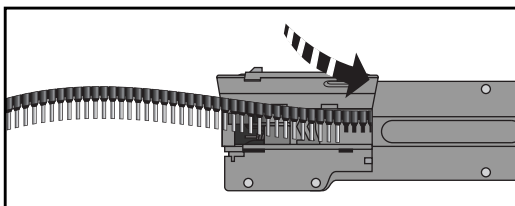

Loading the taped ferrule

- Press the ON button.

You hear a sound of movement and the green indicator light flashes. The crimping tool is ready for use.

If the yellow indicator light lights up, follow the sequence for relieving a blockage (see Page 22).

3.8 Initializing the crimping tool (Reset)

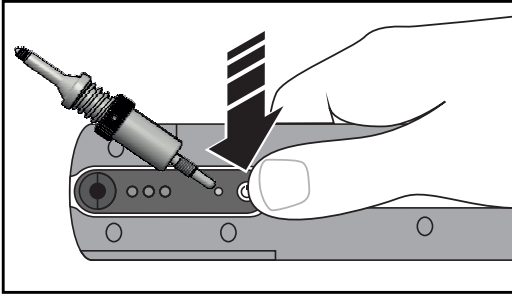

In exceptional cases, it is possible to initialize the device.

- Switch off the device.
- Hold the reset button pressed with the service tool.
- Press the ON button as well.
- Release the ON button first.
- Then release the reset button.

The yellow indicator light lights up.

- Follow the sequence for removing loose parts from the device (see Page 24).
- If this does not work, please contact Phoenix Contact.

3.9 Replacing waste guide plates

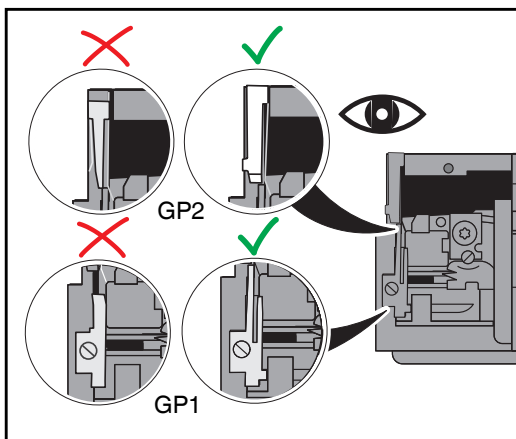

Checking unit version

- Check which type of waste guide plate is installed in your crimping tool. You can only replace waste guide plates from newer devices. Older devices must be sent to Phoenix Contact. There the device is retrofitted to conform to the current version.

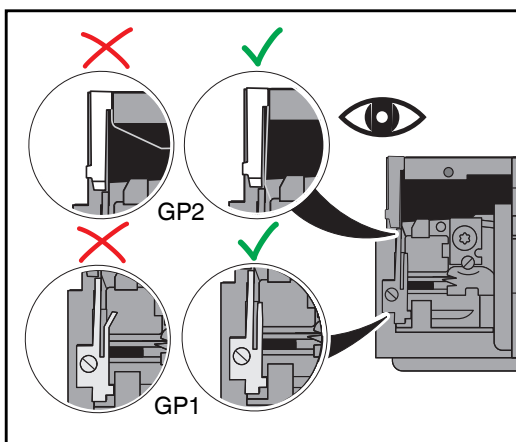

Checking waste guide plates

- Check whether the two waste guide plates are undamaged.
- If a waste guide plate is bent, you must replace it.
- Ordering data for the upper waste guide plate (GP2)
CF CRIMPHANDY 0.5/GP2, 1212515
CF CRIMPHANDY 0.75/GP2, 1212516
CF CRIMPHANDY 1.0/GP2, 1212517
CF CRIMPHANDY 1.5/GP2, 1212844
- Ordering data for the lower waste guide plate (GP1)
CF CRIMPHANDY/GP1, 1212514

3.9.1 Replacing waste guide plate GP1

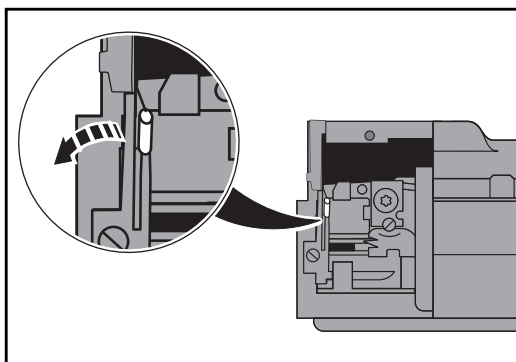

Removing residual insulation

- Check if there is still residual insulation under waste guide plate GP1.

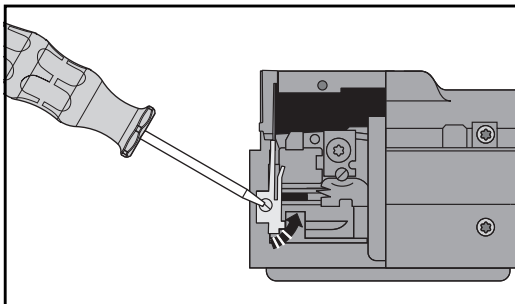

Removing waste guide plate GP1

- Release the screw from the waste guide plate.
- Remove the waste guide plate.

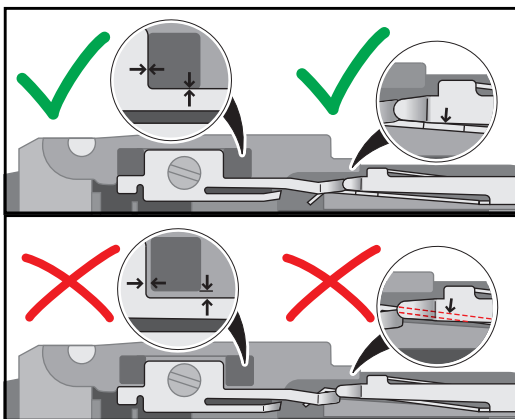

Inserting new waste guide plate GP1

- Insert the new waste guide plate.
Ordering data: CF CRIMPHANDY/GP1, 1212514
- Check for proper fitting in the slot.
- Re-tighten the screw.

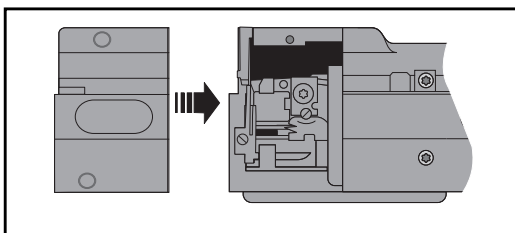

Attaching the service cover

- Put the service cover on again.

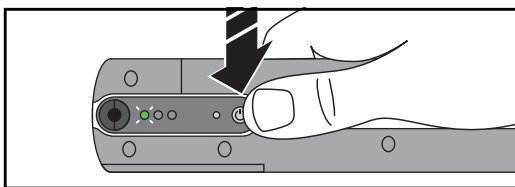

Loading the taped ferrule

- Press the ON button.

You hear a sound of movement and the green indicator light flashes. The crimping tool is ready for use.

If the yellow indicator light flashes, insert taped ferrule (see Page 13).

If the yellow indicator light lights up, follow the sequence for relieving a blockage (see Page 22).

3.9.2 Replacing waste guide plate GP2

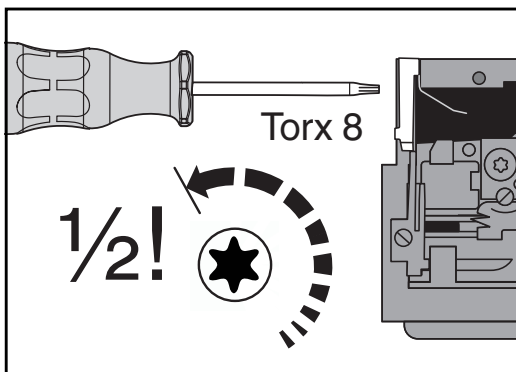

Remove screws



NOTE: If you screw out the screw too far, the crimping tool will be damaged. A half turn is sufficient to release the waste guide plate.

- Loosen the screw with a Torx 8 screwdriver by exactly half of a rotation.

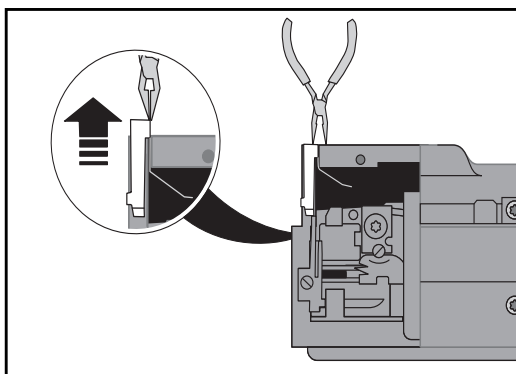

Removing waste guide plate

- Pull out the waste guide plate with a needle-nose pliers.

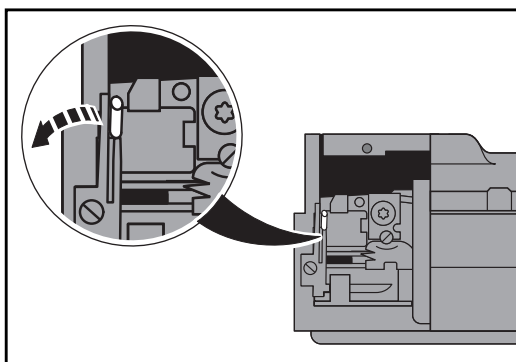

Removing residual insulation

- Check if there is still residual insulation under waste guide plate GP1.

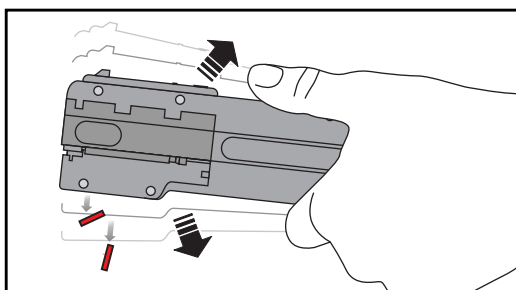

Shaking out loose parts

- Check if there are any loose parts in the device.
- Shake the loose parts out of the device. Do not use any tool that could damage the crimping tool.

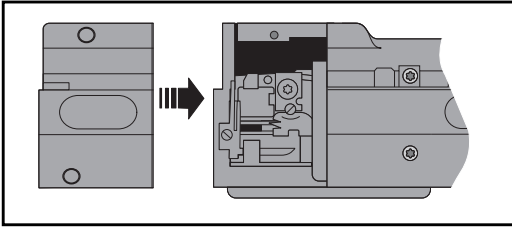

Attaching the service cover

- Put on the service cover again when the device is switched off.

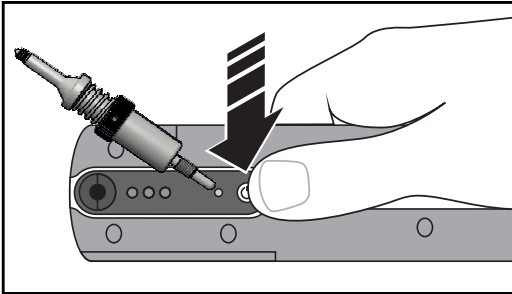

Initializing the crimping tool (Reset)

Initialize the device so that it travels to the initial position.

The device must be switched off.

- Hold the reset button pressed with the service tool.
- Press the ON button as well.
- Release the ON button first.
- Release the reset button.
- The yellow indicator light lights up.

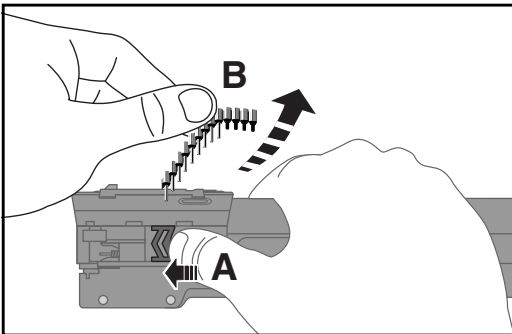

Removing the taped ferrule

- Push the slide towards the front of the device.
- Hold the slide in this position and remove the taped ferrule.
- **Always actuate the slide even if no tape was inserted.**



NOTE: No taped ferrules may remain in the device.

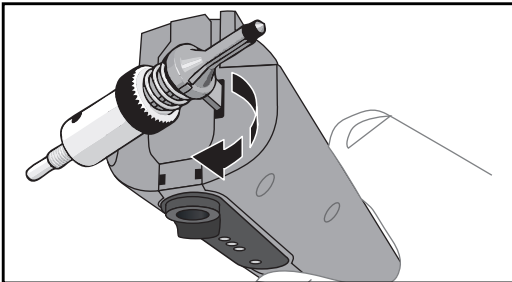

Taking off the service cover

- Take off the service cover. The crimping tool turns off automatically.

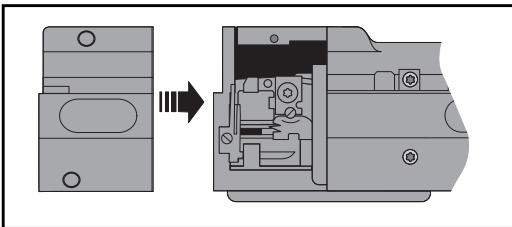

Attaching the service cover

- Put on the service cover again when the device is switched off.

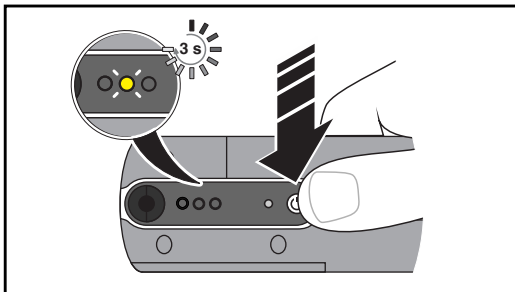

Switching on the crimping tool

- Press the ON button.
After approx. three seconds, the yellow indicator light flashes.

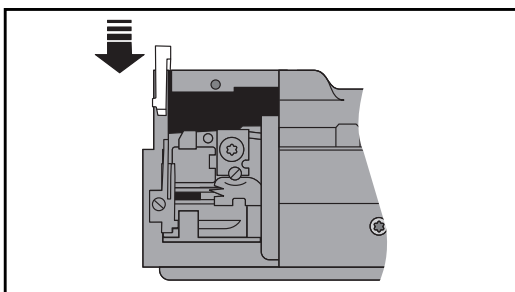

Inserting waste guide plate

- Take off the service cover. The crimping tool turns off automatically.
- Insert the new waste guide plate. Make sure you select the correct waste guide plate GP2 for your crimping tool.

Ordering data:

CF CRIMPHANDY 0.5/GP2, 1212515

CF CRIMPHANDY 0.75/GP2, 1212516

CF CRIMPHANDY 1.0/GP2, 1212517

CF CRIMPHANDY 1.5/GP2, 1212844

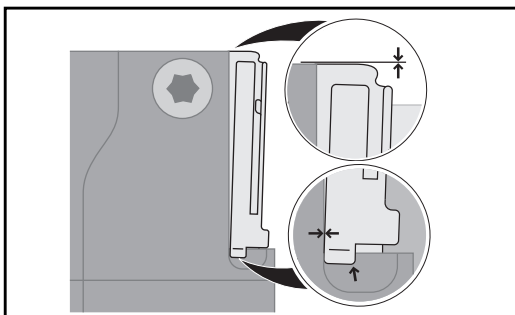

- The small lug must be on the small inclined surface. If the lug is pushed behind this surface, the new plate will be bent with its first use. (This lug is indicated in the lower magnifying glass with the single arrow.)
- It is important that the waste guide plate is cleanly engaged and does not protrude from the housing frame.

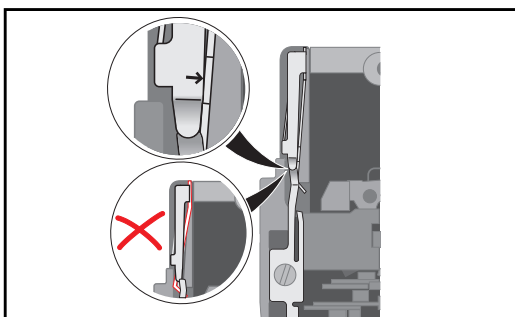

- Observe the position of the bracket of waste guide plate GP2.

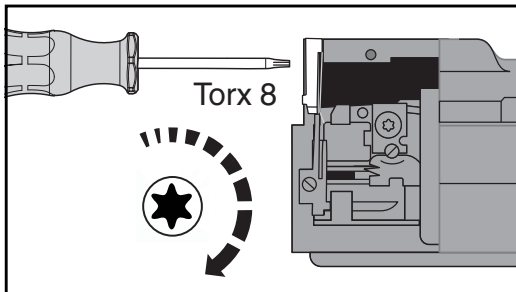

- Hold the waste guide plate in position.
- Retighten the screw.

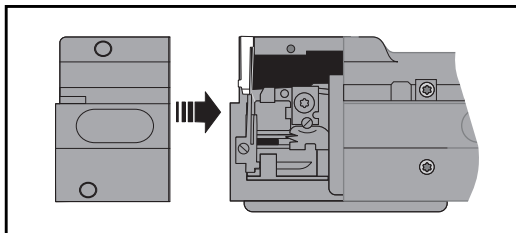

Attaching the service cover

- Put the service cover on again.

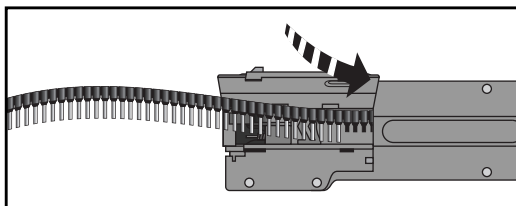

Inserting the taped ferrule

- Re-insert the taped ferrule (see Page 13).
- Reattach the waste receptacle (see Page 13).

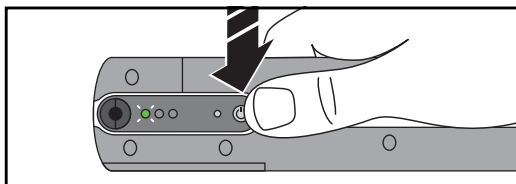

Loading the taped ferrule

- Press the ON button.

You hear a sound of movement and the green indicator light flashes. The crimping tool is ready for use.

If the yellow indicator light lights up, follow the sequence for relieving a blockage (see Page 22).

3.10 Returning a product

When returning a product, please enclose a short description of how the fault occurred. We will also require incorrect results of crimping, insulation remnants, and one meter of the cable used.

A Appendix

A 1 Ordering data

Portable crimping tool

Description	Type	Order No.	Pcs. / Pkt.
Portable crimping tool			
For a cross section of 0.5 mm ²	CF CRIMPHANDY 0,5	1212463	1
For a cross section of 0.75 mm ²	CF CRIMPHANDY 0,75	1212464	1
For a cross section of 1.0 mm ²	CF CRIMPHANDY 1,0	1212465	1
For a cross section of 1.5 mm ²	CF CRIMPHANDY 1,5	1212466	1

Replacement parts

Description	Designation	Order No.	Pcs. / Pkt.
Replacement battery , for CF CRIMPHANDY..., lithium-ion 7.4 V; 0.68 Ah	CF CRIMPHANDY/ACCU	1212518	1
Replacement charger , for 100 V... 240 V AC mains voltage, short charging time, short-circuit-proof, protected against polarity reversal, operating state indicator	CF CRIMPHANDY/CHARGER	1212519	1
Replacement service tool			
For CF CRIMPHANDY 0,5	CF CRIMPHANDY 0,5/SERVICE-TOOL	1212787	1
For CF CRIMPHANDY 0,75	CF CRIMPHANDY 0,75/SERVICE-TOOL	1212786	1
For CF CRIMPHANDY 1,0	CF CRIMPHANDY 1,0/SERVICE-TOOL	1212759	1
For CF CRIMPHANDY 1,5	CF CRIMPHANDY 1,5 /SERVICE-TOOL	1212708	1
Replacement waste container , for CF CRIMPHANDY...	CF CRIMPHANDY/COVER	1212709	1
Replacement waste guide plate GP1 , for CF CRIMPHANDY..., (see Page 24)	CF CRIMPHANDY/GP1	1212514	1
Replacement waste guide plate GP2 , (see Page 24)			
For CF CRIMPHANDY 0,5	CF CRIMPHANDY 0,5/GP2	1212515	1
For CF CRIMPHANDY 0,75	CF CRIMPHANDY 0,75/GP2	1212516	1
For CF CRIMPHANDY 1,0	CF CRIMPHANDY 1,0/GP2	1212517	1
For CF CRIMPHANDY 1,5	CF CRIMPHANDY 1,5/GP2	1212844	1

Accessories

Description	Designation	Order No.	Pcs. / Pkt.
Cable cutter , for copper and aluminum up to 12 mm diameter (up to 35 mm ²)	CUTFOX 12	1212128	1
Cutting unit , for CF CRIMPHANDY, for stranded copper wires from 0.5 - 1.5 mm ² , incl. waste container	CF CRIMPHANDY CUTTER	1212520	1

Taped ferrules

	Color code according to DIN 46228-4/ UL486F	Color code according to NF C 63-023	Special color
Taped ferrules , 8 mm, with plastic ferrule, dimensions according to DIN 46228-4/UL486F, 20 strips, 50 pcs. per strip			
0.5 mm ² , for CF CRIMPHANDY 0,5	Al 0,5-8 WH-S, 1212521; color: white	Al 0,5-8 WH-S, 1212521; color: white	Al 0,5-8 OG-S, 1212784; color: orange
0.75 mm ² , for CF CRIMPHANDY 0,75	Al 0,75-8 GY-S, 1212522; color: gray	Al 0,75-8 BU-S, 1212785; color: blue	Al 0,75-8 WH-S, 1212783; color: white
1.0 mm ² , for CF CRIMPHANDY 1,0	Al 1,0-8 RD-S, 1212523; color: red	Al 1,0-8 RD-S, 1212523; color: red	Al 1,0-8 YE-S, 1212782; color: yellow
1.5 mm ² , for CF CRIMPHANDY 1,5	Al 1,5-8 BK-S, 1212524; color: black	Al 1,5-8 BK-S, 1212524; color: black	Al 1,5-8 RD-S, 1212781; color: red

A 2 Technical data

Technical data	
Operating voltage	7.4 V DC/lithium-ion battery
Charger	Mains voltage 100 V AC ... 240 V AC, 50 Hz ... 60 Hz
Battery charging time	60 min, approximately/can be used after 20 min
Working cycle	< 2 s
Crimping	Square crimp
Type of contact	Insulated ferrules, order designation AI...-8...-S
Sleeve length	8 mm
Ferrule capacity	50 pcs
Insertion length of conductor	32 mm
Conductor type	H05V-K/H07V-K (see table below)
Insulation type	PVC
Crimp cycles per battery charge	Up to 2000
Ambient temperature, operation	+15°C ... +30°C
Dimensions (W x H x D)	43 mm x 205 mm x 70 mm
Weight	434 g
Noise emission L_{pA}	< 70 dB (A)
Work cycle trigger	Sensor
Controller	Electrical
Indicators	Indicator lights (LEDs) for status indicator

Device type	Conductor cross section, metric	Outside diameter	Conductor type
CF CRIMPHANDY 0,5	0.5 mm ²	1.7 mm ... 2.4 mm	H05V-K
CF CRIMPHANDY 0,75	0.75 mm ²	1.9 mm ... 2.6 mm	H05V-K
CF CRIMPHANDY 1,0	1.0 mm ²	2.0 mm ... 2.7 mm	H05V-K
CF CRIMPHANDY 1,5	1.5 mm ²	2.4 mm ... 3.1 mm	H07V-K

