

## Features

- Silver plated
- 2 Claw Support
- Female
- 10A

## RS PRO Heavy Duty Connector Contacts

RS Stock No.:

0180198



RS PRO is the own brand of RS. The RS PRO Seal of Approval is your assurance of professional quality, a guarantee that every part is rigorously tested, inspected, and audited against demanding standards. Making RS PRO the Smart Choice for our customers.

## Product Description

*The RS Pro Heavy-Duty Connector series is a full range of heavy-duty inserts, housings, crimps and accessories. These crimps have two claws for extra support and are compatible with the RS Pro range of heavy-duty inserts. These connectors have been designed for situations where they will encounter harsh environments. This makes them ideal for food & beverage manufacturing, packaging machines, conveyor belt systems, railway, oil & gas processing and other industrial automation*

## General Specifications

Material	Silver Plated
Connector type	Crimp
Current Rating	10A
Gender	Female
Contact Resistance	$\leq 3\text{m}\Omega$
For use with	RS-HD, RS-HDD, RS-HM, RS-HK, RS-HQ inserts

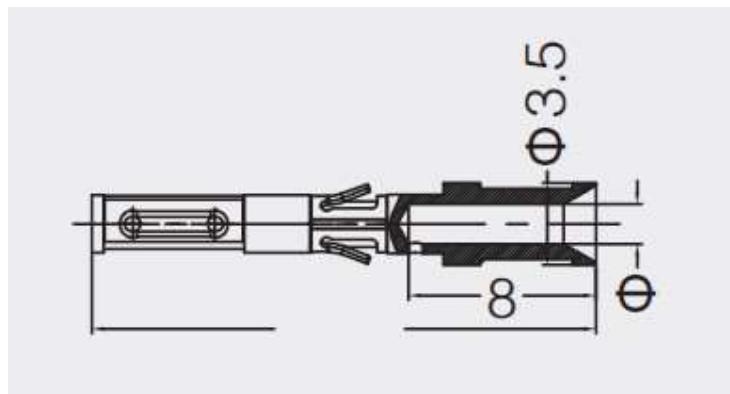

Wire Gauge	$\Phi$	Stripping length
0.75 mm <sup>2</sup>	1.3	8 mm