

Self-Lube bearing inserts

1000G and 1100 Series

1000G

With spherical outside diameter and integral set screw lock

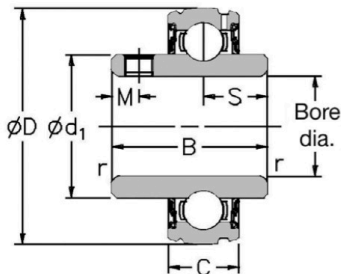

1100

With parallel outside diameter and integral set screw lock

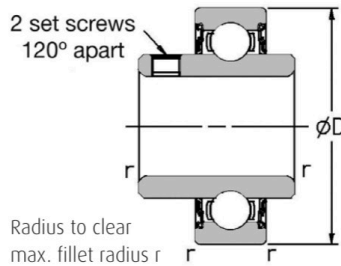

Shaft diameter mm inches	RHP designation		Dimensions (mm)							ISO Load ratings		Rec. max. speed rev/min	Mass (approx.) kg
	1000G Series	1100 Series	D	C	B	s	d1	M	r	dynamic Cr newtons	static Cor newtons		
12		1017-12G 1117-12	40.000	12.00	27.38	11.58	24.80	5.00	0.60	9550	4800	7000	0.09
15		1017-15G 1117-15											
16		1017-16G 1117-16											
17		1017-17G 1117-17											
	1/2	1017-1/2G 1117-1/2											
	5/8	1017-5/8G 1117-5/8											
20		1020-20G 1120-20	47.000	14.00	31.00	12.73	28.30	5.00	1.00	12800	6650	6700	0.13
	3/4	1020-3/4G 1120-3/4											
25		1025-25G 1125-25	52.000	15.00	34.10	14.33	34.00	5.00	1.00	14000	7880	6250	0.17
	7/8	1025-7/8G 1125-7/8											
	15/16	1025-15/16G 1125-15/16											
	1	1025-1G 1125-1											
25		1030-25G 1130-25	62.000	16.00	38.10	15.93	40.30	5.00	1.00	19500	11300	5300	0.37
30		1030-30G 1130-30											
	1	1030-1G 1130-1											
	1 1/8	1030-1 1/8G 1130-1 1/8											
	1 3/16	1030-1 3/16G 1130-1 3/16											
	1 1/4	1030-1 1/4G 1130-1 1/4											
30		1035-30G 1135-30	72.000	17.00	42.90	17.53	46.90	6.50	1.00	25700	15300	4500	0.51
35		1035-35G 1135-35											
	1 3/16	1035-1 3/16G 1135-1 3/16											
	1 1/4	1035-1 1/4G 1135-1 1/4											
	1 5/16	1035-1 5/16G 1135-1 5/16											
	1 3/8	1035-1 3/8G 1135-1 3/8											
	1 7/16	1035-1 7/16G 1135-1 7/16											
35		1040-35G 1140-35	80.000	18.00	49.20	19.03	52.40	8.00	1.00	32500	19900	4000	0.64
40		1040-40G 1140-40											
	1 3/8	1040-1 3/8G 1140-1 3/8											
	1 7/16	1040-1 7/16G 1140-1 7/16											
	1 1/2	1040-1 1/2G 1140-1 1/2											
40		1045-40G 1145-40	85.000	19.00	49.20	19.04	57.40	8.00	1.00	32500	20500	3700	0.73
45		1045-45G 1145-45											
	1 1/2	1045-1 1/2G 1145-1 1/2											
	1 5/8	1045-1 5/8G 1145-1 5/8											
	1 11/16	1045-1 11/16G 1145-1 11/16											
	1 3/4	1045-1 3/4G 1145-1 3/4											
45		1050-45G 1150-45	90.000	20.00	51.60	19.04	62.40	10.00	1.00	35000	23200	3400	0.91
50		1050-50G 1150-50											
	1 11/16	1050-1 11/16G 1150-1 11/16											
	1 3/4	1050-1 3/4G 1150-1 3/4											
	1 7/8	1050-1 7/8G 1150-1 7/8											
	1 15/16	1050-1 15/16G 1150-1 15/16											
	2	1050-2G 1150-2											
50		1055-50G 1155-50	100.000	21.00	55.60	22.24	68.90	10.00	1.50	43500	29200	3100	1.12
55		1055-55G 1155-55											
	1 7/8	1055-1 7/8G 1155-1 7/8											
	1 15/16	1055-1 15/16G 1155-1 15/16											
	2	1055-2G 1155-2											
	2 1/8	1055-2 1/8G 1155-2 1/8											
	2 3/16	1055-2 3/16G 1155-2 3/16											

Please check availability

Shaft diameter mm inches		RHP designation 1000G Series 1100 Series		Dimensions (mm)						ISO Load ratings		Rec. max. speed rev/min	Mass (approx.) kg	
				D	C	B	s	d1	M	r	dynamic Cr newtons			static Cor newtons
55		1060-55G	1160-55	110.000	22.00	65.10	25.44	76.00	10.00	1.50	48000	33000	2800	1.47
60		1060-60G	1160-60											
	2 ³ / ₁₆	1060-2 ³ / ₁₆ G	1160-2 ³ / ₁₆											
	2 ¹ / ₄	1060-2 ¹ / ₄ G	1160-2 ¹ / ₄											
	2 ³ / ₈	1060-2 ³ / ₈ G	1160-2 ³ / ₈											
	2 ⁷ / ₁₆	1060-2 ⁷ / ₁₆ G	1160-2 ⁷ / ₁₆											
60		1065-60G	1165-60	120.000	23.00	65.10	25.44	82.50	10.00	1.50	57500	40000	2600	2.02
65		1065-65G	1165-65											
	2 ¹ / ₂	1065-2 ¹ / ₂ G	1165-2 ¹ / ₂											
60		1070-60G	1170-60	125.000	24.00	74.60	30.24	89.00	12.00	1.50	61000	45000	2450	2.27
65		1070-65G	1170-65											
70		1070-70G	1170-70											
	2 ⁷ / ₁₆	1070-2 ⁷ / ₁₆ G	1170-2 ⁷ / ₁₆											
	2 ¹ / ₂	1070-2 ¹ / ₂ G	1170-2 ¹ / ₂											
	2 ⁵ / ₈	1070-2 ⁵ / ₈ G	1170-2 ⁵ / ₈											
	2 ¹¹ / ₁₆	1070-2 ¹¹ / ₁₆ G	1170-2 ¹¹ / ₁₆											
65		1075-65G	1175-65	130.000	25.00	77.80	33.34	94.00	12.00	1.50	66000	49500	2300	2.61
70		1075-70G	1175-70											
75		1075-75G	1175-75											
	2 ¹¹ / ₁₆	1075-2 ¹¹ / ₁₆ G	1175-2 ¹¹ / ₁₆											
	2 ³ / ₄	1075-2 ³ / ₄ G	1175-2 ³ / ₄											
	2 ⁷ / ₈	1075-2 ⁷ / ₈ G	1175-2 ⁷ / ₈											
	2 ¹⁵ / ₁₆	1075-2 ¹⁵ / ₁₆ G	1175-2 ¹⁵ / ₁₆											
	3	1075-3G	1175-3											
75		1080-75G	1180-75	140.000	26.00	82.60	33.34	100.00	12.00	2.00	71500	54500	2150	3.23
80		1080-80G	1180-80											
	2 ¹⁵ / ₁₆	1080-2 ¹⁵ / ₁₆ G	1180-2 ¹⁵ / ₁₆											
	3	1080-3G	1180-3											
	3 ³ / ₁₆	1080-3 ³ / ₁₆ G	1180-3 ³ / ₁₆											
	3 ¹ / ₄	1080-3 ¹ / ₄ G	1180-3 ¹ / ₄											
80		1085-80G	1185-80	150.000	28.00	85.70	34.15	107.10	12.00	2.00	83000	64000	2000	3.74
85		1085-85G	1185-85											
	3 ³ / ₁₆	1085-3 ³ / ₁₆ G	1185-3 ³ / ₁₆											
	3 ¹ / ₄	1085-3 ¹ / ₄ G	1185-3 ¹ / ₄											
	3 ³ / ₈	1085-3 ³ / ₈ G	1185-3 ³ / ₈											
	3 ⁷ / ₁₆	1085-3 ⁷ / ₁₆ G	1185-3 ⁷ / ₁₆											
85		1090-85G	1190-85	160.000	30.00	96.00	39.74	111.50	15.00	2.00	96000	71500	1900	4.99
90		1090-90G	1190-90											
	3 ⁷ / ₁₆	1090-3 ⁷ / ₁₆ G	1190-3 ⁷ / ₁₆											
	3 ¹ / ₂	1090-3 ¹ / ₂ G	1190-3 ¹ / ₂											
95		3095-95G		200.000	45.00	117.48	49.31	127.10	16.00	2.50	157000	122000	1600	9.53
100		3095-100G												
	3 ¹⁵ / ₁₆	3095-3 ¹⁵ / ₁₆ G												
	4	3095-4G												