

Union

G

Metric Tube End / Metric Tube End

All dimensions in millimeters.

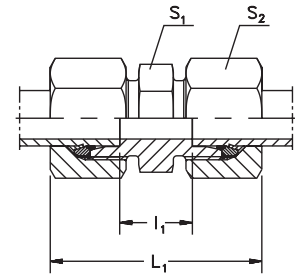

| Part No. | Series Working Pressure (bar/psi) | Tube o.d. | I1 | L1 | S1 | S2 | Standard Material From Stock | | | Standard EO-2 From Stock | |
|----------|---|-----------|----|----|----|----|------------------------------|----|---|--------------------------|----|
| | | | | | | | S | SS | B | S | SS |
| G04LLA3C | LL very light 250 bar 3625 psi | 4 | 12 | 31 | 9 | 10 | • | • | • | • | |
| G06LLA3C | | 6 | 9 | 32 | 11 | 12 | • | • | • | • | |
| G08LLA3C | 100 bar 1450 psi | 8 | 12 | 35 | 12 | 14 | • | • | • | | |
| G10LLA3C | | 10 | 12 | 35 | 14 | 17 | • | | • | | |
| G12LLA3C | | 12 | 11 | 35 | 17 | 19 | • | | | | |
| G06LA3C | L light 315 bar 4560 psi | 6 | 10 | 39 | 12 | 14 | • | • | • | • | • |
| G08LA3C | | 8 | 11 | 40 | 14 | 17 | • | • | • | • | • |
| G10LA3C | | 10 | 13 | 42 | 17 | 19 | • | • | • | • | • |
| G12LA3C | | 12 | 14 | 43 | 19 | 22 | • | • | • | • | • |
| G15LA3C | | 15 | 16 | 46 | 24 | 27 | • | • | • | • | • |
| G18LA3C | | 18 | 16 | 48 | 27 | 32 | • | • | • | • | • |
| G22LA3C | 160 bar 2320 psi | 22 | 20 | 52 | 32 | 36 | • | • | • | • | • |
| G28LA3C | | 28 | 21 | 54 | 41 | 41 | • | • | • | • | • |
| G35LA3C | | 35 | 20 | 63 | 46 | 50 | • | • | • | • | • |
| G42LA3C | | 42 | 21 | 66 | 55 | 60 | • | • | • | • | • |
| G06SA3C | S heavy 630 bar 9130 psi | 6 | 16 | 45 | 14 | 17 | • | • | • | • | • |
| G08SA3C | | 8 | 18 | 47 | 17 | 19 | • | • | • | • | • |
| G10SA3C | | 10 | 17 | 49 | 19 | 22 | • | • | • | • | • |
| G12SA3C | | 12 | 19 | 51 | 22 | 24 | • | • | • | • | • |
| G14SA3C | | 14 | 22 | 57 | 24 | 27 | • | • | • | • | • |
| G16SA3C | 400 bar 5800 psi | 16 | 21 | 57 | 27 | 30 | • | • | • | • | • |
| G20SA3C | | 20 | 23 | 66 | 32 | 36 | • | • | • | • | • |
| G25SA3C | | 25 | 26 | 74 | 41 | 46 | • | • | • | • | • |
| G30SA3C | | 30 | 27 | 80 | 46 | 50 | • | • | • | • | • |
| G38SA3C | 315 bar 4560 psi | 38 | 29 | 90 | 55 | 60 | • | • | • | • | • |

Dimensions given approx. figures with tightened nut.

EO-2 Part Number example: G06ZLA3C

