

semi-rotary drive DRVS-25-90-P

Part number: 1845716

★ Core product range

FESTO

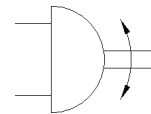
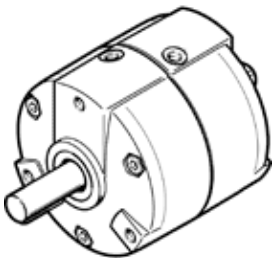

Data sheet

Feature	Value
Size	25
Cushioning angle	0.5 deg
Swivel angle	0 ... 90 deg
Cushioning	P: Flexible cushioning rings/plates at both ends
Assembly position	Any
Mode of operation	double-acting
Design structure	Rotary vane
Position detection	For proximity sensor
Variants	Spigot shaft
Operating pressure	2 ... 8 bar
Max. swivel frequency at 6 bar	3 Hz
Operating medium	Compressed air in accordance with ISO8573-1:2010 [7:4:4]
Note on operating and pilot medium	Lubricated operation possible (subsequently required for further operation)
Corrosion resistance classification CRC	1 - Low corrosion stress
Ambient temperature	0 ... 60 °C
Max. axial force	40 N
Max. radial force	60 N
Theoretical torque at 6 bar	5 Nm
Permissible mass moment of inertia	0.012 kgm ²
Product weight	502 g
Mounting type	with internal (female) thread
Pneumatic connection	M5
Materials note	Conforms to RoHS
Material of drive shaft	Steel, nickel-plated
Material seals	TPE-U(PU)
Material housing	Aluminium die cast Painted